

DO NOT SCALE

DIMENSIONS IN mm

METRIC

THIRD ANGLE  
PROJECTION

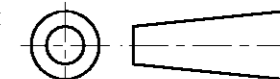

LTR.	REVISION RECORD	DR.	CHK.	DATE
C2	REVISED PER ECO-11-005140	RK	HMR	01APR11

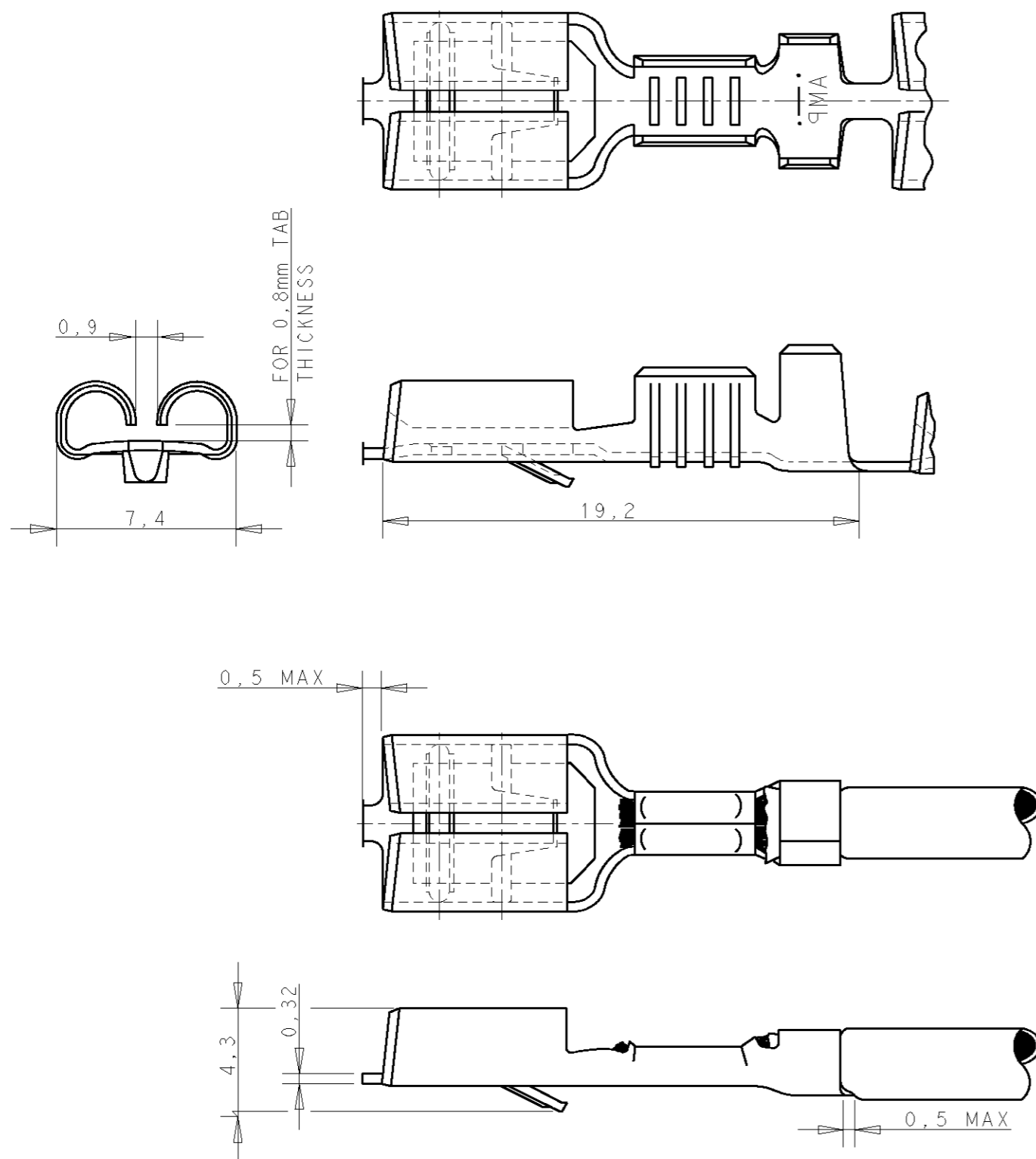

NOTES

- 1 FOR USE ON MINIATURE APPLICATORS ( LEFT-RIGHT FEED ) AND STANDARD APPLICATORS ( RIGHT-LEFT FEED ).
- 2. REELED WITH PAPER AND PAPER COVER.
- 3 OBSOLETE PARTS: OBSOLETE CIS STREAMLINING PER D.RENAUD/D.SINISI

GENERAL TOLERANCES ±0.3

NOTES	FINISH	MATERIAL	PARTNUMBER
3 OBSOLETE	1 PRE-TINPLATED	PH.BRONZE	<del>6-160927-8</del>
	1 PRE-TINPLATED	BRASS	<del>6-160927-7</del>
	1 TINPLATED	PH.BRONZE	160927-4
	1 UNPLATED	PH.BRONZE	160927-3
	1 TINPLATED	BRASS	160927-2
	1 UNPLATED	BRASS	160927-1

CUSTOMER DRAWING

FOR REFERENCE ONLY  
WILL NOT BE UPDATED

**STE** TE Connectivity

~~THIS DRAWING IS UNPUBLISHED~~ RELEASED FOR PUBLICATION jan , 1988

DR.	DATE	WIRE RANGE	NAME	REV. DATE
R.v.Lokven	26.01.88	>1,0-2,5 mm <sup>2</sup>	.250 SRS FASTIN-ON RECEPTACLE.	D M Y
CHK. A.B.	DATE 02.02.88	INSUL. RANGE 2,1-3,1 DIA		01 04 11
APP. L.v.Soest	DATE 03.02.88	SIZE A3	SHEET 1 OF 1	REV. LTR. C2

8 7 6 5 4 3 2 1

# Mouser Electronics

Authorized Distributor

Click to View Pricing, Inventory, Delivery & Lifecycle Information:

[TE Connectivity:](#)

[160927-2](#)