

PART NUMBER	REV	FIRST USED	POWER UNIT	FEED TYPE	DESCRIPTION
1852233-1	A	122500-1	LEADMAKER	POST FEED	CUTS CARRIER
1852233-2	A	565435-5	BENCH MODEL K	PRE FEED	CUTS CARRIER
1852233-3	A	354500-1	BENCH MODEL G	PRE FEED	CUTS CARRIER
1852233-6	A	122500-1	LEADMAKER	POST FEED	CONTINUOUS CARRIER
7-1852233-7	A	-	-	-	SPARE PARTS

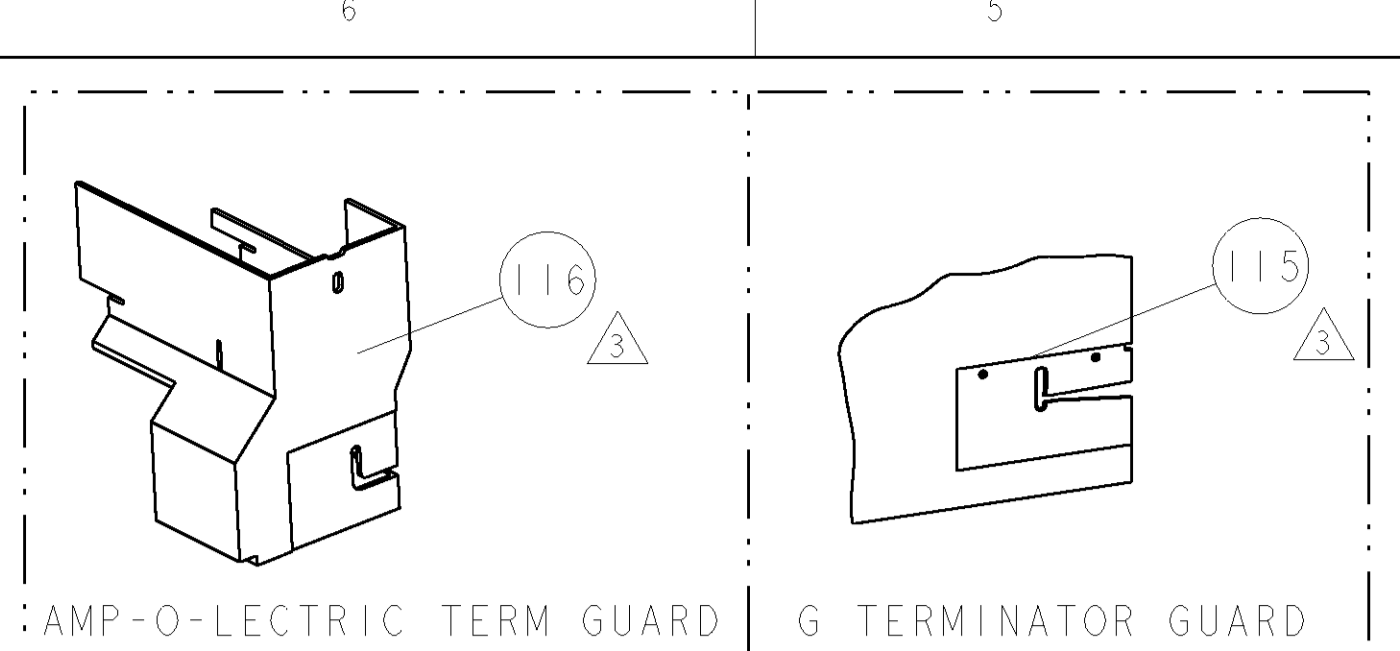

TERMINAL NAME: RECEPTACLE TERMINAL					
TYCO PN	MANUF PN	LEAR TERMINAL - AMP CRIMP SPECS			
1949009-1	771416-HK200	REF SET	CRIMP HEIGHT		WIRE SIZE
1949009-2	771416-FK200	A	.083±.002[2.10±0.05mm]		14 AWG
-	-	B	.074±.002[1.87±0.05mm]		16 AWG
-	-	C	-		-
-	-	D	-		-
-	-	CRIMP	SIZE	TYPE	RANGE
-	-	WIRE	.110 [2.79mm]	F	16-14 AWG
-	-	INSUL	.120 [3.05mm]	F	∅.120 MAX
WIRE STRIP LENGTH	TERM APPL SPEC	FEED	APPL INSTRUCTIONS	SET UP GAGE	
.187 - .202	NONE	.735	408-8040	458637-1	

LOC	DIST	REV	DESCRIPTION	DATE	BY	APPV
A	66					
		A	RELEASED	24APR2006	MEH	GB
		A1	ECR-07-012908	31MAY2007	MY	TE

- △ RECOMMENDED SPARE PARTS
- △ GREASE LIGHTLY
- △ GUARD MUST BE IN PLACE WHEN OPERATING APPLICATOR IN A BENCH MACHINE

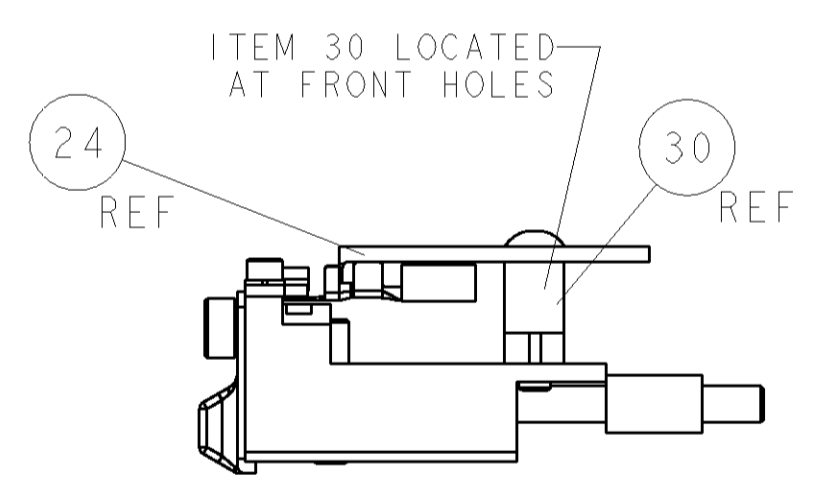
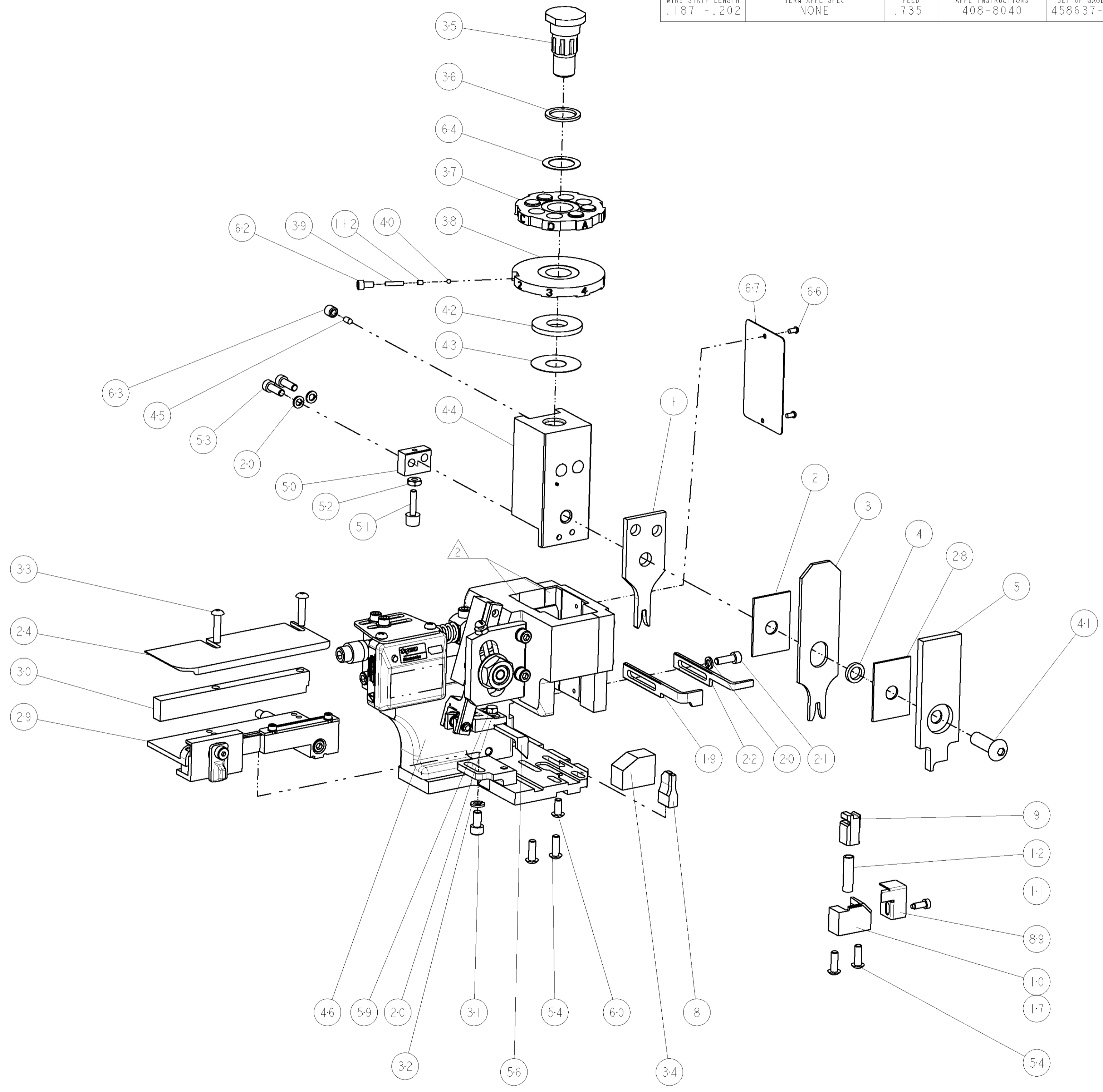
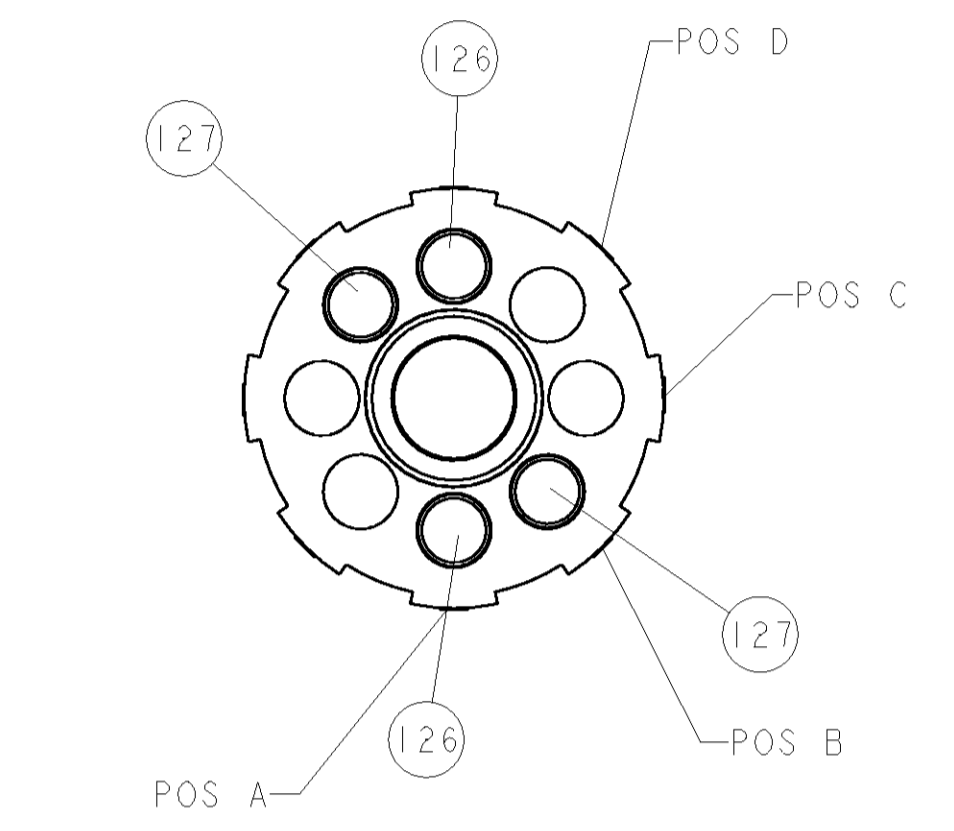

FEED TRACK POSITION

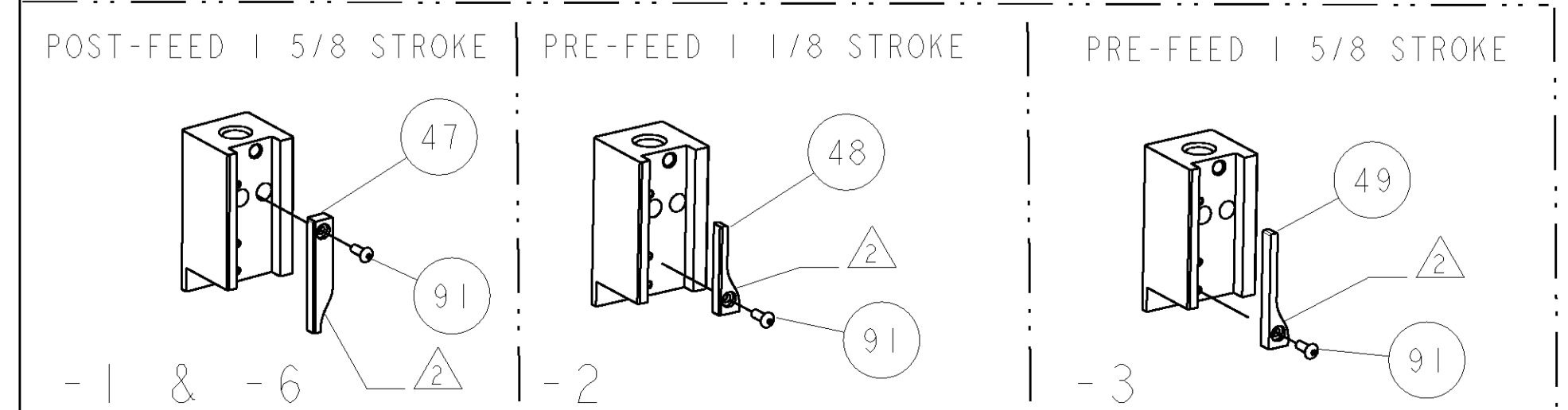
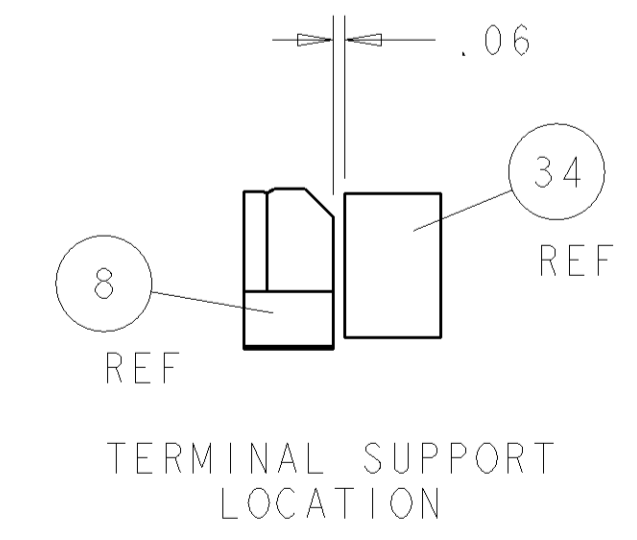

QTY	REV	DESCRIPTION	DATE	BY	APPV	ITEM NO			
-	2	2	2	2	-	1949009-1	-		
-	2	2	2	2	-	7-354778-6	PIN, WIRE DISC, .2875		127
-	2	2	2	2	-	5-354778-8	PIN, WIRE DISC, .2785		126
-	-	-	REF	-	-	455749-1	GUARD WINDOW		116
-	-	REF	-	-	-	679532-1	INSERT, GUARD		115
-	1	1	1	1	-	690603-1	SPRING ASSIST AMP-O-MATOR APPLICATOR		112
-	1	1	1	1	-	1-21002-7	SCR, BTN SKT HD CAP 6-32 X .375		91
-	1	1	1	1	-	318563-1	GUARD, FRONT CHIP		89
-	1	1	1	1	-	4088040	SF APPL INST 408-8040		72
-	1	1	1	1	-	217238-1	GENERAL INSTRUCTION PKG		71
-	1	1	1	1	-	461264-1	PLATE, IDENTIFICATION		67
-	2	2	2	2	-	21017-2	SCREW, DRIVE		66
-	1	1	1	1	-	986950-1	WASHER, FLAT PRECISION		64
-	1	1	1	1	-	21009-2	SCR, SET, SELF LOCKING 1/4-20 X .250		63
-	1	1	1	1	-	23030-1	SCR, SKT HD CAP 6-32 X .25		62
-	1	1	1	1	-	22733-8	SCR, BHSC, SELF-LOCKING, 8-32 X .375		60
-	1	1	1	1	-	2-22603-0	SCR, HEX HD CAP 8-32 X .312		59
-	1	1	1	1	-	458537-2	PAWL, FEED		56
-	4	4	4	4	-	2-21002-2	SCR, BTN SKT HD CAP 8-32 X .500		54
-	2	2	2	2	-	2-21000-7	SCR, SKT HD CAP 8-32 X .500		53
-	1	1	1	1	-	21018-5	NUT, HEX, REG 6-32		52
-	1	1	1	1	-	811242-2	BUMPER, HOLD DOWN		51
-	1	1	1	1	-	690753-1	SPACER, TONKER		50
-	-	1	-	-	-	690602-6	CAM, PRE FEED, 1 5/8		49
-	1	-	-	1	-	690501-4	CAM, POST FEED, 1 5/8		47
-	1	1	1	1	-	459456-1	APPL. BASIC SUB ASSY (SIDE WISE MOCA)		46
-	1	1	1	1	-	690191-1	PLUG, NYLON		45
-	1	1	1	1	-	455673-1	RAM, SIDE FEED		44
-	1	1	1	1	-	690125-1	SHIM SUB-ASSY		43
-	1	1	1	1	-	690124-1	WASHER, RAM (.115)		42
-	1	1	1	1	-	7-21002-9	SCR, BTN SKT HD CAP 5/16-24 X 1.00		41
-	1	1	1	1	-	23241-6	BALL, STEEL		40
-	1	1	1	1	-	690170-1	SPRING, COMPRESSION		39
-	1	1	1	1	-	690142-1	DISC, INSULATION		38
-	1	1	1	1	-	354777-1	WIRE DISC, ASSEMBLY		37
-	1	1	1	1	-	22480-5	SPRING, COMPRESSION		36
-	1	1	1	1	-	690212-1	POST, RAM		35
-	1	1	1	1	-	690786-6	TERMINAL SUPPORT		34
-	2	2	2	2	-	2-21002-4	SCR, BTN SKT HD CAP 8-32 X .750		33
-	1	1	1	1	-	21024-5	WASHER, SPRG LOCK, REG NO 10		32
-	1	1	1	1	-	3-21000-4	SCR, SKT HD CAP 10-32 X .375		31
-	1	1	1	1	-	1320908-2	SPACER, STRIP GUIDE		30
-	1	1	1	1	-	1633091-2	ASSEMBLY, STRIP GUIDE		29
-	1	1	1	1	-	1-455888-0	SPACER, CRIMPER		28
-	1	1	1	1	-	1320928-3	PLATE, STRIP GUIDE		24
-	1	-	-	1	-	690472-2	STRIPPER		22
-	1	1	1	1	-	2-21000-7	SCR, SKT HD CAP 8-32 X .500		21
-	4	4	4	4	-	21024-4	WASHER, SPRG LOCK, REG NO 8		20
-	-	1	1	-	-	691353-1	STRIPPER		19
-	1	-	-	-	-	679625-1	SHEAR HOLDER, FRONT (NO CUT)		17
-	1	1	1	1	-	3-22280-3	SPRING, COMPRESSION		12
-	1	1	1	1	-	690461-1	STOP, SHEAR		11
-	-	1	1	1	-	690459-1	SHEAR HOLDER, FRONT		10
-	1	1	1	1	-	1-454276-9	FLOATING SHEAR, FRONT		9
-	1	1	1	1	-	1633112-3	ANVIL, COMBINATION .110		8
-	1	1	1	1	-	1-455889-4	DEPRESSOR, SHEAR		5
-	1	1	1	1	-	1-238011-7	BLOCK, CRIMPER SPACER		4
-	1	1	1	1	-	1-456134-0	CRIMPER, INSULATION F PREMIUM		3
-	1	1	1	1	-	1-455888-1	SPACER, CRIMPER		2
-	1	1	1	1	-	456408-6	CRIMPER, WIRE PREMIUM		1

DIMENSIONS:		TOLERANCES UNLESS OTHERWISE SPECIFIED:		MATERIAL:		FINISH:	
INCHES		0 PLC	±				
		1 PLC	±0.1				
		2 PLC	±0.01				
		3 PLC	±0.001				
		4 PLC	±0.0001				
		ANGLES	±0.0001				

DATE	07APR2006	BY	M. HERR	APPV	T. ERLIN
DATE	07APR2006	BY	M. HERR	APPV	T. ERLIN
DATE	07APR2006	BY	T. ERLIN	APPV	T. ERLIN

PRODUCT SPEC	SIDE FEED HDM APPLICATOR	
APPLICATION SPEC		
WEIGHT	00779	SCALE 3:5
CUSTOMER DRAWING	00779	SHEET 1 OF 1

Mouser Electronics

Authorized Distributor

Click to View Pricing, Inventory, Delivery & Lifecycle Information:

[TE Connectivity:](#)

[1852233-6](#)