

## Dimensions: mm (In.)

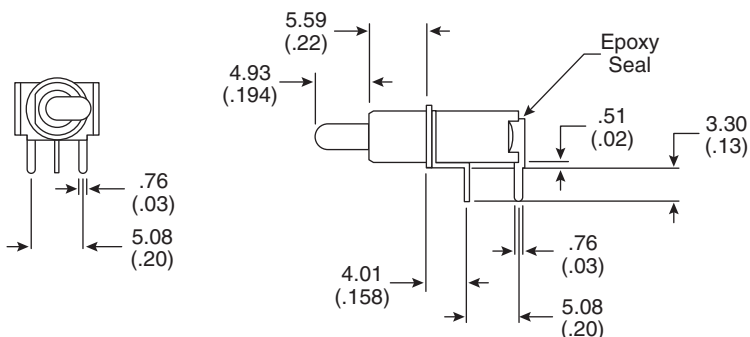

## Switch Function

POS.1	POS.2	POS.3
ON	OFF	ON
2-3	OPEN	2-1

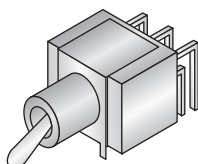
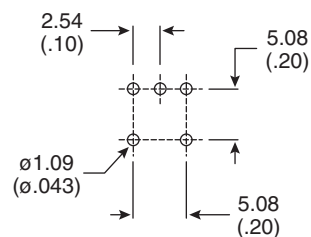
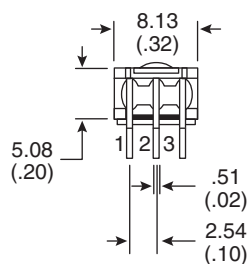

## P.C. Mounting

## Electrical Specifications:

- Electrical Life: 30,000 make-and-break cycles at full load
- Contact Resistance: 20mΩ max. initial @ 2-4VDC 100mA
- Insulation Resistance: 1,000MΩ min.
- Dielectric Strength: 1,000 V RMS@ sea level.
- Rating:
  - 1A/250 VAC
  - 3A/120 VAC or 28 VDC

## Materials:

- Case: Diallyl phthalate (DAP)
- Acuator: Brass, chrome plated.
- Bushing: Brass, nickel plated.
- Housing: Stainless steel.
- Terminals/Contact: Brass, with silver plate
- Switch Support: Brass, Tin plated.

## Mechanical Specifications:

- Operating Temperature: -30° C to +85° C.

## Note:

- RoHS compliant by exemption

**Toggle Switch**  
108-2MS3T2B2M6QE-EVX

**Mountain**  
**Switch**

# Mouser Electronics

Authorized Distributor

Click to View Pricing, Inventory, Delivery & Lifecycle Information:

Mountain Switch:

[108-2MS3T2B2M6QE-EVX](#)