

PRODUCT DATA DRAWING

| REVISION HISTORY | | | |
|------------------|----------------|----------|----------|
| REV | DESCRIPTION | DATE | APPROVED |
| C | REV. DCN 42568 | 08/08/16 | STW |
| | | | |

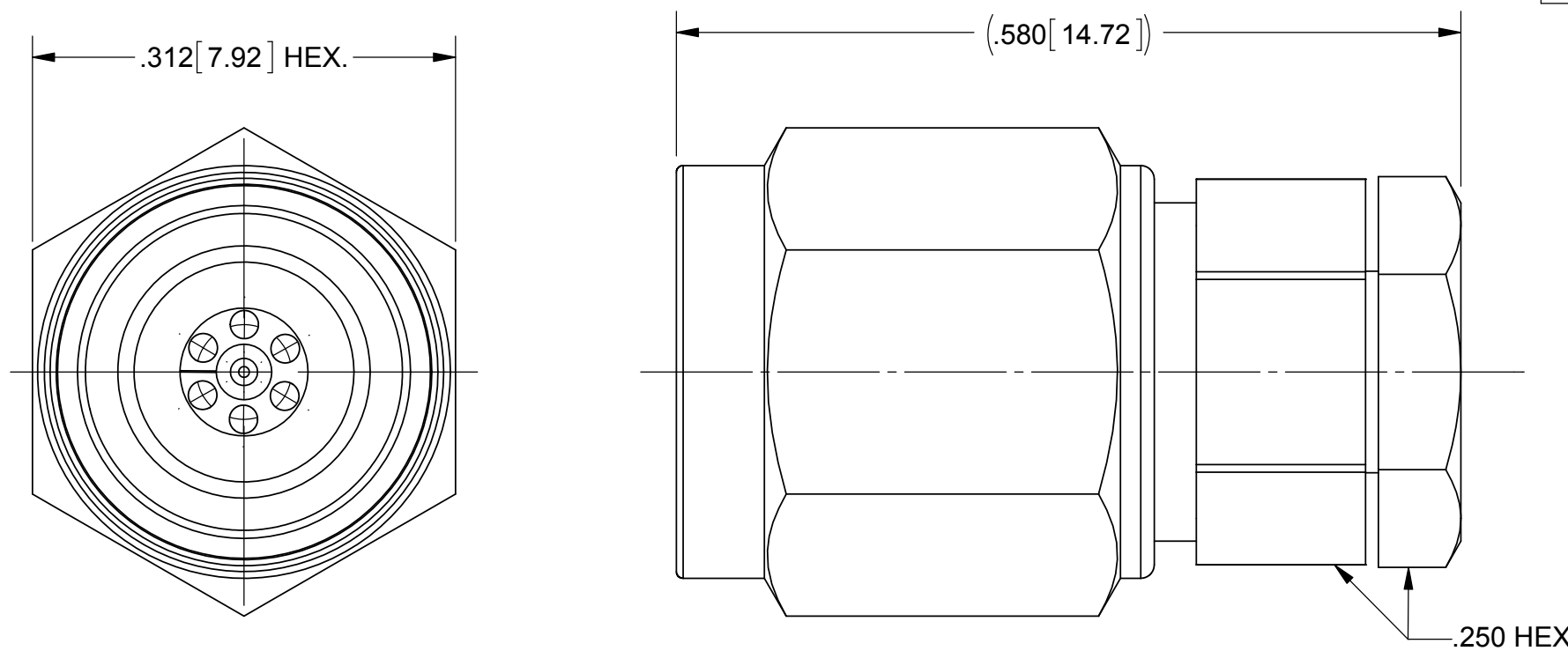

MATERIAL:
 BODY, FERRULE
 CLAMP NUT, SLEEVE
 & COUPLING NUT:

STAINLESS STEEL PER AMS 5640, ALLOY No. UNS S30300, TYPE 1,
 OR ASTM A582, TYPE 303, CONDITION A.

**LOCK RING &
 CONTACT:**

BERYLLIUM COPPER PER ASTM B196, ALLOY No. UNS C17300, TD04

BEAD:

POLYETHERIMIDE (ULTEM 1000) PER ASTM D5205

INSULATOR:

PTFE PER ASTM D1710, TYPE I, GRADE 1, CLASS B

GASKET:

SILICONE RUBBER PER A-A-59588, CLASS 2B, GRADE 50/60

FINISH:
 BODY, SLEEVE
 CLAMP NUT &
 COUPLING NUT:

PASSIVATED PER AMS 2700.

**CONTACT &
 FERRULE:**

GOLD PER ASTM B 488, TYPE II, CODE C, CLASS 1.27,
 OVER NICKEL PER AMS-QQ-N-290, CLASS 1, .00005" MIN.

PERFORMANCE:
IMPEDANCE:
FREQ. RANGE:
VSWR:
INS. LOSS:

50 OHMS
 DC TO 50 GHz
 1.35:1 DC TO 50 GHz
 .05 X SQRTF (F IN GHz)

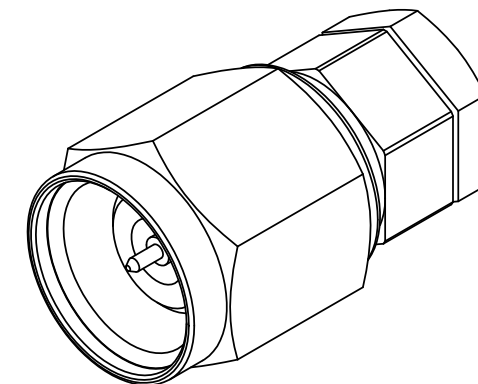

| | | | |
|---|--|---|---|
| MATERIAL: SEE NOTES | DIMENSIONS ARE IN INCHES TOLERANCES: FRACTIONAL: ±1/64 ANGULAR: X° ±1'0" X'X' ±15' | UNLESS OTHERWISE SPECIFIED 1) ALL DIMENSIONS ARE IN INCHES (MILLIMETERS) 2) ALL DIMENSIONS ARE AFTER PLATING. 3) BREAK CORNERS & EDGES .005 R. MAX. 4) CHAM. 1ST & LAST THREADS. 5) SURFACE ROUGHNESS 63-MIL-STD-10. 6) DIA. 'S ON COMMON CENTERS TO BE CONCENTRIC WITHIN .005 T.I.R. 7) REMOVE ALL BURRS | 2400 Centrepark West Drive, Suite 100 West Palm Beach, FL 33409 TITLE: 2.4mm STRAIGHT PLUG FOR Ø.085 CABLE |
| FINISH: SEE NOTES | DECIMAL: X ±.030 .XX ±.010 .XXX ±.005 | INTERPRET DIMENSIONS AND TOLERANCES PER ASME Y14.5M - 1994 | |
| SURFACE AREA: N/A | THIRD ANGLE PROJECTION | DRAWN: FED 02/15/12 | SIZE: B CAGE CODE: 95077 DWG. NO. SF1611-60003 |
| PROPRIETARY THE INFORMATION CONTAINED IN THIS DRAWING IS THE SOLE PROPERTY OF SV MICROWAVE, INC. ANY REPRODUCTION IN PART OR AS A WHOLE WITHOUT THE WRITTEN PERMISSION OF SV MICROWAVE, INC IS PROHIBITED. | | CHECKED: STW 07/28/15 | SCALE: 8:1 |
| | | APPROVED: STW 07/28/15 | SHEET 1 OF 1 |