

## Housing - DFK-PC 6-16/ 9-G-10,16 - 1701524

Please be informed that the data shown in this PDF Document is generated from our Online Catalog. Please find the complete data in the user's documentation. Our General Terms of Use for Downloads are valid (<http://phoenixcontact.com/download>)

Header, Nominal current: 76 A, Rated voltage (III/2): 1000 V, Number of positions: 9, Pitch: 10.16 mm, Color: green, Contact surface: Silver, Mounting: Wave soldering



The figure shows a 5-pos. version of the product

### Product Features

- Panel thickness of 1 mm to 3 mm
- Mounted on the housing panel by means of tool-free snap-lock mechanism or conventional screw connection
- For soldering onto the PCB
- Feed-through headers for use in combination with all PC 6 and PC 16 plugs

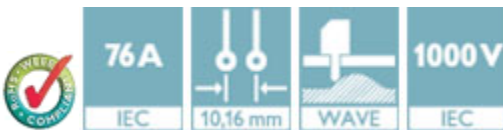

### Key Commercial Data

|                                      |          |
|--------------------------------------|----------|
| Packing unit                         | 1 pc     |
| Minimum order quantity               | 10 pc    |
| Weight per Piece (excluding packing) | 46.33 g  |
| Custom tariff number                 | 85366990 |
| Country of origin                    | Poland   |

### Technical data

#### Dimensions

|                          |              |
|--------------------------|--------------|
| Length                   | 34 mm        |
| Pitch                    | 10.16 mm     |
| Dimension a              | 81.28 mm     |
| Constructional height    | 19 mm        |
| Length of the solder pin | 4.1 mm       |
| Pin dimensions           | 1,0 x 1,2 mm |
| Pin spacing              | 10.16 mm     |

# Housing - DFK-PC 6-16/ 9-G-10,16 - 1701524

## Technical data

### Dimensions

|               |        |
|---------------|--------|
| Hole diameter | 1.7 mm |
|---------------|--------|

### General

|  |                  |
|--|------------------|
| Range of articles                      | DFK-PC 6-16/..-G |
| Insulating material group              | I                |
| Rated surge voltage (III/3)            | 8 kV             |
| Rated surge voltage (III/2)            | 8 kV             |
| Rated surge voltage (II/2)             | 6 kV             |
| Rated voltage (III/3)                  | 1000 V           |
| Rated voltage (III/2)                  | 1000 V           |
| Rated voltage (II/2)                   | 1000 V           |
| Connection in acc. with standard       | EN-VDE           |
| Nominal current $I_N$                  | 76 A             |
| Maximum load current                   | 76 A             |
| Insulating material                    | PA               |
| Flammability rating according to UL 94 | V0               |
| Color                                  | green            |
| Number of positions                    | 9                |

### Standards and Regulations

|  |        |
|--|--------|
| Connection in acc. with standard       | EN-VDE |
|  | CUL    |
| Flammability rating according to UL 94 | V0     |

### Classifications

#### eCl@ss

|            |          |
|------------|----------|
| eCl@ss 4.0 | 272607xx |
| eCl@ss 4.1 | 27260701 |
| eCl@ss 5.0 | 27260701 |
| eCl@ss 5.1 | 27141190 |
| eCl@ss 6.0 | 27260704 |
| eCl@ss 7.0 | 27440402 |
| eCl@ss 8.0 | 27440402 |
| eCl@ss 9.0 | 27440402 |

#### ETIM

|          |          |
|----------|----------|
| ETIM 3.0 | EC001121 |
|----------|----------|

# Housing - DFK-PC 6-16/ 9-G-10,16 - 1701524

## Classifications

### ETIM

|          |          |
|----------|----------|
| ETIM 4.0 | EC002637 |
| ETIM 5.0 | EC002637 |

### UNSPSC

|               |          |
|---------------|----------|
| UNSPSC 6.01   | 30211810 |
| UNSPSC 7.0901 | 39121409 |
| UNSPSC 11     | 39121409 |
| UNSPSC 12.01  | 39121409 |
| UNSPSC 13.2   | 39121409 |

## Approvals

### Approvals

#### Approvals

UL Recognized / SEV / cUL Recognized / EAC / IECCE CB Scheme / EAC / cULus Recognized

#### Ex Approvals

#### Approvals submitted

## Approval details

|   |       |       |       |
|---|-------|-------|-------|
| UL Recognized  |       |       |       |
|   | B     | C     | D     |
| Nominal current IN  | 66 A  | 66 A  | 5 A   |
| Nominal voltage UN  | 300 V | 300 V | 600 V |

|                    |        |
|--------------------|--------|
| SEV                |        |
| Nominal current IN | 76 A   |
| Nominal voltage UN | 1000 V |

# Housing - DFK-PC 6-16/ 9-G-10,16 - 1701524

## Approvals

|                                |       |       |       |
|--------------------------------|-------|-------|-------|
| cUL Recognized                 |       |       |       |
|                                | B     | C     | D     |
| Nominal current I <sub>N</sub> | 66 A  | 66 A  | 5 A   |
| Nominal voltage U <sub>N</sub> | 300 V | 300 V | 600 V |

EAC

|                                |        |
|--------------------------------|--------|
| IECEE CB Scheme                |        |
| Nominal current I <sub>N</sub> | 76 A   |
| Nominal voltage U <sub>N</sub> | 1000 V |

EAC

cULus Recognized

## Accessories

Accessories

Coding element

Coding profile - CP-PC RD - 1701967

Coding profile, for plugging into the coding ribs of the plug at a later date, insulating material, color: Red



## Housing - DFK-PC 6-16/ 9-G-10,16 - 1701524

### Accessories

Accessories - CS-IPC 16/ 6 - 1970016



Coding pin, serves to ensure correct polarization on the PCB during manual mounting

---

### Mounting material

Accessories - DFK-PC 16-SS - 1705449



Screw set for DFK-PC 16... connectors

---

### Screwdriver tools

Screwdriver - SZK PH1 VDE - 1205150



Screwdriver, PH crosshead, VDE insulated, size: PH 1 x 80 mm, 2-component grip, with non-slip grip

Screwdriver - SZS 0,6X2,5 VDE - 1205040



Screwdriver, slot-headed, VDE insulated, size: 0.6 x 2.5 x 80 mm, 2-component grip, with non-slip grip

---

### Additional products

# Housing - DFK-PC 6-16/ 9-G-10,16 - 1701524

## Accessories

Printed-circuit board connector - PC 16/ 9-ST-10,16 - 1967443



Plug component, Nominal current: 76 A, Rated voltage (III/2): 1000 V, Number of positions: 9, Pitch: 10.16 mm, Connection method: Screw connection with tension sleeve, Color: green, Contact surface: Silver

Printed-circuit board connector - TPC 16/ 9-ST-10,16 - 1715248



Plug component, Nominal current: 76 A, Rated voltage (III/2): 1000 V, Number of positions: 9, Pitch: 10.16 mm, Connection method: Screw connection with tension sleeve, Color: green, Contact surface: Silver

Plug - SPC 16/ 9-ST-10,16 - 1711336



Plug component, Nominal current: 76 A, Rated voltage (III/2): 1000 V, Number of positions: 9, Pitch: 10.16 mm, Connection method: Push-in spring connection, Color: green, Contact surface: Silver

## Drawings

Drilling diagram

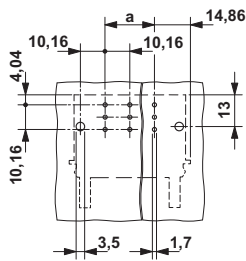

Diagram

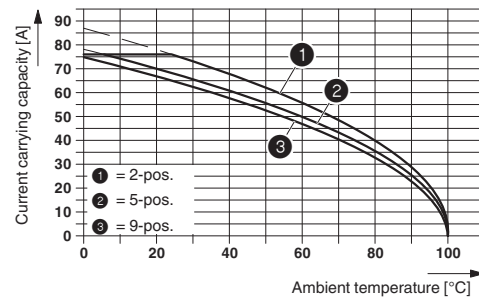
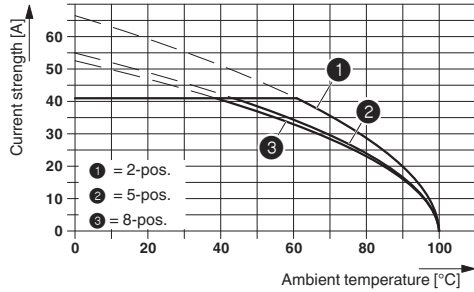

Illustration shows the derating curve for plugs PC 16/...-ST-10,16 in combination with header DFK-PC 6-16/...-G-10,16.

# Housing - DFK-PC 6-16/ 9-G-10,16 - 1701524

Diagram



Dimensional drawing

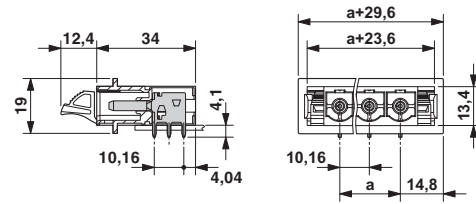
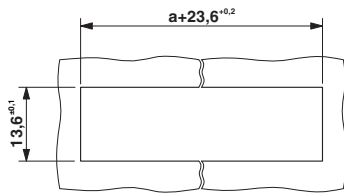

Illustration shows the derating curve for plugs PC 6/...-ST-10,16 in combination with header DFK-PC 6-16/...-G-10,16.

Dimensional drawing



Sheet metal cutout for snap-on.

Dimensional drawing

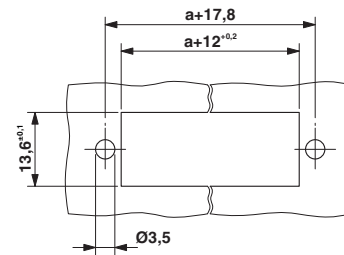

Sheet metal cutout for screw connection.

# Mouser Electronics

Authorized Distributor

Click to View Pricing, Inventory, Delivery & Lifecycle Information:

[Phoenix Contact:](#)

[1701524](#)