



00-9176-00X-7XX-XX6

PREFIX

SERIES

NO. OF WAYS

CODE	NO. OF WAYS
001	1
002	2
003	3

WIRE GAUGE SIZE

CODE	DESCRIPTION	ACCEPTED WIRE GAUGE	WIRE INSULATION
701	CAPPED-IDC CONNECTOR	18 AWG STRANDED	Ø 1.6-2.1
711		20 AWG STRANDED	Ø 1.6-2.1
722		22 AWG STRANDED	Ø 1.1-1.6
732		24 AWG STRANDED	Ø 1.1-1.6

Elco Europe (A Division of AVX Ltd) CONFIDENTIAL PROPRIETY  
The document on this print and information therewith are PROPRIETY  
to Elco Europe (A Division of AVX Ltd) and shall not be copied  
or disclosed in whole or in part without Elco Europe's written consent.

COLOUR OPTION

CODE	INSULATOR COLOUR	AVAILABILITY
0	BLACK	SPECIAL ORDER
1	WHITE	STANDARD

CAP OPTIONS

CODE	CAP OPTION	DESCRIPTION	DETAILS
0	THROUGH WIRE	ALLOWS WIRE TO BE TERMINATED AT ANY POINT	REFER TO SHEETS 2 TO 4
9	WIRE STOP	TERMINATES END OF WIRE END PROTECTED BY STOP FACE	REFER TO SHEETS 5 TO 7

PLATING OPTION

CODE	DESCRIPTION
6	PURE TIN ALL OVER

AVX

CONTROLLED RELEASE

ELCO EUROPE (A DIVISION OF AVX LTD.) CONFIDENTIAL PROPRIETARY  
THE DRAWING ON THIS PRINT AND INFORMATION THEREWITH ARE PROPRIETARY TO ELCO EUROPE (A DIVISION OF AVX LTD.) AND SHALL NOT BE USED OR DISCLOSED IN WHOLE OR IN PART WITHOUT ELCO EUROPE'S WRITTEN CONSENT.

SHEET 1 OF 8

Release No.  
History  
102847  
04.05.2012  
18.05.2012  
20.08.2012

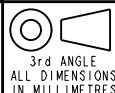

ELCO

© COPYRIGHT ELCO EUROPE  
NOT TO BE DISCLOSED OR COPIED  
WITHOUT WRITTEN PERMISSION

Drawn N.C.H.	Description 18-24AWG IDC WIRE TO BOARD CONNECTOR	DATE 04-Apr-12
Size CV	Part Number 00-9176-01_700S	Issue C

A

B



**18-24 AWG 1 WAY IDC CONNECTOR  
THROUGH WIRE CAPPED IDC**

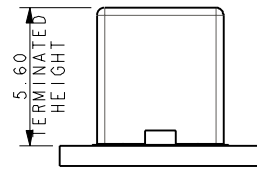
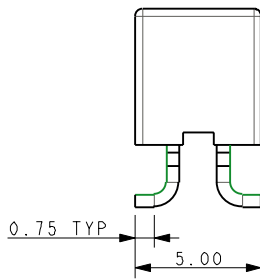
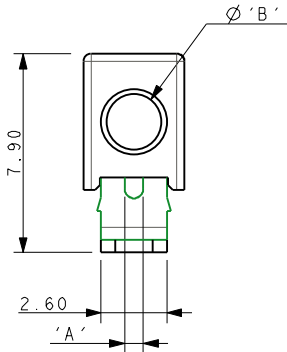
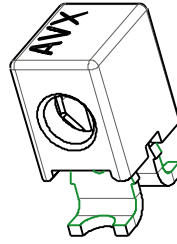
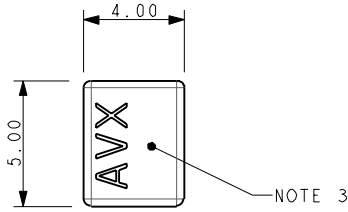

**MOUNTED ON PCB**

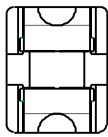

CODE	WIRE GAUGE	'A'	WIRE INSULATION	'B'
701	18AWG STRANDED	0.74	Ø 1.6-2.1	2.1
711	20AWG STRANDED	0.60	Ø 1.6-2.1	2.1
722	22AWG STRANDED	0.47	Ø 1.1-1.6	1.6
732	24AWG STRANDED	0.37	Ø 1.1-1.6	1.6

**Elco Europe (A Division of AVX Ltd) CONFIDENTIAL PROPRIETY**  
**The document on this print and information therewith are PROPRIETY**  
**to Elco Europe (A Division of AVX Ltd) and shall not be copied**  
**or disclosed in whole or in part without Elco Europe's written consent.**

**PACKING NOTES**

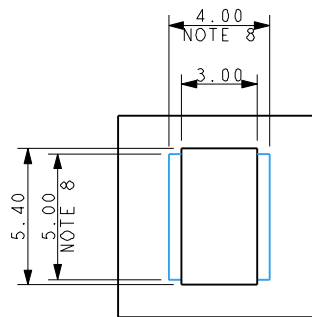
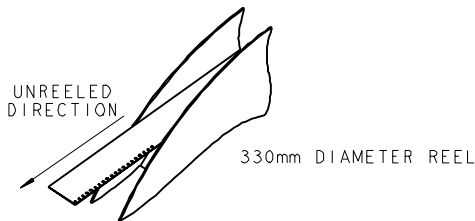

**SUGGESTED PCB LAYOUT**

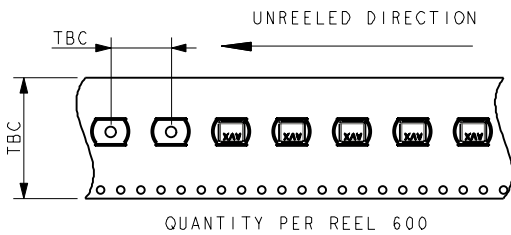

QUANTITY PER REEL 600

**NOTES :-**

1. 1 WAY CONNECTOR FOR IDC WIRE TO BOARD CONNECTION, PRE ASSEMBLED THROUGH WIRE CAP, CODE REFER TO SHEET 1.
2. CONTACT/CAP TO MATCH 18-24AWG STRANDED WIRE, INSULATION DIAMETER RANGE AS IN TABLE.
3. FLAT FACE ON TOP OF CAP TO AID PICK AND PLACE ASSEMBLY.
4. FOR FULL DETAILS REFER TO ELCO SPECIFICATION 201-01-138.
5. ASSEMBLY PROCEDURE, REFER TO APPLICATION NOTES 201-01-140.
6. GENERAL TOLERANCE ±0.20 UNLESS STATED.
7. PACKED IN TAPE AND REEL, QUANTITY PER REEL 600.
8. CONNECTOR OUTLINE.
9. CONTACT MATERIAL :- TIN PLATED COPPER ALLOY.
10. INSULATION MATERIAL, HIGH TEMPERATURE NYLON, GLASS FILLED. UL94 V-0, COLOUR REFER TO SHEET 1.
11. GENERAL TOLERANCE ±0.20 UNLESS STATED.

FORM-106-01-056-6 ISS 7

ELCO EUROPE (A DIVISION OF AVX LTD.) CONFIDENTIAL PROPRIETY  
 THE DRAWING ON THIS PRINT AND INFORMATION THEREWITH ARE PROPRIETARY TO ELCO EUROPE (A DIVISION OF AVX LTD.) AND SHALL NOT BE USED OR DISCLOSED IN WHOLE OR IN PART WITHOUT ELCO EUROPE'S WRITTEN CONSENT.

SHEET 2 OF 8

Release No. 102847	History 04.05.2012 18.05.2012 20.08.2012
-----------------------	---

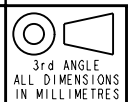

**ELCO**  
 © COPYRIGHT ELCO EUROPE  
 NOT TO BE DISCLOSED OR COPIED  
 WITHOUT WRITTEN PERMISSION

Drawn N.C.H.	Description 18-24AWG IDC WIRE TO BOARD CONNECTOR	DATE 04-Apr-12
Size CV	Part Number 00-9176-01_700S	Issue C

A

B



**18-24 AWG 2 WAY IDC CONNECTOR  
THROUGH WIRE CAPPED IDC**

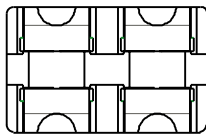
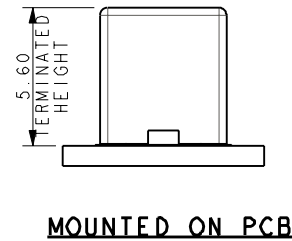
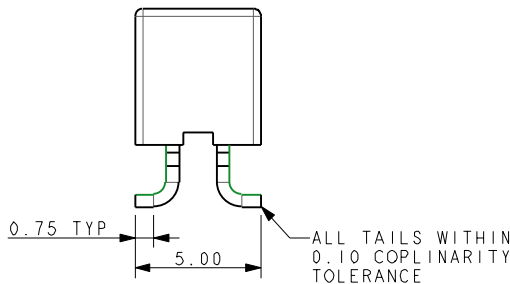
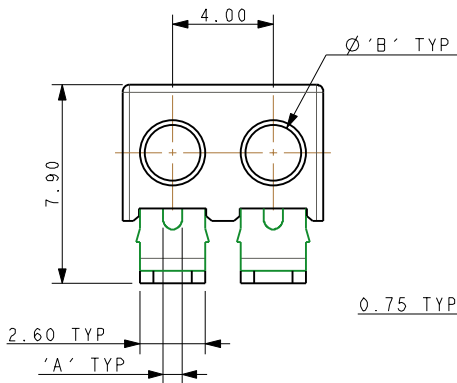
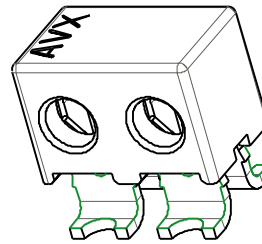
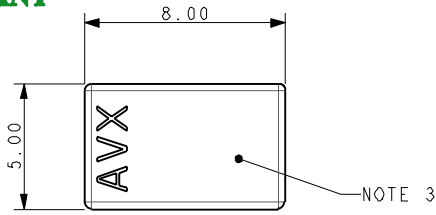

CODE	WIRE GAUGE	'A'	WIRE INSULATION	'B'
701	18AWG STRANDED	0.74	Ø 1.6-2.1	2.1
711	20AWG STRANDED	0.60	Ø 1.6-2.1	2.1
722	22AWG STRANDED	0.47	Ø 1.1-1.6	1.6
732	24AWG STRANDED	0.37	Ø 1.1-1.6	1.6

Elco Europe (A Division of AVX Ltd) CONFIDENTIAL PROPRIETY  
The document on this print and information therewith are PROPRIETY  
to Elco Europe (A Division of AVX Ltd) and shall not be copied  
or disclosed in whole or in part without Elco Europe's written consent.

**PACKING NOTES**

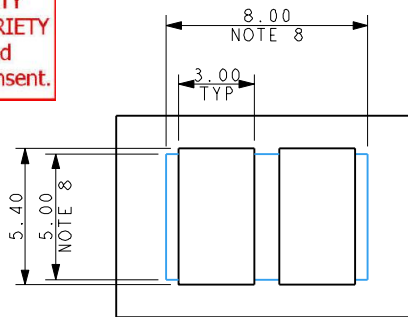
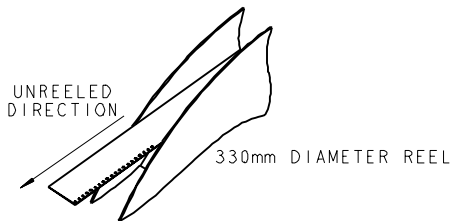

**SUGGESTED PCB LAYOUT**

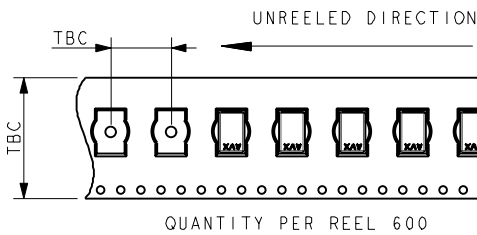

**NOTES :-**

- 2 WAY CONNECTOR FOR IDC WIRE TO BOARD CONNECTION, PRE ASSEMBLED THROUGH WIRE CAP, CODE REFER TO SHEET 1.
- CONTACT/CAP TO MATCH 18-24AWG STRANDED WIRE, INSULATION DIAMETER RANGE AS IN TABLE.
- FLAT FACE ON TOP OF CAP TO AID PICK AND PLACE ASSEMBLY.
- FOR FULL DETAILS REFER TO ELCO SPECIFICATION 201-01-138.
- ASSEMBLY PROCEDURE, REFER TO APPLICATION NOTES 201-01-140.
- GENERAL TOLERANCE ±0.20 UNLESS STATED.
- PACKED IN TAPE AND REEL, QUANTITY PER REEL 600.
- CONNECTOR OUTLINE.
- CONTACT MATERIAL :- TIN PLATED COPPER ALLOY.
- INSULATION MATERIAL, HIGH TEMPERATURE NYLON, GLASS FILLED. UL94 V-0, COLOUR REFER TO SHEET 1.
- GENERAL TOLERANCE ±0.20 UNLESS STATED.

ELCO EUROPE (A DIVISION OF AVX LTD.) CONFIDENTIAL PROPRIETY  
THE DRAWING ON THIS PRINT AND INFORMATION THEREWITH ARE  
PROPRIETARY TO ELCO EUROPE (A DIVISION OF AVX LTD.) AND  
SHALL NOT BE USED OR DISCLOSED IN WHOLE OR IN PART  
WITHOUT ELCO EUROPE'S WRITTEN CONSENT.

SHEET 3 OF 8

FORM-106-01-056-6 ISS 7  
Release No.  
History  
102847  
04.05.2012  
18.05.2012  
20.08.2012

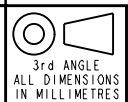

**ELCO**  
© COPYRIGHT ELCO EUROPE  
NOT TO BE DISCLOSED OR COPIED  
WITHOUT WRITTEN PERMISSION

Drawn N.C.H.	Description 18-24AWG IDC WIRE TO BOARD CONNECTOR	DATE 04-Apr-12
Size CV	Part Number 00-9176-01_700S	Issue C

A

B



**18-24 AWG 3 WAY IDC CONNECTOR  
THROUGH WIRE CAPPED IDC**

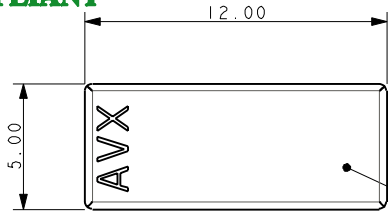

NOTES 3

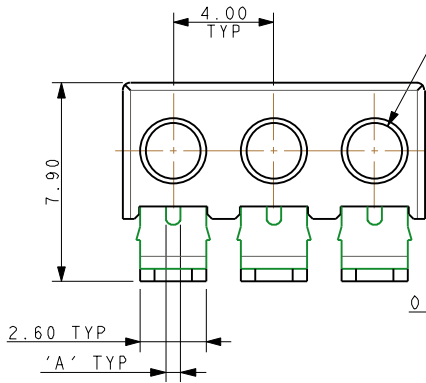
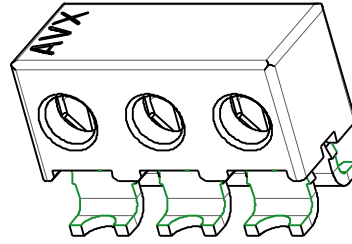

Ø 'B' TYP

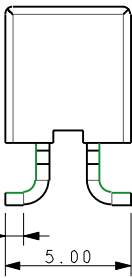

ALL TAILS WITHIN 0.10 COPLANARITY TOLERANCE

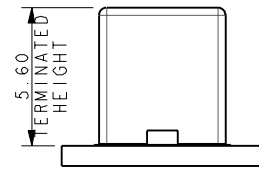

**MOUNTED ON PCB**

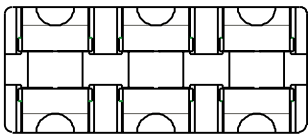

CODE	WIRE GAUGE	'A'	WIRE INSULATION	'B'
701	18AWG STRANDED	0.74	Ø 1.6-2.1	2.1
711	20AWG STRANDED	0.60	Ø 1.6-2.1	2.1
722	22AWG STRANDED	0.47	Ø 1.1-1.6	1.6
732	24AWG STRANDED	0.37	Ø 1.1-1.6	1.6

**Elco Europe (A Division of AVX Ltd) CONFIDENTIAL PROPRIETY**  
**The document on this print and information therewith are PROPRIETY**  
**to Elco Europe (A Division of AVX Ltd) and shall not be copied**  
**or disclosed in whole or in part without Elco Europe's written consent.**

**PACKING NOTES**

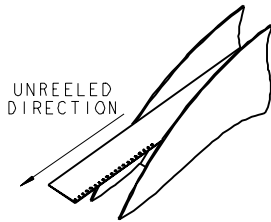

330mm DIAMETER REEL

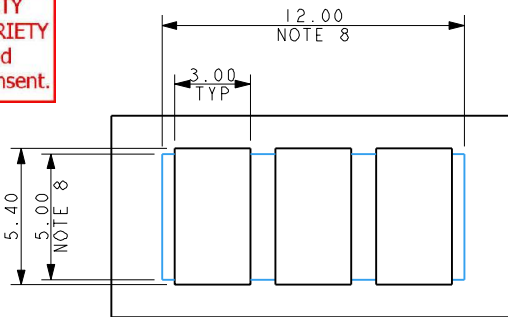

**SUGGESTED PCB LAYOUT**

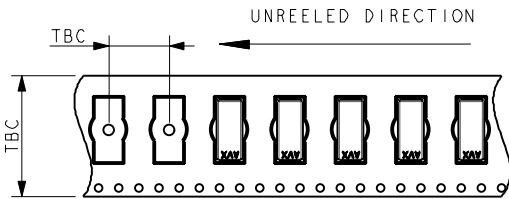

QUANTITY PER REEL 600

**NOTES :-**

- 3 WAY CONNECTOR FOR IDC WIRE TO BOARD CONNECTION, PRE ASSEMBLED THROUGH WIRE CAP, CODE REFER TO SHEET 1.
- CONTACT/CAP TO MATCH 18-24AWG STRANDED WIRE, INSULATION DIAMETER RANGE AS IN TABLE.
- FLAT FACE ON TOP OF CAP TO AID PICK AND PLACE ASSEMBLY.
- FOR FULL DETAILS REFER TO ELCO SPECIFICATION 201-01-138.
- ASSEMBLY PROCEDURE, REFER TO APPLICATION NOTES 201-01-140.
- GENERAL TOLERANCE ±0.20 UNLESS STATED.
- PACKED IN TAPE AND REEL, QUANTITY PER REEL 600.
- CONNECTOR OUTLINE.
- CONTACT MATERIAL :- TIN PLATED COPPER ALLOY.
- INSULATION MATERIAL, HIGH TEMPERATURE NYLON, GLASS FILLED.
- UL94 V-0, COLOUR REFER TO SHEET 1.
- GENERAL TOLERANCE ±0.20 UNLESS STATED.

ELCO EUROPE (A DIVISION OF AVX LTD.) CONFIDENTIAL PROPRIETY  
 THE DRAWING ON THIS PRINT AND INFORMATION THEREWITH ARE PROPRIETARY TO ELCO EUROPE (A DIVISION OF AVX LTD.) AND SHALL NOT BE USED OR DISCLOSED IN WHOLE OR IN PART WITHOUT ELCO EUROPE'S WRITTEN CONSENT.

SHEET 4 OF 8

FORM-106-01-056-6 ISS 7  
 Release No.  
 History  
 102847  
 04.05.2012  
 18.05.2012  
 20.08.2012

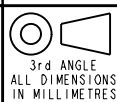

Drawn N.C.H.	Description 18-24AWG IDC WIRE TO BOARD CONNECTOR	DATE 04-Apr-12
Size CV	Part Number 00-9176-01_700S	Issue C

A

B



**18-24 AWG 1 WAY IDC CONNECTOR  
WIRE STOP CAPPED-IDC**

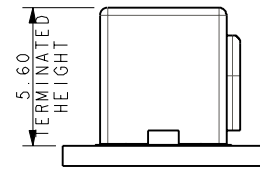
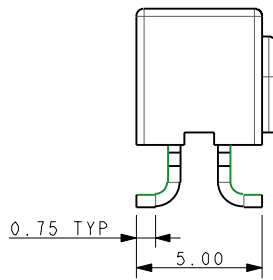
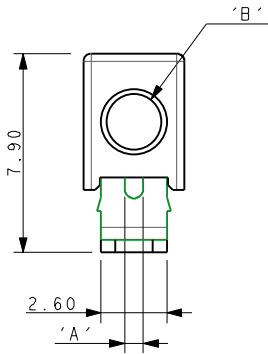
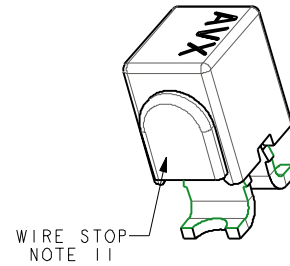
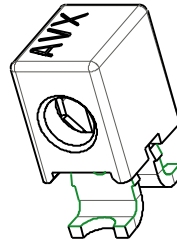
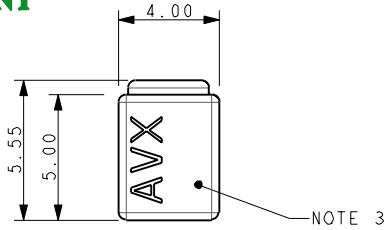

**MOUNTED ON PCB**

CODE	WIRE GAUGE	'A'	WIRE INSULATION	'B'
701	18AWG STRANDED	0.74	Ø 1.6-2.1	2.1
711	20AWG STRANDED	0.60	Ø 1.6-2.1	2.1
722	22AWG STRANDED	0.47	Ø 1.1-1.6	1.6
732	24AWG STRANDED	0.37	Ø 1.1-1.6	1.6

**Elco Europe (A Division of AVX Ltd) CONFIDENTIAL PROPRIETY**  
**The document on this print and information therewith are PROPRIETY**  
**to Elco Europe (A Division of AVX Ltd) and shall not be copied**  
**or disclosed in whole or in part without Elco Europe's written consent.**

**PACKING NOTES**

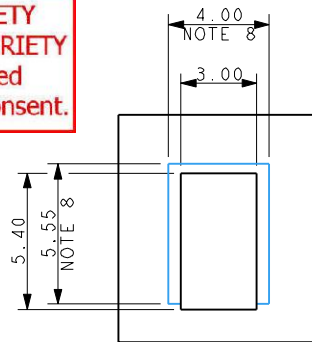
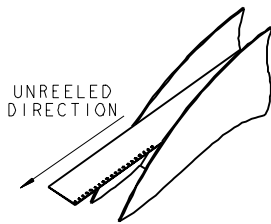

**SUGGESTED PCB LAYOUT**

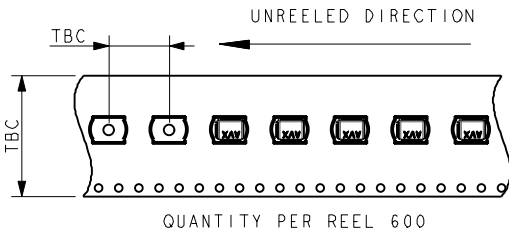

**NOTES :-**

1. 1 WAY CONNECTOR FOR IDC WIRE TO BOARD CONNECTION, PRE ASSEMBLED WIRE STOP CAP, CODE REFER TO SHEET 1.
2. CONTACT/CAP TO MATCH 18-24AWG STRANDED WIRE, INSULATION DIAMETER RANGE AS IN TABLE.
3. FLAT FACE ON TOP OF CAP TO AID PICK AND PLACE ASSEMBLY.
4. FOR FULL DETAILS REFER TO ELCO SPECIFICATION 201-01-138.
5. ASSEMBLY PROCEDURE, REFER TO APPLICATION NOTES 201-01-140.
6. GENERAL TOLERANCE ±0.20 UNLESS STATED.
7. PACKED IN TAPE AND REEL, QUANTITY PER REEL 600.
8. CONNECTOR OUTLINE.
9. CONTACT MATERIAL :- TIN PLATED COPPER ALLOY.
10. INSULATION MATERIAL, HIGH TEMPERATURE NYLON, GLASS FILLED, UL94 V-0, COLOUR REFER TO SHEET 1.
11. WIRE STOP CAP PROTECTS END OF WIRE.
12. GENERAL TOLERANCE ±0.20 UNLESS STATED.

ELCO EUROPE (A DIVISION OF AVX LTD.) CONFIDENTIAL PROPRIETY  
 THE DRAWING ON THIS PRINT AND INFORMATION THERWITH ARE PROPRIETY TO ELCO EUROPE (A DIVISION OF AVX LTD.) AND SHALL NOT BE USED OR DISCLOSED IN WHOLE OR IN PART WITHOUT ELCO EUROPE'S WRITTEN CONSENT.

SHEET 5 OF 8

Release No. 102847	History 04.05.2012 18.05.2012 20.08.2012
-----------------------	---

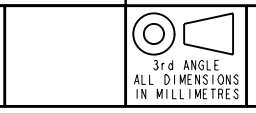

Drawn N.C.H.	Description 18-24AWG IDC WIRE TO BOARD CONNECTOR	DATE 04-Apr-12
Size CV	Part Number 00-9176-01_700S	Issue C

A

B



**18-24 AWG 2 WAY IDC CONNECTOR  
WIRE STOP CAPPED IDC**

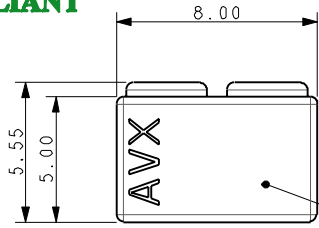

NOTE 3

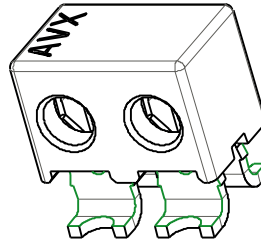

WIRE STOP  
NOTE 11

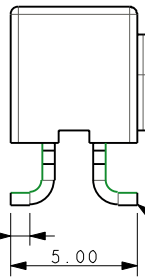
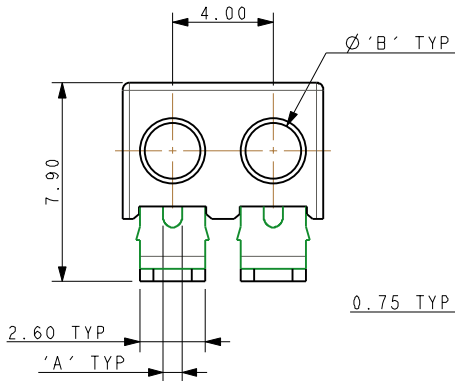
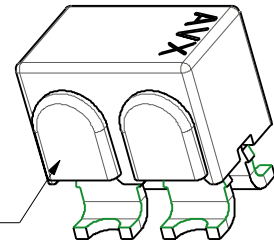

ALL TAILS WITHIN  
0.10 COPLANARITY  
TOLERANCE

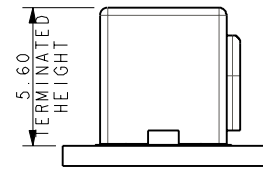

**MOUNTED ON PCB**

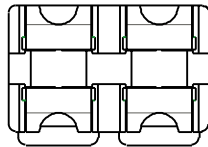

CODE	WIRE GAUGE	'A'	WIRE INSULATION	'B'
701	18AWG STRANDED	0.74	Ø 1.6-2.1	2.1
711	20AWG STRANDED	0.60	Ø 1.6-2.1	2.1
722	22AWG STRANDED	0.47	Ø 1.1-1.6	1.6
732	24AWG STRANDED	0.37	Ø 1.1-1.6	1.6

**Elco Europe (A Division of AVX Ltd) CONFIDENTIAL PROPRIETY**  
The document on this print and information therewith are PROPRIETY  
to Elco Europe (A Division of AVX Ltd) and shall not be copied  
or disclosed in whole or in part without Elco Europe's written consent.

**PACKING NOTES**

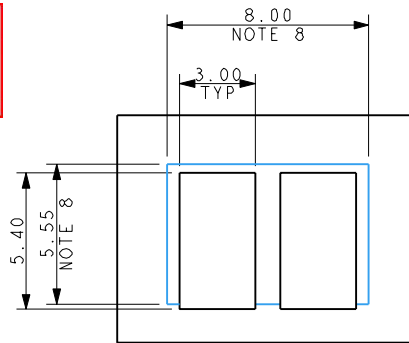
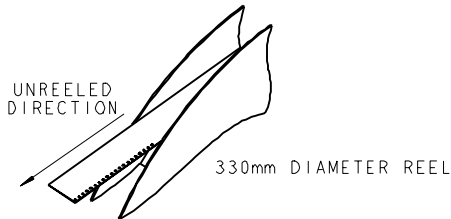

**SUGGESTED PCB LAYOUT**

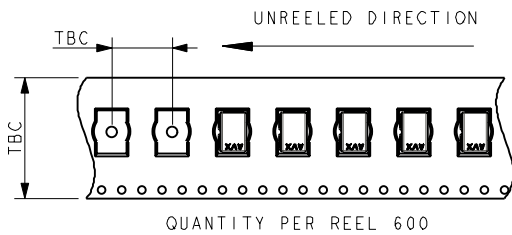

**NOTES :-**

- 2 WAY CONNECTOR FOR IDC WIRE TO BOARD CONNECTION, PRE ASSEMBLED WIRE STOP CAP, CODE REFER TO SHEET 1.
- CONTACT/CAP TO MATCH 18-24AWG STRANDED WIRE, INSULATION DIAMETER RANGE AS IN TABLE.
- FLAT FACE ON TOP OF CAP TO AID PICK AND PLACE ASSEMBLY.
- FOR FULL DETAILS REFER TO ELCO SPECIFICATION 201-01-138.
- ASSEMBLY PROCEDURE, REFER TO APPLICATION NOTES 201-01-140.
- GENERAL TOLERANCE ±0.20 UNLESS STATED.
- PACKED IN TAPE AND REEL, QUANTITY PER REEL 600.
- CONNECTOR OUTLINE.
- CONTACT MATERIAL :- TIN PLATED COPPER ALLOY.
- INSULATION MATERIAL, HIGH TEMPERATURE NYLON, GLASS FILLED. UL94 V-0, COLOUR REFER TO SHEET 1.
- WIRE STOP CAP PROTECTS END OF WIRE.
- GENERAL TOLERANCE ±0.20 UNLESS STATED.

SHEET 6 OF 8

FORM-106-01-056-6 ISS 7

ELCO EUROPE (A DIVISION OF AVX LTD.) CONFIDENTIAL PROPRIETY  
THE DRAWING ON THIS PRINT AND INFORMATION THEREWITH ARE  
PROPRIETARY TO ELCO EUROPE (A DIVISION OF AVX LTD.) AND  
SHALL NOT BE USED OR DISCLOSED IN WHOLE OR IN PART  
WITHOUT ELCO EUROPE'S WRITTEN CONSENT.

Release No.  
History  
102847  
04.05.2012  
18.05.2012  
20.08.2012

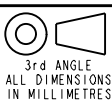

Drawn N.C.H.	Description 18-24AWG IDC WIRE TO BOARD CONNECTOR	DATE 04-Apr-12
Size CV	Part Number 00-9176-01_700S	Issue C

A

B



**18-24 AWG 3 WAY IDC CONNECTOR  
WIRE STOP CAPPED IDC**

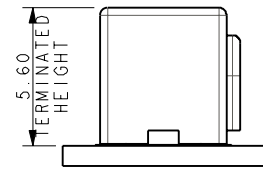
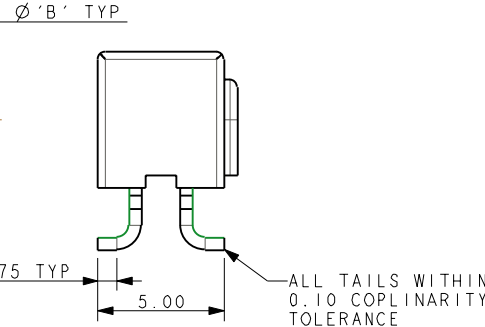
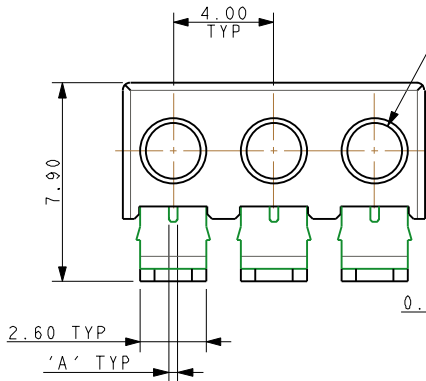
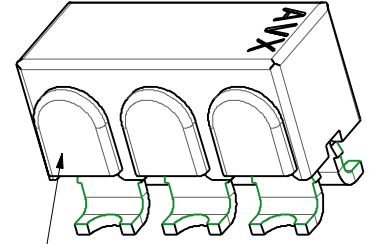
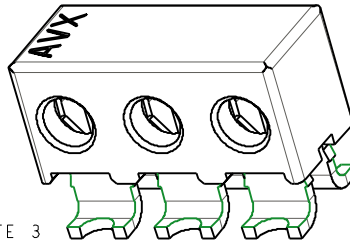
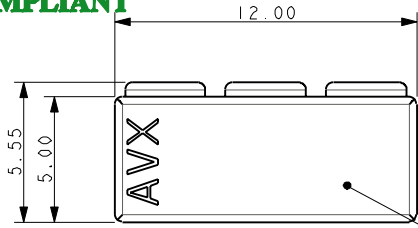

**MOUNTED ON PCB**

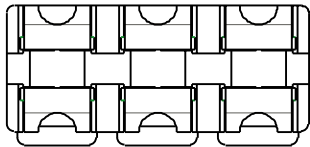

CODE	WIRE GAUGE	'A'	WIRE INSULATION	'B'
701	18AWG STRANDED	0.74	Ø 1.6-2.1	2.1
711	20AWG STRANDED	0.60	Ø 1.6-2.1	2.1
722	22AWG STRANDED	0.47	Ø 1.1-1.6	1.6
732	24AWG STRANDED	0.37	Ø 1.1-1.6	1.6

**Elco Europe (A Division of AVX Ltd) CONFIDENTIAL PROPRIETY**  
The document on this print and information therewith are PROPRIETY to Elco Europe (A Division of AVX Ltd) and shall not be copied or disclosed in whole or in part without Elco Europe's written consent.

**PACKING NOTES**

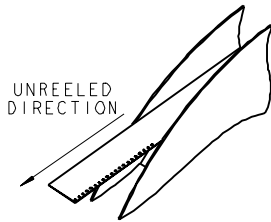

330mm DIAMETER REEL

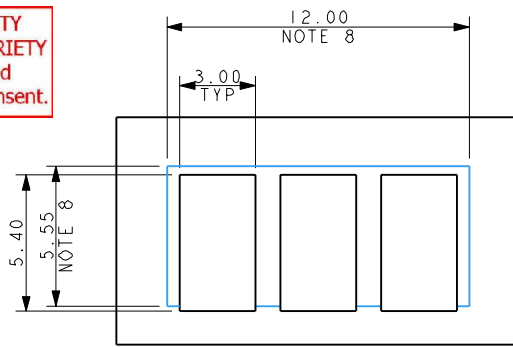

**SUGGESTED PCB LAYOUT**

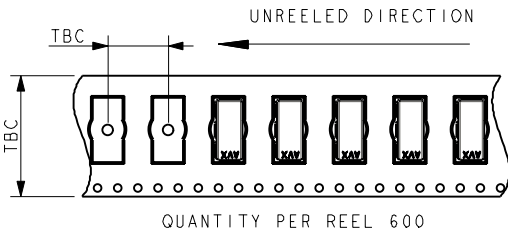

QUANTITY PER REEL 600

**NOTES :-**

- 3 WAY CONNECTOR FOR IDC WIRE TO BOARD CONNECTION, PRE ASSEMBLED WIRE STOP CAP, CODE REFER TO SHEET 1.
- CONTACT/CAP TO MATCH 18-24AWG STRANDED WIRE, INSULATION DIAMETER RANGE AS IN TABLE.
- FLAT FACE ON TOP OF CAP TO AID PICK AND PLACE ASSEMBLY.
- FOR FULL DETAILS REFER TO ELCO SPECIFICATION 201-01-138.
- ASSEMBLY PROCEDURE, REFER TO APPLICATION NOTES 201-01-140.
- GENERAL TOLERANCE ±0.20 UNLESS STATED.
- PACKED IN TAPE AND REEL, QUANTITY PER REEL 600.
- CONNECTOR OUTLINE.
- CONTACT MATERIAL :- TIN PLATED COPPER ALLOY.
- INSULATION MATERIAL, HIGH TEMPERATURE NYLON, GLASS FILLED. UL94 V-0, COLOUR REFER TO SHEET 1.
- WIRE STOP CAP PROTECTS END OF WIRE.
- GENERAL TOLERANCE ±0.20 UNLESS STATED.

SHEET 7 OF 8

FORM-106-01-056-6 ISS 7

ELCO EUROPE (A DIVISION OF AVX LTD.) CONFIDENTIAL PROPRIETY  
THE DRAWING ON THIS PRINT AND INFORMATION THEREWITH ARE PROPRIETY TO ELCO EUROPE (A DIVISION OF AVX LTD.) AND SHALL NOT BE USED OR DISCLOSED IN WHOLE OR IN PART WITHOUT ELCO EUROPE'S WRITTEN CONSENT.

Release No.  
History  
102847  
04.05.2012  
18.05.2012  
20.08.2012

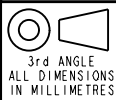

**ELCO**  
© COPYRIGHT ELCO EUROPE  
NOT TO BE DISCLOSED OR COPIED  
WITHOUT WRITTEN PERMISSION

Drawn N.C.H.	Description 18-24AWG IDC WIRE TO BOARD CONNECTOR	DATE 04-Apr-12
Size CV	Part Number 00-9176-01_700S	Issue C

A

B

A

B



18-24 AWG ASSEMBLED CAPPED IDC CONNECTORS

Elco Europe (A Division of AVX Ltd) CONFIDENTIAL PROPRIETY  
 The document on this print and information therewith are PROPRIETY  
 to Elco Europe (A Division of AVX Ltd) and shall not be copied  
 or disclosed in whole or in part without Elco Europe's written consent.

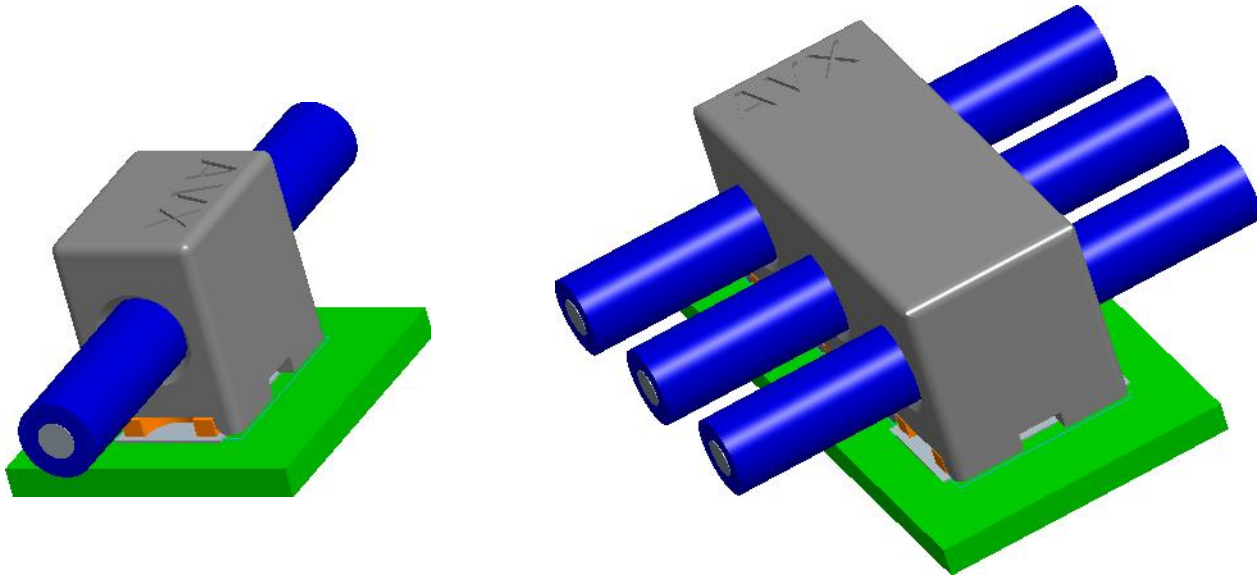

TYPICAL THROUGH WIRE ASSEMBLIES

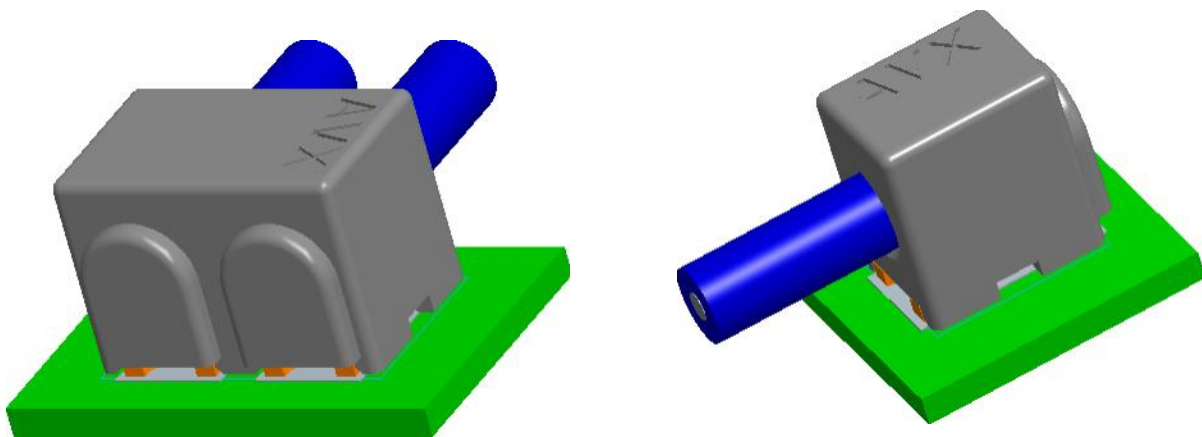

TYPICAL WIRE STOP ASSEMBLIES

FORM-106-01-036-6 ISS 7

ELCO EUROPE (A DIVISION OF AVX LTD.) CONFIDENTIAL PROPRIETY  
 THE DRAWING ON THIS PRINT AND INFORMATION THEREWITH ARE  
 PROPRIETY TO ELCO EUROPE (A DIVISION OF AVX LTD.) AND  
 SHALL NOT BE USED OR DISCLOSED IN WHOLE OR IN PART  
 WITHOUT ELCO EUROPE'S WRITTEN CONSENT.

SHEET 8 OF 8

Release No.  
 History  
 102847  
 04.05.2012  
 18.05.2012  
 20.08.2012

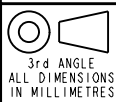

**ELCO**  
 © COPYRIGHT ELCO EUROPE  
 NOT TO BE DISCLOSED OR COPIED  
 WITHOUT WRITTEN PERMISSION

Drawn  
 N.C.H.  
 Size  
 CV

Description  
 18-24AWG IDC WIRE TO BOARD CONNECTOR  
 Part Number  
 00-9176-01\_700S

DATE  
 04-Apr-12  
 Issue  
 C

A

B