

PRODUCT NUMBER
73326-XXXLF

PLATING OPTION
1= GXT 0.76 μm
3= GOLD 0.76 μm
5= GOLD 1.27 μm

PACKAGE OPTION
1= TAPE ON REEL
2= TUBE
3= TAPE ON REEL
IN PLASTIC BAG

TERMINAL LOADING
1= FULLY LOADED
2= POS 2,3,4,5
3= POS 1,2,5,6

WHEN NEEDED, SUFFIX LETTER "LF"
INDICATES THE PRODUCT IS RoHS
COMPATIBLE, SEE NOTE 4.

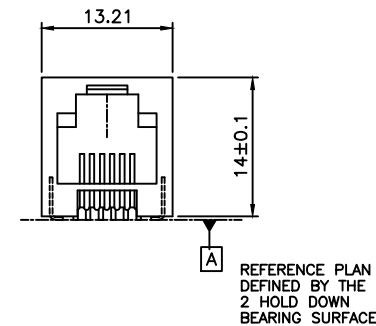
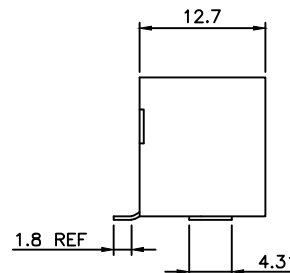
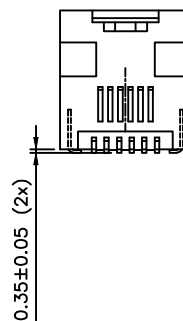

NOTES:

- 1- MATERIAL: HOUSING: HIGH TEMP. PCT, COLOUR BLACK.
TERMINAL: PHOSPHOR BRONZE.
- 2 - PLATING: CONTACT AREA: SEE TABLE.
SOLDER TAIL : 90/10 SnPb 2 μm MIN.
WHEN SUFFIX "LF" IS REQUIRED, 2 μm MIN MATTE
TIN OVER 1.27 MIN Ni IS SUPPLIED INSTEAD OF SnPb.
NO RAW EDGES EXEPT SOLDER TAIL TIPS
- 3 - SOLDER TAILS COPLANARITY : 0.1 mm
- 4 - RoHS COMPATIBLE PRODUCT SPECIFICATIONS

a - PLATING:

- "LF" MEANS THE PRODUCT IS LEAD-FREE,
2 μm MINIMUM MATTE TIN OVER 1.27 μm
MINIMUM NICKEL UNDERPLATE.

b - MANUFACTURING PROCESS COMPATIBILITY

- THE HOUSING WILL WITHSTAND EXPOSURE TO
245°C PEAK TEMPERATURE FOR 30 SECONDS
MAX IN A CONVECTION, INFRA-RED OR VAPOR
PHASE OR REFLOW OVEN.

c - LABELING:

- MEETS PACKAGING SPECS AS PER GS-14-920

d - LEGAL STATEMENT: SEE GS-47-0004

- 5 - PACKAGING FOR OPTION 3 : EACH REEL IS WRAPPED INTO A PLASTIC BAG
TO PROTECT FROM MOISTURE DURING STACKING TIME.

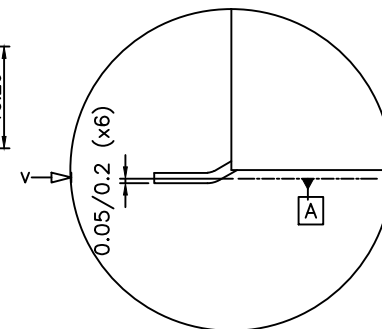
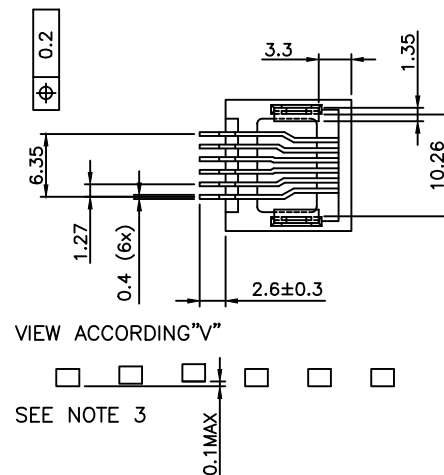

CUSTOMER COPY FOR REFERENCE ONLY

mat'l. code	surface	tolerance	projection	product family
	ISO 1302	ISO 406 ISO 1101		MOD JACK
ltr	ecn no	dr	date	title
H	F06-0240	DLE	06.07.18	SMT RA JACK
J	F09-0070	LSA	09.07.23	6 POS INSIDE
K	B-15798	JFA	13.09.09	
L	F-21888	AMA	15.09.09	
		dr	D LEGRAND	04.10.18
		enr	P NIZZI	04.10.18
F	F04-0363	DLE	04.10.18	
		chr	D LEGRAND	04.10.18
G	F05-0247	DLE	05.09.12	
		appd	P NZ	04.10.18
sheet	revision	L	E	B
index	sheet	1	2	3

PRODUCT NUMBER
SEE SHEET 1

LTR	PART NAME	QTY
1	PRODUCT	230
2	TAPE	1
3	REEL	1
4	COVER TAPE	1

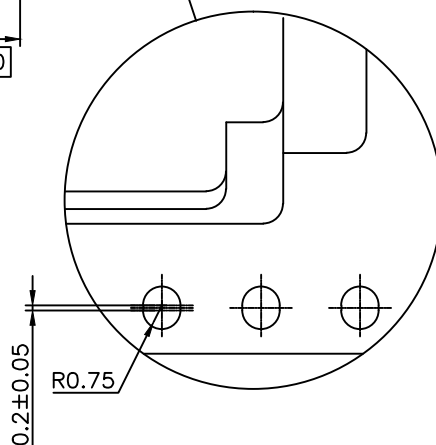
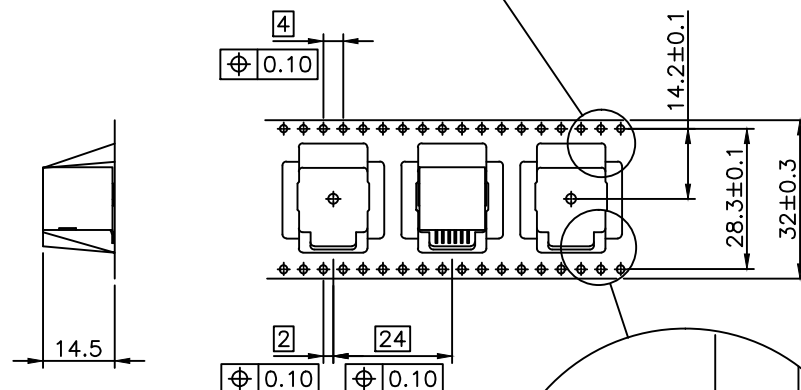
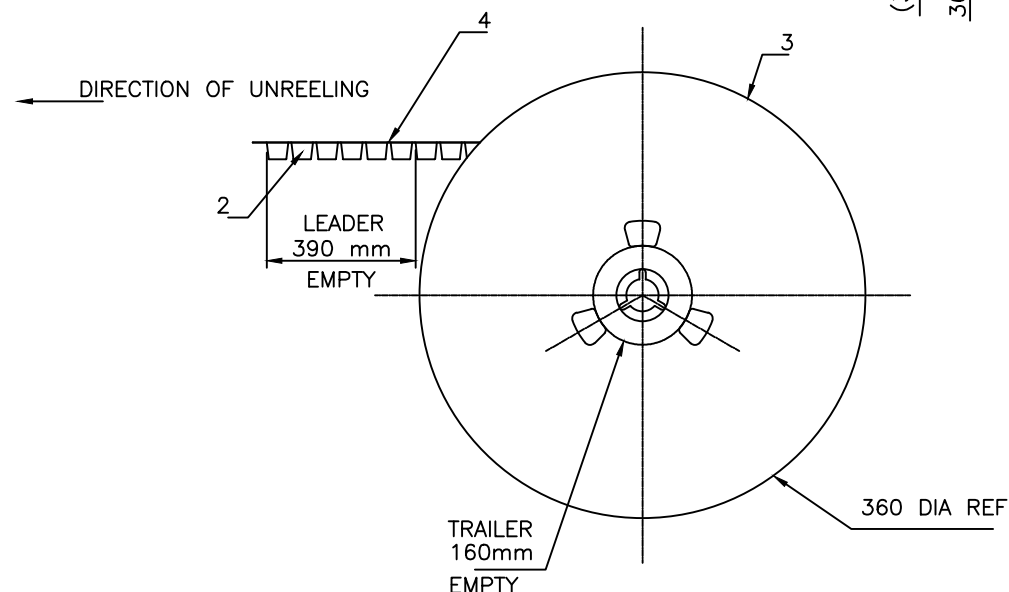
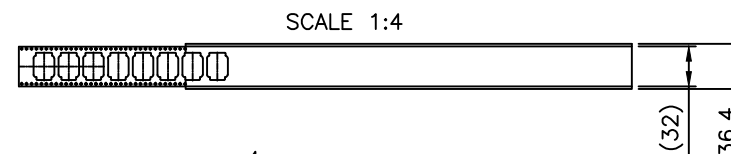
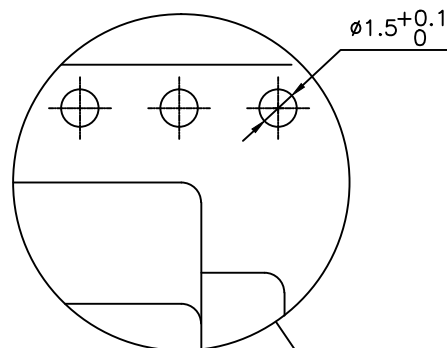

1- IN ACCORDANCE WITH EIA-481 AND IEC 296-3

CUSTOMER COPY FOR REFERENCE ONLY

mat'l. code	surface	tolerance	projection	product family
	ISO 1302	ISO 406 ISO 1101		MOD-JACK
ltr	ecr no	dr	date	title
D	F80620	DLE	98.11.26	SMT RA JACK
E	F06-024Q	DLE	06.07.18	6 POS. INSIDE
			angles	linear
			dr	D LEGRAND
			enr	P NIZZI
			chr	D LE
			app	P NZ
sheet	revision			
index	sheet			



dwg no	73326	sheet 2 of 3	size
			A3
type	CUSTOMER Drawing		



FCconnect.com

Copyright FCJ

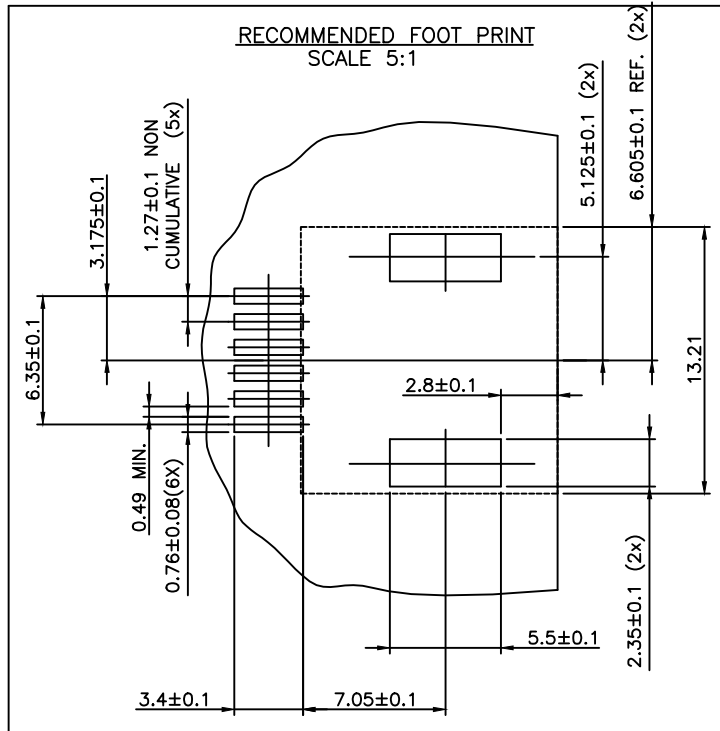

CUSTOMER COPY FOR REFERENCE ONLY

mat'l. code		surface		tolerance		projection		product family	
		ISO 1302		ISO 406 ISO 1101				MOD JACK	
ltr		ecn no		date		tolerances unless otherwise specified		title	
A		F04-0363		04.10.18		±0.13		SMT RA JACK	
B		F06-0240		06.07.18		mm		6 POS INSIDE	
						scale 2:1			
								dwg no	
								sheet 3 of - size	
								73326 A4	
								type	
								CUSTOMER Drawing	
sheet index		revision sheet							

form: A4

Mouser Electronics

Authorized Distributor

Click to View Pricing, Inventory, Delivery & Lifecycle Information:

[FCI / Amphenol:](#)

[73326-111LF](#) [73326-122LF](#) [73326-311LF](#) [73326-312LF](#) [73326-131LF](#)