

REVISIONS					
P	LTR	DESCRIPTION	DATE	DWN	APVD
	D2	REV PER ECO 17-009333	3 DEC 12	CT	RL

SIZE	B DIM	C DIM ±.0050	(L DIM)
09	.229	.3085	(.100)
15	.304	.3835	(.175)
25	.429	.5085	(.300)
37	.579	.6585	(.450)
51	.754	.8335	(.625)
65	.929	1.0085	(.800)

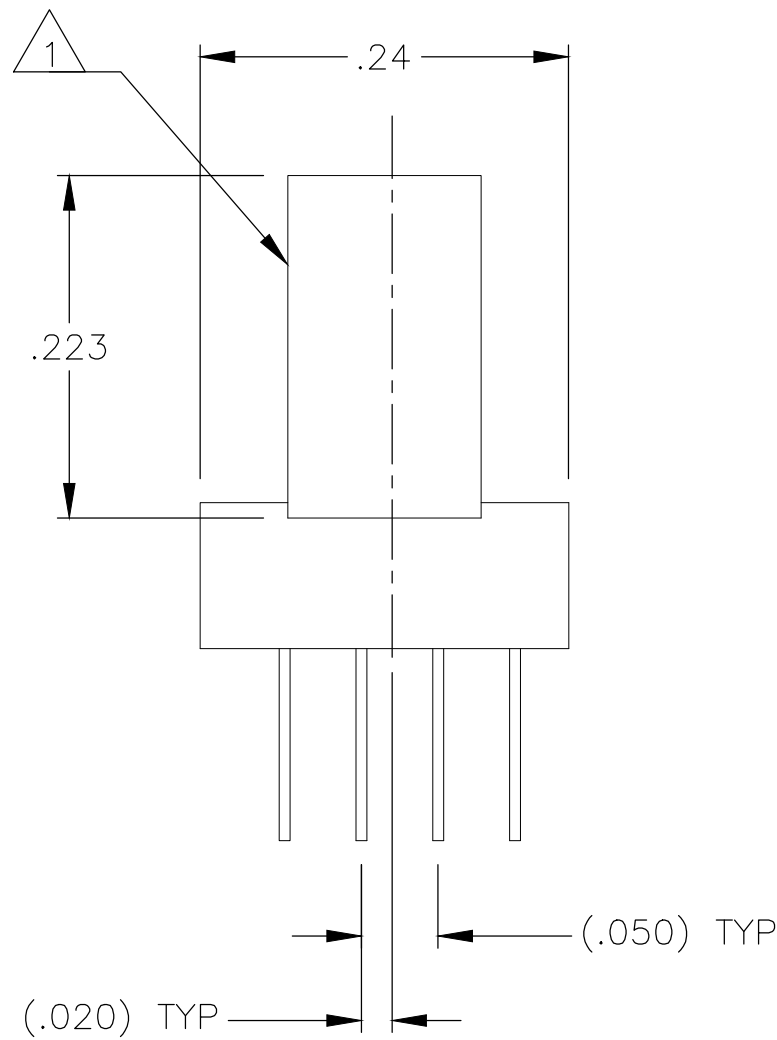
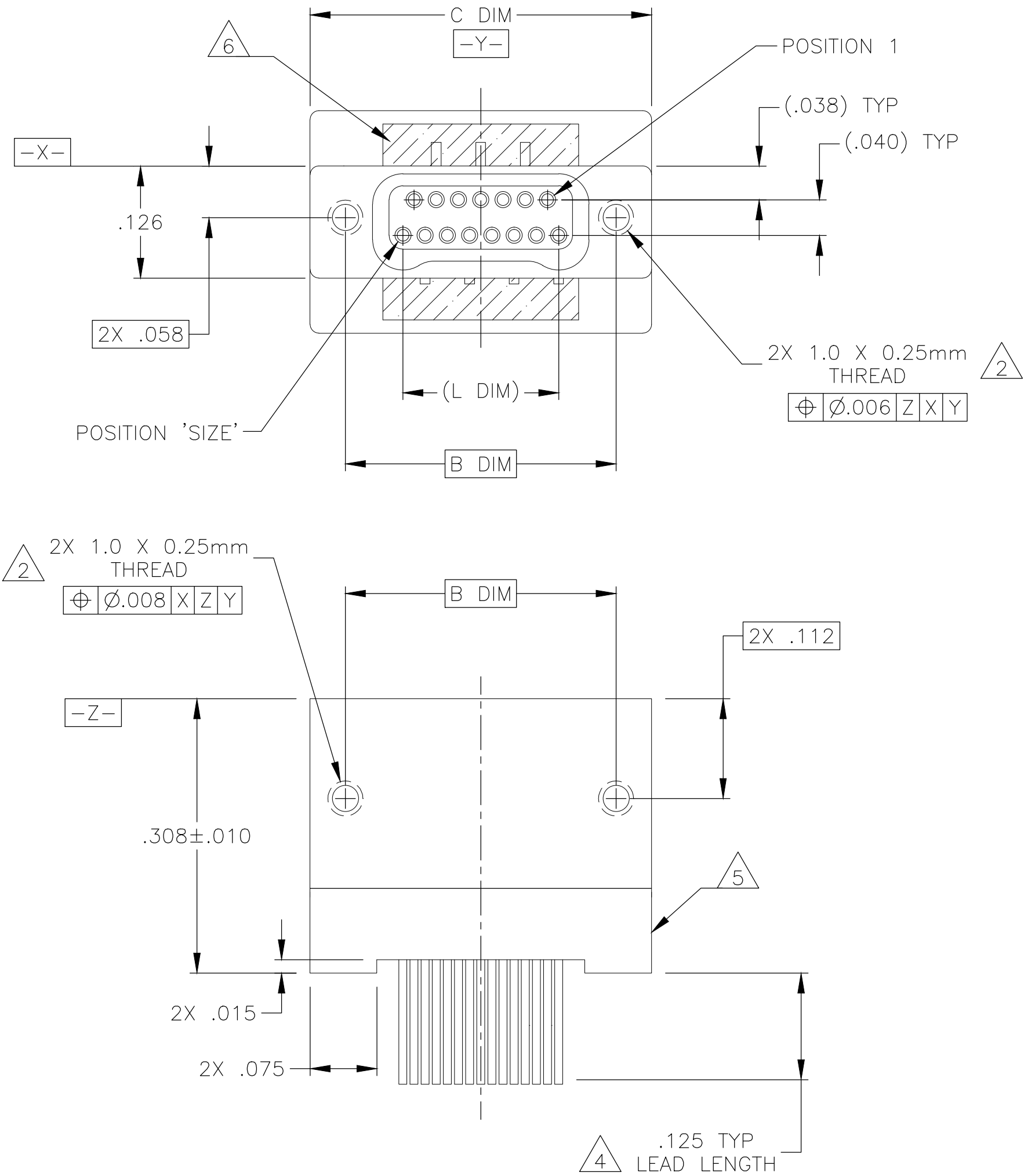

1. SHELL OPTIONS (TO BE SPECIFIED IN NANONICS PART NUMBER):
METAL: 6061-T6 ALUMINUM, ELECTROLESS NICKEL PLATED PER SAE-AMS-C-26074 OR SAE-AMS-2404 (STANDARD) OR GOLD PLATED PER ASTM B488
303 STAINLESS STEEL, PASSIVATED PER SAE-AMS-2700
INSULATOR MATERIAL FOR ALL METAL SHELLS IS LIQUID CRYSTAL POLYMER (LCP) PER MIL-M-24519 OR PER ASTM D5138
PLASTIC: LIQUID CRYSTAL POLYMER (LCP) PER MIL-M-24519 OR PER ASTM D5138
2. STANDARD 1.0 X 0.25mm MOUNTING AND JACKSCREW THREADS ARE SHOWN FOR REFERENCE ONLY AND MUST BE SPECIFIED IN THE NANONICS PART NUMBER WHEN REQUIRED. 1.2 X 0.25mm THREADS ALSO AVAILABLE.
3. MOUNTING HARDWARE IS AVAILABLE WITH THIS CONFIGURATION (NOT SHOWN). HARDWARE MUST BE SPECIFIED IN THE NANONICS PART NUMBER. CONSULT TYCO ELECTRONICS FOR DETAILS
4. LEAD MATERIAL: HH BRASS, TIN LEAD PLATED 60/40 COMPOSITION PER SAE-AMS-P-81728
5. LEAD ORGANIZER MATERIAL IS LIQUID CRYSTAL POLYMER PER ASTM D5138
6. THROUGH HOLE LEADS ARE EPOXY ENCAPSULATED WITHIN THE LEAD ORGANIZER
7. NANONICS TERMINATION CODE: M5 WITH SPECIAL CODE 11816 OR TERMINATION CODE M51
8. PREVIOUSLY IDENTIFIED AS NANONICS: N10138/255

THIS DRAWING IS A CONTROLLED DOCUMENT.

DIMENSIONS:
INCHES

TOLERANCES, UNLESS OTHERWISE SPECIFIED:

0 PLC	±	-
1 PLC	±	-
2 PLC	±	.010
3 PLC	±	.005
4 PLC	±	-
ANGLES	±	1°

MATERIAL

SEE NOTES

FINISH

SEE NOTES

DWN
C. SCHOLL
04-09-02

CHK
M. STORRY
04-16-02

APVD
D. MORALES
03-30-04

PRODUCT SPEC
—

APPLICATION SPEC
—

WEIGHT
0

CUSTOMER DRAWING

TE Connectivity

NAME
RCPT ASSEMBLY,VERTICAL MOUNT,
THROUGH HOLE, 2 TO 4 ROW, .050 SPACING,
—

SIZE
A2

CAGE CODE
OJPN9

DRAWING NO
C=1589743

RESTRICTED TO
—

SCALE
8:1

SHEET
1 OF 2

REV
D2

1471-9 (1/15)

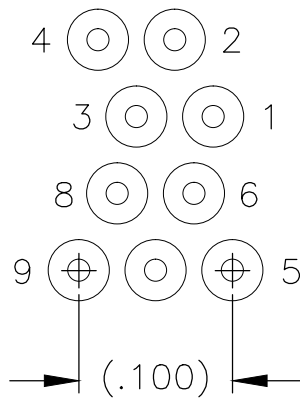

9 POSITION

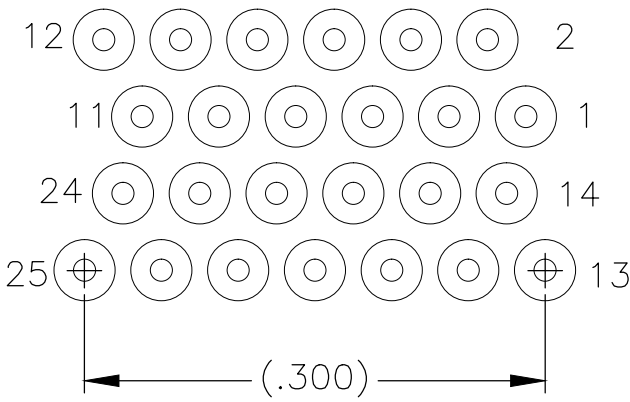

25 POSITION

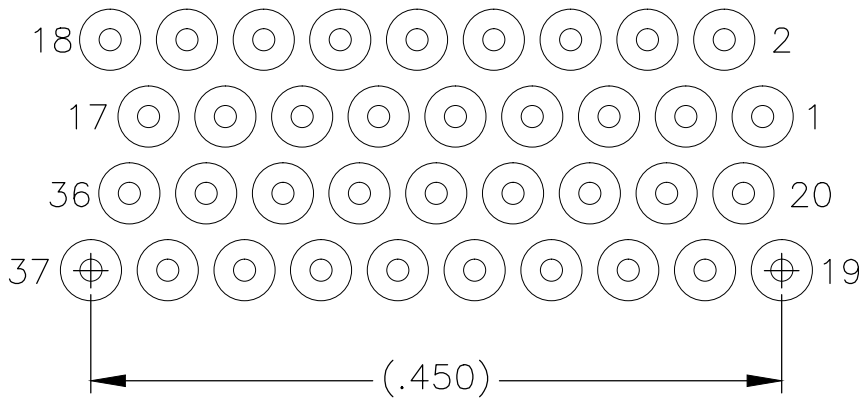

37 POSITION

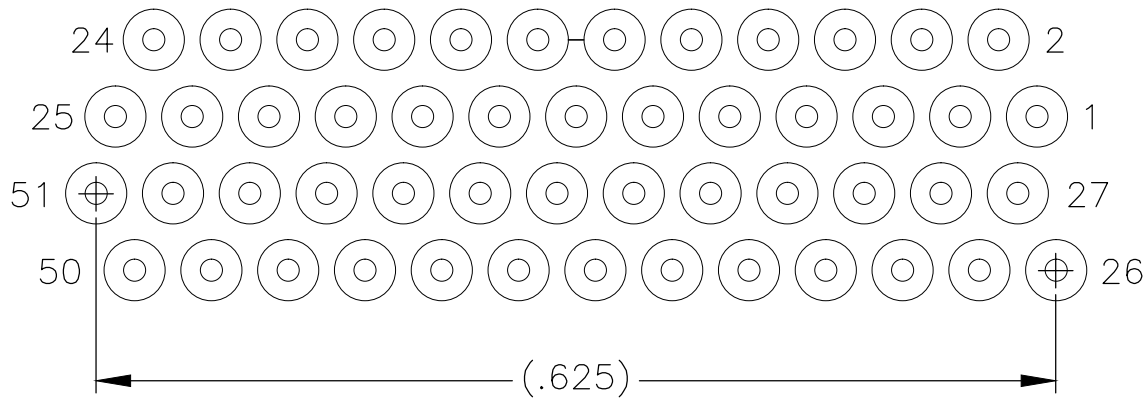

51 POSITION

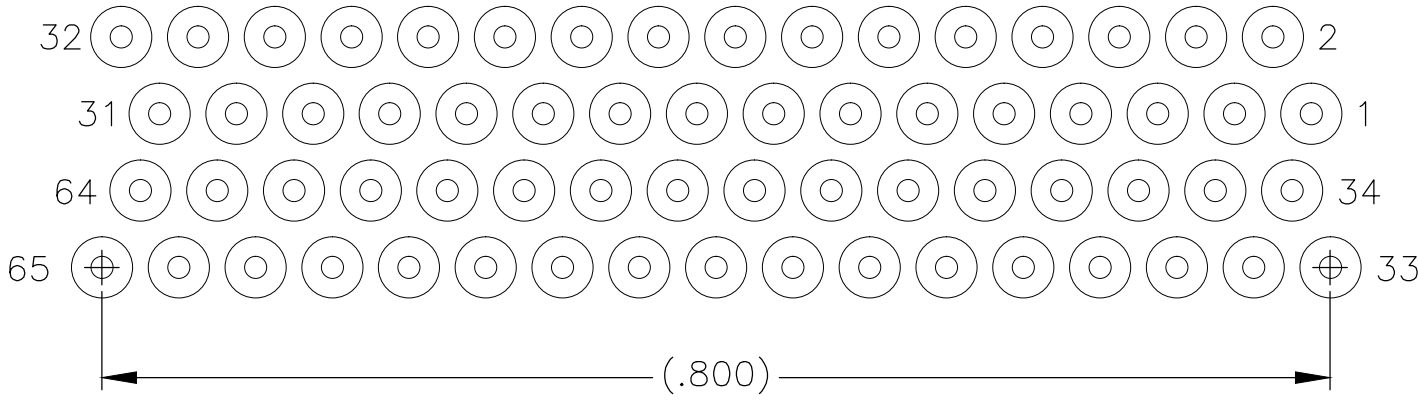

65 POSITION

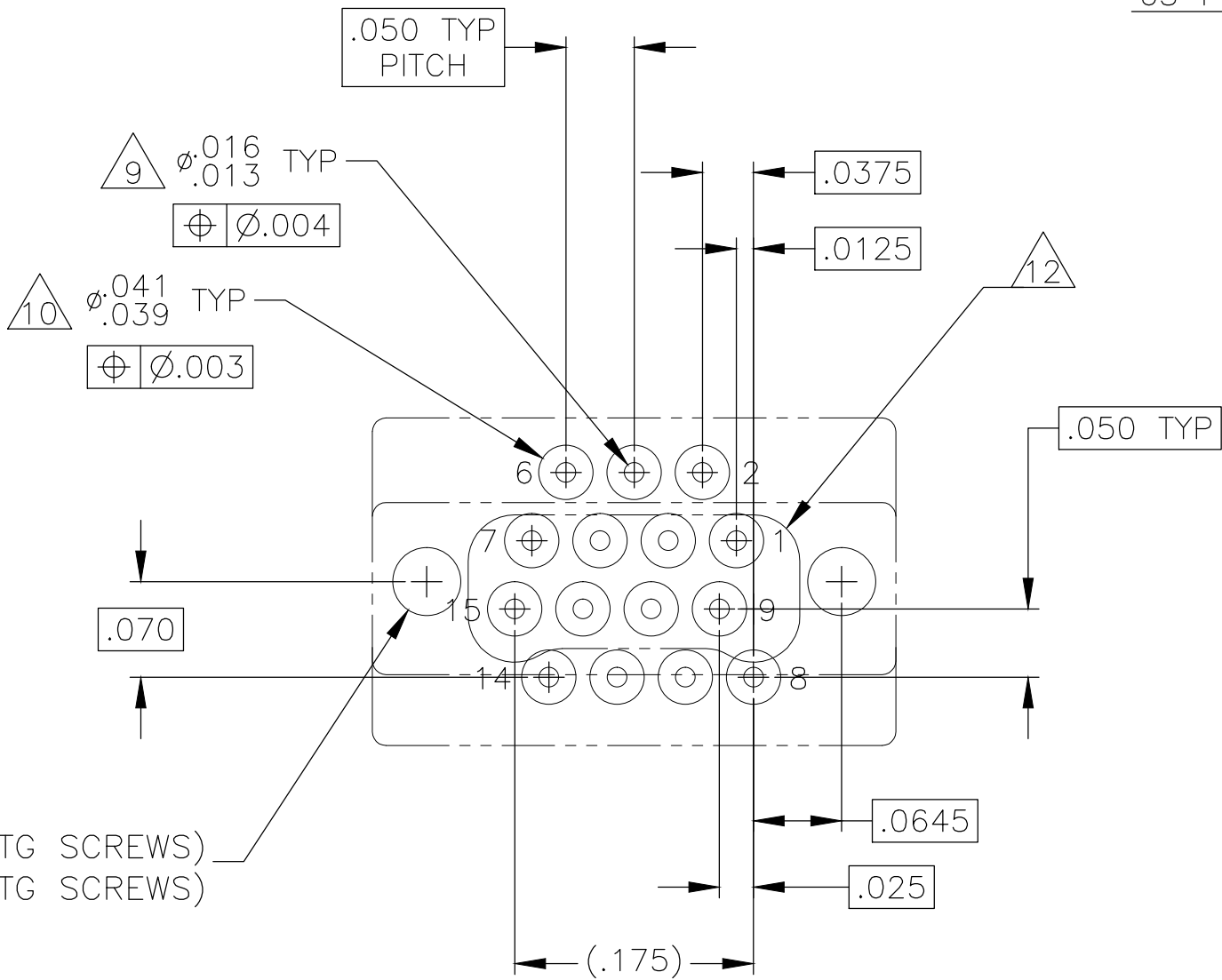

2X $\phi .050 \pm .002$ (FOR 1.0mm MTG SCREWS)
 $\phi .058 \pm .002$ (FOR 1.2mm MTG SCREWS)
 $\phi \phi .004$

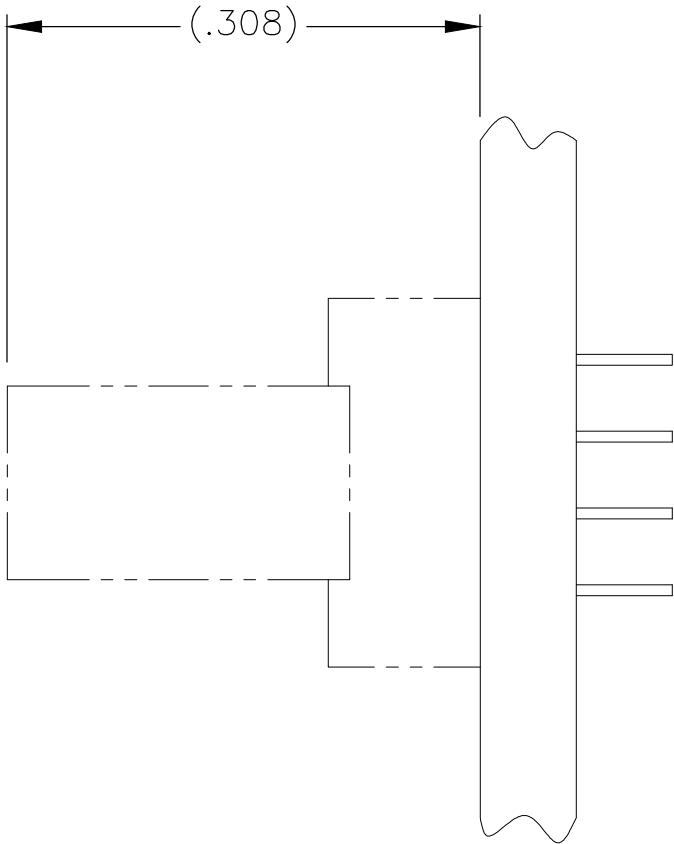

TYPICAL PCB LAYOUT $\triangle 8$
SIZE 15 SHOWN FOR REFERENCE

- $\triangle 8$. POSITIONAL TOLERANCES FOR BASIC DIMENSIONED FEATURES ARE RELATIVE TO FIDUCIALS OR SOME SIMILAR DATUM REFERENCES DEFINED BY PCB DESIGNER.
- $\triangle 9$. PLATED THROUGH HOLES
- $\triangle 10$. SOLDER PADS
- 11. ALL THROUGH HOLE LAYOUTS ARE AS VIEWED FROM TOP OF PCB.
- $\triangle 12$. CONNECTOR ORIENTATION

THIS DRAWING IS A CONTROLLED DOCUMENT.		DWN C. SCHOLL 04-09-02	TE Connectivity			
DIMENSIONS: INCHES		CHK M. STORRY 04-16-02				
		APVD D. MORALES 03-30-04	NAME RCPT ASSEMBLY, VERTICAL MOUNT, THROUGH HOLE, 2 TO 4 ROW, .050 SPACING,			
		PRODUCT SPEC —	SIZE A2			
MATERIAL SEE NOTES		FINISH SEE NOTES	APPLICATION SPEC —	CAGE CODE 0JPN9	DRAWING NO C=1589743	RESTRICTED TO —
CUSTOMER DRAWING			WEIGHT —	SCALE 8:1	SHEET 2 OF 2	REV D2

Mouser Electronics

Authorized Distributor

Click to View Pricing, Inventory, Delivery & Lifecycle Information:

[TE Connectivity:](#)

[STM025M51VQ](#)