

REVISIONS			
LTR	DESCRIPTION	DATE	APPROVED
B		5-18-83	<i>OW REE</i>
C	CHANGED -13 NYLON, 30% GLASS FILLED NUT -13 NYLON, 35% GLASS FILLED	12/13/83	<i>93</i>

SPLIT NUT
TYPE C

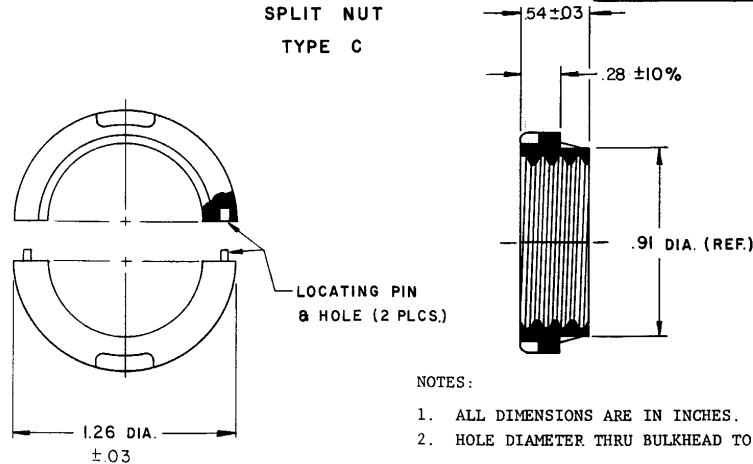

NOTES:

1. ALL DIMENSIONS ARE IN INCHES.
2. HOLE DIAMETER THRU BULKHEAD TO BE .94 ± .02

ORDERING INFORMATION:

BASE PART NUMBER 207A412 -13

FEEDTHROUGH MATERIAL -13 NYLON, 30% GLASS FILLED

If this document is printed it becomes uncontrolled.
Check for the latest revision.

SPECIFICATION CONTROL DRAWING (LIMITED DISTRIBUTION)

THIS DRAWING AND THE INFORMATION SET FORTH HEREON ARE THE PROPERTY OF RAYCHEM CORPORATION, AND ARE TO BE HELD IN TRUST AND CONFIDENCE. PUBLICATION, DUPLICATION, DISCLOSURE, OR USE FOR ANY PURPOSE NOT EXPRESSLY AUTHORIZED IN WRITING BY RAYCHEM CORPORATION IS PROHIBITED.	DRAWN	C. WARREN 11/2/82	Raychem RAYCHEM CORPORATION 300 CONSTITUTION DRIVE MENLO PARK, CALIFORNIA 94025
	CHECKED	<i>S. J. ...</i> 11-2-82	
	DEGN APPD		
	MFG APPD	<i>B. ...</i> 11/18/82	
	QC APPD	<i>D. Hay</i> 11-8-82	
MKTG APPD	<i>J. HOFFMAN</i> 11/16/82	TITLE	SPLIT NUT-TYPE C
TECH SER	<i>RELIANA</i> 11/6/82	CODE IDENT.	NO. 06080
DO NOT SCALE THIS DRAWING	PROJECT	SIZE B	DWG. NO. 207A412-13
		SCALE	SHEET OF

Mouser Electronics

Authorized Distributor

Click to View Pricing, Inventory, Delivery & Lifecycle Information:

[TE Connectivity:](#)

[207A412-13-0](#)