

| LOC |    | DIST |     | REVISIONS     |           |     |      |
|-----|----|------|-----|---------------|-----------|-----|------|
| HV  | 00 | P    | LTR | DESCRIPTION   | DATE      | DWN | APVD |
|     |    | A    |     | ECO-14-001314 | 27JAN2014 | DR  | DR   |
|     |    |      |     |               |           |     |      |
|     |    |      |     |               |           |     |      |

(7.20) (7.20)

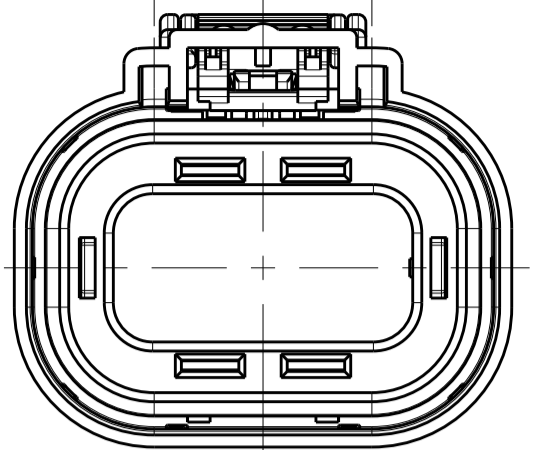

2103534-1  
KEY A

(9.20) (7.20)

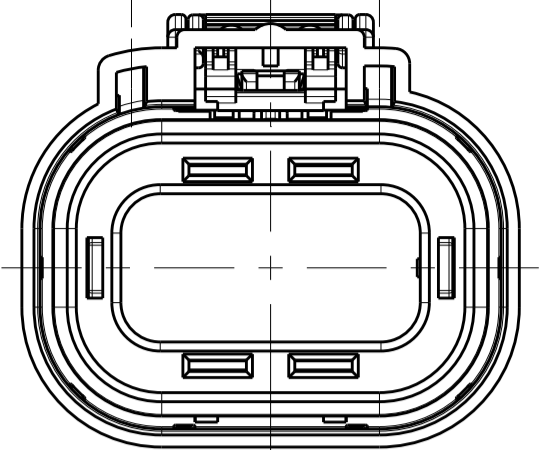

2103534-2  
KEY B

(9.20) (9.20)

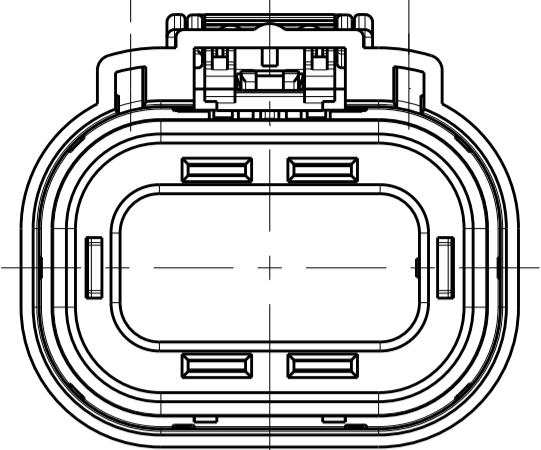

2103534-4  
KEY D

(8.20)

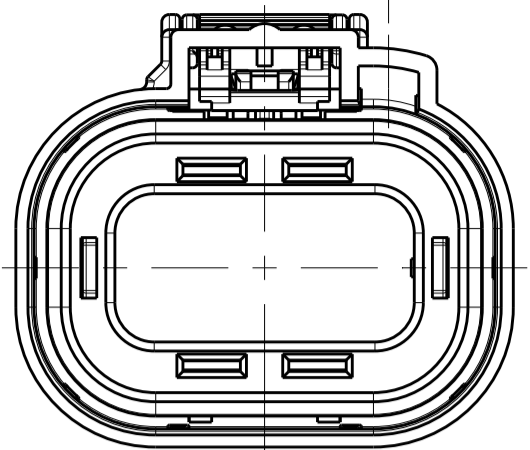

2103534-5  
KEY E

(8.20)

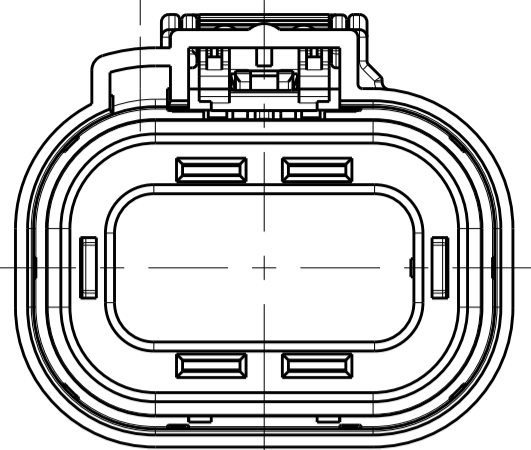

2103534-6  
KEY F

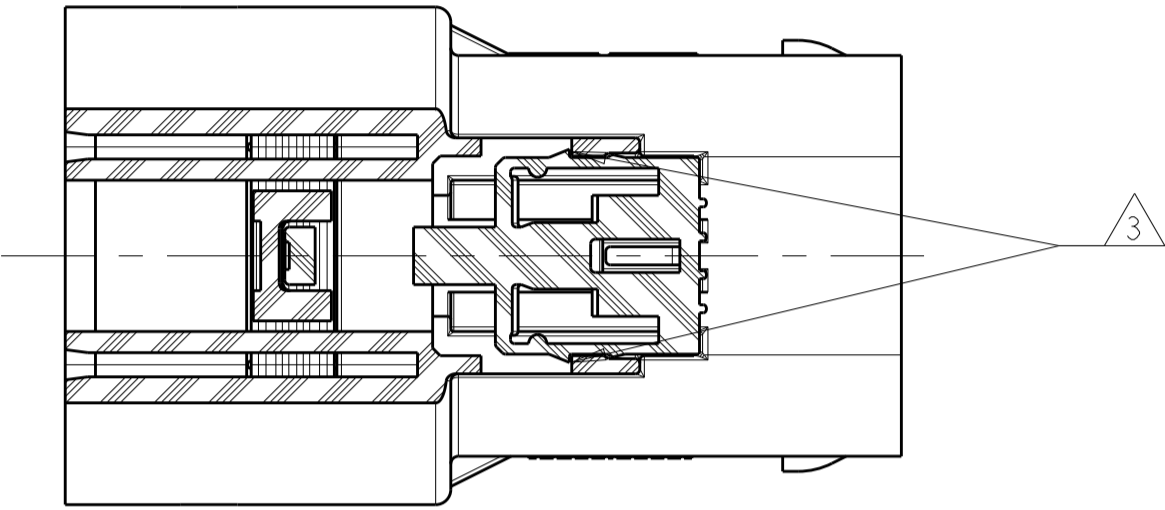

SECTION C-C

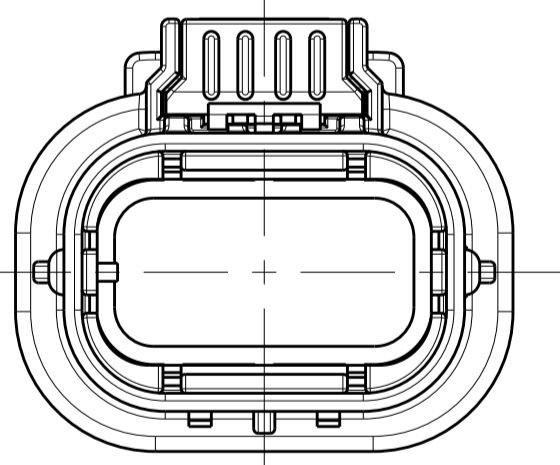
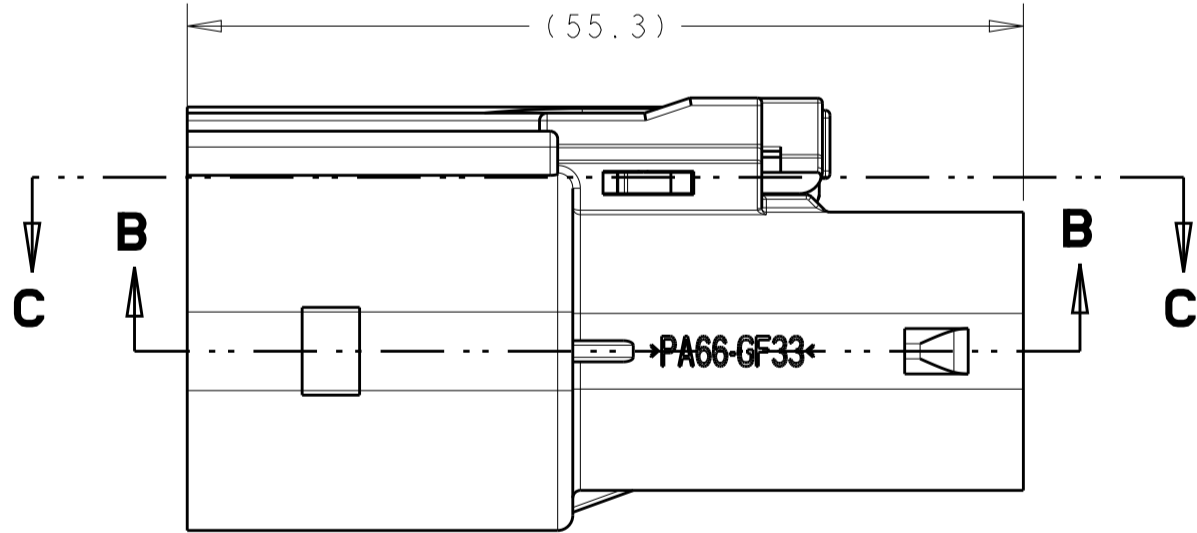
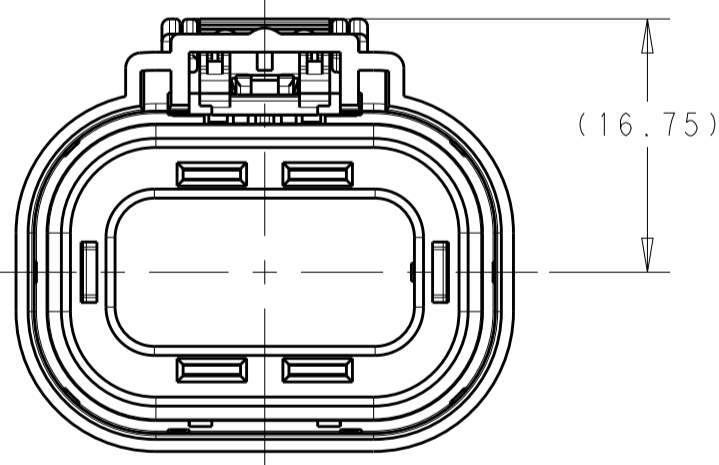
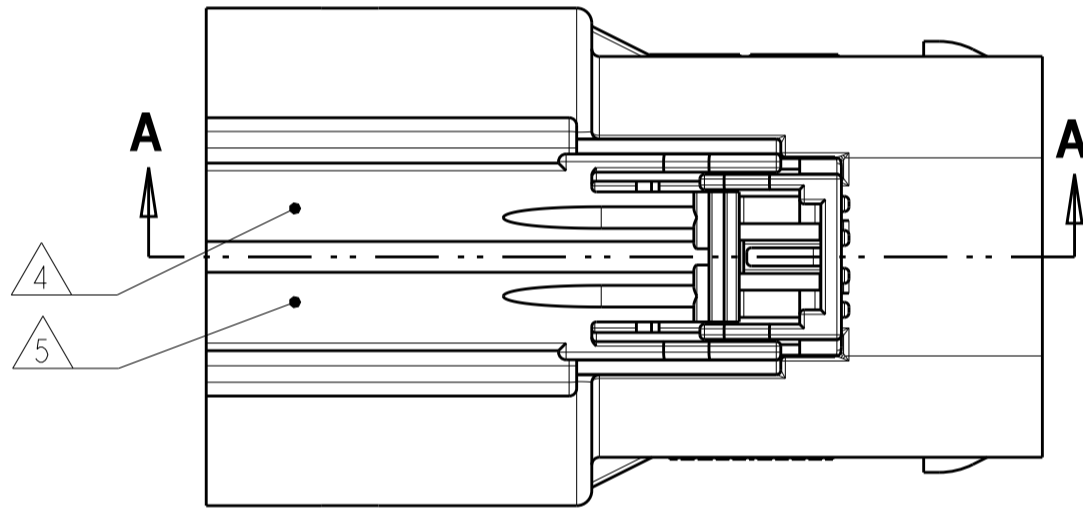

2103534-1 SHOWN

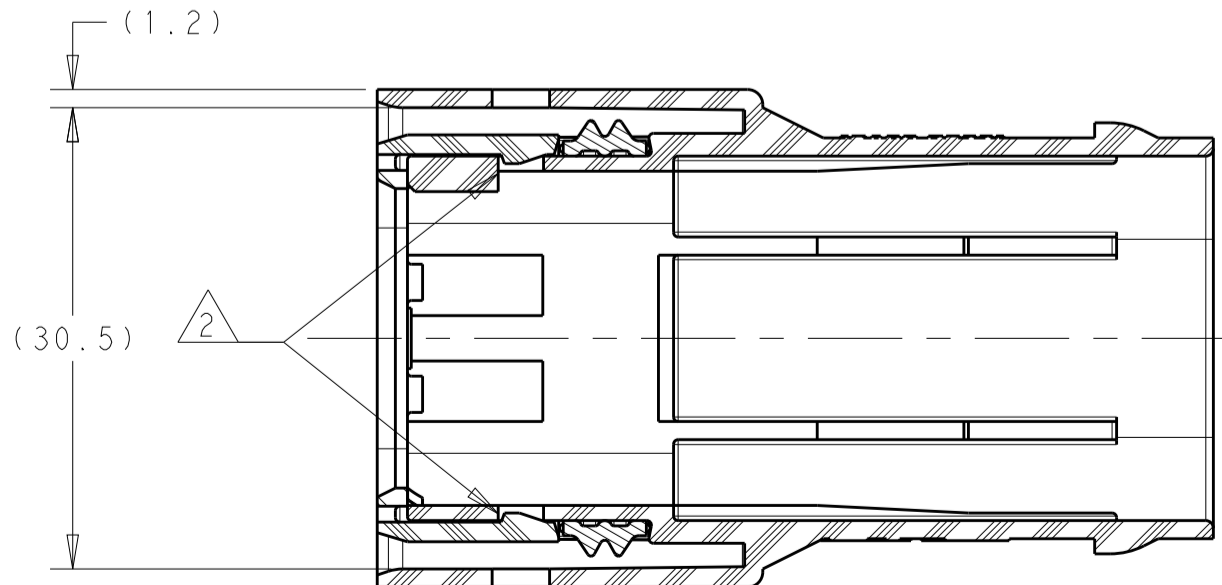

SECTION B-B

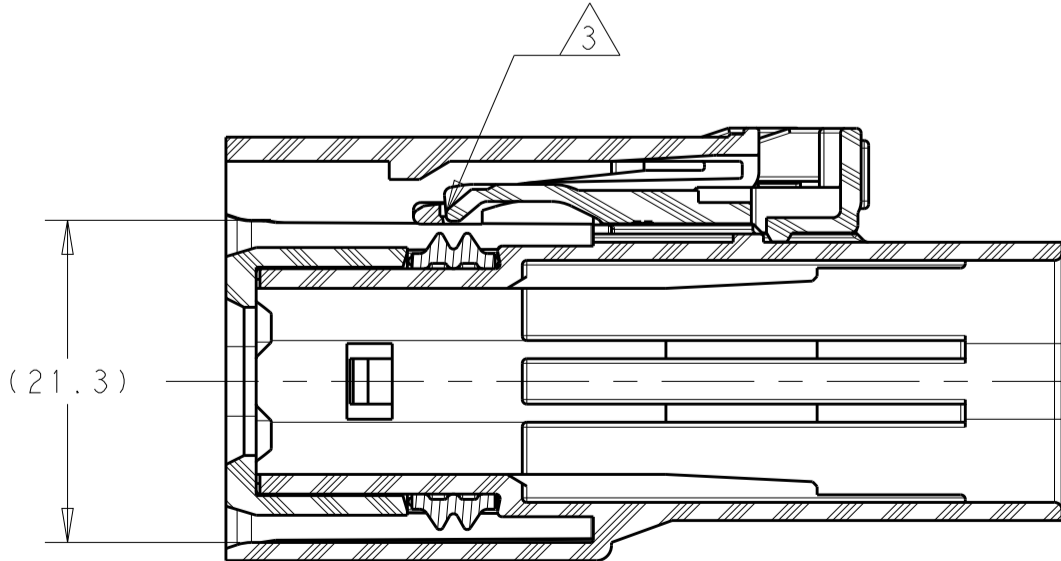

SECTION A-A

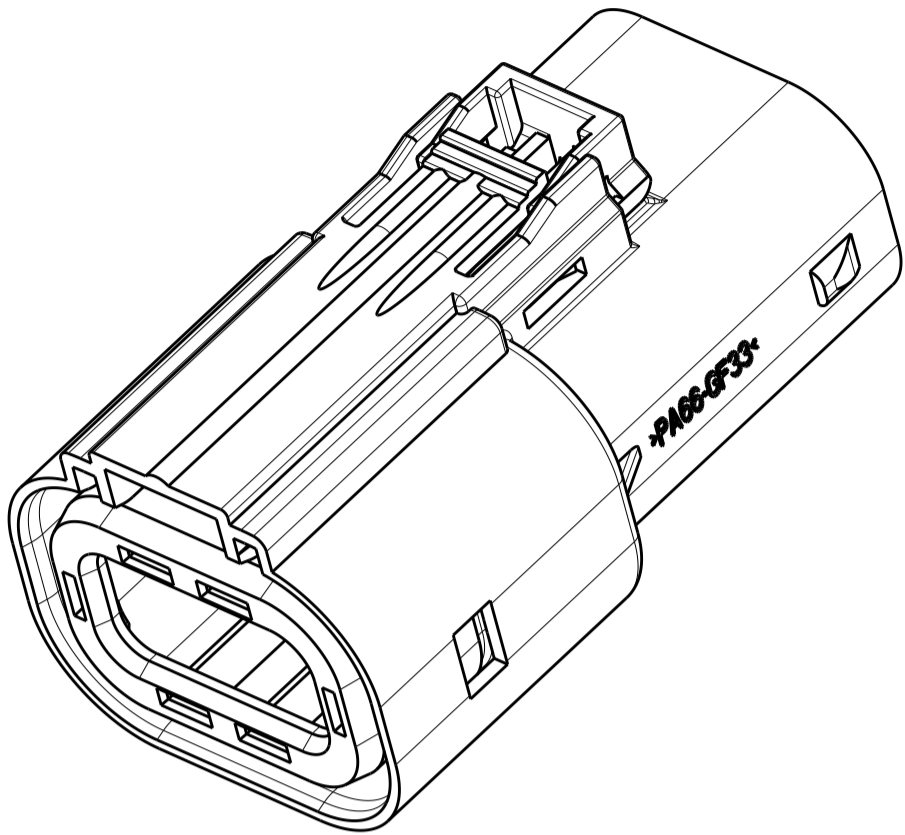

1. CONNECTOR MUST BE FREE OF ANY MECHANICAL DEFECTS WHICH COULD NEGATIVELY AFFECT FIT, FUNCTION, OR PERFORMANCE
- 2 PERIPHERAL SEAL RETAINER MUST BE FULLY LOCKED IN TWO LOCATIONS INTO OUTER HOUSING
- 3 CPA MUST BE INSTALLED IN PRE-STAGE POSITION AS SHOWN
- 4 JULIAN DATE CODE IN THIS LOCATION AT ASSEMBLY
- 5 TE PART NUMBER IN THIS LOCATION AT ASSEMBLY (VARIABLE)

|            |         |           |
|------------|---------|-----------|
| F          | 14.39 g | 2103534-6 |
| E          | 14.30 g | 2103534-5 |
| D          | 14.64 g | 2103534-4 |
| B          | 14.62 g | 2103534-2 |
| A          | 14.48 g | 2103534-1 |
| INDEX CODE | WEIGHT  | PART NO   |

|  |  |                          |                               |  |
|--|--|--------------------------|-------------------------------|--|
| THIS DRAWING IS A CONTROLLED DOCUMENT. |  | DWN D. RHEIN 04SEP2013   | TE Connectivity               |  |
| DIMENSIONS:                            |  | CHK D. RHEIN 04SEP2013   |                               |  |
| mm                                     | TOLERANCES UNLESS OTHERWISE SPECIFIED: | APVD A. GUANCO 04SEP2013 | NAME PLUG SUB-ASSEMBLY HVA280 |  |
|  | 0 PLC ±                                | PRODUCT SPEC             | SIZE CAGE CODE DRAWING NO     |  |
|  | 1 PLC ±0.5                             | APPLICATION SPEC         | RESTRICTED TO                 |  |
|  | 2 PLC ±0.30                            |                          | A100779C=2103534              |  |
|  | 3 PLC ±                                |                          | SCALE 2:1 SHEET 1 OF 1 REV A  |  |
| MATERIAL                               | FINISH                                 | WEIGHT SEE TABLE         | Customer Drawing              |  |

# Mouser Electronics

Authorized Distributor

Click to View Pricing, Inventory, Delivery & Lifecycle Information:

[TE Connectivity:](#)

[2103534-5](#)