

10		9		8		7		6		5		4		3		2		19215				
MATERIAL NUMBER	ENG. NUMBER	CODE STRIPE COLOR	"A"		"B"		"C" MAX.	"L" MAX.	CMA RANGE													
			AWG.	MIN. DIA.	AWG.	MIN. DIA.			LARGE I.D.	TO SMALL I.D.												
			22-18	.071/1.80	16-14	.088/2.24			.160/4.06	.675/17.15											2050-5180	TO 509-2600
			16-14	.097/2.46	12-10	.137/3.48			.223/5.66	.827/21.0											5180-13,100	TO 2050-5180
192150013	BA-331	RED	22-18	.071/1.80	16-14	.088/2.24	.160/4.06	.675/17.15	2050-5180	TO 509-2600												
192150023	CB-346	BLUE	16-14	.097/2.46	12-10	.137/3.48	.223/5.66	.827/21.0	5180-13,100	TO 2050-5180												
192150037	DC-354	YELLOW	12-10	.139/3.53	#8	.172/4.37	.291/7.39	.854/21.69	13,100-20,800	TO 5180-13,100												
192150042	ED-362	RED	#8	.182/4.62	#6	.237/6.02	.375/9.53	1.045/26.54	20,800-33,100	TO 13,100-20800												

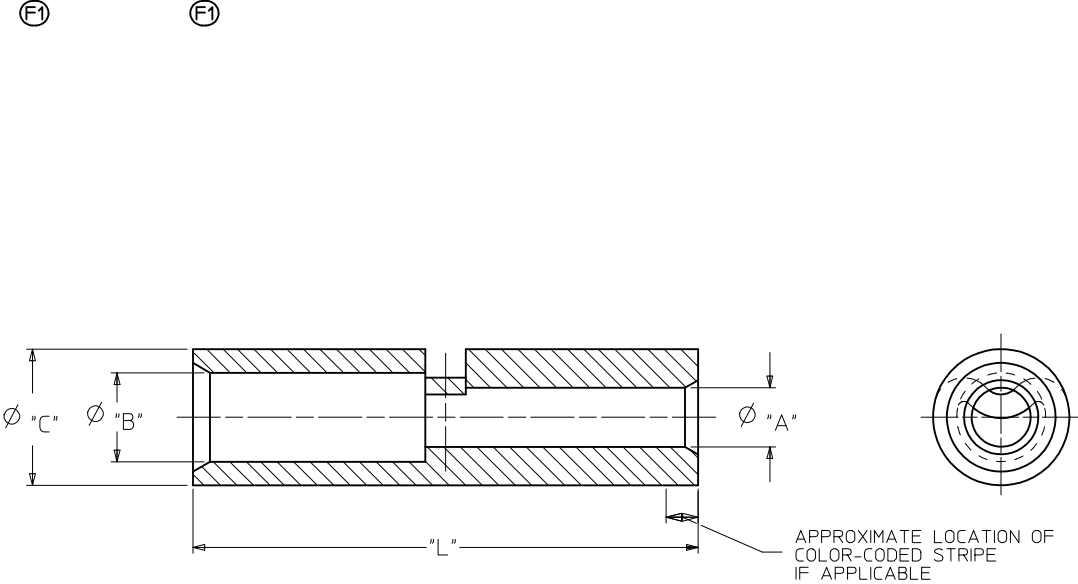

SALES DRAWING

- NOTES:
- 1. MATERIAL: COPPER
FINISH: ELECTRO-TIN
 - 2. DELETED
 - 3. PART IS ROHS COMPLIANT.

CORRECTED DIMS EC NO: WNA2010-0735 DRAWN BY: JMACNEIL CHKD: JMACNEIL APPR: JMACNEIL REV: F1	DESCRIPTION	QUALITY SYMBOLS	GENERAL TOLERANCES (UNLESS SPECIFIED)		DIMENSION STYLE IN/MM		SCALE 5:1	DESIGN UNITS INCH	THIRD ANGLE PROJECTION			
		▽=0	mm	INCH	DRAWN BY	DATE	STEP DOWN BUTT CONNECTOR VERSAKRIMP					
		▽=0	4 PLACES	± ---	± ---	RMARSHALL						91/10/28
		3 PLACES	± ---	± ---	CHECKED BY	DATE						
		2 PLACES	± ---	± ---	RDEROSS	91/10/28	MOLEX MOLEX INCORPORATED					
		1 PLACE	± ---	± ---	APPROVED BY	DATE						
		ANGULAR ± ---°		RDEROSS	91/10/28							
DRAFT WHERE APPLICABLE MUST REMAIN WITHIN DIMENSIONS		MATERIAL NO.		SEE CHART		DOCUMENT NO. SD-19215-004		SHEET NO. 1 OF 1				
		SIZE B	THIS DRAWING CONTAINS INFORMATION THAT IS PROPRIETARY TO MOLEX INCORPORATED AND SHOULD NOT BE USED WITHOUT WRITTEN PERMISSION									

Mouser Electronics

Authorized Distributor

Click to View Pricing, Inventory, Delivery & Lifecycle Information:

Molex:

19215-0025