

A

A

B

B

C

C

D

D



Copyright FCI.

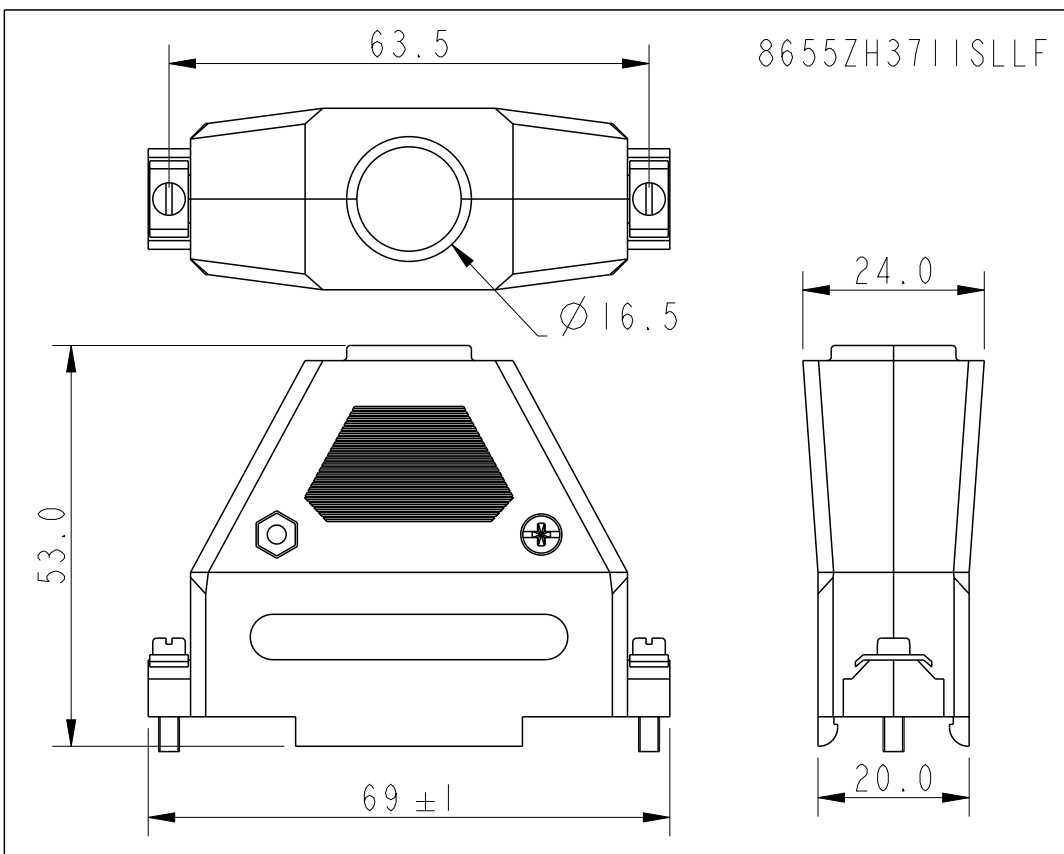
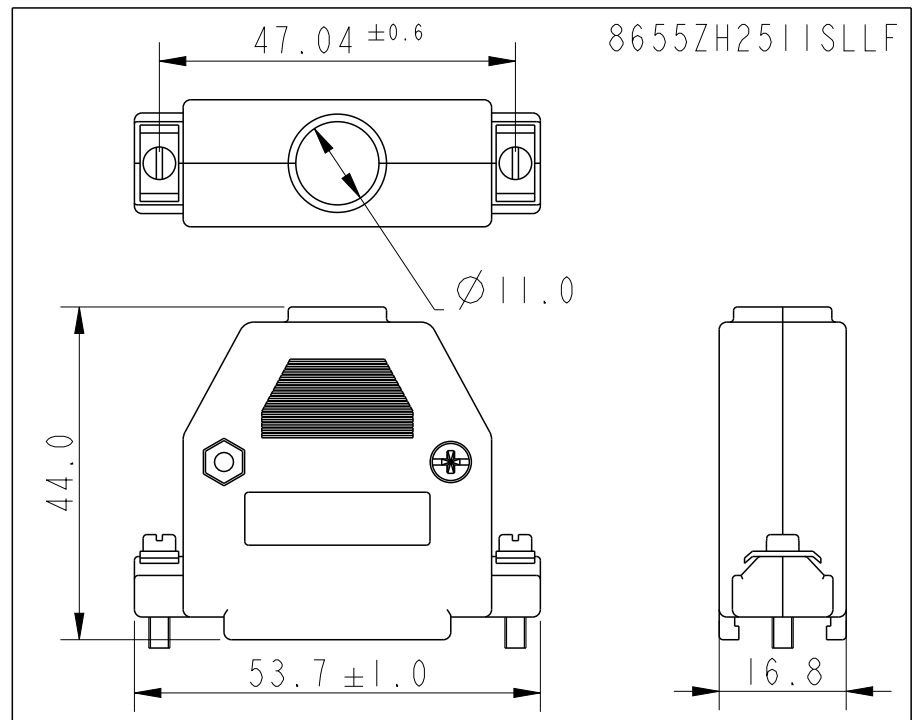
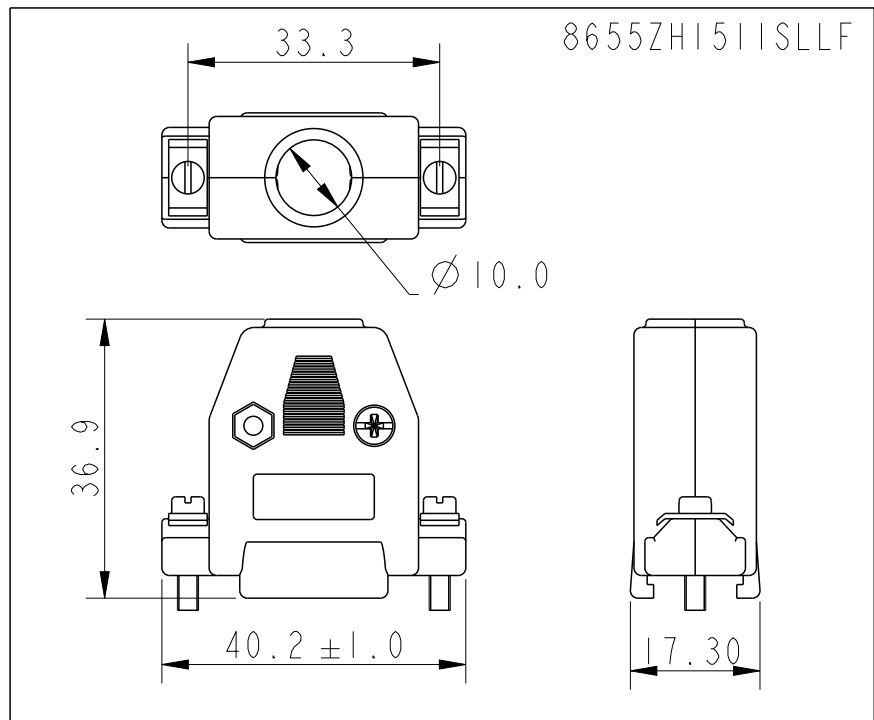
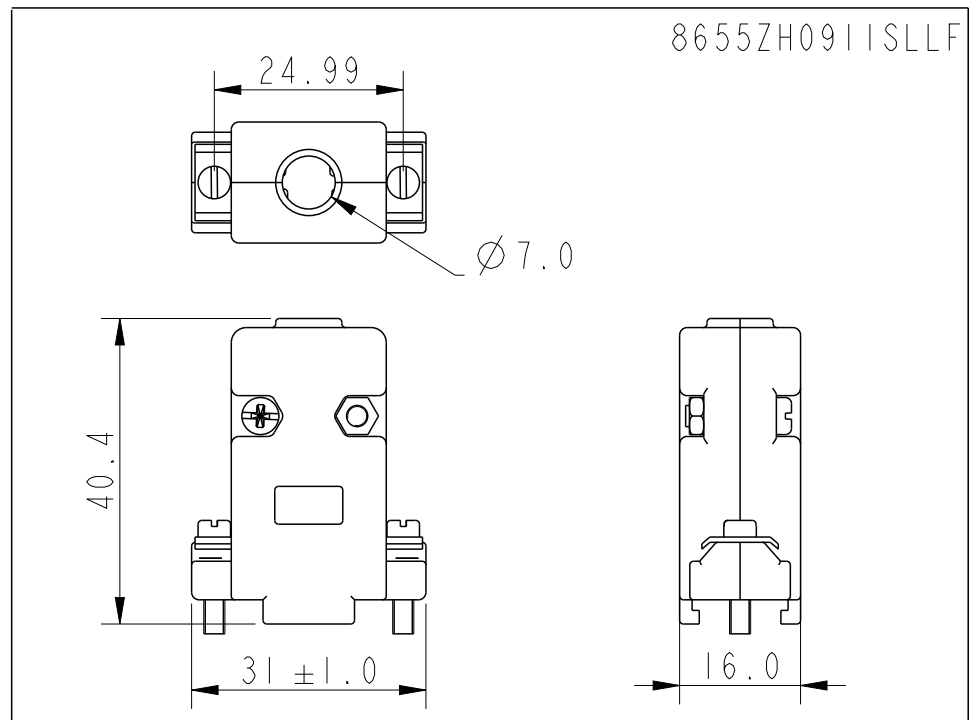

EXPLODED VIEW

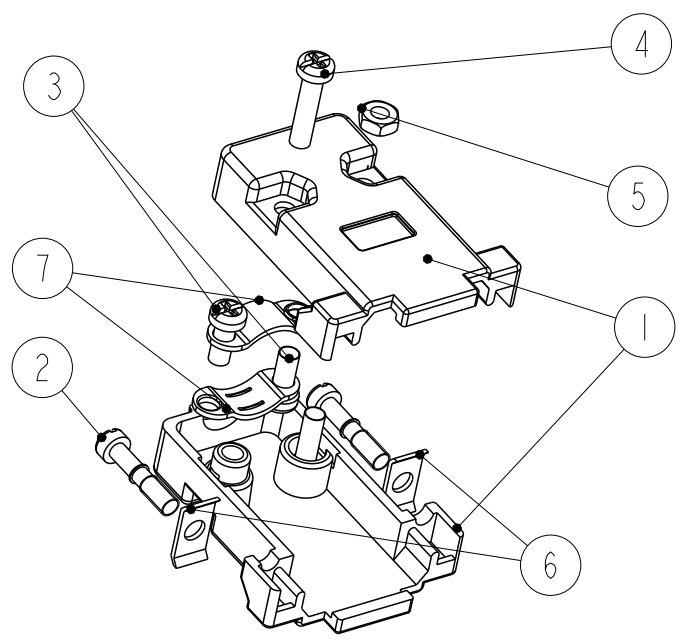

ASSEMBLED VIEW

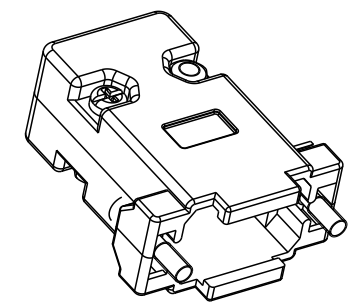

NOTES:
1) OPERATING TEMPERATURE: -55°C to +70°C
2) INDIVIDUAL KITS SEALED IN PLASTIC COVER IN UNASSEMBLED FORM WITH HOOD & METAL ACCESSORIES SEALED IN TWO SEPARATE HALVES.
BOM AS SHOWN IN TABLE

NOTE:RoHS INFORMATION

- The LF product meets European union Directives and other country regulations as described in GS-47-0004.
- The product is not indented to be exposed to a manufacturing solder process.

BILL OF MATERIAL			
ITEM	DESCRIPTION	QTY	MATERIAL
1	METALIZED HOODS	2 PCS	ABS UL 94- CHROME FINISH
2	SPECIAL SCREW	2 PCS	STEEL- Ni PLATED
3	CLAMP SCREWS	2 PCS	STEEL- Ni PLATED
4	HOOD SCREWS	2 PCS	STEEL- Ni PLATED
5	HEXAGONAL NUT	2 PCS	STEEL- Ni PLATED
6	SADDLE WASHER	2 PCS	STEEL- Ni PLATED
7	STRAIN RELEIF CLAMP	2 PCS	STEEL- Ni PLATED

spec ref		dr	Paul Mithun	2013/12/11	projection 	MM ←→	size	A3	scale	1:1
tolerance std		eng	Paul Mithun	2013/12/11			ecn no			-
ISO 406 ISO 1101		chr	-	-			rel level			Released
surface		appr	K-Paul Biju	2013/12/11			product family			-
ISO 1302		linear		0.X	±0.7	FCI		dwg no		10125252
				0.XX	±0.5	METALIZED HOODS				rev
				0.XXX	±0.5	FOR 9-37 Posns				A
		angular		0°	±2°	www.fci.com		cat. no.		--
								Product - Customer Drw		sheet 1 of 1

Mouser Electronics

Authorized Distributor

Click to View Pricing, Inventory, Delivery & Lifecycle Information:

[FCI / Amphenol:](#)

[8655ZH1511SLLF](#) [8655ZH3711SLLF](#) [8655ZH2511SLLF](#) [8655ZH0911SLLF](#)