

Panduit Part number	Wire range AWG (mm ²)	Tab Size	Housing color	Dim. "F"	Dim. "W"	Dim. "L"	Maximum Wire Insulation Diameter	MINIMUM Wire Insulation Diameter	Tools
DNG18-187FB	22-18 (0.5 - 1.0)	.187 X .032	Red	.22 (5.6)	.29 (7.4)	.89 (22.6)	.126 (3.20)	.050 (1.27)	CT-1015
DNG18-188FB	22-18 (0.5 - 1.0)	.187 X .020	Red	.22 (5.6)	.29 (7.4)	.89 (22.6)	.126 (3.20)	.050 (1.27)	
DNG18-250FB	22-18 (0.5 - 1.0)	.250 X .032	Red	.22 (5.6)	.35 (8.9)	.93 (23.6)	.126 (3.20)	.050 (1.27)	
* DNG14-187FB	16-14 (1.5 - 2.5)	.187 X .032	Blue	.25 (6.4)	.29 (7.4)	.89 (22.6)	.153 (3.89)	.070 (1.78)	
* DNG14-188FB	16-14 (1.5 - 2.5)	.187 X .020	Blue	.25 (6.4)	.29 (7.4)	.89 (22.6)	.153 (3.89)	.070 (1.78)	
DNG14-250FB	16-14 (1.5 - 2.5)	.250 X .032	Blue	.25 (6.4)	.35 (8.9)	.93 (23.6)	.153 (3.89)	.070 (1.78)	

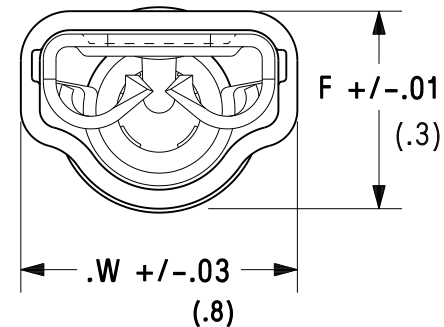

- Notes:
- Used for:
 - A. 600V max voltage rating
 - B. 221°F (105°C) max temperature rating
 - C. Stranded copper wire only
 - Wire strip length:
 - 250: $1/4 \begin{smallmatrix} +1/32 \\ -0 \end{smallmatrix}$ (6.4 $\begin{smallmatrix} +.8 \\ -0 \end{smallmatrix}$)
 - 187/188: $9/32 \begin{smallmatrix} +1/32 \\ -0 \end{smallmatrix}$ (7.1 $\begin{smallmatrix} +.8 \\ -0 \end{smallmatrix}$)
 - Material:
 - A. Stamping - Tin plated brass
 - B. Housing - Nylon
 - SEE www.panduit.com FOR PART NUMBER SUFFIX DESIGNATION FOR PACKAGE SIZE.
 - Dimensions in brackets are in millimeters or mm²
 - DNG14-187FB AND DNG14-188FB ARE UL RECOGNIZED FOR USE WITH COPPER ALLOY TABS.

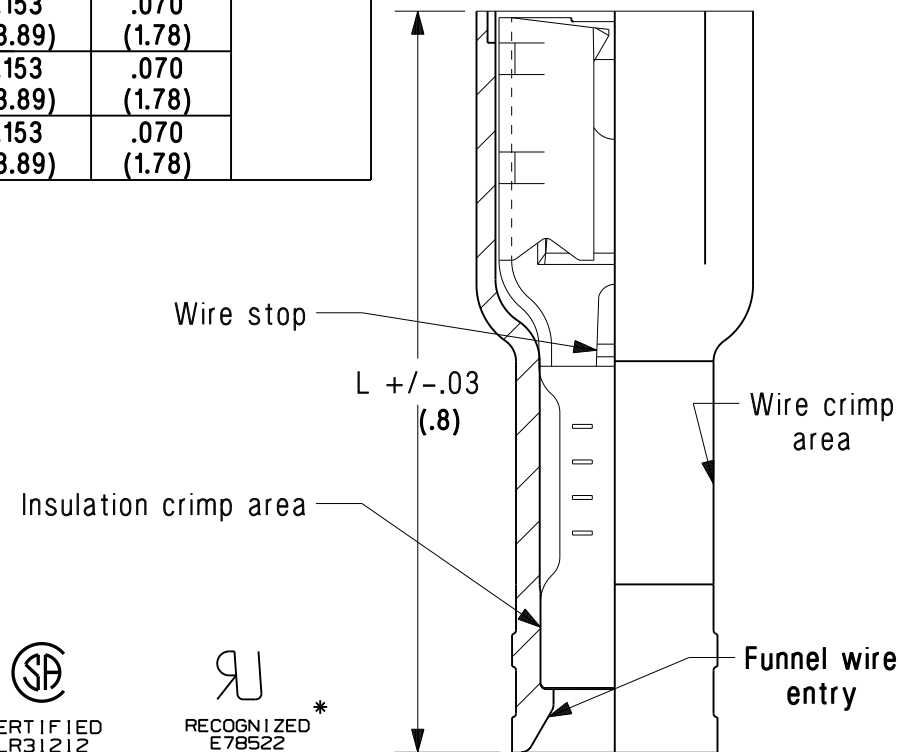

PANDUIT CORP. TINLEY PARK, ILLINOIS

08	8/11	SHOR	MODIFIED NOTE #4, REMOVED PACKAGE SIZES		
07	02/11	SRB	Added Packaging code L= 50 pieces		
REV	DATE	BY	DESCRIPTION	PM	CUST

Supra-Grip™					
Fully Insulated Loose Piece Female Disconnect					
DRAWN BY	CHK'D	SCALE	DRAWING NO./CAD FILENAME		
BDK	RLS	None	A41570		

Mouser Electronics

Authorized Distributor

Click to View Pricing, Inventory, Delivery & Lifecycle Information:

[Panduit:](#)

[DNG18-250FB-L](#) [DNG18-187FB-C](#) [DNG18-250FB-M](#) [DNG18-188FB-C](#) [DNG14-188FB-L](#) [DNG14-250FB-M](#)
[DNG14-187FB-L](#) [DNG14-250FB-L](#)