

Part Number & Date Code Printing

PC card drilling dimensions(after plating)
(thickness 1.60±0.20mm)

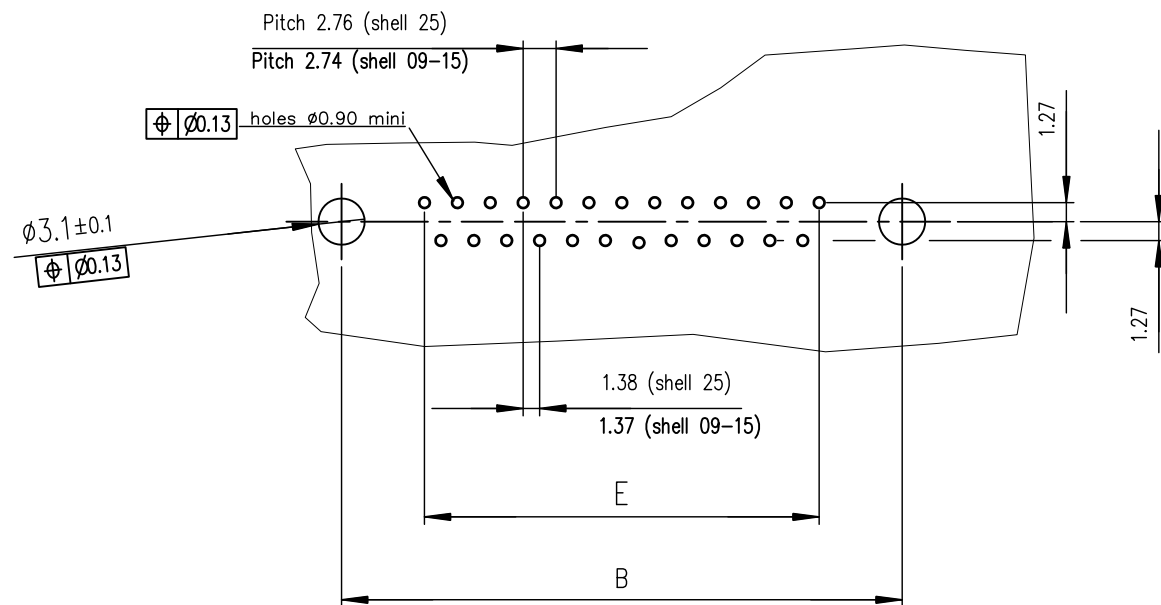

Pull Parts								
SHELL	A±0.38	B±0.12	C±0.10	D±0.25	E±0.07	G±0.25	PART NUMBER	LEAD FREE P/NO
09	30.81	24.99	16.96	16.79	10.96	5.90	D09P13A4GL00	D09P13A4GL00LF
15	39.14	33.32	25.18	25.12	19.18	5.90	D15P13A4GL00	D15P13A4GL00LF
25	53.03	47.04	39.12	38.84	33.12	5.70	D25P13A4GL00	D25P13A4GL00LF

GENERAL CHARACTERISTICS SEE: DRAWING C01-8646-0000

mat'l. code SEE NOTES				surface ISO 1302 ✓		tolerance ISO 406 ISO 1101		projection MM		product family D-SUB	
ltr				ecn no		dr		date		title	
G				I05-0124		JS		2005/07/27		MALE CONNECT. DELTA D RIGHT ANGLED	
H				I06-0074		RPK		2006/06/08		WITH NUT, HARPOON & METAL PLATE	
J				I11-0191		RPK		2011/11/30		scale 2:1	
K				ELXI-I-15060		AB		2013/06/25		dwg no sheet 1 of 1 size 5	
						dr		JOHN.SLEEBA 1994-08-01		C01-8646-0164 A3	
						enr		ALIAS.BABU 2013/06/25		FCJ	
						chr		MITHUN.PAUL 2013/06/25		type CUSTOMER Drawing	
						appd		BIJU.K..PAUL 2013/06/25			
sheet index		revision sheet		K		1					

Mouser Electronics

Authorized Distributor

Click to View Pricing, Inventory, Delivery & Lifecycle Information:

[FCI / Amphenol:](#)

[D09P13A4GL00LF](#) [D15P13A4GL00LF](#) [D25P13A4GL00LF](#)