

## Plug - PTDA 1,5/ 5-PH-3,5 - 1725146

Please be informed that the data shown in this PDF Document is generated from our Online Catalog. Please find the complete data in the user's documentation. Our General Terms of Use for Downloads are valid (<http://phoenixcontact.com/download>)

Plug component, Nominal current: 8 A, Rated voltage (III/2): 240 V, Number of positions: 5, Pitch: 3.5 mm, Connection method: Push-in spring connection, Color: green, Contact surface: Tin



The figure shows a 10-position version of the product

### Product Features

- 3.5 mm pitch
- Large terminal block capacity with compact dimensions
- Attractive design for connection at a glance
- Optional color coding
- Spring-cage double connection with direct plug-in technology with a release button
- Plug with optional mechanical coding

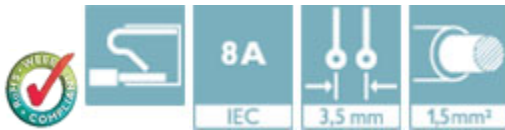

### Key Commercial Data

|                                      |          |
|--------------------------------------|----------|
| Packing unit                         | 1 pc     |
| Minimum order quantity               | 100 pc   |
| Weight per Piece (excluding packing) | 6.65 g   |
| Custom tariff number                 | 85366990 |
| Country of origin                    | Germany  |

### Technical data

#### Dimensions

|             |         |
|-------------|---------|
| Pitch       | 3.50 mm |
| Dimension a | 14 mm   |

#### General

|                           |                |
|---------------------------|----------------|
| Range of articles         | PTDA 1,5/..-PH |
| Insulating material group | I              |

## Plug - PTDA 1,5/ 5-PH-3,5 - 1725146

### Technical data

#### General

|  |                     |
|--|---------------------|
| Rated surge voltage (III/3)            | 2.5 kV              |
| Rated surge voltage (III/2)            | 2.5 kV              |
| Rated surge voltage (II/2)             | 2.5 kV              |
| Rated voltage (III/3)                  | 160 V               |
| Rated voltage (III/2)                  | 240 V               |
| Rated voltage (II/2)                   | 400 V               |
| Connection in acc. with standard       | EN-VDE              |
| Nominal current $I_N$                  | 8 A                 |
| Nominal cross section                  | 1.5 mm <sup>2</sup> |
| Maximum load current                   | 8 A                 |
| Insulating material                    | PA                  |
| Flammability rating according to UL 94 | V0                  |
| Stripping length                       | 10 mm               |
| Number of positions                    | 5                   |

#### Connection data

|   |                     |
|---|---------------------|
| Conductor cross section solid min.  | 0.2 mm <sup>2</sup> |
| Conductor cross section solid max.  | 1.5 mm <sup>2</sup> |
| Conductor cross section flexible min.   | 0.2 mm <sup>2</sup> |
| Conductor cross section flexible max.   | 1.5 mm <sup>2</sup> |
| Conductor cross section flexible, with ferrule without plastic sleeve min.              | 0.5 mm <sup>2</sup> |
| Conductor cross section flexible, with ferrule without plastic sleeve max.              | 1.5 mm <sup>2</sup> |
| Conductor cross section flexible, with ferrule with plastic sleeve min.                 | 0.5 mm <sup>2</sup> |
| Conductor cross section flexible, with ferrule with plastic sleeve max.                 | 0.5 mm <sup>2</sup> |
| Conductor cross section AWG min.  | 24                  |
| Conductor cross section AWG max.  | 16                  |
| 2 conductors with same cross section, solid min.  | 0.2 mm <sup>2</sup> |
| 2 conductors with same cross section, solid max.  | 1.5 mm <sup>2</sup> |
| 2 conductors with same cross section, stranded min.                                     | 0.2 mm <sup>2</sup> |
| 2 conductors with same cross section, stranded max.                                     | 1.5 mm <sup>2</sup> |
| 2 conductors with same cross section, stranded, ferrules without plastic sleeve, min.   | 0.5 mm <sup>2</sup> |
| 2 conductors with same cross section, stranded, ferrules without plastic sleeve, max.   | 1.5 mm <sup>2</sup> |
| 2 conductors with same cross section, stranded, TWIN ferrules with plastic sleeve, min. | 0.5 mm <sup>2</sup> |
| 2 conductors with same cross section, stranded, TWIN ferrules with plastic sleeve, max. | 0.5 mm <sup>2</sup> |
| Minimum AWG according to UL/CUL   | 24                  |

# Plug - PTDA 1,5/ 5-PH-3,5 - 1725146

## Technical data

### Connection data

|                                 |    |
|---------------------------------|----|
| Maximum AWG according to UL/CUL | 16 |
|---------------------------------|----|

### Standards and Regulations

|  |        |
|--|--------|
| Connection in acc. with standard       | EN-VDE |
|  | CUL    |
| Flammability rating according to UL 94 | V0     |

## Classifications

### eCl@ss

|            |          |
|------------|----------|
| eCl@ss 4.0 | 272607xx |
| eCl@ss 4.1 | 27141109 |
| eCl@ss 5.0 | 27141190 |
| eCl@ss 5.1 | 27141190 |
| eCl@ss 6.0 | 27261101 |
| eCl@ss 7.0 | 27440401 |
| eCl@ss 8.0 | 27440309 |
| eCl@ss 9.0 | 27440309 |

### ETIM

|          |          |
|----------|----------|
| ETIM 3.0 | EC001121 |
| ETIM 4.0 | EC002638 |
| ETIM 5.0 | EC002638 |

### UNSPSC

|               |          |
|---------------|----------|
| UNSPSC 6.01   | 30211801 |
| UNSPSC 7.0901 | 39121432 |
| UNSPSC 11     | 34131203 |
| UNSPSC 12.01  | 39121432 |
| UNSPSC 13.2   | 39121432 |

## Approvals

### Approvals

---

#### Approvals

UL Recognized / cUL Recognized / EAC / EAC / cULus Recognized

---

# Plug - PTDA 1,5/ 5-PH-3,5 - 1725146

## Approvals

Ex Approvals

---

Approvals submitted

---

### Approval details

|                                |       |       |
|--------------------------------|-------|-------|
| UL Recognized                  |       |       |
|                                | B     | D     |
| mm <sup>2</sup> /AWG/kcmil     | 24-16 | 24-16 |
| Nominal current I <sub>N</sub> | 10 A  | 10 A  |
| Nominal voltage U <sub>N</sub> | 150 V | 300 V |

|                                |       |       |
|--------------------------------|-------|-------|
| cUL Recognized                 |       |       |
|                                | B     | D     |
| mm <sup>2</sup> /AWG/kcmil     | 24-16 | 24-16 |
| Nominal current I <sub>N</sub> | 10 A  | 10 A  |
| Nominal voltage U <sub>N</sub> | 150 V | 300 V |

|     |
|-----|
| EAC |
|-----|

|     |
|-----|
| EAC |
|-----|

|                  |
|------------------|
| cULus Recognized |
|------------------|

## Accessories

Additional products

# Plug - PTDA 1,5/ 5-PH-3,5 - 1725146

## Accessories

Pin strip - PST 1,0/ 5-3,5 R56 - 1720259



Header, Nominal current: 8 A, Rated voltage (III/2): 250 V, Number of positions: 5, Pitch: 3.5 mm, Color: black, Contact surface: Tin, Mounting: THR soldering, The maximum current depends on the plug used. The lower of the two current values apply for plug and pin strip. The pin strip is made of highly temperature resistant plastic and is thus suitable for the reflow process.

Pin strip - PST 1,0/ 5-3,5 - 1945122



Header, Nominal current: 8 A, Rated voltage (III/2): 250 V, Number of positions: 5, Pitch: 3.5 mm, Color: black, Contact surface: Tin, Mounting: THR soldering, The maximum current depends on the plug used. The lower of the two current values apply for plug and pin strip. The pin strip is made of highly temperature resistant plastic and is thus suitable for the reflow process.

Screwdriver - SZF 0-0,4X2,5 - 1204504



Actuation tool, for ST terminal blocks, also suitable for use as a bladed screwdriver, size: 0.4 x 2.5 x 75 mm, 2-component grip, with non-slip grip

Coding profile - CP-PTDA - 1731361

## Drawings

Diagram

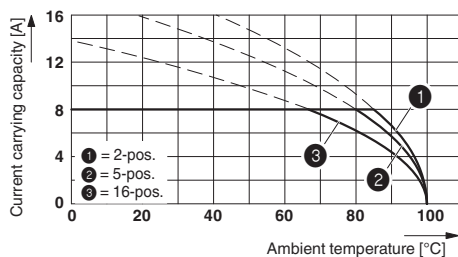

Dimensional drawing

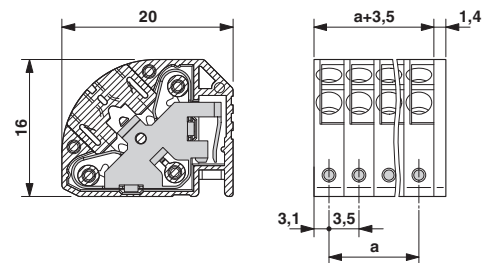

Derating curve for: PTDA 1,5/..-PH-3,5 with PST 1,0/..-3,5



# Mouser Electronics

Authorized Distributor

Click to View Pricing, Inventory, Delivery & Lifecycle Information:

[Phoenix Contact:](#)

[1725146](#)