

EVEREADY 1235



SUPER HEAVY DUTY



Industry Standard Dimensions

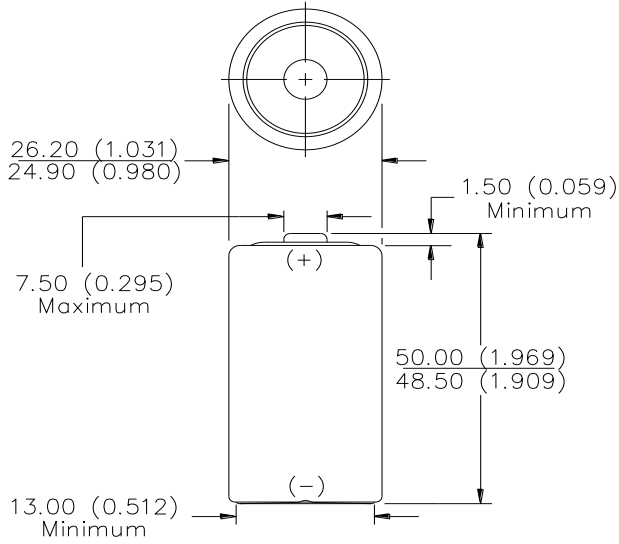

Chemical System: Zinc-Manganese Dioxide (Zn/MnO₂)
(No Added Mercury or Cadmium)

Designation: ANSI-14D, IEC-R14

Battery Voltage: 1.5 Volts

Operating Temp: -18°C to 55°C (0°F to 130°F)

Average Weight: 45.0 grams (1.6 oz.)

Volume: 25 cubic centimeters (1.5 cubic inch)

Average Capacity: 3800 mAh to 0.8 volts
(Rated at 25 mA continuous at 21°C)

Cell: One No. 35 (size "C")

Jacket: Metal

TYPICAL TEMPERATURE EFFECT
3.9 ohm - 4 hours/day to 0.75 volts

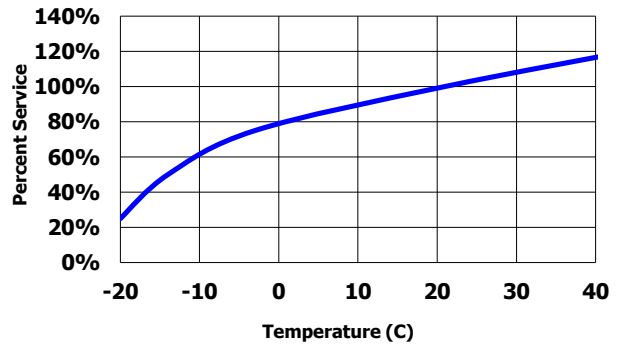

CONSTANT RESISTANCE PERFORMANCE
Typical Service

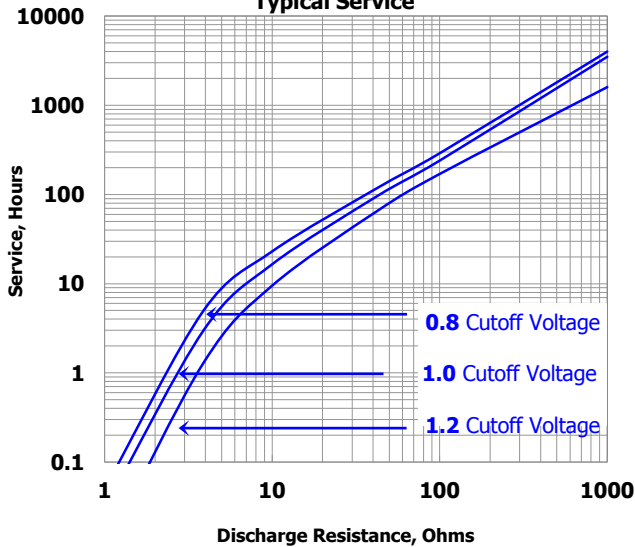

CONSTANT CURRENT DISCHARGE
Typical Service

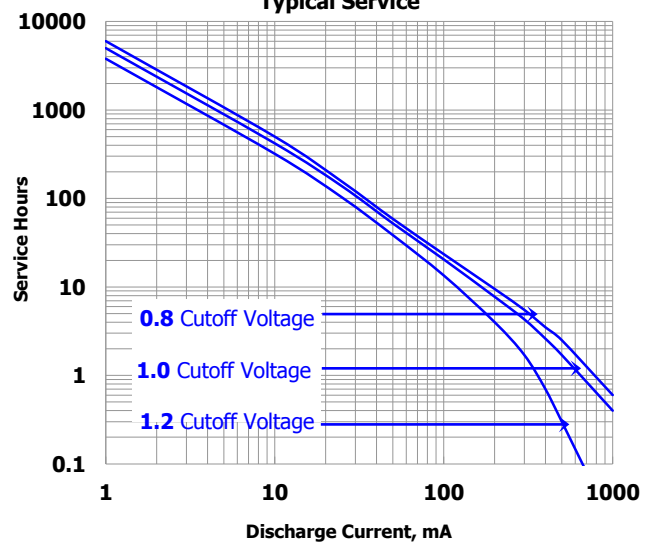

Important Notice

This datasheet contains typical information specific to products manufactured at the time of its publication.
Contents herein do not constitute a warranty and are for reference only.

EVEREADY 1235

ANSI Industry Standard Tests @ 20° C

RADIO
20 ohm - 4 hours/day

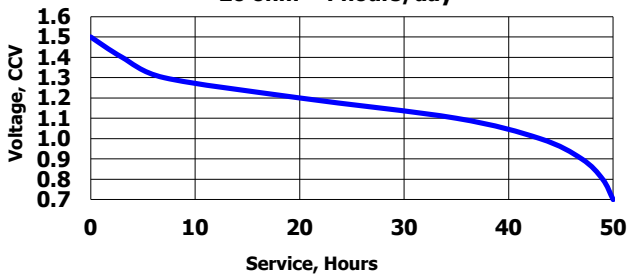

PORTABLE STEREO
6.8 ohm - 1 hr/day

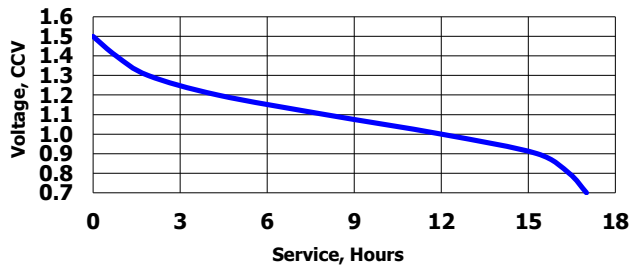

TOY
3.9 ohm - 1 hr/day



PORTABLE LIGHT
3.9 ohms - 4 min/hour 8 hours/day

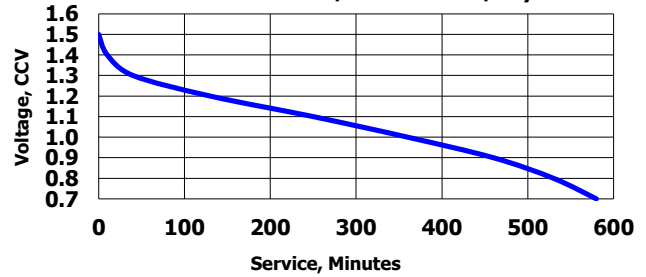

Important Notice

This datasheet contains typical information specific to products manufactured at the time of its publication.
Contents herein do not constitute a warranty and are for reference only.