

| REVISIONS |      |                           |           |            |
|-----------|------|---------------------------|-----------|------------|
| P.        | LTN. | DESCRIPTION               | DATE      | APVD.      |
| D4        |      | REVISED PER ECR-17-014071 | 30DEC2017 | W, H, D, Z |

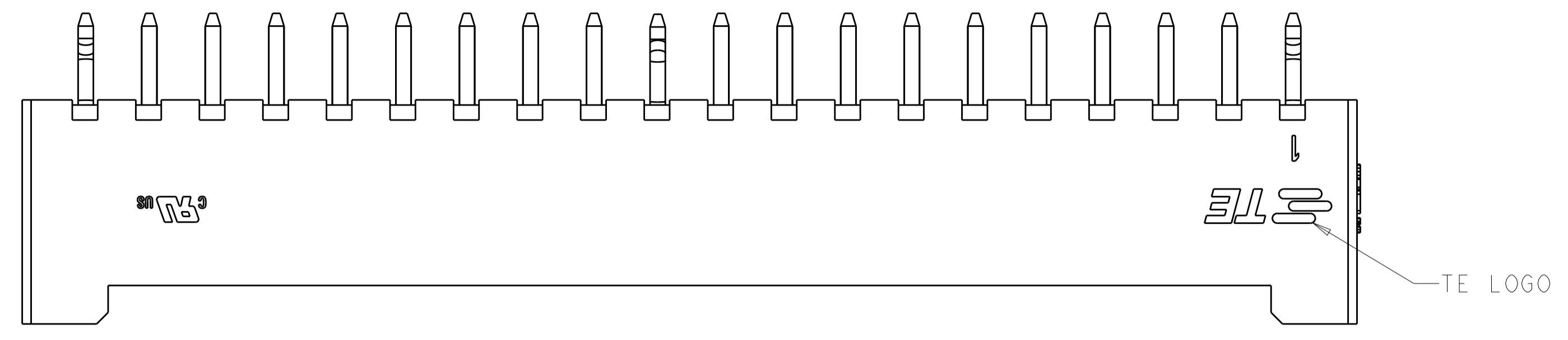

- 1 MATERIAL: HOUSING: HIGH PERFORMANCE RESIN, UL94V-0, NATURAL.  
CONTACT: BRASS, NICKEL UNDER PLATING,  
TIN PLATING ON PIN AREA.
- 2 CONTACT RETENTION: 20 NEWTON [ 4.5 lbf] MIN.
- 3 CONTACT SOLDER TAIL KINK DIRECTION SEE BELOW TABLE.

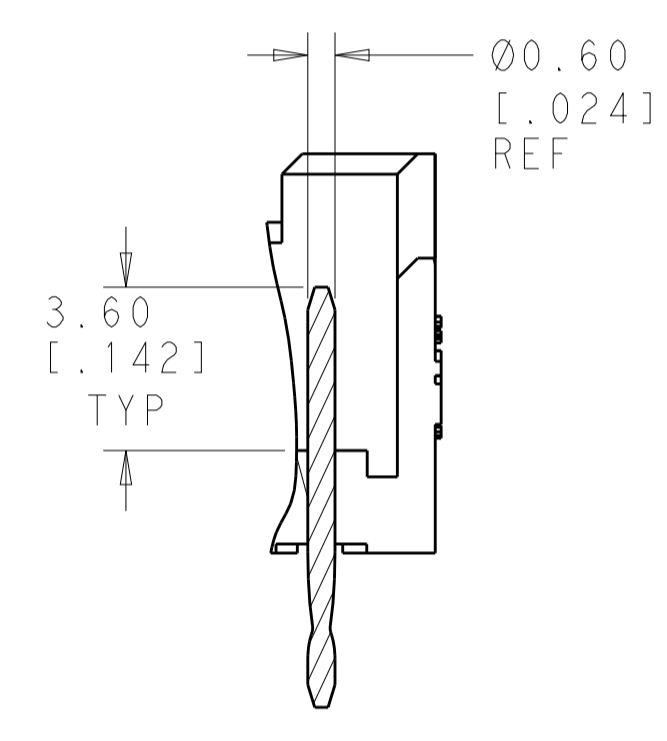
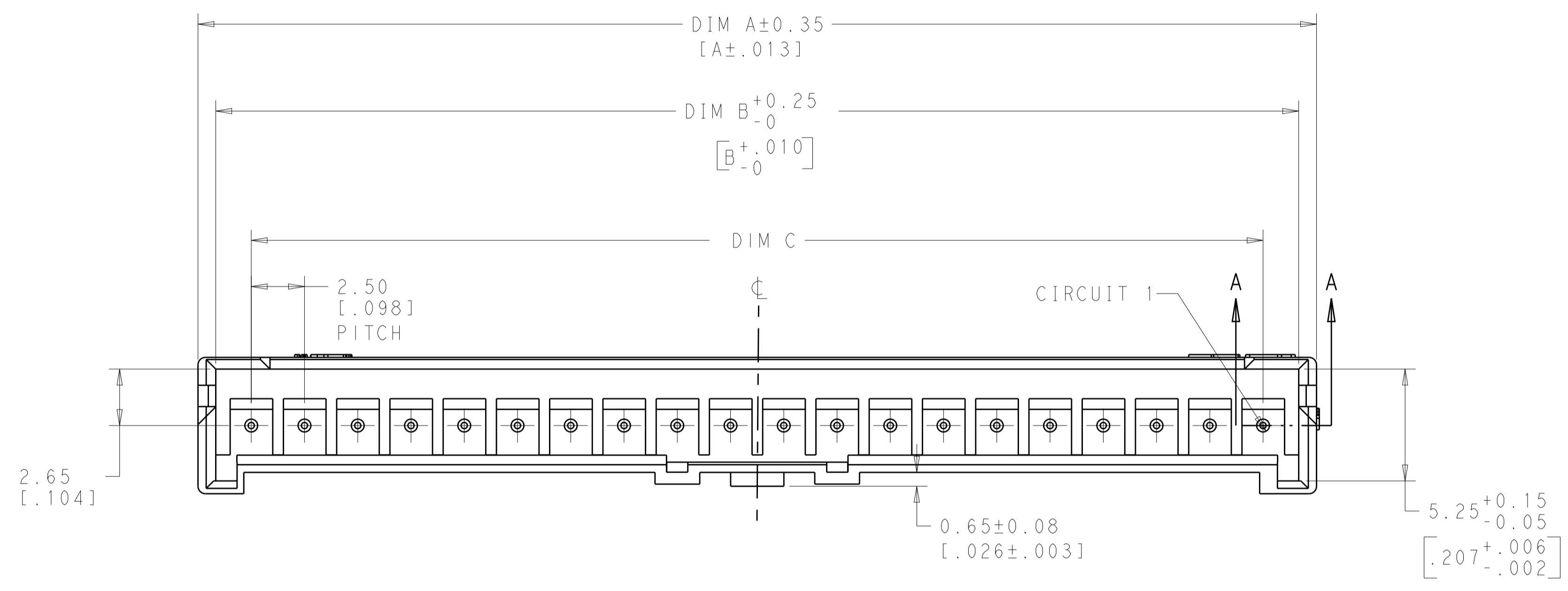

SECTION A-A

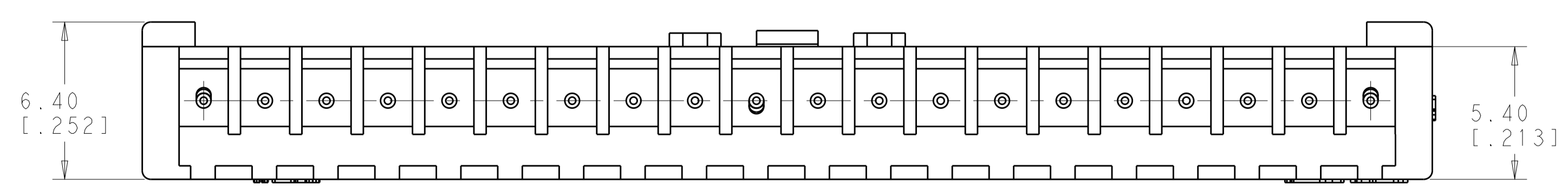
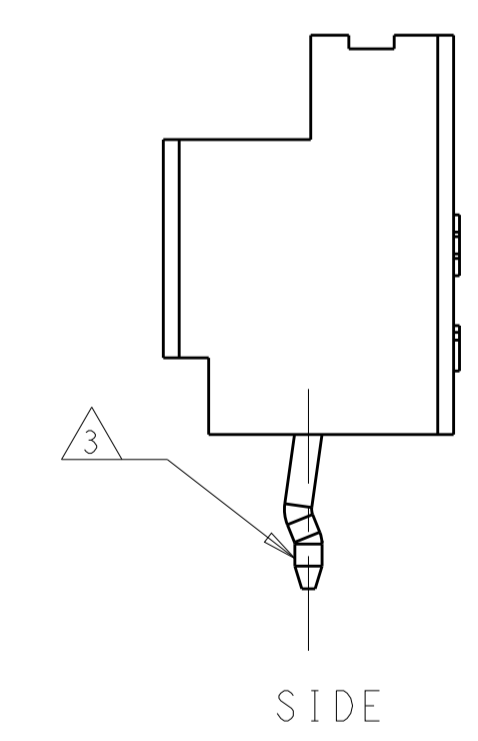
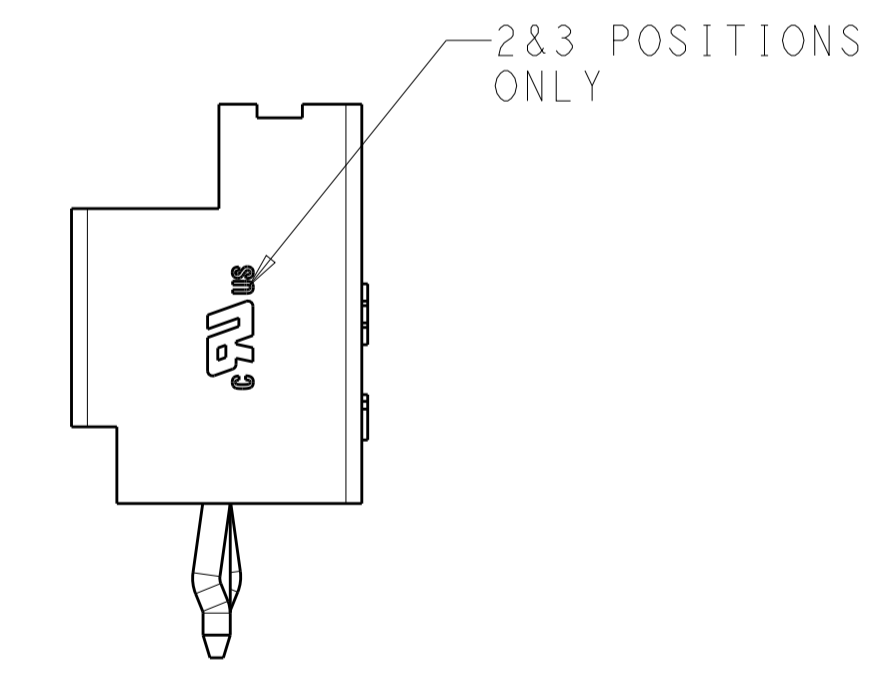
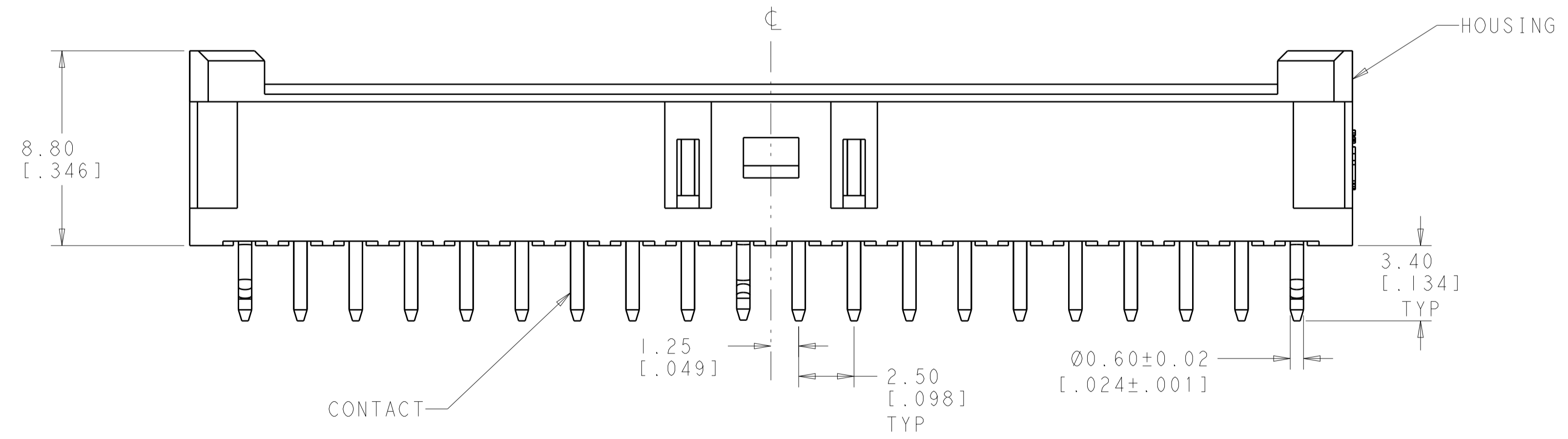
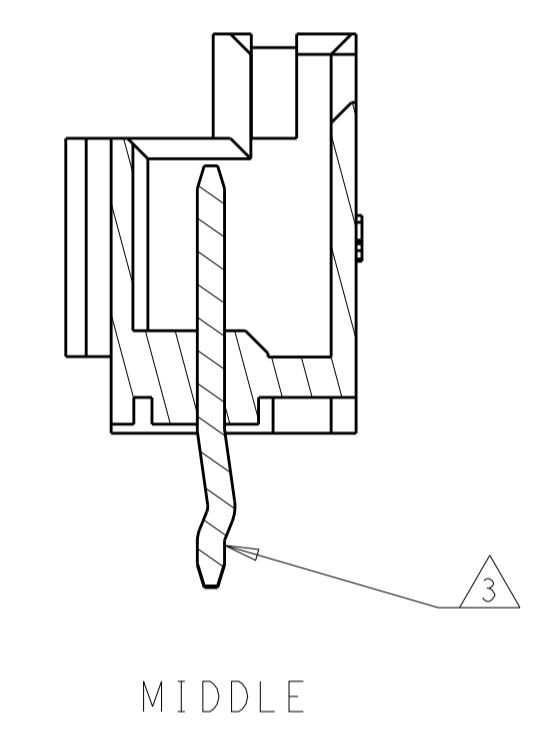

|   |  |                          |   |                  |
|---|--|--------------------------|---|------------------|
| THIS DRAWING IS A CONTROLLED DOCUMENT.  |  | OWN: RAGHAVENDRA 06JAN11 | TE Connectivity<br>NAME: HEADER ASSEMBLY, VERTICAL, ECONOMY POWER, 2.5mm CENTERLINE |                  |
| DIMENSIONS: mm [INCHES]   |  | CHK: MACE SAMUEL 06JAN11 |   |                  |
| TOLERANCES UNLESS OTHERWISE SPECIFIED:  |  | PRODUCT SPEC: 108-2418   | APPLICATION SPEC: 114-13315   | RESTRICTED TO: - |
| MATERIAL: -   |  | WEIGHT: -                | SIZE: A100779   | SCALE: 6:1       |
| FINISH: -   |  | CUSTOMER DRAWING         | CAGE CODE: C=2132415  | SHEET 1 OF 2     |
| 0 PLC ±0.50<br>1 PLC ±0.30<br>2 PLC ±0.20<br>3 PLC ±0.10<br>4 PLC ±*<br>ANGLES ±* |  | REV: D4                  |   |                  |

| REVISIONS |     |             |      |      |
|-----------|-----|-------------|------|------|
| P.        | LTN | DESCRIPTION | DATE | APPD |
| -         | -   | SEE SHEET 1 | -    | -    |

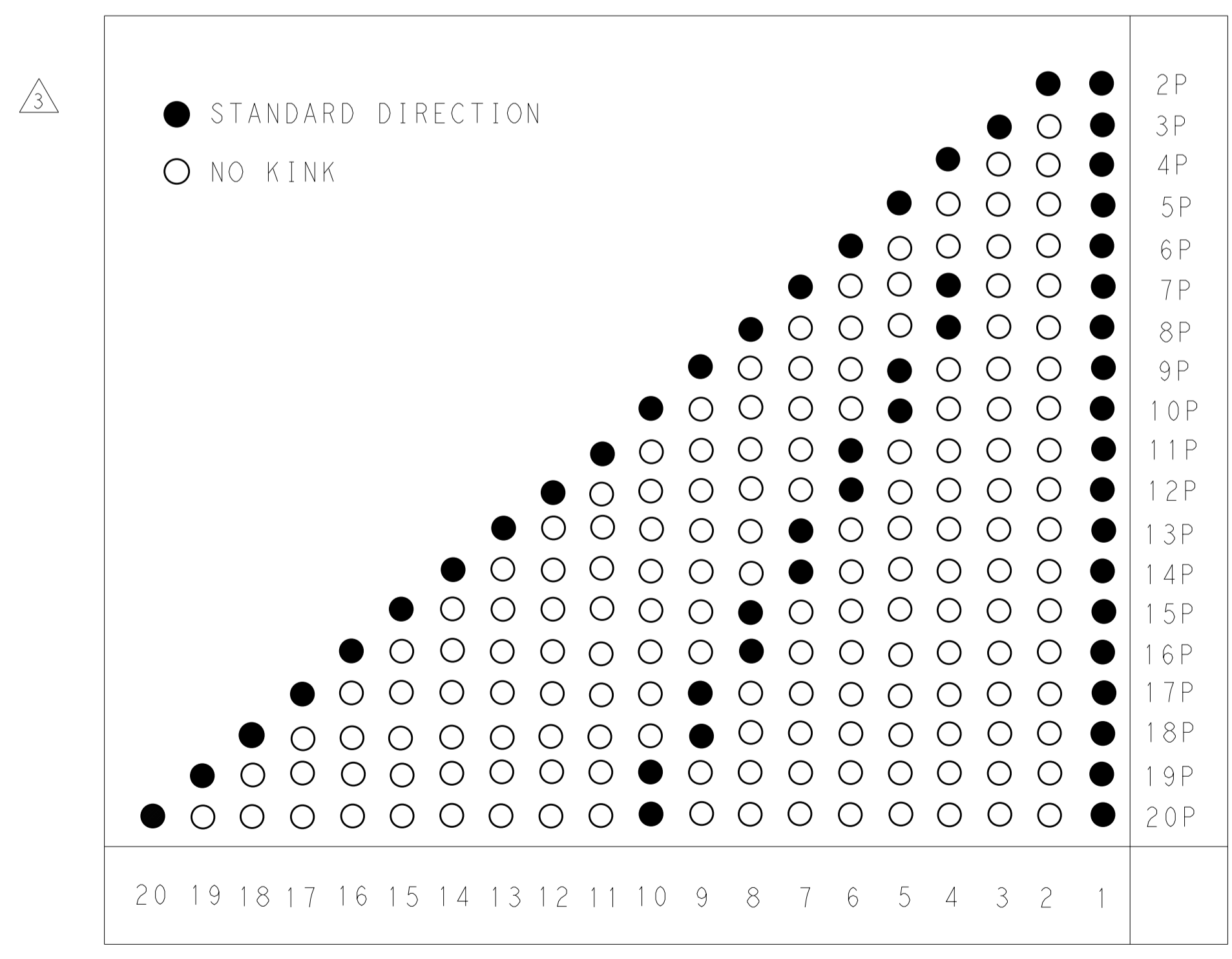
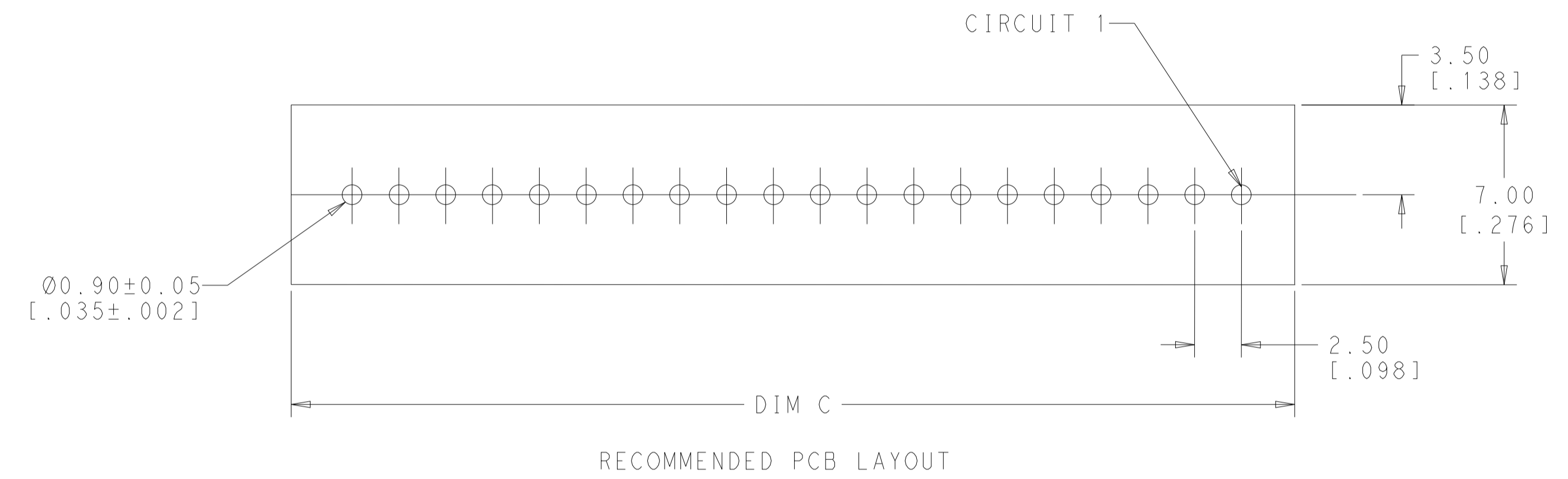
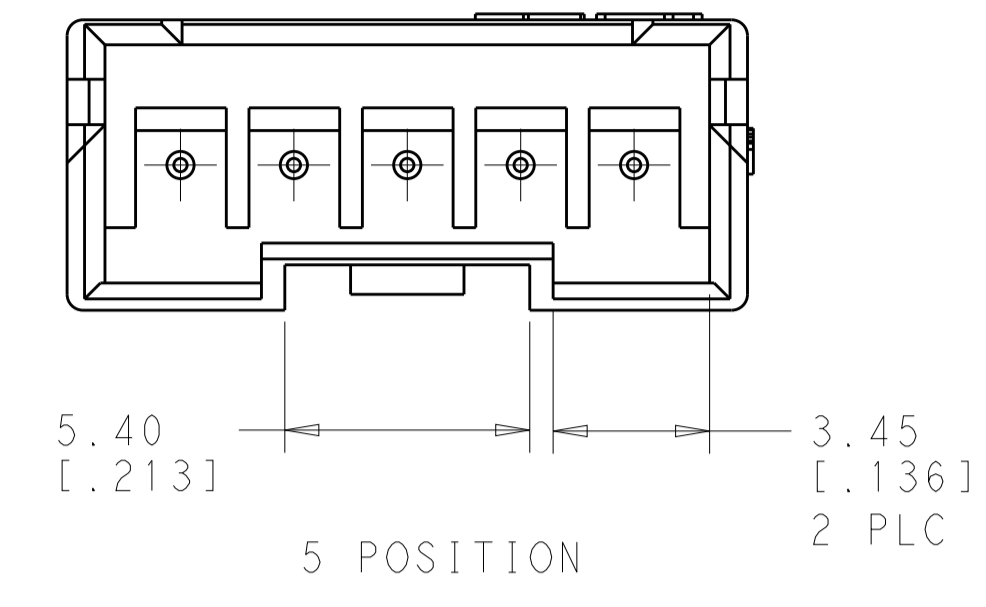
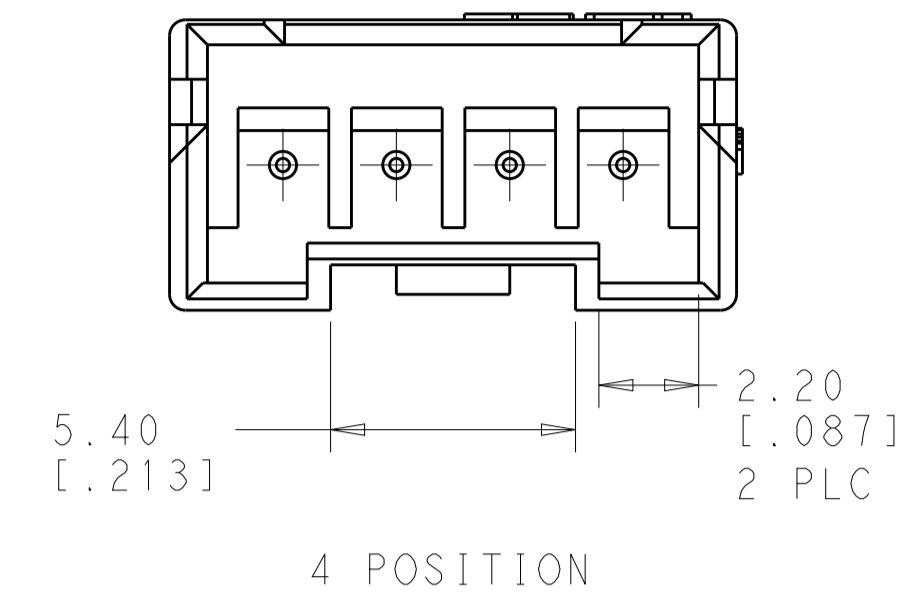
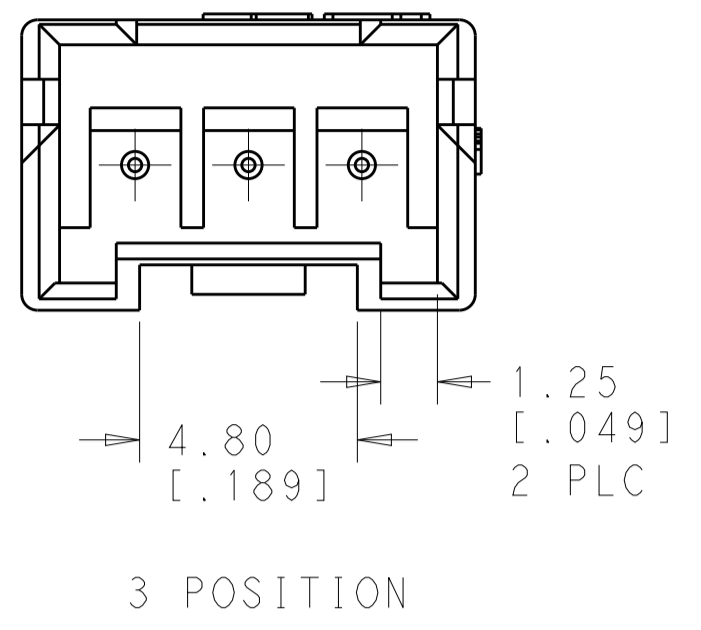
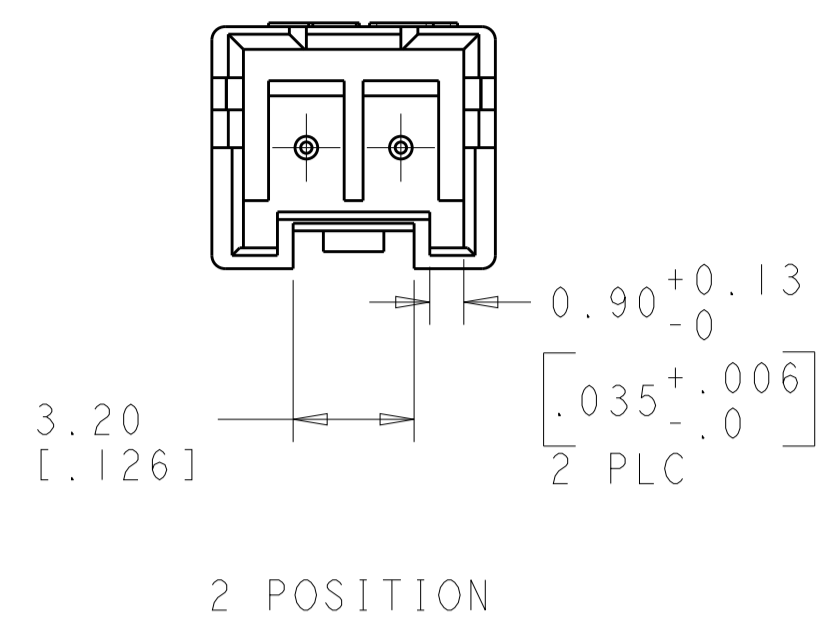

|              |              |              |     |             |
|--------------|--------------|--------------|-----|-------------|
| 47.50[1.870] | 50.83[2.001] | 52.50[2.067] | 20  | 2-2132415-0 |
| 45.00[1.772] | 48.33[1.903] | 50.00[1.968] | 19  | 1-2132415-9 |
| 42.50[1.673] | 45.83[1.804] | 47.50[1.870] | 18  | 1-2132415-8 |
| 40.00[1.575] | 43.33[1.706] | 45.00[1.772] | 17  | 1-2132415-7 |
| 37.50[1.476] | 40.83[1.607] | 42.50[1.673] | 16  | 1-2132415-6 |
| 35.00[1.378] | 38.33[1.510] | 40.00[1.575] | 15  | 1-2132415-5 |
| 32.50[1.280] | 35.83[1.411] | 37.50[1.476] | 14  | 1-2132415-4 |
| 30.00[1.181] | 33.33[1.312] | 35.00[1.378] | 13  | 1-2132415-3 |
| 27.50[1.083] | 30.83[1.214] | 32.50[1.280] | 12  | 1-2132415-2 |
| 25.00[.984]  | 28.33[1.115] | 30.00[1.181] | 11  | 1-2132415-1 |
| 22.50[.886]  | 25.83[1.016] | 27.50[1.083] | 10  | 1-2132415-0 |
| 20.00[.787]  | 23.33[.919]  | 25.00[.984]  | 9   | 2132415-9   |
| 17.50[.689]  | 20.83[.820]  | 22.50[.886]  | 8   | 2132415-8   |
| 15.00[.591]  | 18.33[.722]  | 20.00[.787]  | 7   | 2132415-7   |
| 12.50[.492]  | 15.83[.623]  | 17.50[.689]  | 6   | 2132415-6   |
| 10.00[.395]  | 13.33[.525]  | 15.00[.591]  | 5   | 2132415-5   |
| 7.50[.295]   | 10.83[.426]  | 12.50[.492]  | 4   | 2132415-4   |
| 5.00[.197]   | 8.33[.328]   | 10.00[.395]  | 3   | 2132415-3   |
| 2.50[.098]   | 5.83[.229]   | 7.50[.295]   | 2   | 2132415-2   |
| DIM C        | DIM B        | DIM A        | POS | PART NO     |

THIS DRAWING IS A CONTROLLED DOCUMENT. DWN: BRAGHAVENDRA 06JAN11  
CHK: MACE SAMUEL 06JAN11

DIMENSIONS: mm [INCHES] TOLERANCES UNLESS OTHERWISE SPECIFIED:  
0 PLC ±0.50  
1 PLC ±0.30  
2 PLC ±0.20  
3 PLC ±0.10  
4 PLC ±.0

MATERIAL: - FINISH: -

CUSTOMER DRAWING

TE Connectivity  
NAME: HEADER ASSEMBLY, VERTICAL, ECONOMY POWER, 2.5mm CENTERLINE  
PRODUCT SPEC: 108-2418  
APPLICATION SPEC: 114-13315

SIZE: A1 CAGE CODE: 100779 DRAWING NO: 2132415  
RESTRICTED TO: -  
SCALE: 6:1 SHEET: 2 OF 2 REV: D4

# Mouser Electronics

Authorized Distributor

Click to View Pricing, Inventory, Delivery & Lifecycle Information:

[TE Connectivity:](#)

[2132415-6](#)