

REVISIONS					
P	LTR	DESCRIPTION	DATE	DWN	APVD
	H	REVISED PER ECO-16-005106	28APR2016	NK	MZ
	J	REVISED PER ECO-17-013721	15NOV2017	RS	MZ
	K	REVISED PER ECO-18-002097	14FEB2018	RS	MZ

[.45]	[.050]	A	15	9.01	[.355]	117-2	12	0.15	[.006]	01210	5-192013-0	OBSOLETE
[.52]	[.046]	A	15	8.97	[.353]	13UNPL	12	0.08	[.003]	01126	4-192013-9	△4
[.42]	[.050]	A	15	7.92	[.312]	10UNPL	13	0.15	[.006]	01116	4-192013-8	OBSOLETE
[.42]	[.052]	A	15	7.92	[.312]	107-2	12	0.20	[.008]	01118	4-192013-7	OBSOLETE
[.42]	[.050]	A	15	7.92	[.312]	106-2	12	0.15	[.006]	01217	4-192013-6	OBSOLETE
[.42]	[.050]	A	15	7.92	[.312]	107-2	12	0.15	[.006]	01117	4-192013-5	△4
[.42]	[.050]	A	15	7.92	[.312]	10UNPL	12	0.15	[.006]	01266	4-192013-4	OBSOLETE
[.42]	[.050]	A	15	7.92	[.312]	107-2	12	0.10	[.004]	01281	4-192013-3	OBSOLETE
		C	15	--	--	877-2	12	0.15	[.006]	01030	4-192013-2	OBSOLETE
1.48	[.052]	A	45	31.8	[1.250]	397-2	12	0.20	[.008]	01219	4-192013-1	OBSOLETE
1.48	[.052]	A	45	31.8	[1.250]	39UNPL	12	0.20	[.008]	01218	4-192103-0	△4
1.48	[.050]	A	45	31.8	[1.250]	397-2	12	0.15	[.006]	01209	3-192013-9	OBSOLETE
1.45	[.050]	A	45	30.1	[1.187]	387-2	12	0.15	[.006]	01193	3-192013-8	△4
1.21	[.050]	A	45	26.2	[1.032]	337-2	12	0.15	[.006]	01214	3-192013-7	OBSOLETE
1.15	[.050]	A	45	25.0	[.984]	317-2	12	0.15	[.006]	01319	3-192013-6	OBSOLETE
1.02	[.050]	A	45	21.6	[.850]	277-2	12	0.15	[.006]	01208	3-192013-5	OBSOLETE
1.05	[.050]	A	45	21.4	[.842]	287-2	12	0.15	[.006]	01165	3-192013-4	OBSOLETE
[.92]	[.052]	A	45	19.1	[.750]	247-2	12	0.20	[.008]	01300	3-192013-3	△4
--	[.050]	C	45			555-2	12	0.15	[.006]	01041	3-192013-2	△4
--	[.050]	C	45			55UNPL	12	0.15	[.006]	01044	3-192013-1	OBSOLETE
											3-192013-0	OBSOLETE
--	[.050]	C	15			487-2	12	0.15	[.006]	01043	2-192013-9	OBSOLETE
--	[.050]	C	15			417-2	12	0.15	[.006]	01027	2-192013-8	OBSOLETE
--	[.050]	C	15			417-2	12	0.10	[.004]	01028	2-192013-7	OBSOLETE
	[.050]	C	15			407-2	12	0.15	[.006]	01243	2-192013-6	OBSOLETE
--	[.050]	C	15			407-2	12	0.10	[.004]	01047	2-192013-5	△4
--	[.050]	C	45			357-2	12	0.15	[.006]	01033	2-192013-4	OBSOLETE
--	[.050]	C	15			357-2	12	0.15	[.006]	01032	2-192013-3	OBSOLETE
--	[.050]	C	15			357-2	12	0.10	[.004]	01299	2-192013-2	OBSOLETE
											2-192013-1	OBSOLETE
											2-192013-0	OBSOLETE
	[.050]	C	15			337-2	12	0.15	[.006]	01026	1-192013-9	OBSOLETE
--	[.050]	C	15			337-2	12	0.10	[.004]	01025	1-192013-8	△4
											1-192013-7	OBSOLETE
		C	15	--		207-2	12	0.15	[.006]	01035	1-192013-6	OBSOLETE
	[.050]	C	15	--		194	12	0.15	[.006]	01051	1-192013-5	OBSOLETE
		C	15	--		197-2	12	0.15	[.006]	01031	1-192013-4	OBSOLETE
	[.050]	C	15			177-2	12	0.15	[.006]	01059	1-192013-3	OBSOLETE
	[.050]	C	15			147-2	12	0.15	[.006]	01053	1-192013-2	△4
--	[.050]	C	15			134	12	0.15	[.006]	01065	1-192013-1	OBSOLETE
--	[.050]	C	15			137-2	12	0.15	[.006]	01077	△41-192013-0	OBSOLETE
--	[.050]	C	15			127-2	12	0.15	[.006]	01055	△41-192013-9	OBSOLETE
OBSOLETE											1-192013-8	OBSOLETE
--	[.050]	C	15			121-3	12	0.10	[.004]	01069	△41-192013-7	OBSOLETE
--	[.050]	C	15			117-2	12	0.15	[.006]	01057	△41-192013-6	OBSOLETE
--	[.050]	C	15			104	12	0.15	[.006]	01056	△41-192013-5	OBSOLETE
--	[.050]	C	15			107-2	12	0.15	[.006]		△41-192013-4	OBSOLETE
--	[.050]	C	15			101-2	12	0.10	[.004]	01046	△41-192013-3	OBSOLETE
--	[.050]	C	15			97-2	12	0.15	[.006]	01081	△41-192013-2	OBSOLETE
--	[.050]	C	15			57-2	12	0.15	[.006]	01045	△41-192013-1	OBSOLETE
(FREE DIA)	LH	STYLE	T°	MATING PIN	Ø REF	NUM LOUV	PLATING	MAT'L NOTE	MAT'L THK	REF	PART NUMBER	

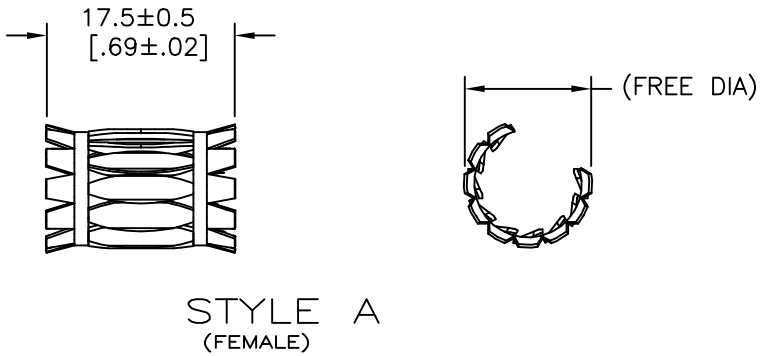
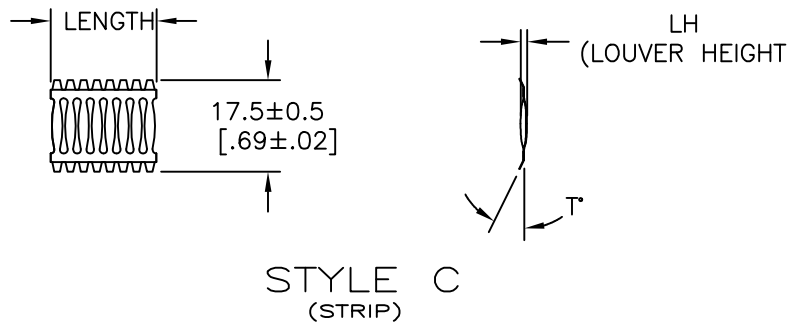

- 1 FINISH-GOLD PLATE 2.03-2.54µm [80-100µ"] THICK
- 2 FINISH-NICKEL PLATE 1.02-2.03µm [40-80µ"] THICK
- 3 FINISH-NICKEL PLATE 1.27-1.91µm [50-75µ"] THICK
- 4 FINISH-TIN PLATE 7.62-15.24µm [300-700µ"] THICK
- 5 FINISH-SILVER PLATE 18.78µm [700-1000µ"] THICK
- 6 FINISH-GOLD PLATE 0.25-0.51µm [10-20µ"] THICK
- 7 FINISH-SILVER PLATE 5.08-10.16µm [200-400µ"] THICK
- 8
- 9
- 10
- 11 PLATING NOTES ARE TO BE INTERPRETED AS FOLLOWS:
5-7 AS 5 OVER 7.
- 12 MATERIAL-CDA172 BeCu.
- 13 MATERIAL-STAINLESS STEEL.
- △4 OBSOLETE PARTS: OBSOLETE CIS STREAMLINING PER D.RENAUD/D.SINISI

THIS DRAWING IS A CONTROLLED DOCUMENT.		DWN RA JAYNE 07-01-91	TE Connectivity		
		CHK G.STEINHAUER 07-01-91			
DIMENSIONS: mm [INCHES]	TOLERANCES UNLESS OTHERWISE SPECIFIED:	APVD G.STEINHAUER 07-01-91	NAME CONTACT BAND,FEMALE		
	0 PLC ± -	PRODUCT SPEC			
	1 PLC ± -	APPLICATION SPEC			
MATERIAL	2 PLC ± 0.5 [.02]		SIZE A2	CAGE CODE 00779	DRAWING NO C=192013
SEE TABLE	3 PLC ± 0.25 [.010]	WEIGHT -	RESTRICTED TO -		
	4 PLC ± -	CUSTOMER DRAWING	SCALE NTS	SHEET 1 of 2	REV K
	ANGLES ± -				
	FINISH				

THIS DRAWING IS UNPUBLISHED.										RELEASED FOR PUBLICATION										REVISIONS									
© COPYRIGHT - By -										ALL RIGHTS RESERVED.										P LTR DESCRIPTION DATE DWN APVD									
[.89][.052] A 15 19.1[.750] 23 UNPL 12 0.20[.008] 01248 9 192013 9										[.92][.050] A 15 19.1[.750] 24 UNPL 13 0.15[.006] 01203 9 192013 8										[.92][.050] A 15 19.1[.750] 24 6-2 12 0.15[.006] 01234 9 192013 7									
[.92][.050] A 15 19.1[.750] 24 7-2 12 0.15[.006] 01154 9-192013-6										[.92][.050] A 15 19.1[.750] 24 UNPL 12 0.15[.006] 01152 9-192013-5										[.92][.050] A 15 19.1[.750] 24 UNPL 12 0.15[.006] 01152 9-192013-5									
[.89][.050] A 15 19.1[.750] 23 7-2 12 0.15[.006] 01255 9-192013-3										[1.75][.050] A 15 19.1[.750] 23 7-2 12 0.10[.004] 01279 9 192013-2										[.92][.046] A 15 19.1[.750] 24 7-2 12 0.08[.003] 01151 9 192013-1									
[.92][.046] A 15 19.1[.750] 24 UNPL 12 0.08[.003] 01297 9 192013-0										[.85][.050] A 15 17.4[.685] 22 7-2 12 0.15[.006] 01223 8-192013-9										[.80][.052] A 15 15.88[.625] 20 7-2 12 0.20[.008] 01245 8 192013-8									
[.80][.052] A 15 15.88[.625] 20 UNPL 12 0.20[.008] 01289 8 192013-7										[.76][.052] A 15 15.88[.625] 19 7-2 12 0.20[.008] 01259 8-192013-6										[.76][.052] A 15 15.88[.625] 19 UNPL 12 0.20[.008] 01258 8 192013-5									
[.83][.050] A 15 15.88[.625] 21 7-2 12 0.15[.006] 01207 8 192013-4										[.80][.050] A 15 15.88[.625] 20 6-2 12 0.15[.006] 01317 8 192013-3										[.80][.050] A 15 15.88[.625] 20 7-2 12 0.15[.006] 01148 8-192013-2									
[.73][.052] A 15 14.27[.562] 18 7-2 12 0.20[.008] 01143 7 192013-8										[.45][.050] A 15 9.01[.355] 11 UNPL 12 0.15[.006] 01264 7-192013-6										[.70][.050] A 15 14.0[.551] 17 7-2 12 0.15[.006] 01141 7-192013-5									
[.69][.052] A 15 12.7[.500] 16 7-2 12 0.20[.008] 01137 7 192013-4										[.69][.052] A 15 12.7[.500] 16 UNPL 12 0.20[.008] 01247 7 192013-3										[.69][.050] A 15 12.7[.500] 16 UNPL 13 0.15[.006] 01244 7-192013-2									
[.69][.050] A 15 12.7[.500] 16 7-2 12 0.15[.006] 01206 7-192013-1										[.69][.046] A 15 12.7[.500] 16 7-2 12 0.08[.003] 01275 7 192013-0										[.64][.052] A 15 11.99[.472] 15 7-2 12 0.20[.008] 01304 6-192013-9									
[.55][.050] A 15 11.99[.472] 14 UNPL 13 0.15[.006] 01073 6 192013-8										[.64][.050] A 15 11.99[.472] 15 7-2 12 0.15[.006] 01135 6-192013-7										[.64][.050] A 15 11.99[.472] 15 UNPL 12 0.15[.006] 01134 6 192013-6									
[1.25][.050] A 15 11.99[.472] 15 7-2 12 0.10[.004] 01286 6 192013-5										[.80][.050] A 15 15.88[.625] 20 UNPL 0.15[.006] 6 192013-4										[.67][.046] A 15 12.7[.500] 16 UNPL 0.08[.003] 6 192013-3									
[.53][.050] A 15 10.0[.394] 13 UNPL 0.15[.006] 6 192013-2										[.55][.052] A 15 11.1[.437] 14 7-2 12 0.20[.008] 01131 6 192013-1										[.55][.050] A 15 11.1[.437] 14 UNPL 13 0.15[.006] 01246 6 192013-0									
[.55][.050] A 15 11.1[.437] 14 7-2 12 0.15[.006] 01211 5-192013-9										[.55][.050] A 15 11.02[.434] 14 6-2 12 0.15[.006] 01128 5-192013-8										[.55][.050] A 15 11.02[.434] 14 UNPL 12 0.15[.006] 01216 5 192013-7									
[.52][.050] A 15 10.0[.394] 13 6-2 12 0.15[.006] 01272 5 192013-6										[.52][.050] A 15 10.0[.394] 13 7-2 12 0.15[.006] 01205 5-192013-5										[.50][.050] A 15 9.53[.375] 12 7-2 12 0.15[.006] 01124 5-192013-4									
[.48][.050] A 9.53[.375] 12 7-2 12 0.10[.004] 01268 5 192013-3										[.48][.052] A 15 9.07[.357] 12 7-2 12 0.20[.008] 01122 5 192013-2										[.45][.050] A 15 9.01[.355] 11 6-2 12 0.15[.006] 01121 5 192013-1									
(FREE DIA) LH STYLE T \$ MATING PIN t REF NUM LOUV PLATING MAT'L NOTE MAT'L THK REF PART NUMBER																													

LENGTH

17.5±0.5
[.69±.02]

STYLE C
(STRIP)

17.5±0.5
[.69±.02]

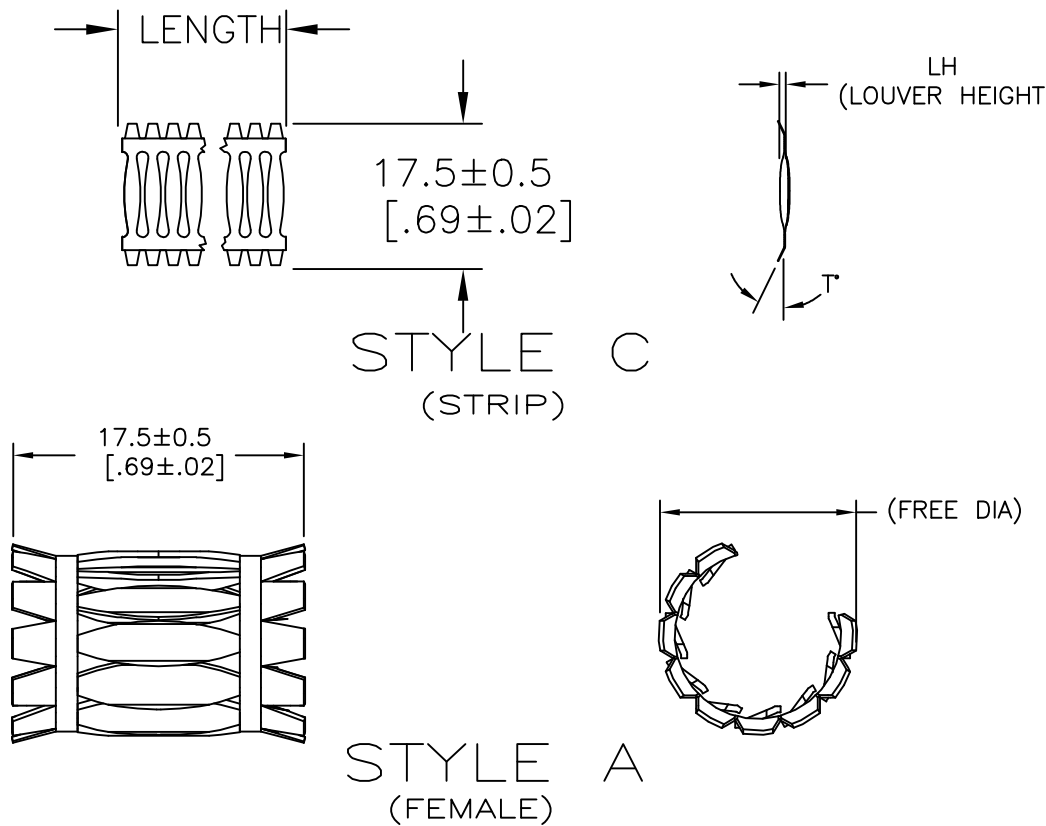

THIS DRAWING IS A CONTROLLED DOCUMENT.		DWN RA JAYNE 07-01-91	TE Connectivity			
DIMENSIONS: mm [INCHES]		CHK G.STEINHAUER 07-01-91				
		NAME				
		CONTACT BAND,FEMALE				
		PRODUCT SPEC				
		APPLICATION SPEC				
MATERIAL SEE TABLE		WEIGHT -	SIZE A2	CAGE CODE 00779	DRAWING NO C=192013	RESTRICTED TO -
CUSTOMER DRAWING				SCALE NTS	SHEET 2 of 2	REV K

Mouser Electronics

Authorized Distributor

Click to View Pricing, Inventory, Delivery & Lifecycle Information:

[TE Connectivity:](#)

[4-192013-3](#) [5-192013-9](#)