

THIS INFORMATION IS CONFIDENTIAL AND PROPRIETARY TO CW INDUSTRIES INCORPORATED AND ITS AFFILIATES. IT MAY NOT BE DISCLOSED TO ANYONE, OTHER THAN CW INDUSTRIES PERSONNEL, WITHOUT WRITTEN AUTHORIZATION FROM CW INDUSTRIES INCORPORATED, SOUTHAMPTON, PENNSYLVANIA USA.

Rating	12(4)A 250V ac  UL US	Mounting Hole 	Circuit Diagram 
Contact Resistance	50m ohm Max.		
Insulation Resistance	DC 500V 100M ohm Min.		
Dielectric Strength	AC 1500V 1 minute		
Switch Function	6P DPDT ON-ON		
Operation Temperature	0°0~85°C		

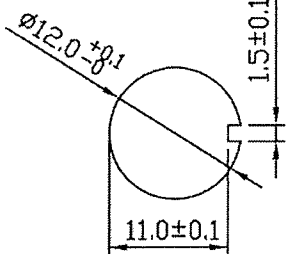
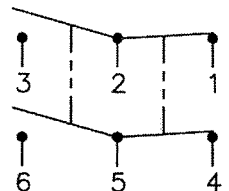
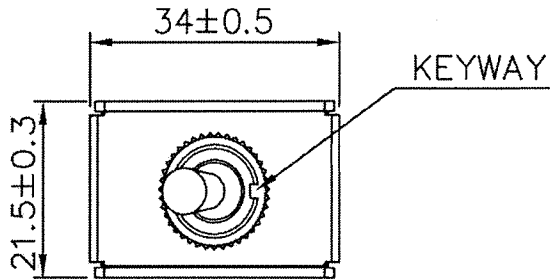

MATERIAL:

- Frame: Nylon 66, Black
- UL Flame: 94-V2
- Lever: Metal
- Cover PA#66+30%GF A0520
- UL Flame: 94-V0
- Terminal: Copper Alloy
- Contact: Copper Alloy
- Waterproof: IP56

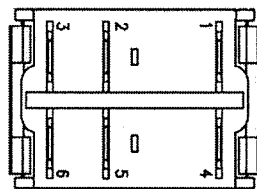
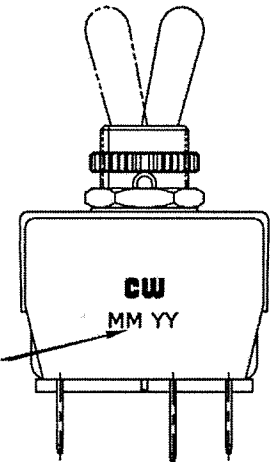
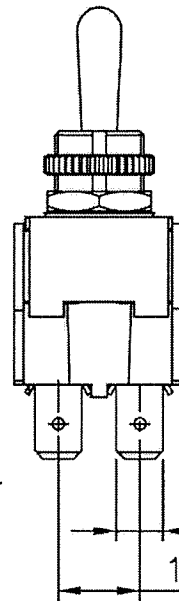
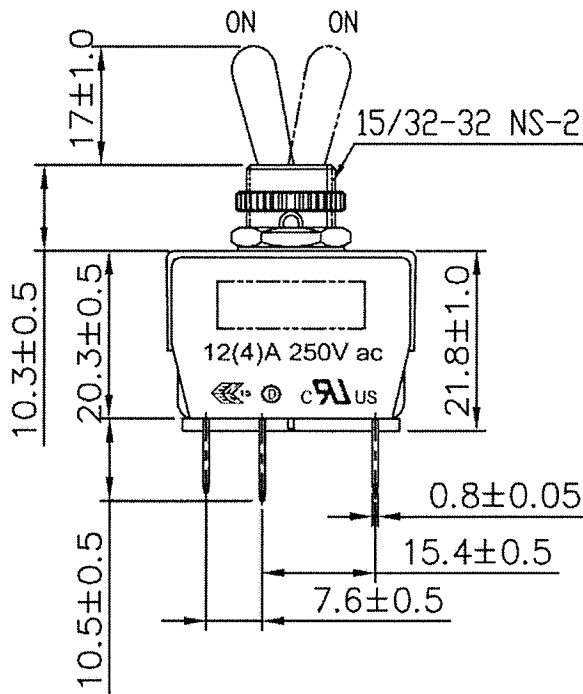

DATE CODE

Tolerances Unless Otherwise Specified +/-0.5.

RoHS Compliant

4 Redrawn. Removed 16A 277vac rating & added 12(4)A 250vac & listings. 8/09/12.

CW INDUSTRIES
 Southampton, Pa. 18966
 Tel 215.355.7080/www.cwind.com

Date Drawn: 1/28/11

Rev. 4

Unit: mm

Checked By: *G. Gold*

Title: **TOGGLE SWITCH**

CW P/N: **GTS448B101A1HR**

Mouser Electronics

Authorized Distributor

Click to View Pricing, Inventory, Delivery & Lifecycle Information:

[CW Industries:](#)

[GTS448B101A1HR](#)