

PART NUMBER	SSI-LXR3612ID-150	REV.	F
DATE	E.C.N. NUMBER AND REVISION COMMENTS		REV.
11.17.92	UPDATED SAFE OPER. SPECS.		A
09.19.94	UPDATED SAFE OPER. SPECS AND NOTES.		B
05.16.95	UPDATED DWG AND NOTES.		C
06.23.95	CHG'D WIRE SIZE.		D
10.30.01	E.C.N. #10BRDR. & REDRAWN IN 3D.		E
7.14.11	E.C.N. #10BRDR. & REDRAWN.		F

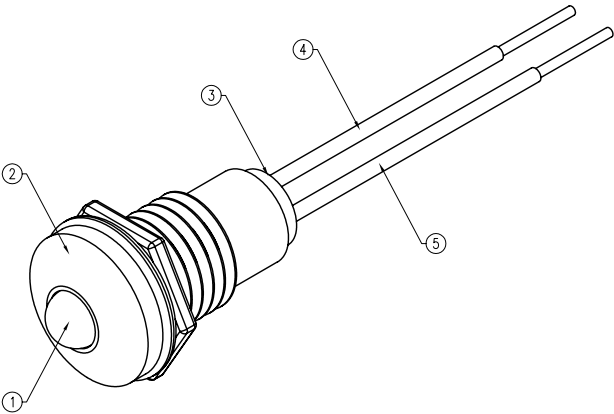
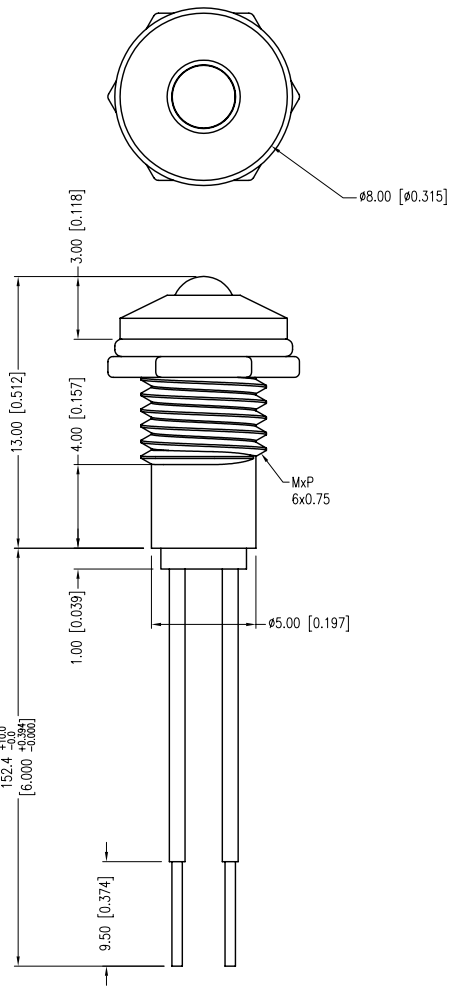

ELECTRO-OPTICAL CHARACTERISTICS Ta=25°C			If=20mA	
PARAMETER	MIN	TYP	MAX	UNITS
PEAK WAVELENGTH		635		nm
FORWARD VOLTAGE		2.0	2.5	Vf
REVERSE VOLTAGE	5.0			Vr
AXIAL INTENSITY		30		mcd
VIEWING ANGLE		60		2x theta
EMITTED COLOR:	RED			
EPOXY LENS FINISH:	RED DIFFUSED			

LIMITS OF SAFE OPERATION AT 25°C		
PARAMETER	MAX	UNITS
PEAK FORWARD CURRENT*	150	mA
STEADY CURRENT	30	mA
POWER DISSIPATION	105	mW
DERATE FROM 25°C	-1.6	mW/°C
OPERATING TEMP.	-40 TO +85	°C
STORAGE TEMP.	-40 TO +85	°C
SOLDERING TEMP.	+260	°C
2.0mm FROM BODY	3	SEC. MAX.
* t<10µs		

- NOTES:
1. SSL-LX3054ID, RED LED, TRIM LEADS TO 5mm.
  2. SSI-LXR3612 HOLDER, CHROME FINISH.
  3. SSH-LXH1612BSG, BUSHING, INSERT AND CRIMP.
  4. ANODE LEAD: LXP-WST26RTOC, 26 AWG. STRANDED, RED INSULATION, CUT TO 157mm LONG, STRIP ENDS 2mm AND 9.5mm.
  5. CATHODE LEAD: LXP-WST26BLTOC, 26 AWG. STRANDED, BLACK INSULATION, CUT TO 157mm LONG, STRIP ENDS 2mm AND 9.5mm.
  6. SOLDER LED LEADS TO WIRE LEADS.

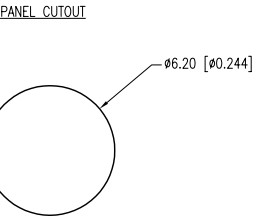

# Mouser Electronics

Authorized Distributor

Click to View Pricing, Inventory, Delivery & Lifecycle Information:

Lumex:

[SSI-LXR3612ID-150](#)