

## Housing - DC-B 6-H-80/O2STM25G-M - 1581201

Please be informed that the data shown in this PDF Document is generated from our Online Catalog. Please find the complete data in the user's documentation. Our General Terms of Use for Downloads are valid (<http://phoenixcontact.com/download>)



DUPLICON, aluminum stackable housing for DUPLICON contact inserts, type B6, IP67 protection, with two locking latches, gasket and two M25 cable screw connection threads (without cable screw connection), straight output



### Key Commercial Data

|                                      |          |
|--------------------------------------|----------|
| Packing unit                         | 1 pc     |
| Weight per Piece (excluding packing) | 280.0 g  |
| Custom tariff number                 | 85389099 |
| Country of origin                    | Slovenia |

### Technical data

#### Dimensions

|        |       |
|--------|-------|
| Height | 37 mm |
|--------|-------|

#### Ambient conditions

|                                      |                   |
|--------------------------------------|-------------------|
| Degree of protection of housing (IP) | IP65              |
|                                      | IP66              |
|                                      | IP67              |
| Ambient temperature (operation)      | -40 °C ... 125 °C |

#### General

|                              |                    |
|------------------------------|--------------------|
| Size                         | DC-B6              |
| Housing type                 | Sleeve housing     |
| Color                        | pearl gray         |
| Locking type                 | With locking latch |
| Cable exit                   | Lateral            |
| Screw connection             | none               |
| Type of the screw connection | With 2x M20 thread |
| Housing material             | Aluminum die-cast  |

# Housing - DC-B 6-H-80/O2STM25G-M - 1581201

## Technical data

### General

|                              |                 |
|------------------------------|-----------------|
| Housing surface material     | EMC-conductive  |
| Seal material                | NBR             |
| Material lock                | Stainless steel |
| Material grip body interlock | PA              |

## Classifications

### eCl@ss

|            |          |
|------------|----------|
| eCl@ss 4.0 | 272607xx |
| eCl@ss 4.1 | 27260701 |
| eCl@ss 5.0 | 27143424 |
| eCl@ss 5.1 | 27143424 |
| eCl@ss 6.0 | 27143424 |
| eCl@ss 7.0 | 27440209 |
| eCl@ss 8.0 | 27440202 |

### ETIM

|          |          |
|----------|----------|
| ETIM 3.0 | EC000437 |
| ETIM 4.0 | EC000437 |
| ETIM 5.0 | EC000437 |

### UNSPSC

|               |          |
|---------------|----------|
| UNSPSC 6.01   | 31261502 |
| UNSPSC 7.0901 | 31261502 |
| UNSPSC 11     | 31261502 |
| UNSPSC 12.01  | 31261502 |
| UNSPSC 13.2   | 31261502 |

## Approvals

### Approvals

---

Approvals

EAC

---

Ex Approvals

## Housing - DC-B 6-H-80/O2STM25G-M - 1581201

### Approvals

Approvals submitted

---

#### Approval details

|     |
|-----|
| EAC |
|-----|

### Accessories

Accessories

Device marking

Label - EML (26,5X12)R SR - 0816854



Label, Roll, silver/matt, unlabeled, can be labeled with: THERMOMARK ROLL, THERMOMARK ROLL X1, THERMOMARK X, THERMOMARK S1.1, Mounting type: Adhesive, Lettering field: 26.5 x 12 mm

---

#### Full screw connection

Cable gland - HC-K-KV-M25(11-17) - 1690639



Plastic screw connection up to 5 bar, thread length: 8 mm, cable diameter: 11 - 17 mm, WAF 29, screw connection: M25

---

Cable gland - HC-K-KV-M20(8-13) - 1690626



Plastic screw connection up to 5 bar, thread length: 8 mm, cable diameter: 8 - 13 mm, WAF 24, screw connection: M20

---

#### Seal

## Housing - DC-B 6-H-80/O2STM25G-M - 1581201

### Accessories

Seal - DC-B 6-A-HD-G - 1602326



DUPLICON, profile gasket for stackable housing, made of conductive EPDM

---

### Drawings

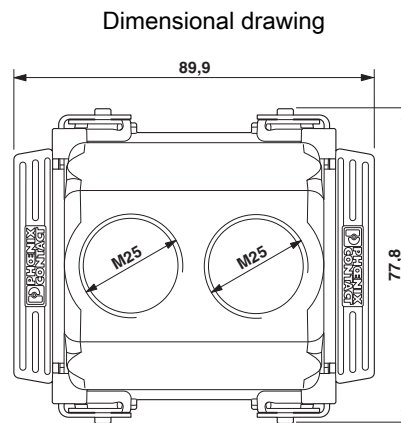

Dimensional drawing

---

# Mouser Electronics

Authorized Distributor

Click to View Pricing, Inventory, Delivery & Lifecycle Information:

Phoenix Contact:

1581201