

## Housing - VC-AL-T2-R-M20-S - 1583652

Please be informed that the data shown in this PDF Document is generated from our Online Catalog. Please find the complete data in the user's documentation. Our General Terms of Use for Downloads are valid (<http://phoenixcontact.com/download>)



Aluminum die-cast sleeve housing, with grommet, locking screws with knurled head, for a metric M20 cable gland, angled cable outlet, type VC2

### Product Features

- Housing with two cable entries is available
- Angled cable outlet so the cable can be routed as desired, from the side and straight
- Aluminum housing with extended cabling space for high-position and power contact inserts



### Key Commercial Data

Packing unit	1 pc
Minimum order quantity	5 pc
Weight per Piece (excluding packing)	195.0 g
Custom tariff number	85369010
Country of origin	Poland

### Technical data

#### Dimensions

Height	80 mm
--------	-------

#### Ambient conditions

Ambient temperature (operation)	-40 °C ... 125 °C
---------------------------------	-------------------

#### General

Note	When using fiber optics, the bending radii of the cable manufacturers must be observed.
Size	VC2
Color	gray aluminum
Locking type	Screw locking, knurled head
Tightening torque, mounting screw	1.5 Nm ±0.3 Nm

## Housing - VC-AL-T2-R-M20-S - 1583652

### Technical data

#### General

Fixing screws	M4
No. of cable outlets	1
Cable exit	Angled
Screw connection	none
Type of the screw connection	M20 x 1.5
Housing material	Aluminum die-cast
Seal material	NBR, conductive
Material of locking screw	Nickel-plated brass
Flammability rating according to UL 94	V0

#### Standards and Regulations

Flammability rating according to UL 94	V0
--	----

### Classifications

#### eCl@ss

eCl@ss 4.0	272607xx
eCl@ss 4.1	27260701
eCl@ss 5.0	27143424
eCl@ss 5.1	27143424
eCl@ss 6.0	27371205
eCl@ss 7.0	27371205
eCl@ss 8.0	27440202
eCl@ss 9.0	27440202

#### ETIM

ETIM 3.0	EC000437
ETIM 4.0	EC000437
ETIM 5.0	EC000437

#### UNSPSC

UNSPSC 6.01	31261502
UNSPSC 7.0901	31261502
UNSPSC 11	31261502
UNSPSC 12.01	31261502
UNSPSC 13.2	31261502

## Housing - VC-AL-T2-R-M20-S - 1583652

### Approvals

#### Approvals

---

Approvals

EAC / EAC

---

Ex Approvals

---

Approvals submitted

---

#### Approval details

EAC
-----

EAC
-----

### Accessories

#### Accessories

#### Device marking

Engraving material - GPE 22X22 SR/R - 0806628



Engraving material, Sheet, silver, unlabeled, can be labeled with: Engraving, Plotter, Mounting type: Adhesive, Lettering field: 22 x 22 mm

#### Full screw connection

Cable gland - HC-M-KV-M20(9-13) - 1690561



Metal screw connection up to 5 bar, thread length: 6 mm, cable diameter: 9 - 13 mm, WAF 22, screw connection: M20

## Housing - VC-AL-T2-R-M20-S - 1583652

### Accessories

Cable gland - HC-M-KV-M20(11-16) - 1645998



Metal screw connection up to 5 bar, thread length: 6 mm, cable diameter: 11 - 16 mm, WAF 27, screw connection: M20

Cable gland - HC-EMV-KV-M20(7-12,5) - 1690503



EMC screw connection up to 5 bar, thread length: 5 mm, cable diameter: 7.0 - 12.5 mm, WAF 24, screw connection: M20

### Drawings

Dimensional drawing

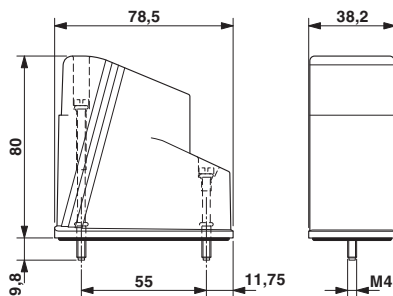

Dimensional drawing

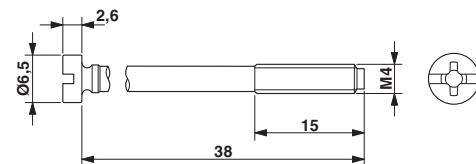

Dimensional drawing

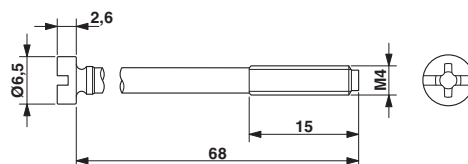

# Mouser Electronics

Authorized Distributor

Click to View Pricing, Inventory, Delivery & Lifecycle Information:

Phoenix Contact:

1583652