

DATA CONTAINED IN THIS DOCUMENT IS PROPRIETARY TO TROMPETER ELECTRONICS INC. AND SHALL NOT BE DISCLOSED, COPIED OR USED FOR PROCUREMENT OR MANUFACTURE WITHOUT EXPRESS WRITTEN PERMISSION.

DASH NO	MODEL NO	IMPED OHMS
-1	PL121	50
-2	UPL121	75

INCH	MM
.005	0.13
.030	0.76
.068	1.73
.093	2.36
.380	9.65
.437	11.10
.500	12.70
.628	15.95
1.060	26.92

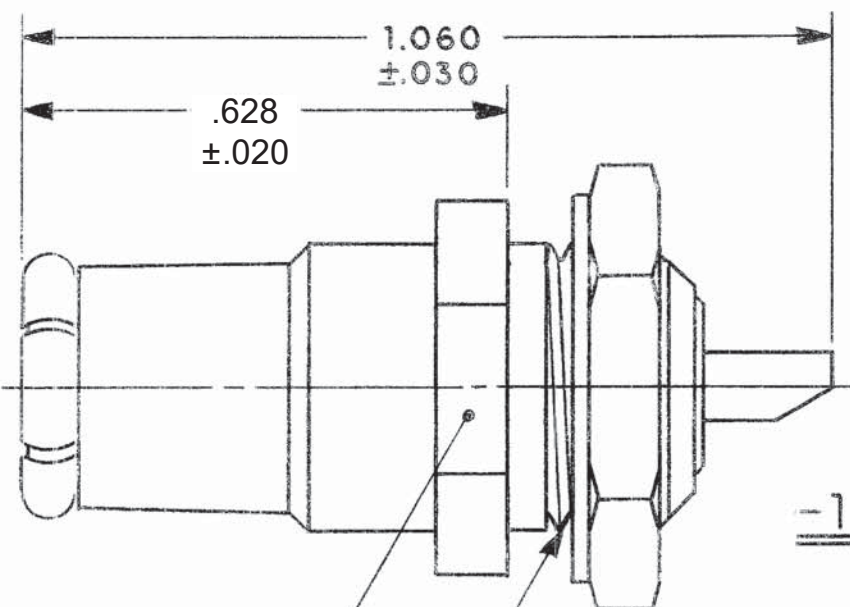

-1 SHOWN

.500 HEX NUT

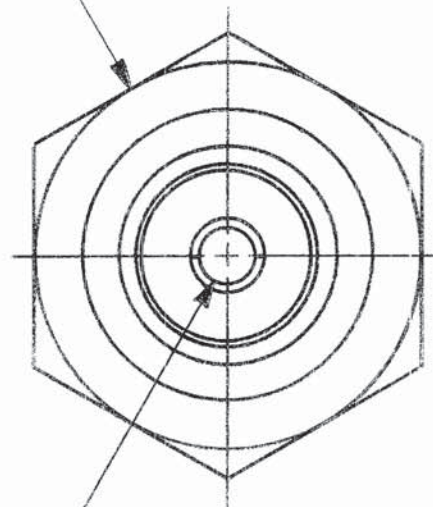

SOLDER POT ACCEPTS
.068 DIA CONDUCTOR

RECOMMENDED
PANEL CUTOUT
SCALE: 2/1

4. MAX PNL THK .093
3. 50 & 75 OHM COAXIAL BULKHEAD MOUNT PUSH-ON SOLDER POT PLUG, BNC INTERFACE
2. FINISH: NICKEL
1. ALL DIM ARE IN INCHES

QTY	DESCRIPTION		PART NUMBER		ITEM
TOL UNLESS SPECIFIED		TROMPETER	PL121/UPL121		
.XX ±		ELECTRONICS, INC.			
.XXX ± .005					
.XXX ±					
ANGLES ±					
DWN	RJS	9-3-84	MATERIAL	CODE IDENT	DRAWING NO.
CHK	DC	9-10-84	—	14949	105-0414
ENGR	DM	9-14-84			
APPR	JS	9-14-84	SCALE 4/1	DATE 1-15-74	SHEET 1 OF 2

NEXT ASSY

SCALE 4/1

DATE 1-15-74

SHEET 1 OF 2

Mouser Electronics

Authorized Distributor

Click to View Pricing, Inventory, Delivery & Lifecycle Information:

[Cinch Connectivity Solutions:](#)

[PL121](#)