

Pin strip - PST 1,0/ 8-3,5 - 1945151

Please be informed that the data shown in this PDF Document is generated from our Online Catalog. Please find the complete data in the user's documentation. Our General Terms of Use for Downloads are valid (<http://phoenixcontact.com/download>)



The figure shows a 10-position version of the product

Header, Nominal current: 8 A, Rated voltage (III/2): 250 V, Number of positions: 8, Pitch: 3.5 mm, Color: black, Contact surface: Tin, Mounting: THR soldering, The maximum current depends on the plug used. The lower of the two current values apply for plug and pin strip. The pin strip is made of highly temperature resistant plastic and is thus suitable for the reflow process.

Product Features

- Various pin lengths and pin geometries available on request
- Optimum pin geometry so as to not damage the plug
- Reflow solderable pin strip, optimized for COMBICON compact connectors

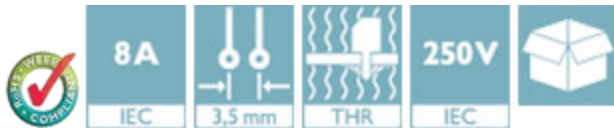

Key Commercial Data

| | |
|--------------------------------------|----------|
| Packing unit | 1 pc |
| Minimum order quantity | 100 pc |
| Weight per Piece (excluding packing) | 0.928 g |
| Custom tariff number | 85366990 |
| Country of origin | Germany |

Technical data

Dimensions

| | |
|--------------------------|---------|
| Length | 2.8 mm |
| Pitch | 3.50 mm |
| Dimension a | 24.5 mm |
| Width | 28 mm |
| Constructional height | 9.2 mm |
| Height | 12.7 mm |
| Length of the solder pin | 3.5 mm |
| Pin dimensions | 1 mm |

Pin strip - PST 1,0/ 8-3,5 - 1945151

Technical data

Dimensions

| | |
|---------------|--------|
| Hole diameter | 1.2 mm |
|---------------|--------|

General

| | |
|--|--------------------------------|
| Range of articles | PST 1,0/..-V |
| Insulating material group | IIIa |
| Rated surge voltage (III/3) | 2.5 kV |
| Rated surge voltage (III/2) | 2.5 kV |
| Rated surge voltage (II/2) | 2.5 kV |
| Rated voltage (III/3) | 160 V |
| Rated voltage (III/2) | 250 V |
| Rated voltage (II/2) | 250 V |
| Connection in acc. with standard | EN-VDE |
| Nominal current I_N | 8 A (depends on the plug used) |
| Maximum load current | 8 A (depends on the plug used) |
| Insulating material | PA |
| Flammability rating according to UL 94 | V0 |
| Color | black |
| Number of positions | 8 |

Standards and Regulations

| | |
|--|--------|
| Connection in acc. with standard | EN-VDE |
| | CUL |
| Flammability rating according to UL 94 | V0 |

Classifications

eCl@ss

| | |
|------------|----------|
| eCl@ss 4.0 | 272607xx |
| eCl@ss 4.1 | 27260701 |
| eCl@ss 5.0 | 27260701 |
| eCl@ss 5.1 | 27260701 |
| eCl@ss 6.0 | 27260704 |
| eCl@ss 7.0 | 27440402 |
| eCl@ss 8.0 | 27440402 |
| eCl@ss 9.0 | 27440402 |

ETIM

| | |
|----------|----------|
| ETIM 3.0 | EC001121 |
|----------|----------|

Pin strip - PST 1,0/ 8-3,5 - 1945151

Classifications

ETIM

| | |
|----------|----------|
| ETIM 4.0 | EC002637 |
| ETIM 5.0 | EC002637 |

UNSPSC

| | |
|---------------|----------|
| UNSPSC 6.01 | 30211801 |
| UNSPSC 7.0901 | 39121432 |
| UNSPSC 11 | 34131203 |
| UNSPSC 12.01 | 39121432 |
| UNSPSC 13.2 | 39121432 |

Approvals

Approvals

Approvals

UL Recognized / cUL Recognized / EAC / SEV / CCA / EAC / cULus Recognized

Ex Approvals

Approvals submitted

Approval details

| | |
|---|-------|
| UL Recognized  | |
| | B |
| Nominal current IN | 10 A |
| Nominal voltage UN | 300 V |

| | |
|--|-------|
| cUL Recognized  | |
| | B |
| Nominal current IN | 10 A |
| Nominal voltage UN | 300 V |

Pin strip - PST 1,0/ 8-3,5 - 1945151

Approvals

| |
|-----|
| EAC |
|-----|

| | |
|--------------------|-------|
| SEV | |
| Nominal current IN | 6 A |
| Nominal voltage UN | 160 V |

| | |
|--------------------|-------|
| CCA | |
| Nominal current IN | 6 A |
| Nominal voltage UN | 160 V |

| |
|-----|
| EAC |
|-----|

| |
|------------------|
| cULus Recognized |
|------------------|

Accessories

Additional products

Plug - PTDA 1,5/ 8-PH-3,5 - 1725185



Plug component, Nominal current: 8 A, Rated voltage (III/2): 240 V, Number of positions: 8, Pitch: 3.5 mm, Connection method: Push-in spring connection, Color: green, Contact surface: Tin

PCB terminal block - FK-MPT 0,5/ 8-ST-3,5 - 1913989



Plug component, Nominal current: 4 A, Rated voltage (III/2): 250 V, Number of positions: 8, Pitch: 3.5 mm, Connection method: Push-in spring connection, Color: green, Contact surface: Tin

Pin strip - PST 1,0/ 8-3,5 - 1945151

Accessories

PCB terminal block - PT 1,5/ 8-PVH-3,5 - 1984073



Plug component, Nominal current: 8 A, Rated voltage (III/2): 200 V, Number of positions: 8, Pitch: 3.5 mm, Connection method: Screw connection with wire protector, Color: green, Contact surface: Tin

PCB terminal block - PT 1,5/ 8-PH-3,5 - 1984374



Plug component, Nominal current: 8 A, Rated voltage (III/2): 200 V, Number of positions: 8, Pitch: 3.5 mm, Connection method: Screw connection with wire protector, Color: green, Contact surface: Tin

Drawings

Drilling diagram

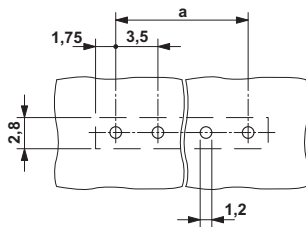

Diagram

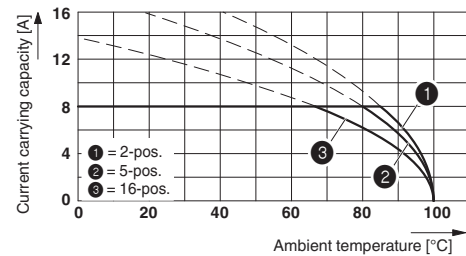

Derating curve for: PTDA 1,5/..-PH-3,5 with PST 1,0/..-3,5

Dimensional drawing

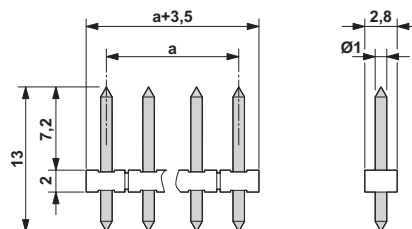

Mouser Electronics

Authorized Distributor

Click to View Pricing, Inventory, Delivery & Lifecycle Information:

[Phoenix Contact:](#)

[1945151](#)