

DESCRIPTION: 4-40 FEMALE SCREWLOCK

MATERIAL: BRASS - C3604
 PLATING: NICKEL

TORQUE VALUE: 50 IN-OZ RECOMMENDED

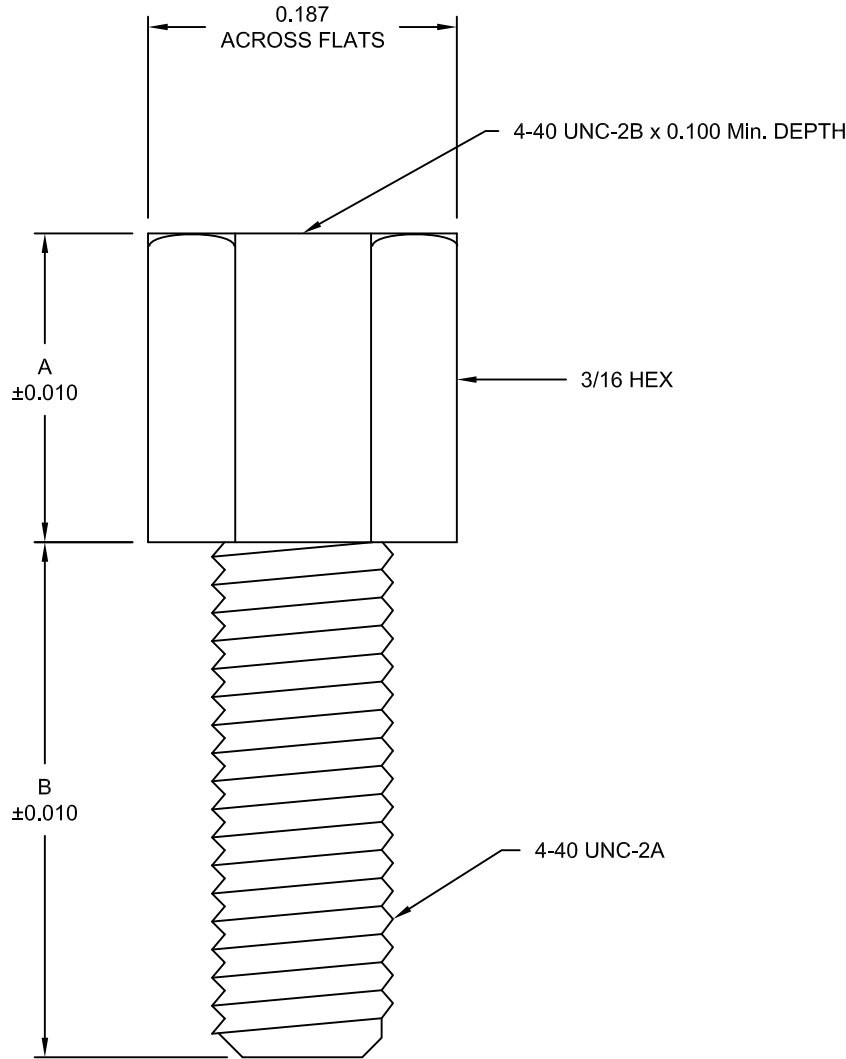

PART NUMBER	A	B
SFSO-440-1-NR	0.187	0.312
SFSO-440-2-NR	0.250	0.156
SFSO-440-3-NR	0.187	0.625
SFSO-440-4-NR	0.197	0.197
SFSO-440-5-NR	0.197	0.236
SFSO-440-6-NR	0.197	0.323
SFSO-440-7-NR	0.197	0.433
SFSO-440-8-NR	0.197	0.520
SFSO-440-9-NR	0.197	0.669

DO NOT SCALE FROM DRAWING



THESE DRAWINGS AND SPECIFICATIONS ARE THE PROPERTY OF NorComp AND SHALL NOT BE REPRODUCED, COPIED OR USED AS THE BASIS FOR THE MANUFACTURE OF SALE OF APPARATUS WITHOUT WRITTEN PERMISSION.

DRAWN: PAM JENKINS		DATE: 8-8-05	
SCALE: NTS	SHEET 1	OF 1	REV 7
DWG NO. SFSO-440-Y-NR			

RoHS COMPLIANT

NorComp

Mouser Electronics

Authorized Distributor

Click to View Pricing, Inventory, Delivery & Lifecycle Information:

[NorComp:](#)

[SFSO4401NR](#)