

PART NUMBER	REV	FIRST USED	POWER UNIT	FEED TYPE	DESCRIPTION
1852245-1	A	122500-1	LEADMAKER	POST FEED	CUTS CARRIER
1852245-2	A	565435-5	BENCH MODEL K	PRE FEED	CUTS CARRIER
1852245-3	A	354500-1	BENCH MODEL G	PRE FEED	CUTS CARRIER
1852245-6	A	122500-1	LEADMAKER	POST FEED	CONTINUOUS CARRIER
7-1852245-7	A	-	-	-	SPARE PARTS

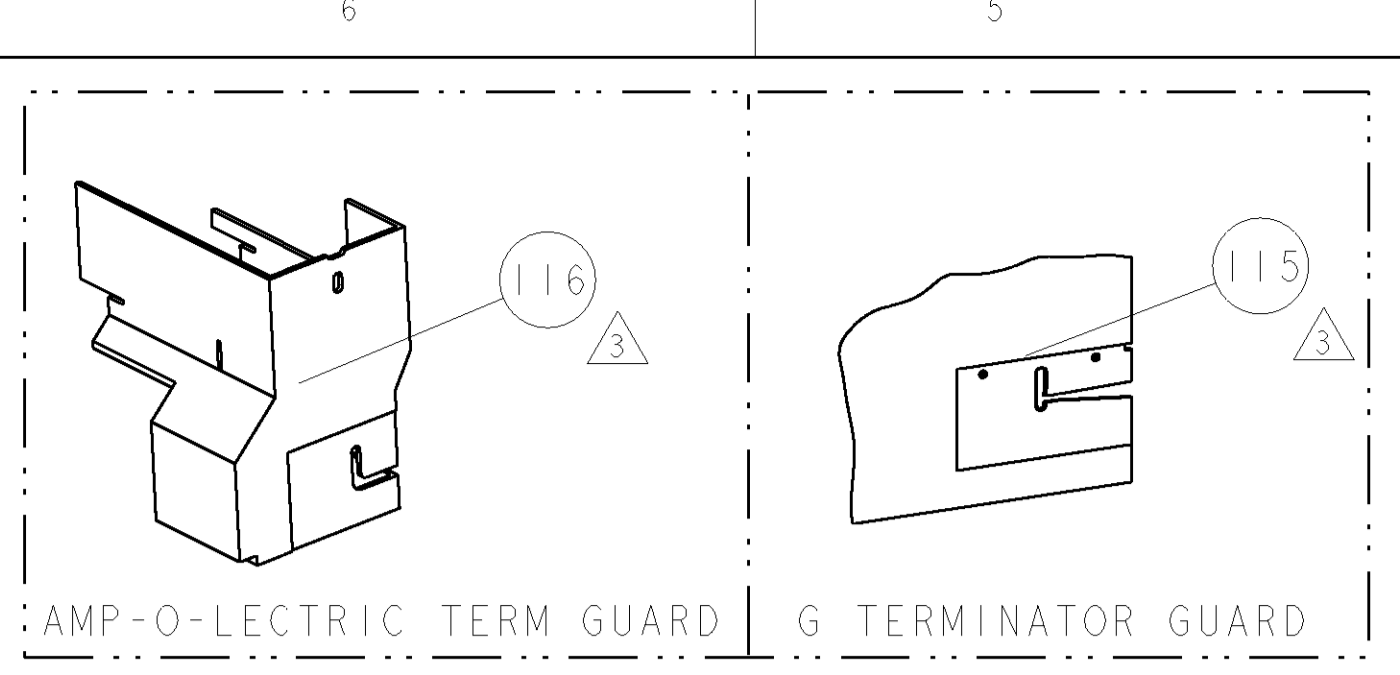

TERMINAL NAME: TERMINAL		PACKARD TERMINAL-PACKARD CRIMP SPECS	
TYCO PN	COMP PN	PAD LTR	WIRE SIZE
1949020-1	15465511	-	1.5mm
-	-	A	1.50±0.05mm [.059±.002]
-	-	B	-
-	-	C	-
-	-	D	-
		CRIMP	SIZE
-	-	WIRE	2.21mm [.087]
-	-	INSUL	2.54mm [.100]
WIRE STRIP LENGTH		TERM APPL SPEC	FEED
5.0mm-5.8mm		NONE	16.50mm
		APPL INSTRUCTIONS	SET UP GAGE
		408-8040	458637-1

LOC	DIST	REV	DESCRIPTION	DATE	DWN	APPR
A	66		RELEASED	31MAR2006	BH	BH

- △ RECOMMENDED SPARE PARTS
- △ GREASE LIGHTLY
- △ GUARD MUST BE IN PLACE WHEN OPERATING APPLICATOR IN A BENCH MACHINE

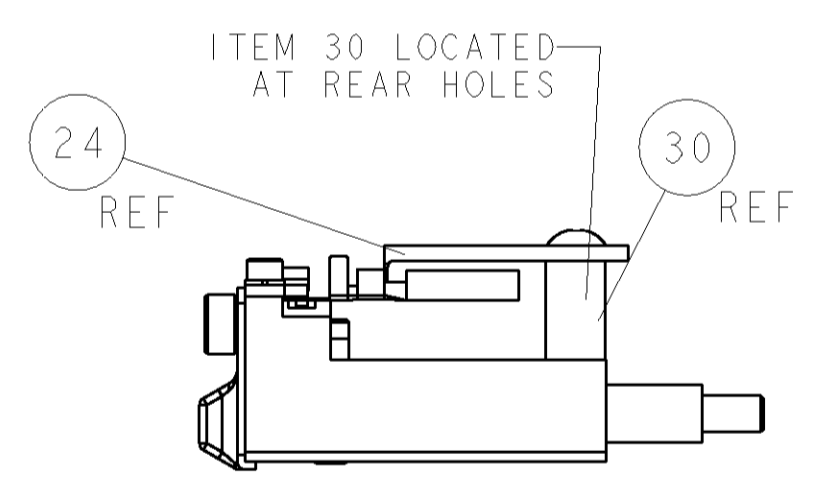
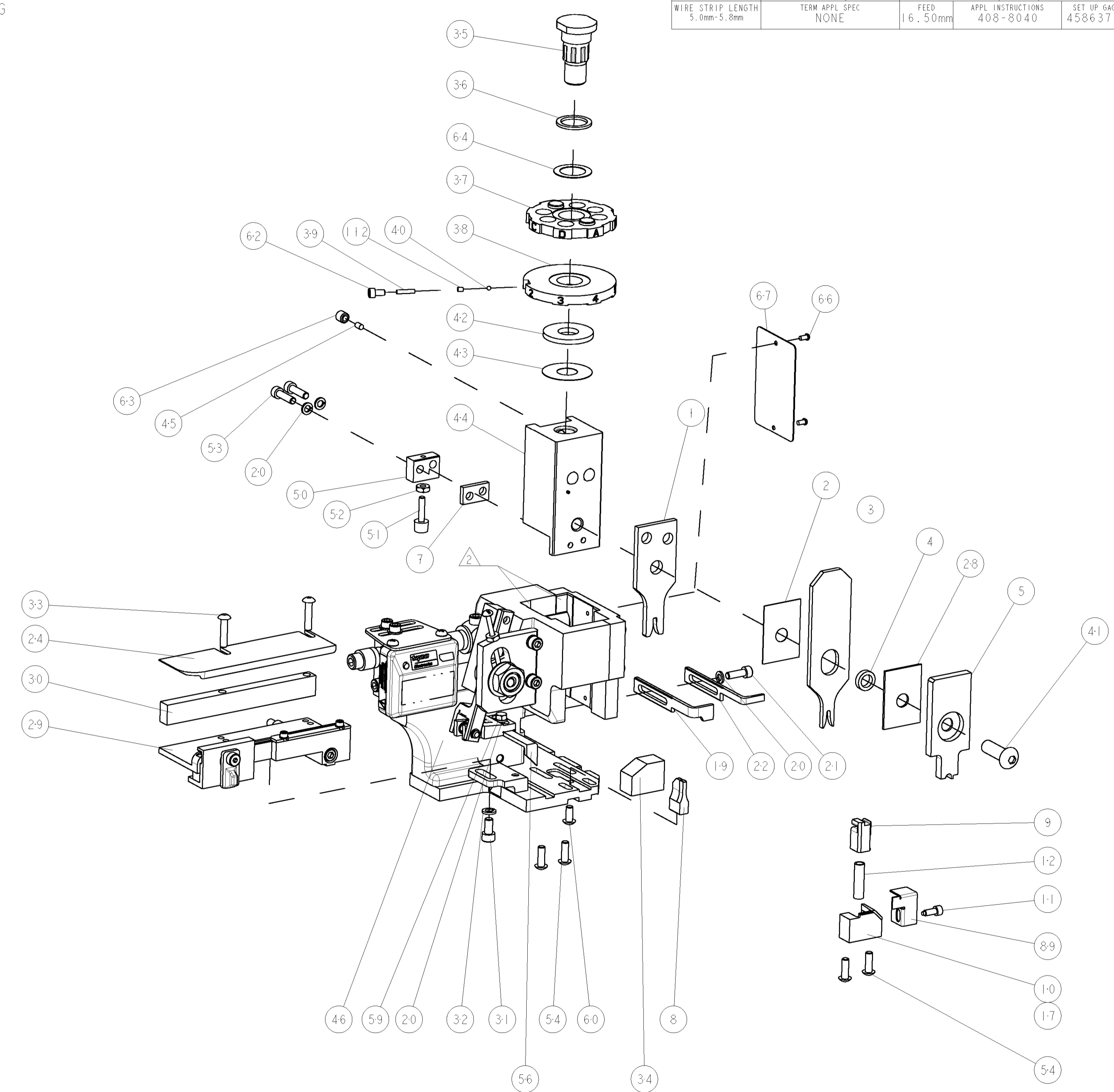

FEED TRACK POSITION

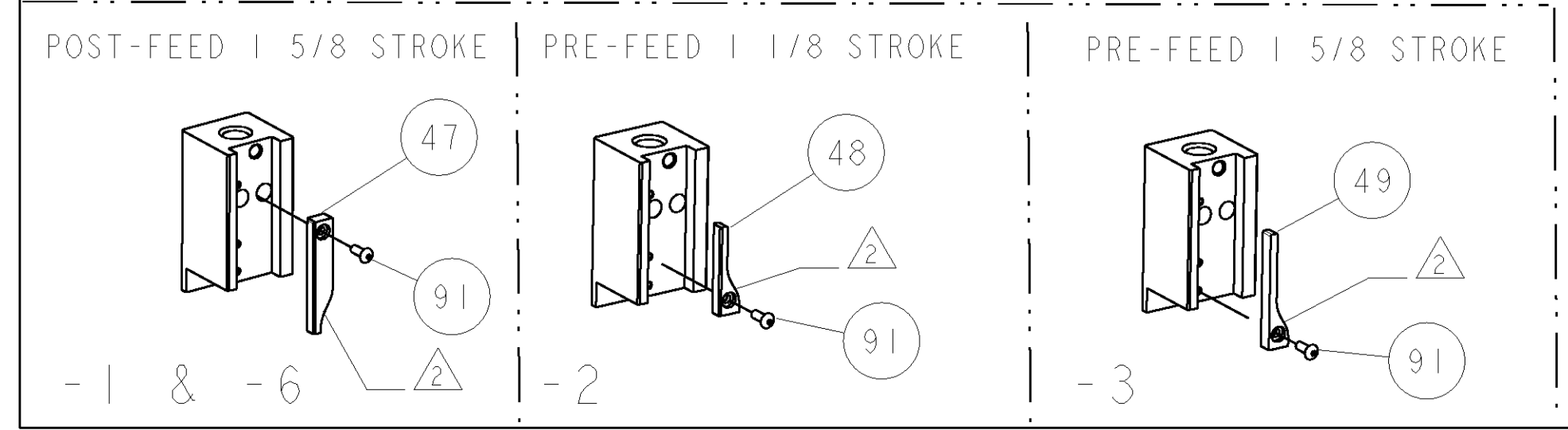
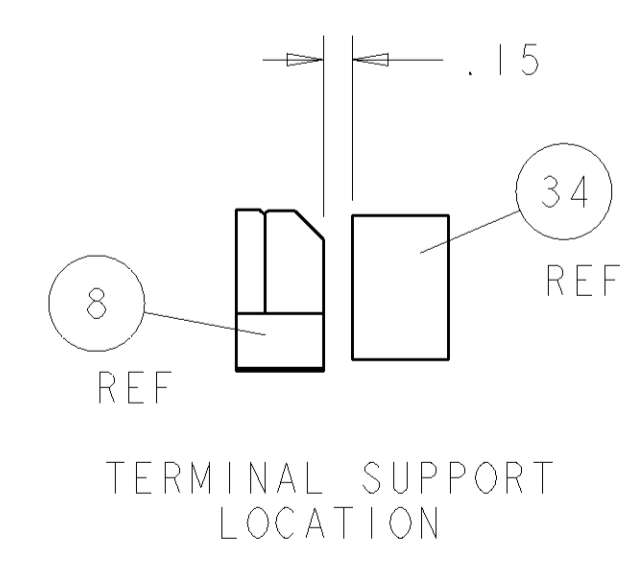

QTY	REV	DESCRIPTION	ITEM NO
-	2	1-354779-8 PIN, WIRE DISC, .3080	126
-	-	REF	116
-	-	REF	115
-	1	690603-1 SPRING ASSIST AMP-O-MATOR APPLICATOR	112
-	1	1-21002-7 SCR, BTN SKT HD CAP 6-32 X .375	91
-	1	318563-1 GUARD, FRONT CHIP	89
-	1	4088040 SF APPL INST 408-8040	72
-	1	217238-1 GENERAL INSTRUCTION PKG	71
-	1	461264-1 PLATE, IDENTIFICATION	67
-	2	21017-2 SCREW, DRIVE	66
-	1	986950-1 WASHER, FLAT PRECISION	64
-	1	21009-2 SCR, SET, SELF LOCKING 1/4-20 X .250	63
-	1	23030-1 SCR, SKT HD CAP 6-32 X .25	62
-	1	22733-8 SCR, BHSC, SELF-LOCKING, 8-32 X .375	60
-	1	2-22603-0 SCR, HEX HD CAP 8-32 X .312	59
-	1	458537-2 PAWL, FEED	56
-	4	2-21002-2 SCR, BTN SKT HD CAP 8-32 X .500	54
-	2	2-21000-8 SCR, SKT HD CAP 8-32 X .625	53
-	1	21018-5 NUT, HEX, REG 6-32	52
-	1	811242-2 BUMPER, HOLD DOWN	51
-	1	690753-1 SPACER, TONKER	50
-	-	690602-6 CAM, PRE FEED, 1 5/8	49
-	-	690602-5 CAM, PRE FEED, 1 1/8	48
-	1	690501-4 CAM, POST FEED, 1 5/8	47
-	1	459456-1 APPL. BASIC SUB ASSY (SIDE WISE MOCA)	46
-	1	690191-1 PLUG, NYLON	45
-	1	455673-1 RAM, SIDE FEED	44
-	1	690125-1 SHIM SUB-ASSY	43
-	1	690124-1 WASHER, RAM (.115)	42
-	1	7-21002-9 SCR, BTN SKT HD CAP 5/16-24 X 1.00	41
-	1	23241-6 BALL, STEEL	40
-	1	690170-1 SPRING, COMPRESSION	39
-	1	690142-1 DISC, INSULATION	38
-	1	354777-1 WIRE DISC, ASSEMBLY	37
-	1	22480-5 SPRING, COMPRESSION	36
-	1	690212-1 POST, RAM	35
-	1	690786-6 TERMINAL SUPPORT	34
-	2	2-21002-4 SCR, BTN SKT HD CAP 8-32 X .750	33
-	1	21024-5 WASHER, SPRG LOCK, REG NO 10	32
-	1	3-21000-4 SCR, SKT HD CAP 10-32 X .375	31
-	1	1320908-8 SPACER, STRIP GUIDE	30
-	1	1633091-3 ASSEMBLY, STRIP GUIDE	29
-	1	1-455888-0 SPACER, CRIMPER	28
-	1	1320928-1 PLATE, STRIP GUIDE	24
-	1	690472-2 STRIPPER	22
-	1	2-21000-7 SCR, SKT HD CAP 8-32 X .500	21
-	4	21024-4 WASHER, SPRG LOCK, REG NO 8	20
-	-	691353-1 STRIPPER	19
-	1	679625-1 SHEAR HOLDER, FRONT (NO CUT)	17
-	1	3-22280-3 SPRING, COMPRESSION	12
-	1	690461-1 STOP, SHEAR	11
-	-	690459-1 SHEAR HOLDER, FRONT	10
-	1	454276-2 FLOATING SHEAR, FRONT	9
1	1	6-1633116-7 ANVIL, COMBINATION	8
-	1	5-240641-2 SPACER	7
-	1	1-455889-4 DEPRESSOR, SHEAR	5
-	1	238011-2 BLOCK, CRIMPER SPACER	4
1	1	4-456135-8 CRIMPER, INSULATION O PREMIUM	3
-	1	455888-3 SPACER, CRIMPER	2
1	1	3-1490019-7 CRIMPER, WIRE PREMIUM	1

DIMENSIONS: INCHES 		TOLERANCES UNLESS OTHERWISE SPECIFIED: 0 PLC ±.01 1 PLC ±.01 2 PLC ±.01 3 PLC ±.001 4 PLC ±.001 ANGLES ±.001		DWN B. HIGMAN 15MAY2006 CHK B. HIGMAN 15MAY2006 APVD J. ELBIN 15MAY2006		tyco Electronics Tyco Electronics Harrisburg, PA 17105-3608	
MATERIAL		FINISH		WEIGHT		SCALE 3:5 SHEET 1 OF 1 REV A	
CUSTOMER DRAWING				CUSTOMER VIEWABLE ASSEMBLY			

Mouser Electronics

Authorized Distributor

Click to View Pricing, Inventory, Delivery & Lifecycle Information:

[TE Connectivity:](#)

[1852245-3](#)