

HODTEC-31230-000

SHT 1.1

## NOTES:

1. A POSITIVE GOING VOLTAGE AT TERMINAL 2, RELATIVE TO TERMINAL 1, CAUSES A DECREASE IN PRESSURE AT THE SOUND OUTLET.

2. LOCATED FROM TWO SURFACES FOR CUSTOMER CONVENIENCE. ONLY APPLICABLE FROM ONE SURFACE, NOT TO BE USED TOGETHER. HORIZONTAL LOCATION FOR TERMINAL CENTERED TO  $\pm 0,17$  [.007].

3. RECEIVERS WIRED IN ELECTRICAL PARALLEL WHEN CONNECTED TO TERMINAL 1 AND TERMINAL 2.

4. RED STRIP FROM CORNER TO CORNER, EITHER SIDE.

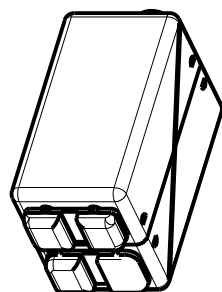
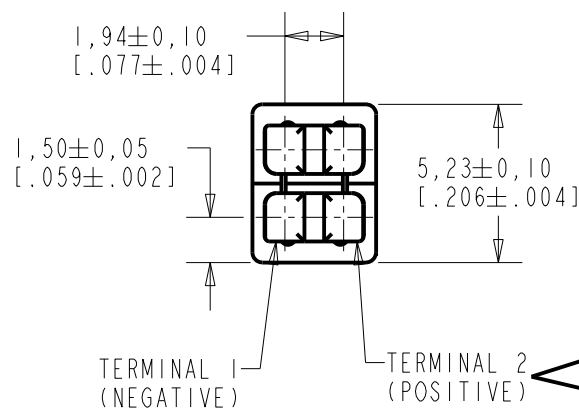
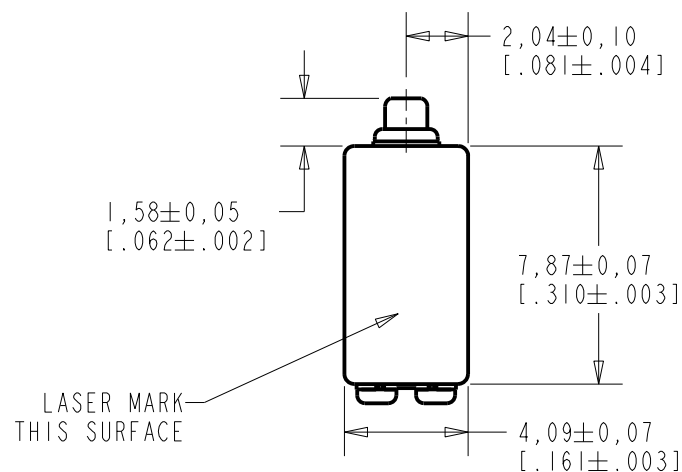

NOMINAL WEIGHT  
.71 GRAMS

DIMENSIONS IN MILLIMETERS [INCHES]

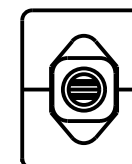
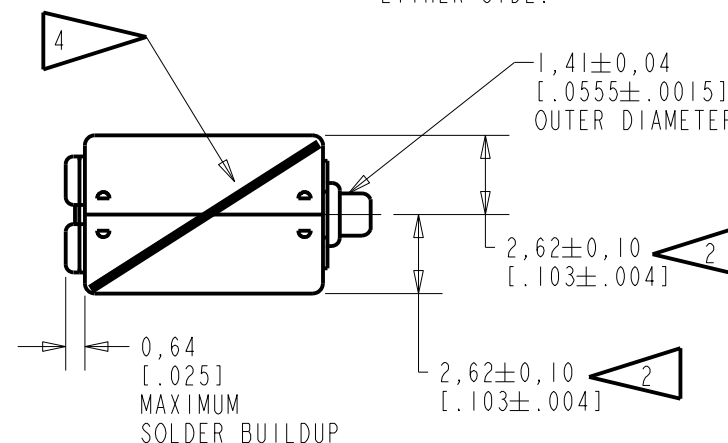

**KNOWLES ELECTRONICS**  
ITASCA, ILLINOIS U.S.A.

Revision	C.O. #	Implementation Date	RELEASE LEVEL	REVISION
C	CI0114023	8-30-12	Active	C
B	CI0112707	8-26-11		
A	CI0112225	4-13-11		
SCALE: 4:1			DR. BY KL	DATE 4-13-11
DO NOT SCALE DRAWING			CK. BY GJP	DATE 4-13-11
TITLE: RECEIVER			APP. BY GJP	DATE 4-13-11
OUTLINE DRAWING			HODTEC-31230-000 SHT 1.1	

**SHEET 2.1**

Revision	C.O. #	Implementation Date	RELEASE LEVEL	REVISION
C	C10114023	8-30-12	Active	C
B	C10112707	8-26-11		
A	C10112225	4-13-11		
WHEN TEST LIMITS ARE USED TO ESTABLISH INCOMING INSPECTION ACCEPTANCE/REJECTION CRITERIA, CORRELATION OF TEST EQUIPMENT WITH KNOWLES IS ALSO REQUIRED FOR ELIMINATION OF EQUIPMENT AND TEST METHOD VARIATION				DR. BY DATE
				KL 4-13-11
				CK. BY DATE
TITLE: RECEIVER			HODTEC-31230-000	
			SHT 2.1	
PERFORMANCE SPECIFICATION			GJP 4-13-11	
			APP. BY DATE	
			GJP 4-13-11	

# Mouser Electronics

Authorized Distributor

Click to View Pricing, Inventory, Delivery & Lifecycle Information:

## Knowles:

[HODVTEC-31516-000](#) [HODTEC-31268-000](#) [HODTEC-31230-000](#) [HODVTEC-31618-000](#) [HODVTEC-32951-000](#)  
[HODVTEC-61242-000](#) [HODVTEC-61553-000](#)