

76829-0006 SHOWN

NOTES:

- MATERIAL:  
HOUSING: LCP, UL94V-0, GLOW WIRE CAPABLE PER IEC-60335-1 5TH EDITION, COLOR: BLACK.  
TERMINAL: HIGH CONDUCTIVITY COPPER.
- TERMINAL PLATING:  
(TIN) 1.52 MICROMETER /(60 MICROINCH) MIN REFLOWED MATTE TIN OVER  
1.27 MICROMETER /(50 MICROINCH) MIN NICKEL OVERALL.  
(15 GOLD) 0.38 MICROMETER /(15 MICROINCH) MIN SELECT GOLD ON CONTACT AREA  
2.54 MICROMETER /(100 MICROINCH) MIN SELECT MATTE TIN ON SOLDER AREA  
BOTH OVER 1.27 MICROMETER /(50 MICROINCH) MIN NICKEL OVERALL  
(30 GOLD) 0.76 MICROMETER /(30 MICROINCH) MIN SELECT GOLD ON CONTACT AREA  
2.54 MICROMETER /(100 MICROINCH) MIN SELECT MATTE TIN ON SOLDER AREA  
BOTH OVER 1.27 MICROMETER /(50 MICROINCH) MIN NICKEL OVERALL
- PRODUCT SPECIFICATION PS-76823-100.
- PART MATES WITH MOLEX PART NUMBER 170001 AND 171692 SERIES.
- PACKAGING: TRAY PACKED PER MOLEX SPECIFICATION PK-31301-976, WHILE T&R IS 1720650900.
- APPLICATION SPECIFICATION: AS-76823-100
- PARTS CONFORM TO CLASS "B" REQUIREMENTS OF COSMETIC SPECIFICATION PS-45499-002.

MODEL: 768290000

SYMBOLS	THIS DRAWING CONTAINS INFORMATION THAT IS PROPRIETARY TO MOLEX ELECTRONIC TECHNOLOGIES, LLC AND SHOULD NOT BE USED WITHOUT WRITTEN PERMISSION			
	DIMENSION UNITS		SCALE	
∇ = 0	INCH		CURRENT REV DESC: CORRECT 2CKT PCB	
∇ = 0	GENERAL TOLERANCES (UNLESS SPECIFIED)			
∇ = 0		MM	INCH	EC NO: 605032
∇ = 0	4 PLACES	±	±	DRWN: SCHEN76 2018/09/18
∇ = 0	3 PLACES	±	±	CHK'D: AYIN 2018/09/27
∇ = 0	2 PLACES	± 0.25	±	APPR: AYIN 2018/09/27
∇ = 0	1 PLACE	± 0.5	±	INITIAL REVISION:
∇ = 0	0 PLACES	±	±	DRWN: DRWN BY XXXX/XX/XX
∇ = 0	ANGULAR TOL	± 0.5 °		APPR: APPR BY XXXX/XX/XX
∇ = 0	DRAFT WHERE APPLICABLE MUST REMAIN WITHIN DIMENSIONS		THIRD ANGLE PROJECTION	DRAWING SERIES
∇ = 0			C-SIZE	76829
DOCUMENT NUMBER		DOC TYPE		DOC PART
SD-76829-0100		PSD		000
MATERIAL NUMBER		CUSTOMER		SHEET NUMBER
		GENERAL MARKET		1 OF 3

**molex**

MEGA-FIT VERTICAL HEADER  
VERTICAL HEADER ASSY 2-12 CKT TOP LATCH

PRODUCT CUSTOMER DRAWING

DOCUMENT NUMBER: SD-76829-0100  
DOC TYPE: PSD  
DOC PART: 000  
REVISION: D8

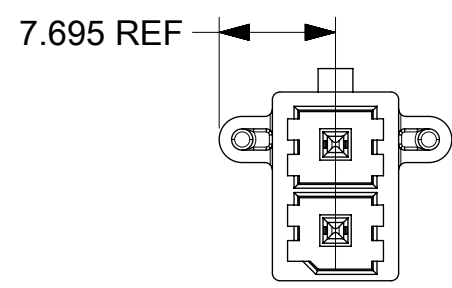

2 CKT

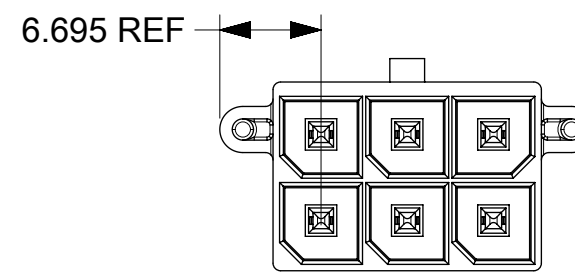

4-12 CKT

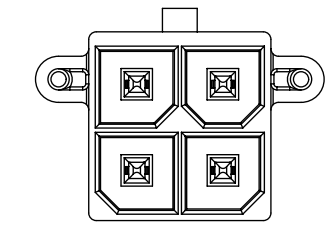

4 CKT

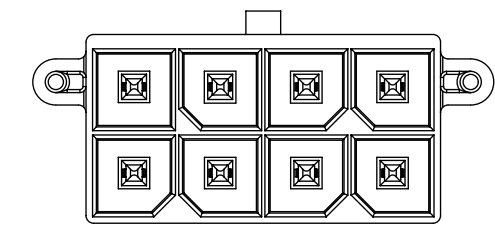

8 CKT

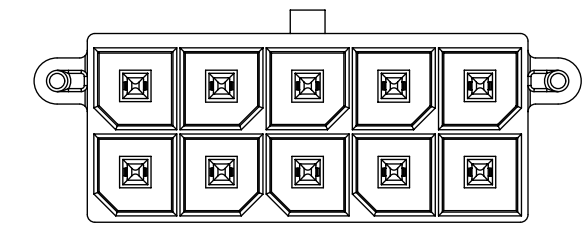

10 CKT

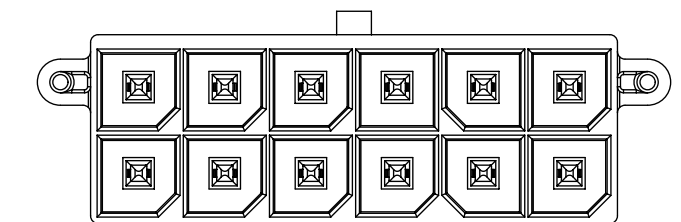

12 CKT

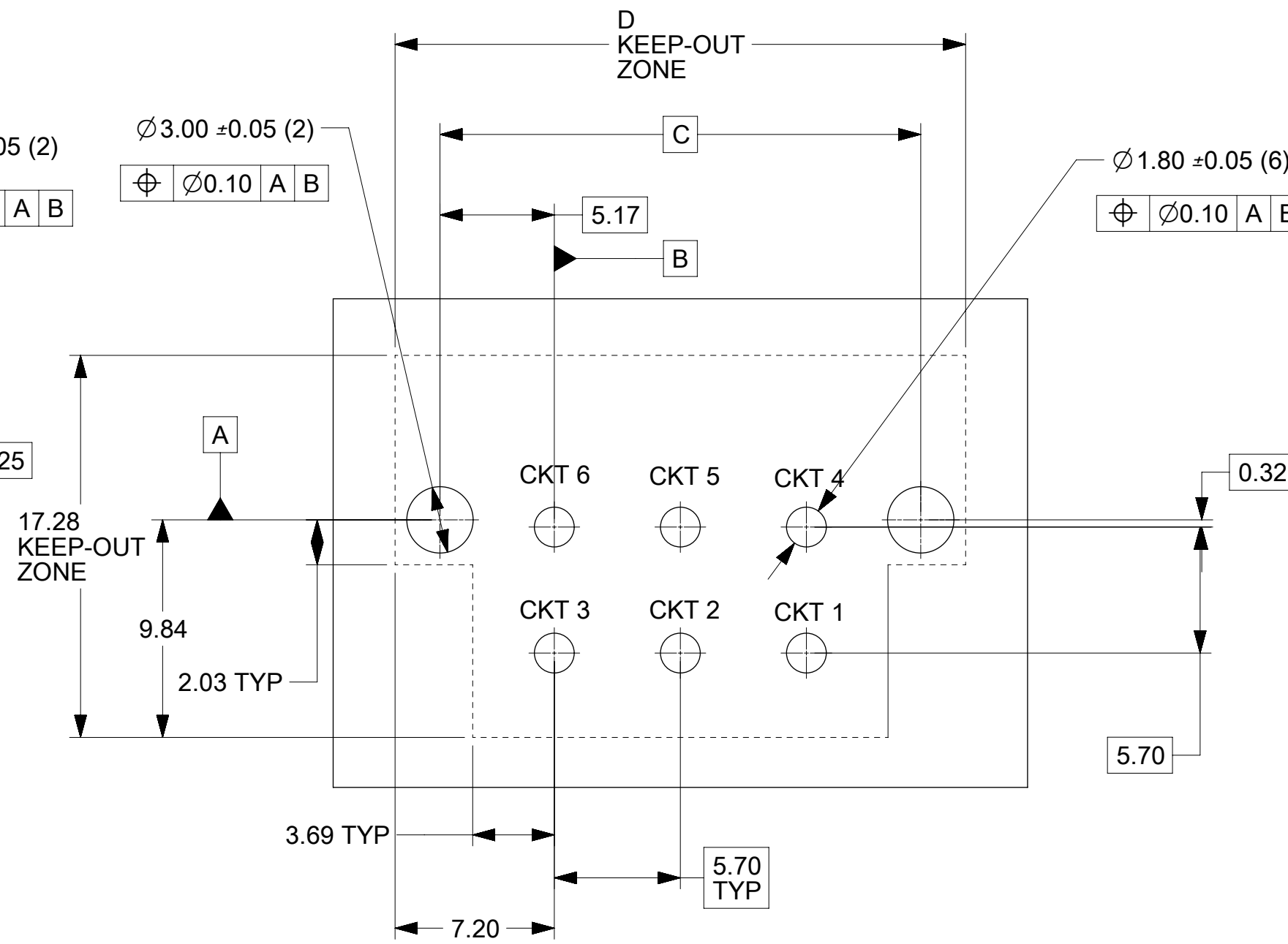
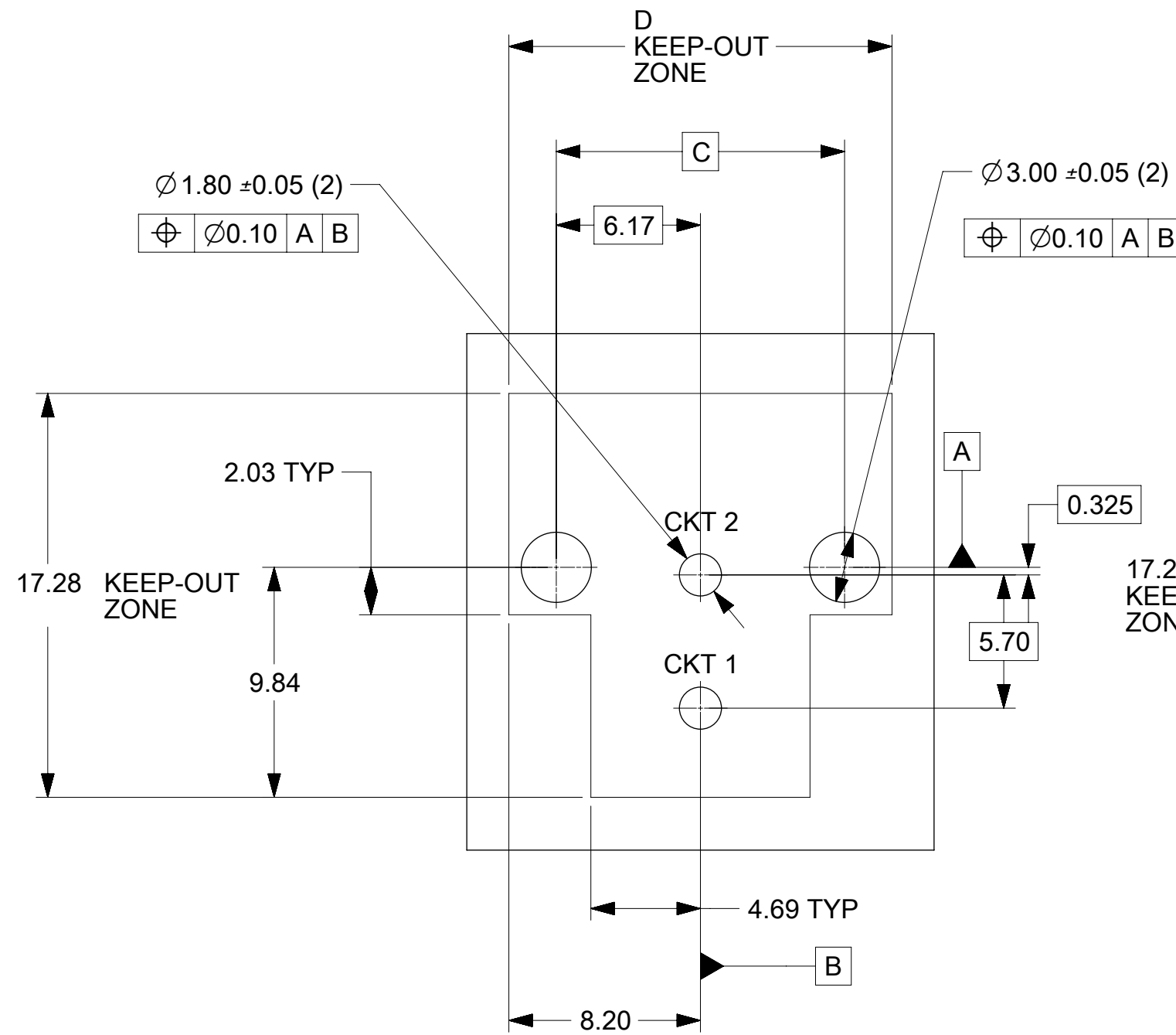

SYMBOLS	THIS DRAWING CONTAINS INFORMATION THAT IS PROPRIETARY TO MOLEX ELECTRONIC TECHNOLOGIES, LLC AND SHOULD NOT BE USED WITHOUT WRITTEN PERMISSION				
	DIMENSION UNITS	SCALE	CURRENT REV DESC: CORRECT 2CKT PCB		
∇ = 0	INCH		<b>molex</b> MEGA-FIT VERTICAL HEADER VERTICAL HEADER ASSY 2-12 CKT TOP LATCH PRODUCT CUSTOMER DRAWING		
∇ = 0	GENERAL TOLERANCES (UNLESS SPECIFIED)				
∇ = 0		MM			INCH
S = 0	4 PLACES	±			±
∇ = 0	3 PLACES	±			±
∇ = 0	2 PLACES	± 0.25	±	EC NO: 605032 DRWN: SCHEN76 2018/09/18 CHK'D: AYIN 2018/09/27 APPR: AYIN 2018/09/27	
∇ = 0	1 PLACE	± 0.5	±	INITIAL REVISION:	
∇ = 0	0 PLACES	±	±	DRWN: DRWN BY XXXX/XX/XX	
∇ = 0	ANGULAR TOL	± 0.5 °		APPR: APPR BY XXXX/XX/XX	
∇ = 0	DRAFT WHERE APPLICABLE MUST REMAIN WITHIN DIMENSIONS		THIRD ANGLE PROJECTION	DRAWING SERIES	
			C-SIZE	76829	
DOCUMENT STATUS		P1	RELEASE DATE	2018/09/27 04:38:23	
12	11	10	9	8	
DOCUMENT NUMBER		CUSTOMER		SHEET NUMBER	
SD-76829-0100		GENERAL MARKET		2 OF 3	
DOC TYPE		DOC PART	REVISION		
PSD		000	D8		

12	11	10	9	8	7	6	5	4	3	2	1
CKT SIZE	PART NO.	PLATING	DIM A	DIM B	DIM C BASIC	DIM D	PK SPEC				
2	76829-0002	TIN	8.35	15.39	12.34	16.40	TRAY				
4	76829-0004	TIN	12.05	19.09	16.04	20.10					
6	76829-0006	TIN	17.75	24.79	21.74	25.80					
8	76829-0008	TIN	23.45	30.49	27.44	31.50					
10	76829-0010	TIN	29.15	36.19	33.14	37.20					
12	76829-0012	TIN	34.85	41.89	38.84	42.90					
2	172065-0002	15 GOLD	8.35	15.38	12.34	16.40					
4	172065-0004	15 GOLD	12.05	19.09	16.04	20.10					
6	172065-0006	15 GOLD	17.75	24.79	21.74	25.80					
8	172065-0008	15 GOLD	23.45	30.49	27.44	31.50					
10	172065-0010	15 GOLD	29.15	36.19	33.14	37.20					
12	172065-0012	15 GOLD	34.85	41.89	38.84	42.90					
2	172065-1002	30 GOLD	8.35	15.38	12.34	16.40					
4	172065-1004	30 GOLD	12.05	19.09	16.04	20.10					
6	172065-1006	30 GOLD	17.75	24.79	21.74	25.80					
8	172065-1008	30 GOLD	23.45	30.49	27.44	31.50					
10	172065-1010	30 GOLD	29.15	36.19	33.14	37.20					
12	172065-1012	30 GOLD	34.85	41.89	38.84	42.90					

12	11	10	9	8	7	6	5	4	3	2	1	
CKT SIZE	PART NO.	PLATING	DIM A	DIM B	DIM C BASIC	DIM D	PK SPEC					
*	2	76829-0902	TIN	8.35	15.38	12.34	16.40	TAPE&REEL WITHOUT KAPTON				
	4	76829-0904	TIN	12.05	19.09	16.04	20.10					
	6	76829-0906	TIN	17.75	24.79	21.74	25.80					
	8	76829-0908	TIN	23.45	30.49	27.44	31.50					
*	10	76829-0910	TIN	29.15	36.19	33.14	37.20					
*	12	76829-0912	TIN	34.85	41.89	38.84	42.90					
*	2	172065-0902	15 GOLD	8.35	15.38	12.34	16.40					
	4	172065-0904	15 GOLD	12.05	19.09	16.04	20.10					
	6	172065-0906	15 GOLD	17.75	24.79	21.74	25.80					
	8	172065-0908	15 GOLD	23.45	30.49	27.44	31.50					
*	10	172065-0910	15 GOLD	29.15	36.19	33.14	37.20					
*	12	172065-0912	15 GOLD	34.85	41.89	38.84	42.90					
*	2	172065-1902	30 GOLD	8.35	15.38	12.34	16.40					
	4	172065-1904	30 GOLD	12.05	19.09	16.04	20.10					
	6	172065-1906	30 GOLD	17.75	24.79	21.74	25.80					
	8	172065-1908	30 GOLD	23.45	30.49	27.44	31.50					
*	10	172065-1910	30 GOLD	29.15	36.19	33.14	37.20					
*	12	172065-1912	30 GOLD	34.85	41.89	38.84	42.90					
*	2	76829-0702	TIN	8.35	15.38	12.34	16.40		TAPE&REEL WITH KAPTON			
*	4	76829-0704	TIN	12.05	19.09	16.04	20.10					
*	6	76829-0706	TIN	17.75	24.79	21.74	25.80					
*	8	76829-0708	TIN	23.45	30.49	27.44	31.50					
*	10	76829-0710	TIN	29.15	36.19	33.14	37.20					
*	12	76829-0712	TIN	34.85	41.89	38.84	42.90					
*	2	172065-0702	15 GOLD	8.35	15.38	12.34	16.40					
*	4	172065-0704	15 GOLD	12.05	19.09	16.04	20.10					
*	6	172065-0706	15 GOLD	17.75	24.79	21.74	25.80					
*	8	172065-0708	15 GOLD	23.45	30.49	27.44	31.50					
*	10	172065-0710	15 GOLD	29.15	36.19	33.14	37.20					
*	12	172065-0712	15 GOLD	34.85	41.89	38.84	42.90					
*	2	172065-1702	30 GOLD	8.35	15.38	12.34	16.40					
*	4	172065-1704	30 GOLD	12.05	19.09	16.04	20.10					
*	6	172065-1706	30 GOLD	17.75	24.79	21.74	25.80					
*	8	172065-1708	30 GOLD	23.45	30.49	27.44	31.50					
*	10	172065-1710	30 GOLD	29.15	36.19	33.14	37.20					
*	12	172065-1712	30 GOLD	34.85	41.89	38.84	42.90					

\* DESIGNATES PART NOT RELEASED  
CONTACT FACTORY FOR AVAILABILITY.

MODEL: 768290000

SYMBOLS	THIS DRAWING CONTAINS INFORMATION THAT IS PROPRIETARY TO MOLEX ELECTRONIC TECHNOLOGIES, LLC AND SHOULD NOT BE USED WITHOUT WRITTEN PERMISSION									
	DIMENSION UNITS		SCALE		CURRENT REV DESC: CORRECT 2CKT PCB					
∇ = 0	INCH				<b>molex</b> MEGA-FIT VERTICAL HEADER VERTICAL HEADER ASSY 2-12 CKT TOP LATCH PRODUCT CUSTOMER DRAWING DOCUMENT NUMBER: <b>SD-76829-0100</b>   DOC TYPE: PSD   DOC PART: 000   REVISION: D8 MATERIAL NUMBER:   CUSTOMER: GENERAL MARKET   SHEET NUMBER: 3 OF 3					
∇ = 0	GENERAL TOLERANCES (UNLESS SPECIFIED)									
∇ = 0		MM	INCH							
∇ = 0	4 PLACES	±		±						
∇ = 0	3 PLACES	±		±						
∇ = 0	2 PLACES	±	0.25	±						
∇ = 0	1 PLACE	±	0.5	±						
∇ = 0	0 PLACES	±		±						
∇ = 0	ANGULAR TOL ± 0.5 °		THIRD ANGLE PROJECTION		DRAWING		SERIES			
∇ = 0	DRAFT WHERE APPLICABLE MUST REMAIN WITHIN DIMENSIONS				C-SIZE		76829			