

VES Series

Features

- 4 ϕ ~ 6.3 ϕ , 105°C, 1,000 hours assured
- Vertical chip type miniaturized for 5.5mm high capacitor
- Designed for surface mounting on high density PC board
- RoHS Compliance



Marking color: Black

Specifications

Items	Performance																								
Category Temperature Range	-55°C ~ +105°C																								
Capacitance Tolerance	±20% (at 120Hz, 20°C)																								
Leakage Current (at 20°C)	I = 0.01CV or 3 (μA) whichever is greater (after 2 minutes) Where, C = rated capacitance in μF, V = rated DC working voltage in V																								
Tanδ (at 120Hz, 20°C)	<table border="1"> <thead> <tr> <th>Rated Voltage</th> <th>6.3</th> <th>10</th> <th>16</th> <th>25</th> <th>35</th> <th>50</th> </tr> </thead> <tbody> <tr> <td>Tanδ (max)</td> <td>0.30</td> <td>0.26</td> <td>0.22</td> <td>0.16</td> <td>0.13</td> <td>0.12</td> </tr> </tbody> </table>	Rated Voltage	6.3	10	16	25	35	50	Tanδ (max)	0.30	0.26	0.22	0.16	0.13	0.12										
Rated Voltage	6.3	10	16	25	35	50																			
Tanδ (max)	0.30	0.26	0.22	0.16	0.13	0.12																			
Low Temperature Characteristics (at 120Hz)	<p>Impedance ratio shall not exceed the values given in the table below.</p> <table border="1"> <thead> <tr> <th colspan="2">Rated Voltage</th> <th>6.3</th> <th>10</th> <th>16</th> <th>25</th> <th>35</th> <th>50</th> </tr> </thead> <tbody> <tr> <td>Impedance</td> <td>Z(-25°C)/Z(+20°C)</td> <td>4</td> <td>3</td> <td>2</td> <td>2</td> <td>2</td> <td>2</td> </tr> <tr> <td>Ratio</td> <td>Z(-55°C)/Z(+20°C)</td> <td>8</td> <td>5</td> <td>4</td> <td>3</td> <td>3</td> <td>3</td> </tr> </tbody> </table>	Rated Voltage		6.3	10	16	25	35	50	Impedance	Z(-25°C)/Z(+20°C)	4	3	2	2	2	2	Ratio	Z(-55°C)/Z(+20°C)	8	5	4	3	3	3
Rated Voltage		6.3	10	16	25	35	50																		
Impedance	Z(-25°C)/Z(+20°C)	4	3	2	2	2	2																		
Ratio	Z(-55°C)/Z(+20°C)	8	5	4	3	3	3																		
Endurance	<table border="1"> <thead> <tr> <th>Test Time</th> <th>1,000 Hrs</th> </tr> </thead> <tbody> <tr> <td>Capacitance Change</td> <td>Within ±20% of initial value</td> </tr> <tr> <td>Tanδ</td> <td>Less than 200% of specified value</td> </tr> <tr> <td>Leakage Current</td> <td>Within specified value</td> </tr> </tbody> </table> <p>* The above specifications shall be satisfied when the capacitors are restored to 20°C after the rated voltage applied for 1,000 hours at 105°C.</p>	Test Time	1,000 Hrs	Capacitance Change	Within ±20% of initial value	Tanδ	Less than 200% of specified value	Leakage Current	Within specified value																
Test Time	1,000 Hrs																								
Capacitance Change	Within ±20% of initial value																								
Tanδ	Less than 200% of specified value																								
Leakage Current	Within specified value																								
Shelf Life Test	<table border="1"> <thead> <tr> <th>Test Time</th> <th>1,000 Hrs</th> </tr> </thead> <tbody> <tr> <td>Capacitance Change</td> <td>Within ±20% of initial value</td> </tr> <tr> <td>Tanδ</td> <td>Less than 200% of specified value</td> </tr> <tr> <td>Leakage Current</td> <td>Within specified value</td> </tr> </tbody> </table> <p>* The above specifications shall be satisfied when the capacitors are restored to 20°C after exposing them for 1,000 hours at 105°C without voltage applied.</p>	Test Time	1,000 Hrs	Capacitance Change	Within ±20% of initial value	Tanδ	Less than 200% of specified value	Leakage Current	Within specified value																
Test Time	1,000 Hrs																								
Capacitance Change	Within ±20% of initial value																								
Tanδ	Less than 200% of specified value																								
Leakage Current	Within specified value																								
Ripple Current and Frequency Multipliers	<table border="1"> <thead> <tr> <th>Frequency (Hz)</th> <th>50</th> <th>120</th> <th>1k</th> <th>10k up</th> </tr> </thead> <tbody> <tr> <td>Multiplier</td> <td>0.7</td> <td>1.0</td> <td>1.3</td> <td>1.4</td> </tr> </tbody> </table>	Frequency (Hz)	50	120	1k	10k up	Multiplier	0.7	1.0	1.3	1.4														
Frequency (Hz)	50	120	1k	10k up																					
Multiplier	0.7	1.0	1.3	1.4																					

Diagram of Dimensions

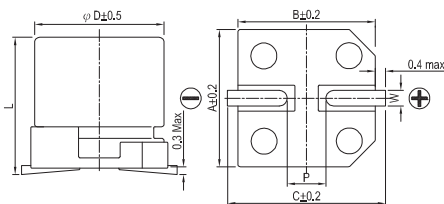

Marking

Lead Spacing and Diameter

Unit: mm

φD	L	A	B	C	W	P ± 0.2
4	5.3 ± 0.2	4.3	4.3	5.1	0.5 ~ 0.8	1.0
5	5.3 ± 0.2	5.3	5.3	5.9	0.5 ~ 0.8	1.5
6.3	5.3 ± 0.2	6.6	6.6	7.2	0.5 ~ 0.8	2.0

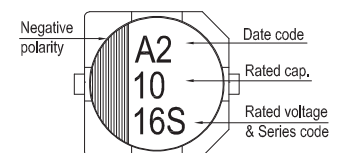

Dimension: φD × L(mm)
Ripple Current: mA/rms at 120 Hz, 105°C

Dimension and Permissible Ripple Current

μF	V _{DC} Contents	6.3V (0J)		10V (1A)		16V (1C)		25V (1E)		35V (1V)		50V (1H)	
		φD×L	mA	φD×L	mA	φD×L	mA	φD×L	mA	φD×L	mA	φD×L	mA
1	010											4×5.3	7
2.2	2R2											4×5.3	10
3.3	3R3											4×5.3	12
4.7	4R7							4×5.3	12	4×5.3	14	5×5.3	17
10	100			4×5.3	15	4×5.3	16	5×5.3	21	5×5.3	23	6.3×5.3	26
22	220	4×5.3	21	5×5.3	25	5×5.3	28	6.3×5.3	36	6.3×5.3	50	6.3×5.3	51
33	330	5×5.3	30	5×5.3	31	6.3×5.3	40	6.3×5.3	44				
47	470	5×5.3	36	6.3×5.3	43	6.3×5.3	47	6.3×5.3	60				
100	101	6.3×5.3	61	6.3×5.3	65	6.3×5.3	70						

Part Numbering System

VES Series	10μF	±20%	16V	Carrier Tape	4 φ × 5.3L	Pb-free and PET coating case
VES	100	M	1C	TR	-	0405
Series Name	Capacitance	Capacitance Tolerance	Rated Voltage	Package Type	Terminal Type	Case size
						Lead Wire and Coating Type

Note: For more details, please refer to "Part Numbering System (SMD Type)" on page 15.

SMD

Mouser Electronics

Authorized Distributor

Click to View Pricing, Inventory, Delivery & Lifecycle Information:

Lelon:

[VES-010M1HTR-0405](#) [VES-100M1CTR-0405](#) [VES-100M1HTR-0605](#) [VES-100M1VTR-0505](#) [VES-101M0JTR-0605](#)
[VES-101M1CTR-0605](#) [VES-2R2M1HTR-0405](#) [VES-220M0JTR-0405](#) [VES-220M1CTR-0505](#) [VES-220M1VTR-0605](#)
[VES-330M1ETR-0605](#) [VES-4R7M1VTR-0405](#) [VES-470M0JTR-0505](#) [VES-470M1CTR-0605](#) [VES-470M1ETR-0605](#)
[VES-0R1M1HTR-0405](#) [VES-100M1ATR-0405](#) [VES-100M1ETR-0505](#) [VES-101M1ATR-0605](#) [VES-220M1ATR-0505](#)
[VES-220M1ETR-0605](#) [VES-220M1HTR-0605](#) [VES-330M0JTR-0505](#) [VES-330M1ATR-0505](#) [VES-330M1CTR-0605](#)
[VES-3R3M1HTR-0405](#) [VES-470M1ATR-0605](#) [VES-4R7M1ETR-0405](#) [VES-4R7M1HTR-0405](#) [VES-R22M1HTR-0405](#)
[VES-R33M1HTR-0405](#) [VES-R47M1HTR-0405](#) [VES-101M1ETR-0607](#) [VES-4R7M1HTR-0505](#)