

DIN Receptacles

161-0003-E, 161-0005-E, 161-0006-E



DIN Receptacles

161-0003-E, 161-0005-E, 161-0006-E

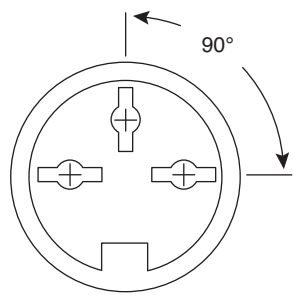
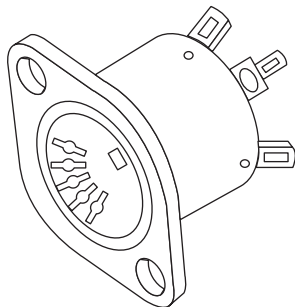
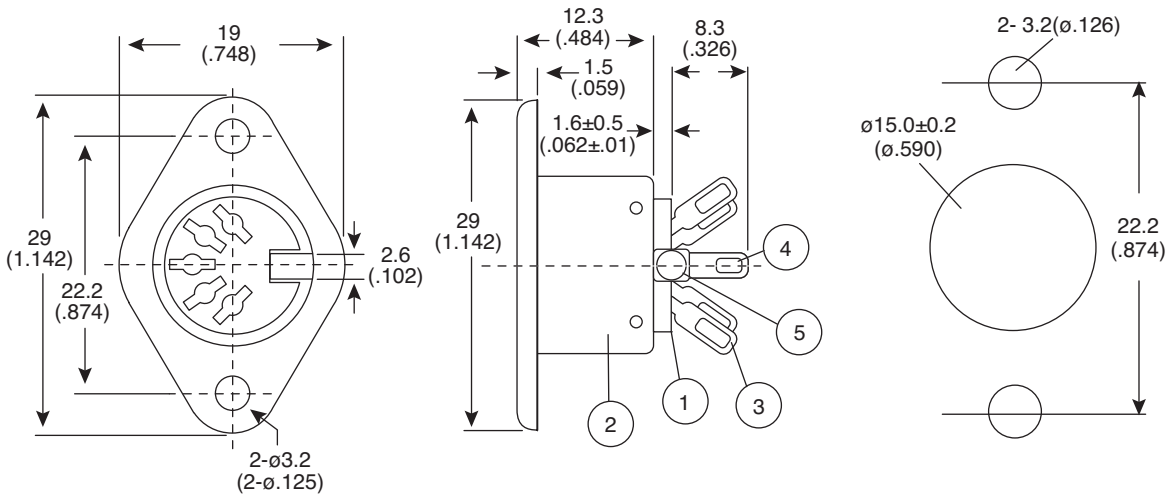

3 Contacts
161-0003-E

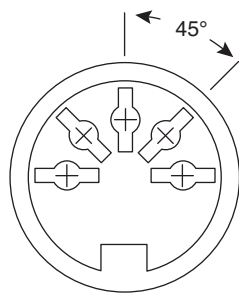

5 Contacts
161-0005-E

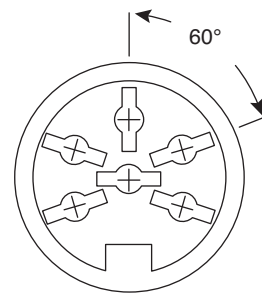

6 Contacts
161-0006-E

Dimensions: mm (in.)

SPECIFICATIONS	
Rating:	2A/100VAC
Insulation Resistance:	300MΩ min @ 500VDC
Dielectric Strength:	1,000VAC for 1 Minute
Contact Resistance:	20mΩ max
Insertion Force:	4Kg max
Withdrawal Force:	1-3.5Kg

MATERIALS		
No.	Part Name	Material / Plating
1	Insulator	1 PBT
2	Socket Case	Nickel Plated
3	Contact	Tin Plated Brass
4	Earth Pin	Nickel Plated Brass
5	Rivet	Nickel Plated Aluminum

Mouser Stock No.	Description	Degree of Arc
161-0003-E	3 Pin Metal Body	180°
161-0005-E	5 Pin Metal Body	180°
161-0006-E	6 Pin Metal Body	240°
RoHS Compliant		

Date Last Revised: 12-16-09

Available from Mouser Electronics
1-800-346-6873 / www.mouser.com

KC-301198

Specifications are subject to change without notice. No liability or warranty implied by this information. Environmental compliance based on producer documentation.

Mouser Electronics

Authorized Distributor

Click to View Pricing, Inventory, Delivery & Lifecycle Information:

[Kobiconn:](#)

[161-0003-E](#) [161-0005-E](#) [161-0006-E](#)