

X (2:1)

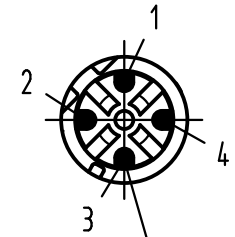

Steckgesicht nach  
contact face acc. to  
IEC 61076-2-101

Montagehilfe wird lose beigelegt  
assembly aid enclosed

Crimpkontakte separat bestellen  
order contacts separately

Spannung/voltage: 250V a.c/d.c  
Strom/current: 4A/40°C  
Betriebstemperatur: -40°C - +85°C  
working temperature:

Kabelø cableø	Leiterquerschnitt wire gauge	Bestell-Nr. part-no.
4,5-8,8mm	AWG 26-22	09 67 000 5576
	AWG 24-20	09 67 000 8576
	AWG 22-18	09 67 000 3576

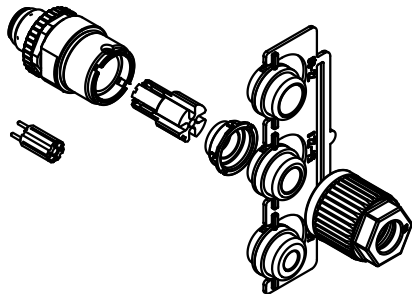

ALL Dimensions in mm Original Size DIN A 4		Techn. Character.		Nicht tolerierte Maß/Free size tolerances	
		Dat.	Name	Maßstab/Scale <b>1:1</b>	<b>RSV M12-L</b> <b>circular connector M12-L</b> 4-polig Stift D-kodiert Crimp geschirmt 4-pole male D-coded crimp shielded
		Detail.	16.04.12 Bus.		
		Insp.	Ge		
		Stand.			
ECO4958		HARTING Electronics GmbH & Co. KG D-32339 ESPELKAMP			<b>TB 21 03 882 1415</b> Blatt/ page
Mod.	Dat.	Name	Sub.		

# Mouser Electronics

Authorized Distributor

Click to View Pricing, Inventory, Delivery & Lifecycle Information:

[HARTING:](#)

[21038821415](#)