

### Feature -



- small size push switch (6x6 mm)
- bi-color LED illuminated available
- lock / non-lock function

### Application -

- consumer products
- computer products
- instrumentation
- communication equipments

## SPECIFICATIONS

SWITCH SPECIFICATIONS	
POLE - POSITION	SPDT , DPDT
CONTACT RATING	12 V DC , 50 mA
CONTACT RESISTANCE	100 mΩ MAX. 1.5 V DC ; 100 mA , by Method of Voltage DROP
INSULATION RESISTANCE	100 MΩ MIN. 500 V DC for 1 minute
DIELECTRIC STRENGTH	Breakdown is not Allowable ; 500 V AC for 1 Minute
OPERATING FORCE	250 ± 50 gf
OPERATING LIFE	50,000 cycles
OPERATING TEMPERATURE RANGE	-40°C ~ 85°C
TOTAL TRAVEL / OPERATING TRAVEL	2 ± 0.3 mm / 1 ± 0.3 mm

LED SPECIFICATIONS						
 <div>ATTENTION LEDs are Electrostatic Sensitive devices</div>		Unit	Value / LED Color			
			Blue	Green	Red	Yellow
FORWARD CURRENT	If	mA	20	20	20	20
REVERSE VOLTAGE	Vr	V	5.0	5.0	5.0	5.0
REVERSE CURRENT	Ir	μA	10	10	10	10
FORWARD VOLTAGE@20mA	Vf	V	3.3-4.0	2.1-2.5	2.0-2.5	2.0-2.5
LUMINOUS INTENSITY@20mA	Iv	mcd	1300	700	900	700

Physical and electrical information of LED will be provided upon customer's request on switches .

## HOW TO ORDER

PS020L	-	N	2	2	N	P	A	X	X		U	R	X	X	
		POLE		TIMING		FRAME		CAP COLOR		LED BRIGHTNESS		LED BRIGHTNESS			
		2	2 POLE ( std. )	N	NON - SHORTING ( std. )	A	P.C.B TYPE	G	GRAY (std.)	U	ULTRA ( std. )	U	ULTRA ( std. )		
		1	1 POLE			B	RIGHT ANGLE TYPE	K	BLACK	X	WITHOUT	X	WITHOUT		
		OPERATION		POSITION		B1	RIGHT ANGLE TYPE	R	RED						
		N	NON-LOCK ( std. )	2	2 POSITION ( std. )	C	WIRE TYPE	Y	YELLOW						
		L	LOCK TYPE			D	WIRE TYPE	T	TRANSPARENT						
						TERMINAL		CAP TYPE		CAP SYMBOL		LED COLOR		LED COLOR	
						P	P.C.B TYPE ( std. )	X	WITHOUT	Please refer to appendix 1(knob)		B	BLUE	B	BLUE
						S	SMT TYPE ( WITHOUT RIGHT ANGLE )	S1	SQUARE	For example		G	GREEN	G	GREEN
								R1	ROUND	K3:Printing		R	RED	R	RED
								S2	SQUARE	K3:Laser carving		W	WHITE	W	WHITE
								R2	ROUND	PE1:Printing		Y	YELLOW	Y	YELLOW
										E1:Laser carving		X	WITHOUT	X	WITHOUT
										WITHOUT					



► DIMENSION

PS020L-L22NSAXX□□□□

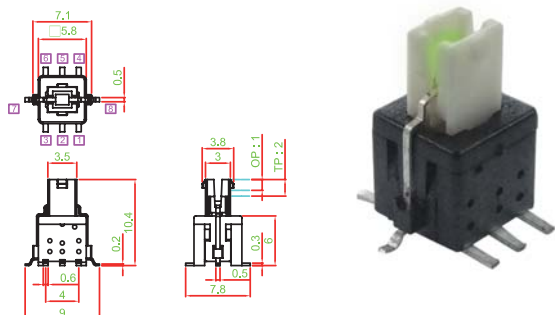

PS020L-L22NPB1XX□□□□

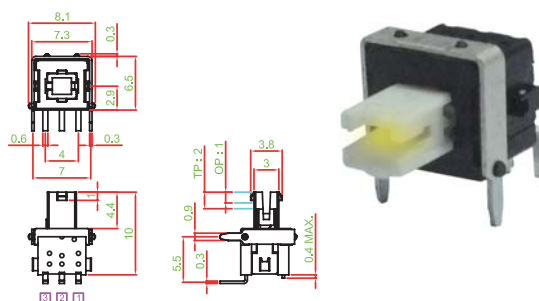

PS020L-L22NPAS2T□□□□

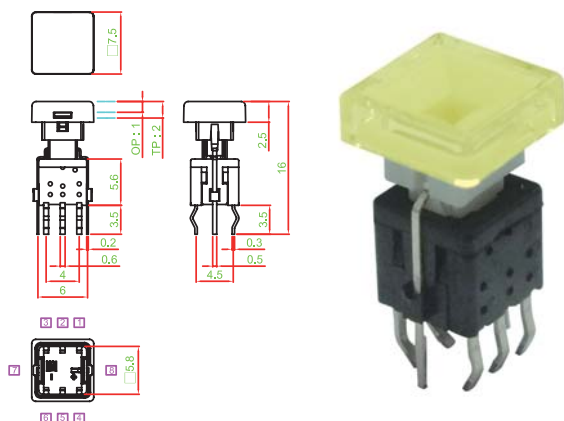

PS020L-L22NPAR2T□□□□

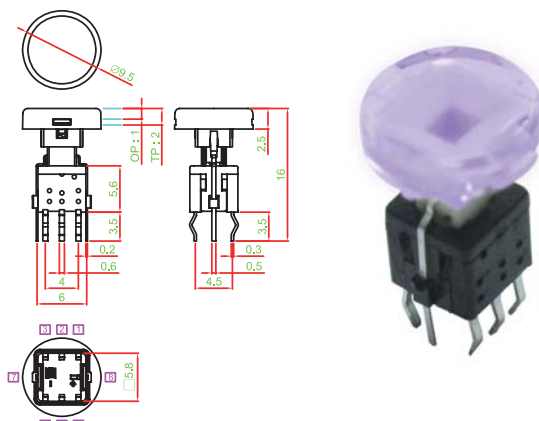

PS020L-L22NPCS2T□□□□

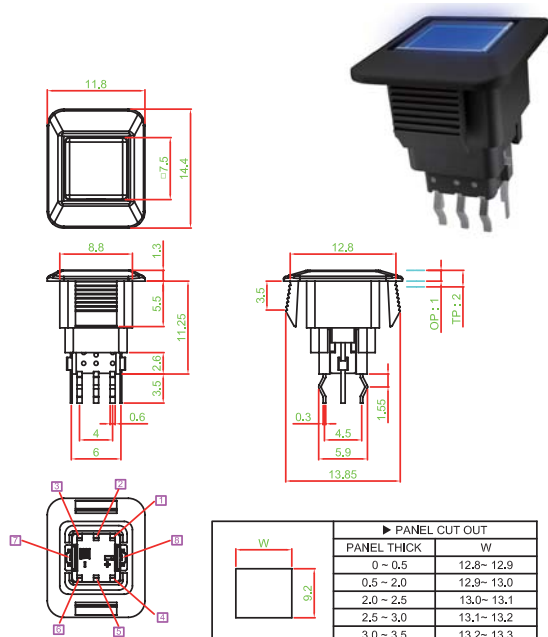

PS020L-L22NPDR2T□□□□

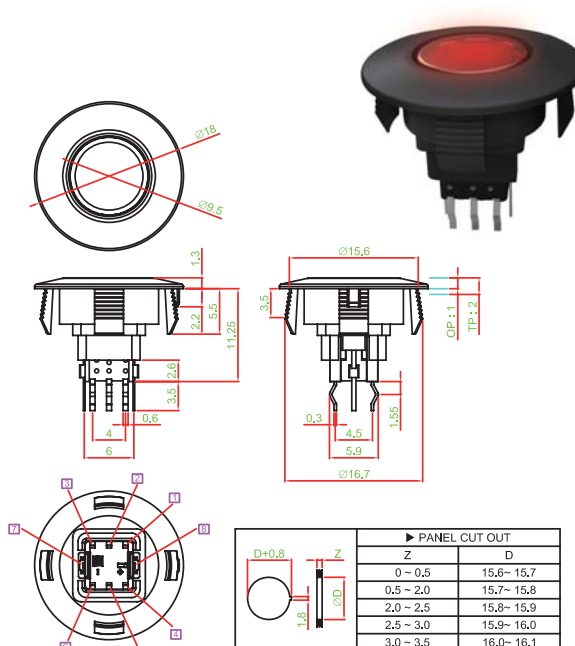

## ► DIMENSION

PS020L-L22NPAXX□□□□

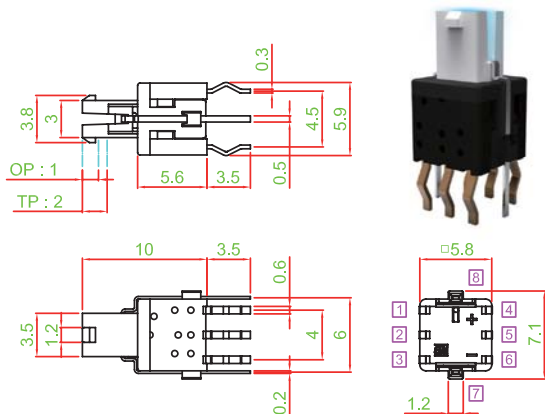

PS020L-L22NPAS1T□□□□

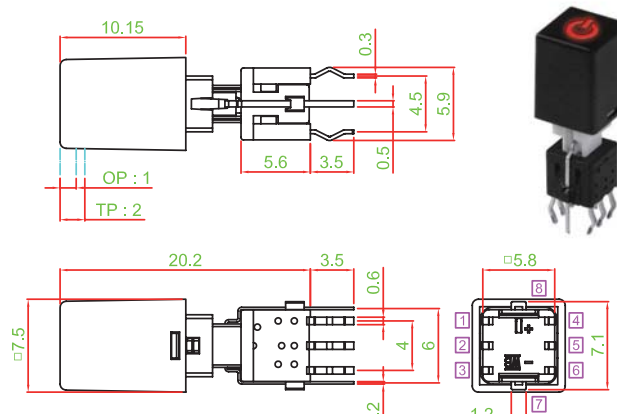

PS020L-L22NPBXX□□□□

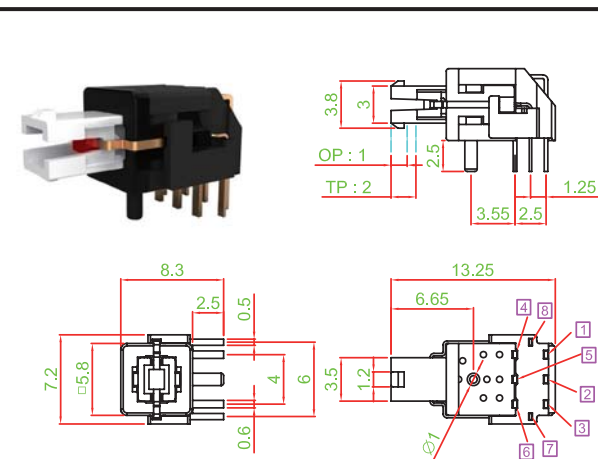

PS020L-L22NPAR1T□□□□

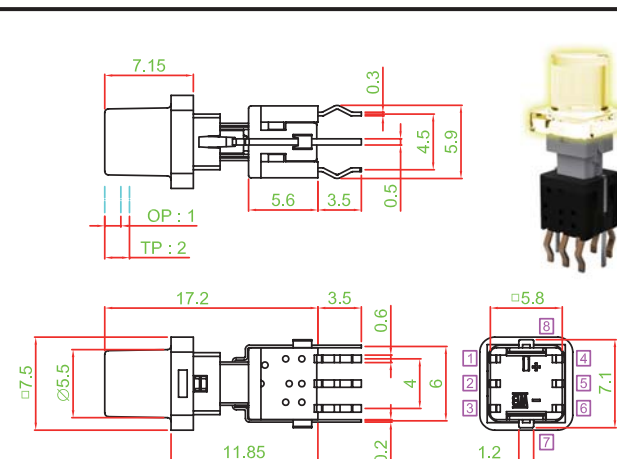

## ► P.C.B LAYOUT

A TYPE

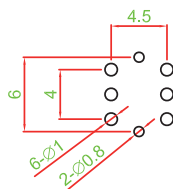

B TYPE

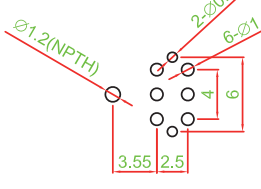

B1 TYPE

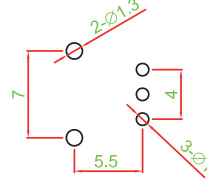

SMT TYPE

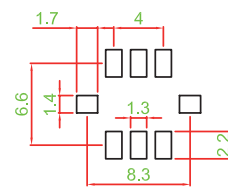

## ► SCHEMATIC

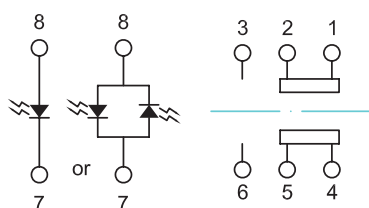

## ► MATERIAL

- ACTUATOR : PA + GF
- TERMINAL : BRONZE SILVER PLATING
- FRAME : PA + GF
- SPRING : STAINLESS STEEL

# Mouser Electronics

Authorized Distributor

Click to View Pricing, Inventory, Delivery & Lifecycle Information:

Well Buying:

[PS020L-N22NPBXXURXX](#) [PS020L-L22NPAS1KXXXX](#)