

THIS COPY IS PROVIDED ON A RESTRICTED BASIS AND IS NOT TO BE USED IN ANY WAY DETRIMENTAL TO THE INTERESTS OF PANDUIT CORP.

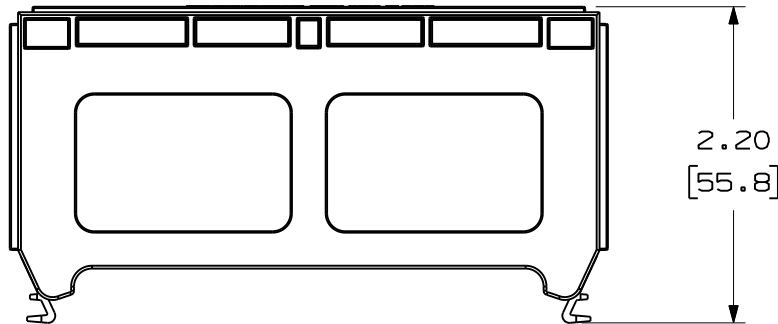
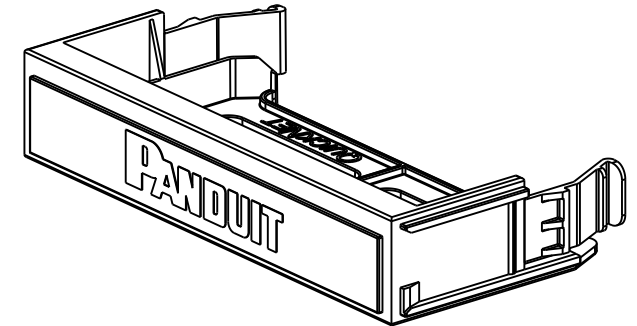
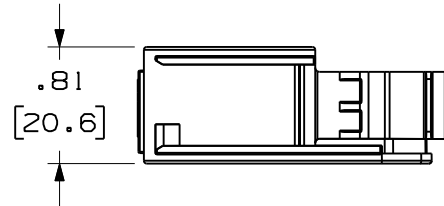
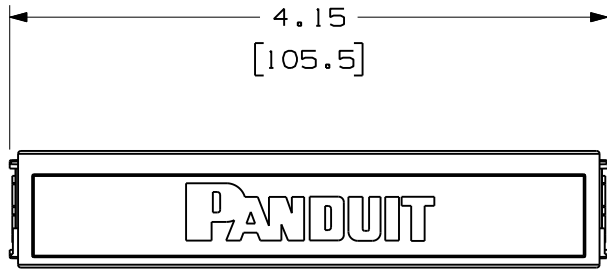

NOTES:

1. SEE CURRENT CATALOG FOR VARIOUS APPLICATIONS.
2. THE 6 PORT PANEL ADAPTER IS DESIGNED FOR USE WITH QuickNET QPP24 AND QPP48 SERIES STRAIGHT AND ANGLED PATCH PANELS.
3. DIMENSIONS IN BRACKETS ARE IN METRIC.

PANDUIT PART NUMBER	WEIGHT (APPOX.)
QPPBBL	0.04 lbs (20.0 g)



MODEL FILENAME	10F094BD/01	SIZE
DRAWING FILENAME	M02582CJ_DC43/04C	A

QuickNET PATCH PANEL  
BLANK CUSTOMER DRAWING

**PANDUIT**<sup>®</sup>  
TINLEY PARK, IL 60487

I.I. NUMBER
PRODUCT SPEC/ PKG SPEC
ASSY METHOD/ TEST METHOD
SCALE .75 TO 1
PART NO. QPPBBL
DRAWING NO. 02582-43

ALL DIMENSIONS ARE GIVEN IN INCHES, UNLESS OTHERWISE SPECIFIED.	
DIMENSIONAL TOLERANCES ARE: (.X) ±.03 (.XXX) ±.005 (.XX) ±.01 ANGLES ± 1°	
THIRD ANGLE PROJECTION	
DRAWN BY KSM	REVIEW DRAWING NUMBERS
DATE 1-03-07	MAT'L BLACK POLYCARBONATE
CHK'D WFMI	

REV	DATE	BY	CHK	DESCRIPTION	ECN	R	CUST	SUP	OTH
2	3-11-11	BJN	WFMI	B. UPDATED MODEL TO 10F094BD/01	02582-43		JPMC		
1	5-25-07	MDJr	WFMI	A. UPDATED MODEL TO REVISION 04	02582-43		TRW		
R	1-31-07	MDJr	WFMI	RELEASED FOR PRODUCTION	02582-43				

# Mouser Electronics

Authorized Distributor

Click to View Pricing, Inventory, Delivery & Lifecycle Information:

[Panduit:](#)

[QPPBBL](#)