

EXTREME SPEC Pak®

Sealed Power For Environmental Connections



Marine | Wind Power | Lighting | Transportation | Pumps | Ground Support
Machine Tool | Industrial Automation | Motor | Solar Power | Harsh Environments



APP
Anderson Power Products®

Rugged and Sealed (IP68) Plugs and Receptacles

For Use with APP® Powerpole® Signal, Power & Ground Contacts & Housings

The SPEC Pak® Extreme uses rugged and environmentally sealed (IP68) shells to protect APP Powerpole® contacts and housings. Customer configured SPEC Pak® Extreme Connectors are capable of up to 310 amps and may be used anywhere a rugged and/or waterproof high power, signal and ground interconnect solution is required.

The SPEC Pak® Extreme shell accepts 75 to 180 amp Powerpole® contacts. The wide range of Powerpole® housing colors and contact sizes, coupled with the available Powerpole® holders, offers the user a wide array of design options. Flexibility can be enhanced by replacing a PP120 housing with the PP15/45 adapter to provide auxiliary signal options. Wire sizes ranging from 24 to 3/0 AWG (0.25 to 85.0 mm²) can be accommodated. SPEC Pak® Extreme is highly configurable with thousands of design options in a single interconnect.

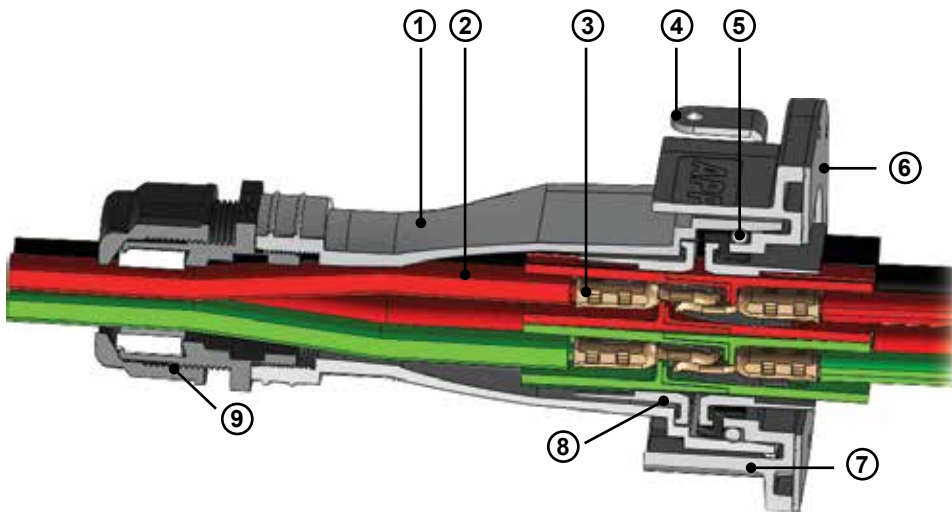

⑧ Powerpole® Insert Holders



E02



E04



E06



E09

- 1 - Chemical & UV Resistant Ruggedized Shells
- 2 - Color Coded Powerpole® Housings Match Wire Colors
- 3 - Power Contacts (up to 310 amps)
- 4 - Stainless Steel Latches (securing plug to receptacle)
- 5 - IP68 Interfacial Sealing O-Ring
- 6 - IP68 Panel Mount Sealing Gasket
- 7 - Chemical & UV Resistant Ruggedized Panel Mount Receptacle Shell

- 8 - Powerpole® Insert Holders (user configurable)
 - E02 Arrangement - up to two PP180
 - E04 Arrangement - up to four PP120
 - E06 Arrangement - up to six PP120 (4 each) & PP75 (2 each)
 - E09 Arrangement - up to nine PP75
- 9 - Industry Standard Sealing (IP68) Component
 - PG Gland Compatible - Size 42
 - Multi-Hole Glands For Use With Discrete Wires
 - Single Hole Glands For Use With Jacketed Cable

Specifications

Extreme SPEC Pak® Shell / Components

Electrical	Extreme
UL Voltage Rating (AC/DC)	600
Dielectric Withstanding Voltage (AC)	3000
Operating Temperature (°C)	-40 to + 105
(°F)	-40 to 221
Flammability Rating of SPEC Pak® Shells	UL94 V-0
UV Rating (equivalent)	UL746C F1

Mechanical	
Shell/Latch Mating Cycles	1,500
Average Connect/Disconnect (lbf)	37
(N)	165
IP Rating	IP68
Sealing Exceeds IP68, Meets Sealing Requirements of UL50E	
Crush test per EIA-364-40B	Pass

Material	
SPEC Pak® - Receptacle, Plug & Holders	PBT
Latch	Stainless Steel
Latch Retainer	Stainless Steel
Holder Retention Hardware (M8 x 18 & M8 x 25 screws)	NI Plated Steel

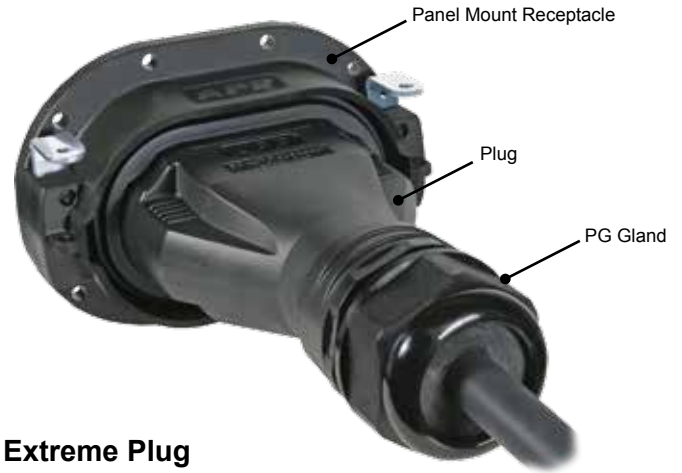

**Extreme Plug
Mated to Panel Mount Receptacle**

Powerpole® Contacts	PP180	PP120	PP75	PP15/45 & Ground
UL Current Rating (Amperes)	310	200	75	15 to 45
CSA (30C Rise) (Amperes)	230	155	45	10 to 29
Voltage Rating (AC/DC)	600	600	600	600
Contact Barrel Wire Size (AWG) - Power	3/0 to 6	1/0 to 6	6 to 12	10 to 20
- Ground	-	-	-	10 to 14
(mm²) - Power	85 to 13.3	53.5 to 13.3	13.3 to 3.3	4.0 to 0.5
- Ground	-	-	-	4.0 to 1.5
Average Contact Resistance (micro-ohms)	100	136	200	600
Contact Retention Force (lbf)	170	100	50	25-35
(N)	756	445	222	111
Operating Temperature (°C)	-20 to 105	-20 to 105	-20 to 105	-20 to 105
(°F)	-4 to 221	-4 to 221	-4 to 221	-4 to 221
Flammability Rating	UL94 V-0	UL94 V-0	UL94 V-0	UL94 V-0
Contact Materials	Copper	Copper	Copper	Copper
Contact Plating	Silver	Silver	Silver	Tin or Silver

Mechanical				
Mating Cycles - no load	10,000	10,000	10,000	10,000
Average Connect/Disconnect (lbf)	20	8	5 (Low Detent)	3 (Low Detent)
(single mated pair)			7 (High Detent)	5 (High Detent)

Material				
Powerpole® Housing Material	Polycarbonate	Polycarbonate	Polycarbonate	Polycarbonate

UL File No. E26226



For other industry tests and/or agency approvals, contact customer service.

Part Number Configurator

| PART NUMBER PLAN |

SPEC Pak® Series	Shell Color	Shell Style (Select One)	Dash	Shell Size	Insert Arrangement (Select One)
S	K	2	-	142	E02
S = SPEC Pak® Series	K = Black	2 = Panel Mount Receptacle 6 = Straight Plug 9 = Environmental Receptacle Cover 9P = Environmental Plug Cover		142=142mm shell	Detailed Information Is Available On: E02 = PP180, 2 Pole Page 7 E04 = PP120 Housing, 4 Pole Page 8 E06 = PP120 (4), PP75 (2), 6 Pole ... Page 9 E09 = PP75, 9 Pole Page 10

| RECEPTACLE KIT |

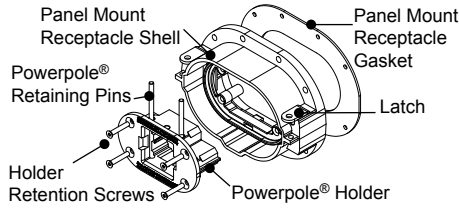

| PLUG KIT |

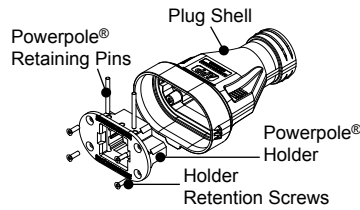

| IP68 SEALING COVER KIT |

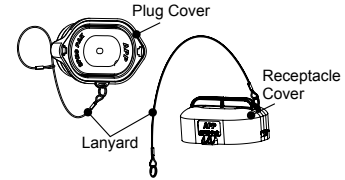

| ORDERING INFORMATION |

SPEC Pak® Kits

Part - Numbers - Minimum Quantity	Description
SK2-142E02	Receptacle Kit - Panel mount shell with latches - Panel mount gasket - Powerpole® holder - 2 pole - Retaining pins - 0.187 x 1.5 - Holder retention screws - M5 x 25
SK2-142E04	Receptacle Kit - Panel mount shell with latches - Panel mount gasket - Powerpole® holder - 4 pole - Retaining pins - 0.187 x 2.0 - Holder retention screws - M5 x 25
SK2-142E06	Receptacle Kit - Panel mount shell with latches - Panel mount gasket - Powerpole® holder - 6 pole - Retaining pins - 0.187 x 2.0 - Retaining pins - 0.187 x 0.87 - Holder retention screws - M5 x 25
SK2-142E09	Receptacle Kit - Panel mount shell with latches - Panel mount gasket - Powerpole® holder - 9 pole - Holder Retention Screws - M5 x 25

Part - Numbers - Minimum Quantity	Description
SK6-142E02	Plug Kit - Plug shell - Powerpole® holder - 2 pole - Retaining pins - 0.187 x 1.5 - Holder retention screws - M5 x 18
SK6-142E04	Plug Kit - Plug shell - Powerpole® holder - 4 pole - Retaining pins - 0.187 x 2.0 - Holder retention screws - M5 x 18
SK6-142E06	Plug Kit - Plug shell - Powerpole® holder - 6 pole - Retaining pins - Retaining pins - 0.187 x 2.0 - Retaining pins - 0.187 x 0.87 - Holder retention screws - M5 x 18
SK6-142E09	Plug Kit - Plug Shell - Powerpole® holder - 9 pole - Holder retention screws - M5 x 18

Component Replacement Parts

Part - Numbers - Minimum Quantity ...	Description
H1120P49	Screw M5x25 (for use in w/ receptacle)
H1120P48	Screw M5x18 (for use in w/ plug)
111812P12	Retaining pin 0.187 x 2.0
111812P11	Retaining pin 0.187 x 0.87
111812P1	Retaining pin 0.094 x 0.85
114896P1	Panel gasket (for use w/ receptacle)
111812P8	Retaining pin 0.187 x 1.5
2400G1	PP15/45 housing adapter

Cover Kit, Environmental Sealed

Part - Numbers - Minimum Quantity	Description
SK9P-142	Plug Protective Cover - Protective sealing (IP68) cover - Lanyard
SK9-142	Receptacle Cover Kit - Protective sealing (IP68) cover - Lanyard

NOTE:

- Panel mount receptacle mounting hardware (8 each ¼ inch or M6 screw) not included
- Recommended torque for panel mount receptacle mounting hardware is 26 to 30 inch - lbs [3 to- 3.4Nm]

| PART NUMBER PLAN |

Wire Protection		Housing Arrangement		Contact		APP®																																																																																																				
See page 6 (Select Two)		For more information see pages 7 thru 10																																																																																																								
Dash		(Select One)		(Select One)		Dash Content																																																																																																				
PS	00	-	0	00	-	A01																																																																																																				
00 = None PS = Plastic Short PM = Plastic Multi-hole	00 = None 00 - 99 = Various Gland Type	* Contact the factory for custom configurations																																																																																																								
<table border="1"> <thead> <tr> <th><u>Housing Arrangement</u></th> <th><u>Available in Insert Arrangement</u></th> </tr> </thead> <tbody> <tr> <td>0 = Custom Configuration</td> <td>-</td> </tr> <tr> <td>A = AC Single Phase</td> <td>E04</td> </tr> <tr> <td>B = AC 3 Phase, 3 Wire</td> <td>E04</td> </tr> <tr> <td>C = DC 2 Circuit, 4 wire</td> <td>E04</td> </tr> <tr> <td>Q = DC 2 Circuit, 4 wire with 2 power Auxiliary Circuits</td> <td>E06</td> </tr> <tr> <td>R = DC 1 Circuit, 2 Wire</td> <td>E02</td> </tr> <tr> <td>Z = All Black</td> <td>E02, E04, E06 & E09</td> </tr> </tbody> </table>		<u>Housing Arrangement</u>	<u>Available in Insert Arrangement</u>	0 = Custom Configuration	-	A = AC Single Phase	E04	B = AC 3 Phase, 3 Wire	E04	C = DC 2 Circuit, 4 wire	E04	Q = DC 2 Circuit, 4 wire with 2 power Auxiliary Circuits	E06	R = DC 1 Circuit, 2 Wire	E02	Z = All Black	E02, E04, E06 & E09	<table border="1"> <thead> <tr> <th><u>Contact Code</u></th> <th><u>Contact</u></th> <th colspan="2"><u>Wire Size AWG (mm²)</u></th> <th><u>Available in Insert Arrangement</u></th> </tr> </thead> <tbody> <tr> <td>00 =</td> <td>Custom Configuration</td> <td colspan="2"></td> <td></td> </tr> <tr> <td>11 =</td> <td>5900</td> <td>#6</td> <td>(13.3)</td> <td>E06, E09</td> </tr> <tr> <td>12 =</td> <td>5952</td> <td>#8</td> <td>(8.4)</td> <td>E06, E09</td> </tr> <tr> <td>13 =</td> <td>5915</td> <td>#10/12</td> <td>(5.3/3.3)</td> <td>E06, E09</td> </tr> <tr> <td>20 =</td> <td>1323G2</td> <td>1/0</td> <td>(53.5)</td> <td>E04, E06</td> </tr> <tr> <td>21 =</td> <td>1323G1</td> <td>#1</td> <td>(42.4)</td> <td>E04, E06</td> </tr> <tr> <td>22 =</td> <td>1319</td> <td>#2</td> <td>(33.6)</td> <td>E04, E06</td> </tr> <tr> <td>23 =</td> <td>1319G4</td> <td>#4</td> <td>(21.2)</td> <td>E04, E06</td> </tr> <tr> <td>24 =</td> <td>1319G6</td> <td>#6</td> <td>(13.3)</td> <td>E04, E06</td> </tr> <tr> <td>80 =</td> <td>1328G2</td> <td>3/0</td> <td>(85.0)</td> <td>E02</td> </tr> <tr> <td>81 =</td> <td>1328G1</td> <td>2/0</td> <td>(67.4)</td> <td>E02</td> </tr> <tr> <td>82 =</td> <td>1382</td> <td>1/0</td> <td>(53.5)</td> <td>E02</td> </tr> <tr> <td>83 =</td> <td>1347</td> <td>#1</td> <td>(42.4)</td> <td>E02</td> </tr> <tr> <td>84 =</td> <td>1383</td> <td>#2</td> <td>(33.6)</td> <td>E02</td> </tr> <tr> <td>85 =</td> <td>1384</td> <td>#4</td> <td>(21.2)</td> <td>E02</td> </tr> <tr> <td>86 =</td> <td>1348</td> <td>#6</td> <td>(13.3)</td> <td>E02</td> </tr> </tbody> </table>				<u>Contact Code</u>	<u>Contact</u>	<u>Wire Size AWG (mm²)</u>		<u>Available in Insert Arrangement</u>	00 =	Custom Configuration				11 =	5900	#6	(13.3)	E06, E09	12 =	5952	#8	(8.4)	E06, E09	13 =	5915	#10/12	(5.3/3.3)	E06, E09	20 =	1323G2	1/0	(53.5)	E04, E06	21 =	1323G1	#1	(42.4)	E04, E06	22 =	1319	#2	(33.6)	E04, E06	23 =	1319G4	#4	(21.2)	E04, E06	24 =	1319G6	#6	(13.3)	E04, E06	80 =	1328G2	3/0	(85.0)	E02	81 =	1328G1	2/0	(67.4)	E02	82 =	1382	1/0	(53.5)	E02	83 =	1347	#1	(42.4)	E02	84 =	1383	#2	(33.6)	E02	85 =	1384	#4	(21.2)	E02	86 =	1348	#6	(13.3)	E02
<u>Housing Arrangement</u>	<u>Available in Insert Arrangement</u>																																																																																																									
0 = Custom Configuration	-																																																																																																									
A = AC Single Phase	E04																																																																																																									
B = AC 3 Phase, 3 Wire	E04																																																																																																									
C = DC 2 Circuit, 4 wire	E04																																																																																																									
Q = DC 2 Circuit, 4 wire with 2 power Auxiliary Circuits	E06																																																																																																									
R = DC 1 Circuit, 2 Wire	E02																																																																																																									
Z = All Black	E02, E04, E06 & E09																																																																																																									
<u>Contact Code</u>	<u>Contact</u>	<u>Wire Size AWG (mm²)</u>		<u>Available in Insert Arrangement</u>																																																																																																						
00 =	Custom Configuration																																																																																																									
11 =	5900	#6	(13.3)	E06, E09																																																																																																						
12 =	5952	#8	(8.4)	E06, E09																																																																																																						
13 =	5915	#10/12	(5.3/3.3)	E06, E09																																																																																																						
20 =	1323G2	1/0	(53.5)	E04, E06																																																																																																						
21 =	1323G1	#1	(42.4)	E04, E06																																																																																																						
22 =	1319	#2	(33.6)	E04, E06																																																																																																						
23 =	1319G4	#4	(21.2)	E04, E06																																																																																																						
24 =	1319G6	#6	(13.3)	E04, E06																																																																																																						
80 =	1328G2	3/0	(85.0)	E02																																																																																																						
81 =	1328G1	2/0	(67.4)	E02																																																																																																						
82 =	1382	1/0	(53.5)	E02																																																																																																						
83 =	1347	#1	(42.4)	E02																																																																																																						
84 =	1383	#2	(33.6)	E02																																																																																																						
85 =	1384	#4	(21.2)	E02																																																																																																						
86 =	1348	#6	(13.3)	E02																																																																																																						

Part Numbering Notes:

- 1) To order SPEC Pak® Kits only (no internal Powerpole® housings or contacts), use part numbering on page 4 only. **Plug Kit Example: SK6-142E04.** Powerpole® housings, contacts and wire protection may be ordered separately, see pages 7 thru 10 for information.
- 2) To order customer configured SPEC Pak® connectors (including internal Powerpole® housings and contacts) use Part Number Plan across the top of pages 4 and 5. **Customer Configured SPEC Pak® Plug Connector Example: SK6-142E04PS01-A23.**
- 3) To order a custom configuration which is not listed on page 7 thru 10 contact the factory.

* Custom configuration may not be UL Recognized.

Wire Protection - PG Gland

SPECIFICATIONS

Material	
Shell	Nylon PA 66 (UL94 V-2)
Gasket	EPDM
Color	Black



Mechanical	
Operating Temp	-40°C to 105°C (-40°F to 221°F)
IP Rating	IP68
UV Rating	Equivalent to UL746C F1
Thread Type	PG

Torque Requirements	
Cable Gland Body to Plug Housing	
- Hand tighten until snug, tighten additional 1/8 - 1/4 turn with wrench	
Sealing Nut to Cable	
- Hand tighten until snug, tighten additional 1/2 - 3/4 turn with wrench	

* Contact factory for UL94 V-0 material

NOTE: Only UL listed cable glands are UL recognized components when used with SPEC Pak® connector(s).

STRAIGHT PLASTIC SHORT THREAD TYPE - STD PACK 10 / UL LISTED

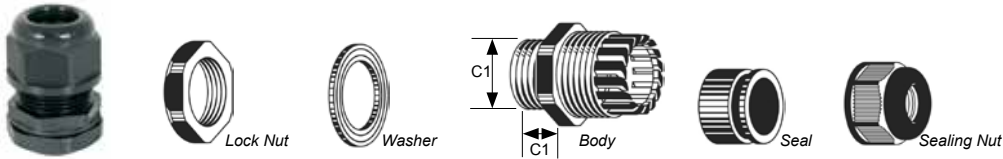

Number of Holes	Cable Range Wire Outer Dia. mm (in)	Thread O.D. C1 mm (in)	Panel Mounting Hole mm (in)	Thread Length C2 mm (in)	Wrench Size Lock Nut mm	Wrench Size Sealing Nut mm	Wire Protection Designation (4 Characters)	--- Part Numbers ---
							 10
Minimum Order Quantity								
1	19.5 - 16.0 (0.77 - 0.63)	54 (2.13)	54 - 54.4 (2.13 - 2.14)	15.5 (0.61)	64	62	PS01	PL1P42-19X
1	32.0 - 26.0 (1.26 - 0.79)	54 (2.13)	54 - 54.4 (2.13 - 2.14)	15.5 (0.61)	64	62	PS02	PS1P42-32X

STRAIGHT PLASTIC MULTI-HOLE TYPE - STD PACK 10 / UL LISTED

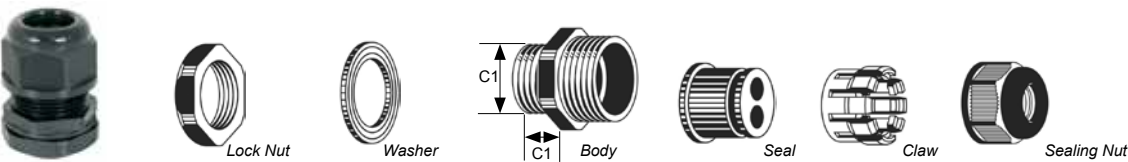

Number of Holes	Cable Range Wire Outer Dia. mm (in)	Thread O.D. C1 mm (in)	Panel Mounting Hole mm (in)	Thread Length C2 mm (in)	Wrench Size Lock Nut mm	Wrench Size Sealing Nut mm	Wire Protection Designation (4 Characters)	--- Part Numbers ---
							 10
Minimum Order Quantity								
4	10.5 - 8.5 (0.41 - 0.33)	54 (2.13)	54 - 54.4 (2.13 - 2.14)	15.5 (0.61)	64	62	PM46	PL4P42-10X
6	7.0 - 5.0 (0.28 - 0.20)	54 (2.13)	54 - 54.4 (2.13 - 2.14)	15.5 (0.61)	64	62	PM66	PL6P42-7X
8	7.0 - 5.7 (0.28 - 0.22)	54 (2.13)	54 - 54.4 (2.13 - 2.14)	15.5 (0.61)	64	62	PM66	PL8P42-7X

NOTE: Custom PG Glands may be available. Contact customer service for more information.

E02 Insert Arrangement

Configured with up to 2 PP180 Contacts (up to 310 amps)
Standard & Custom Configuration Options

| HOUSING ARRANGEMENT |

0 Custom Configuration *

DC 1 Circuit, 2 Wire

R 1381G1 1381G3

All Black

Z 1381G1 1381G1

NOTE:
(1) For agency approval, contact factory.
* For custom configurations contact the factory.

| TEMPERATURE CHART |

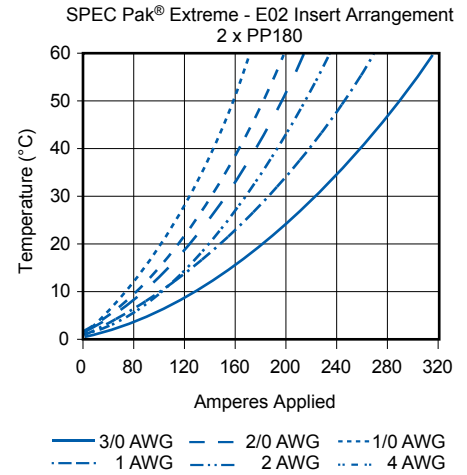

Ordering Information

| POWERPOLE® CONTACTS & HOUSINGS FOR E02 INSERT ARRANGEMENTS |

PP180 Contacts

AWG	mm ²	Mating Force	Loose Piece Part Numbers				Contact Code Designation
3/0	85	Low	-	-	1328G2-BK	1328G2	80
2/0	67.4	Low	-	1328G1-BK	-	1328G1	81
1/0	53.5	High	1382-BK	-	-	1382	82
1	42.4	High	1347-BK	-	-	1347	83
2	33.6	High	1383-BK	-	-	1383	84
4	21.1	High	1384-BK	-	-	1384	85
6	13.3	High	1348-BK	-	-	1348	86

PP180 Housings

Description	Part Numbers	
Minimum Quantity	250	50
Red	1381G3-BK	1381G3
Green	1381G4-BK	1381G4
Black	1381G1-BK	1381G1
White	1381G2-BK	1381G2
Blue	1381-BK	1381

NOTE:
(1) See Powerpole® & Multipole Power Connectors Catalog for additional contacts and/or housings options.
(2) Application tooling information is available on page 11.



**E02 Powerpole®
Insert Holder**

E04 Insert Arrangement

Configured with up to 4 PP120 Contacts (up to 200 amps)
Standard & Custom Configuration Options

| HOUSING ARRANGEMENT |

0 Custom Configuration *

AC Single Phase

A	1321G1	1321G2
	1321G4	E

AC 3 Phase, 3 Wire

B	1321G1	1321G2
	1321G3	1321G4

DC 2 Circuit, 4 Wire

C	1321G1	1321G1
	1321G3	1321G3

All Black

Z	1321G1	1321G1
	1321G1	1321G1

NOTE:
(1) E = Empty
(2) For agency approval, contact factory.
* For custom configurations contact the factory.

| TEMPERATURE CHART |

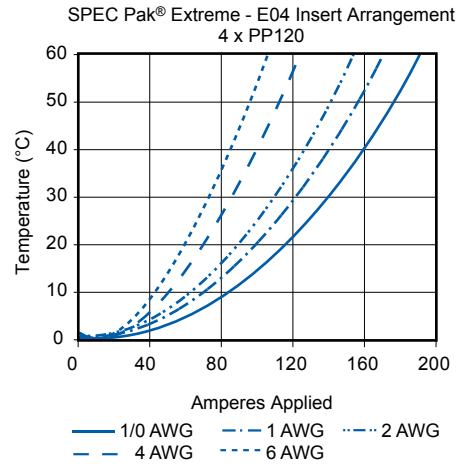

Ordering Information

| POWERPOLE® CONTACTS & HOUSINGS FOR E04 & E06 INSERT ARRANGEMENTS |

PP120 Contacts

AWG	mm ²	Mating Force	Loose Piece Part Numbers			Contact Code Designation
Minimum Quantity			600	500	50	
1/0	53.5	Low	1323G2-BK	-	1323G2	20
1	42.4	Low	1323G1-BK	-	1323G1	21
2	33.6	High	-	1319-BK	1319	22
4	21.1	High	-	1319G4-BK	1319G4	23
6	13.3	High	-	1319G6-BK	1319G6	24

PP120 Housings

Description	Part Numbers	
Minimum Quantity	500	50
Red	1321G3-BK	1321G3
Green	1321G4-BK	1321G4
Black	1321G1-BK	1321G1
White	1321G2-BK	1321G2
Blue	1321-BK	1321

PP75 Contacts

AWG	mm ²	Mating Force	Loose Piece Part Numbers		Contact Code Designation
Minimum Quantity			1,000	100	
6	13.3	High	5900-BK	5900	11
8	8.4	High	5952-BK	5952	12
12 to 10	3.3 to 5.3	High	5915-BK	5915	13

PP75 Housings

Description	Part Numbers	
Minimum Quantity	1,000	100
Red	5916G7-BK	5916G7
Green	5916G6-BK	5916G6
Black	5916G4-BK	5916G4
White	5916G5-BK	5916G5
Blue	5916-BK	5916

NOTE:
(1) See Powerpole® & Multipole Power Connectors Catalog for additional contacts and/or housings options.
(2) Application tooling information is available on page 11.
(3) PP15/45 housing adapter (custom configuration) information is available on page 9.



E04 Powerpole®
Insert Holder



E06 Powerpole®
Insert Holder

E06 Insert Arrangement

Configured with up to 4 PP120 & 2 PP75 Contacts (up to 200 amps)
Standard & Custom Configuration Options

| HOUSING ARRANGEMENT |

0 Custom Configuration *

DC 2 Circuit, 4 Wire With
2 Power Auxiliary Circuits

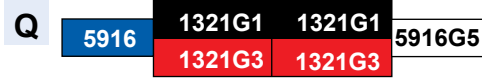

All Black

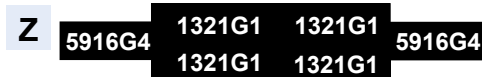

NOTE:

(1) For agency approval, contact factory.

* For custom configurations, use APP® custom part number configurator at www.andersonpower.com or contact the factory.

E06 Standard Powerpole® Contacts and Housings Options are Available on Page 8.

| TEMPERATURE CHART |

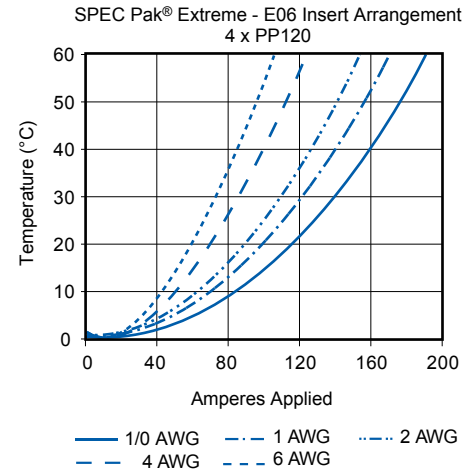

Ordering Information

| POWERPOLE® CONTACTS & HOUSINGS FOR PP15/45 HOUSING ADAPTER FOR E04 & E06 INSERT ARRANGEMENTS |

PP15/45 Contacts

Barrel	AWG	mm ²	Mating Force	Loose Piece ----- Part Numbers -----	Reeled
Minimum Quantity				200	5,000 ...
Open	14 to 10 K	2.1 to 5.3	Low	261G2-LPBK	261G2
Open	14 to 10 SF	2.1 to 6.0	Low	200G1L-LPBK	200G1L
Open	16 to 12	1.3 to 3.3	Low	261G1-LPBK	261G1
Open	20 to 16	0.52 to 1.3	Low	262G1-LPBK	262G1
Closed	16 to 12	1.3 to 3.3	Low	1331	1331-BK
Closed	20 to 16	0.52 to 1.3	Low	1332	1332-BK
Open, Tin	14 to 10	2.1 to 6.0	Low	1830G1-LPBK	1830G1
Open, Silver	14 to 10	2.1 to 6.0	Low	1830G2-LPBK	1830G2

PP15/45 Housings

Description	----- Part Numbers -----	
Minimum Quantity ...	2,500	200 ...
PP 15/45 Finger Proof		
Red	1327FP-BK	1327FP
Green	1327G5FP-BK	1327G5FP
Black	1327G6FP-BK	1327G6FP
White	1327G7FP-BK	1327G7FP
Blue	1327G8FP-BK	1327G8FP
Yellow	1327G16FP-BK	1327G16FP
PP 15/45 Ground		
Green	1827G1-BK	1827G1

NOTE:

- (1) See Powerpole® & Multipole Power Connectors Catalog for additional contacts and/or housings options.
- (2) Application tooling information is available on page 11.
- (3) Housing adapter (p/n 2400G1) can be used in place of PP120 housing and contact.

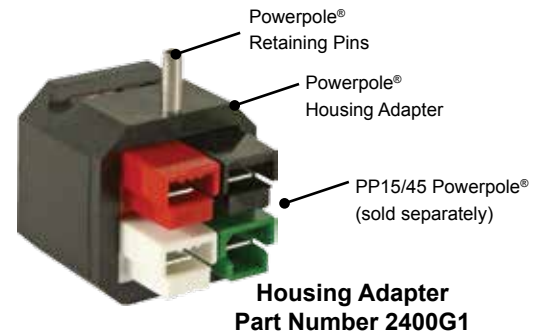

E09 Insert Arrangement

Configured with up to 9 PP75 Contacts (up to 75 amps)

| HOUSING ARRANGEMENT |

0 Custom Configuration *

All Black

Z

5916G4	5916G4
5916G4	5916G4
5916G4	5916G4

* For custom configurations contact the factory.

| TEMPERATURE CHART |

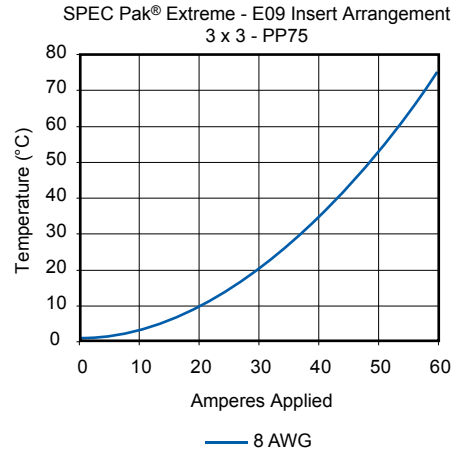

Ordering Information

| POWERPOLE® CONTACTS & HOUSINGS FOR E09 INSERT ARRANGEMENTS |

Contacts

AWG	mm ²	Mating Force	Loose Piece		Dimensions - A -		Contact Code Designation
			-- Part Numbers --		inches	mm	
Minimum Quantity			1,000	100		
6	13.3	High	5900-BK	5900	0.22	5.59	11
8	8.4	High	5952-BK	5952	0.19	4.83	12
12 to 10	3.3 to 5.3	High	5915-BK	5915	0.14	3.56	13

Contact Housings

Description	----- Part Numbers -----	
Minimum Quantity ...	1,000	100
Red	5916G7-BK	5916G7
Green	5916G6-BK	5916G6
Black	5916G4-BK	5916G4
White	5916G5-BK	5916G5
Blue	5916-BK	5916



**E09 Powerpole®
Insert Holder**

NOTE:

- (1) See Powerpole® & Multipole Power Connectors Catalog for additional contacts and/or housings options.
- (2) Application tooling information is available on page 11.

PP75 Spacer & Keying Accessory

Description	----- Part Numbers -----	
Minimum Quantity...	1000	100
Red, Short	1399G23-BK	1399G23
Red, Long	1399G21-BK	1399G21

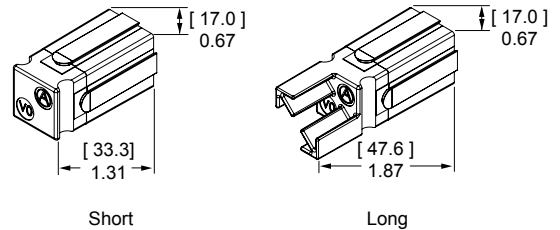

Tooling Chart

Wire Size		Loose Piece Part Numbers		Loose Piece Contact Crimp Tool					Reeled Part Numbers		Reeled Contact Crimp Tools			
AWG	mm²	Tin Plating	Silver Plating	Hand Tool or	Pneumatic Bench Tool	+ Die	+ Locator	Number of Crimps	Tin Plating	Silver Plating	ATS Applicator	ATS Press	Air Feed Kit*	
PP15 / 45 Flat Wiping Power & Ground														
16 / 20	1.3 / 0.52	N/A	1332	1309G2 or 1309G8	1367G1				N/A	N/A	N/A	N/A	N/A	
12 / 16	3.3 / 1.3	N/A	1331						N/A	N/A	N/A	Single	262G1	262G2
16 / 20	1.3 / 0.52	262G1-LPBK	262G2-LPBK	1309G3 or 1309G8	N/A	N/A	N/A	Single	200G2L	200G4L	TBD			
16 / 20	1.5 / 0.52	200G2L-LPBK	200G4L-LPBK						269G2	N/A	1385519-1			
16 / 20	1.3 / 0.52	269G2-LPBK	N/A	1309G6 or 1309G8	N/A	N/A	N/A	Single	261G1	261G4	1385520-1			
12 / 16	3.3 / 1.3	261G1-LPBK	261G4-LPBK						261G2	261G3	1385458-1			
10 / 14	5.3 / 2.1	261G2-LPBK	261G3-LPBK	1309G3 or 1309G8	N/A	N/A	N/A	Single	269G1	N/A	1385520-1			
12 / 16	3.3 / 1.3	269G1-LPBK	N/A						269G3	N/A	1385458-1			
10 / 14	5.3 / 2.1	269G3-LPBK	N/A	1309G6 or 1309G8	N/A	N/A	N/A	Single	200G1L	200G3L	1385460-1			
10 / 14	6.0 / 2.1	200G1L-LPBK	200G3L-LPBK						201G1H	201G3H	1385460-1			
10 / 14	6.0 / 2.1	201G1H-LPBK	201G3H-LPBK	1309G6 or 1309G8	N/A	N/A	N/A	Single	1830G1	1830G2	1385460-1			
10 / 14	6.0 / 2.1	1830G1-LPBK	1830G2-LPBK											
PP75														
#6	13.3	N/A	1307	1309G4	1387G1	1388G6	1389G6	Single	265G5	N/A	1385523-1	2-565435-2	692655-1	
#8	8.4		5952											
#10 / 12	5.3 / 3.3		5953											
			5915											
PP120														
1/0	53.5	N/A	1323G2	1368	1387G1	1388G3	1389G4	Single	N/A	N/A	N/A	N/A	N/A	
#1	42.4		1323G1											
#2	33.6		1319											
#4	21.2		1319G4											
#6	13.3		1319G6											
PP180														
3/0	85	N/A	1328G2	1368	1387G1	1303G12	1304G32	Double	N/A	N/A	N/A	N/A	N/A	
2/0	53.5		1328G1											1303G13
1/0	53.5		1382											
#1	42.4		1347			1387G1	1388G3	1389G3						Single
#2	33.6		1383			1387G2	1303G13	1304G32						Double
#4	21.1		1384			1387G1	1388G3	1389G3						Single
						1387G2	1303G13	1304G32						Double
#6	13.3		1348			1387G1	1388G4	1389G3						Single

* All ATS applicators for APP® contacts are air feed style, (except 1385870) and require the press to have an air feed kit installed.
NOTE: See website for the most current information.

DIMENSIONS

| PLUG |

Top View

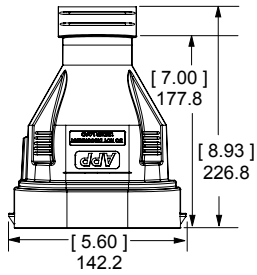

Side View

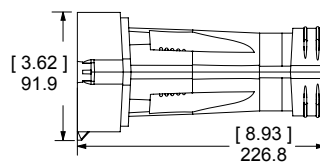

Mated Side View with Receptacle

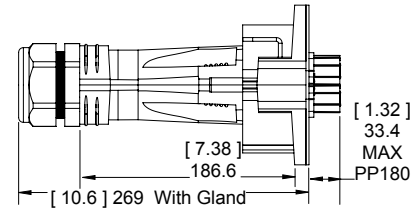

Front View - E02

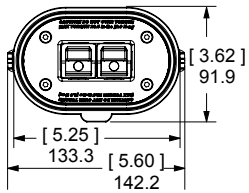

Front View - E04

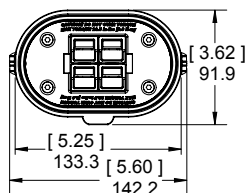

Front View - E06

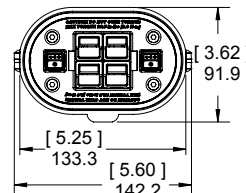

Front View - E09

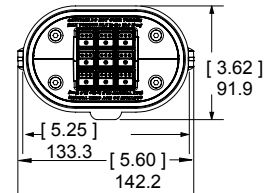

| RECEPTACLE |

Top View

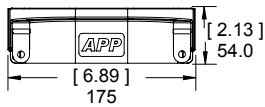

Side View

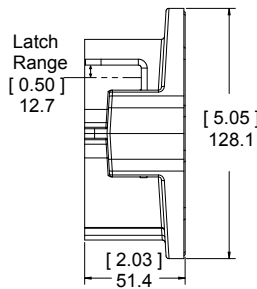

Panel Cut Out

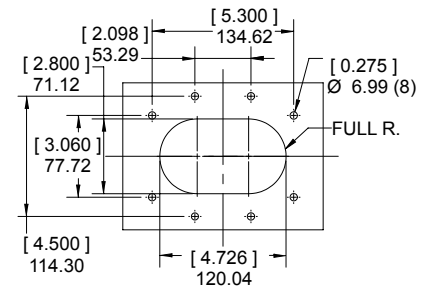

Front View - E02

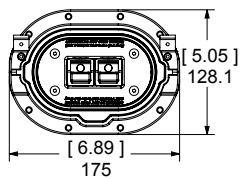

Front View - E04

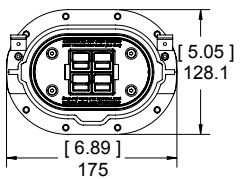

Front View - E06

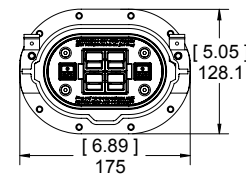

Front View - E09

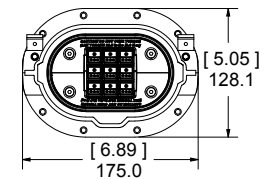

| PLUG COVER KIT |

Front View

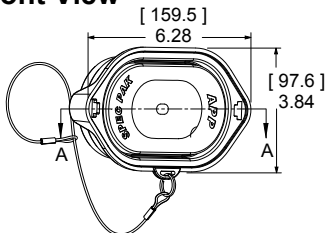

Side View

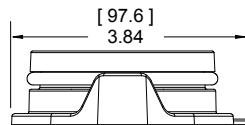

| RECEPTACLE COVER KIT |

Front View

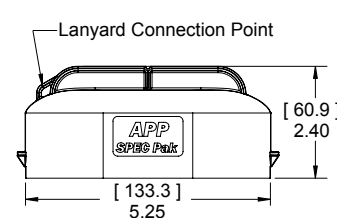

Side View

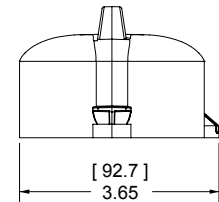

All Data Subject To Change Without Notice "SPEC Pak, APP and Anderson Power Products are registered trademarks of Anderson Power Products"

15426 DS-EXSPA REV 03

HEADQUARTERS: Anderson Power Products®, 13 Pratts Junction Road, Sterling, MA 01564-2305 USA T:978-422-3600 F:978-422-0128

EUROPE: Anderson Power Products® Ltd., Unit 3, Europa Court, Europa Boulevard, Westbrook, Warrington, Cheshire, WA5 7TN United Kingdom T: +44 (0) 1925 428390 F: +44 (0) 1925 520203

ASIA / PACIFIC: IDEAL Anderson Asia Pacific Ltd., Unit 922-928 Topsail Plaza, 11 On Sum Street, Shatin N.T., Hong Kong T: +(852) 2636 0836 F: +(852) 2635 9036

CHINA: IDEAL Anderson Technologies (Shenzhen) Ltd., Block A8 Tantun Western Industrial Park, Songgang Baoan District, Shenzhen, P.R. China 518105 T: +(86) 755 2768 2118 F: +(86) 755 2768 2218

TAIWAN: IDEAL Anderson Asia Pacific Ltd., Taiwan Branch, 4F.-2, No.116, Dadun 20th St., Situn District, Taichung City 407, Taiwan (R.O.C.) T: +(886) 4 2310 6451 F: +(886) 4 2310 6460

www.andersonpower.com

Mouser Electronics

Authorized Distributor

Click to View Pricing, Inventory, Delivery & Lifecycle Information:

[Anderson Power Products:](#)

[120BBS-BK](#)