

RECOMMENDED MOUNTING HOLE PATTERN FOR 1.57 [.062] THICK P.C. BOARD

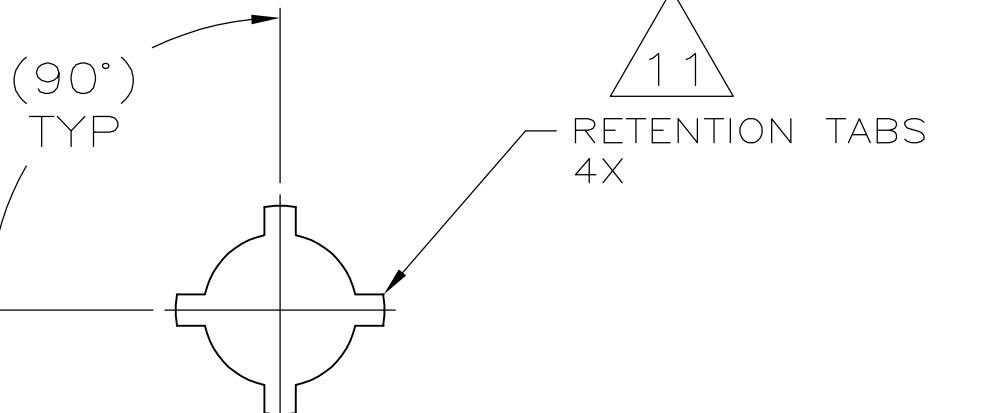
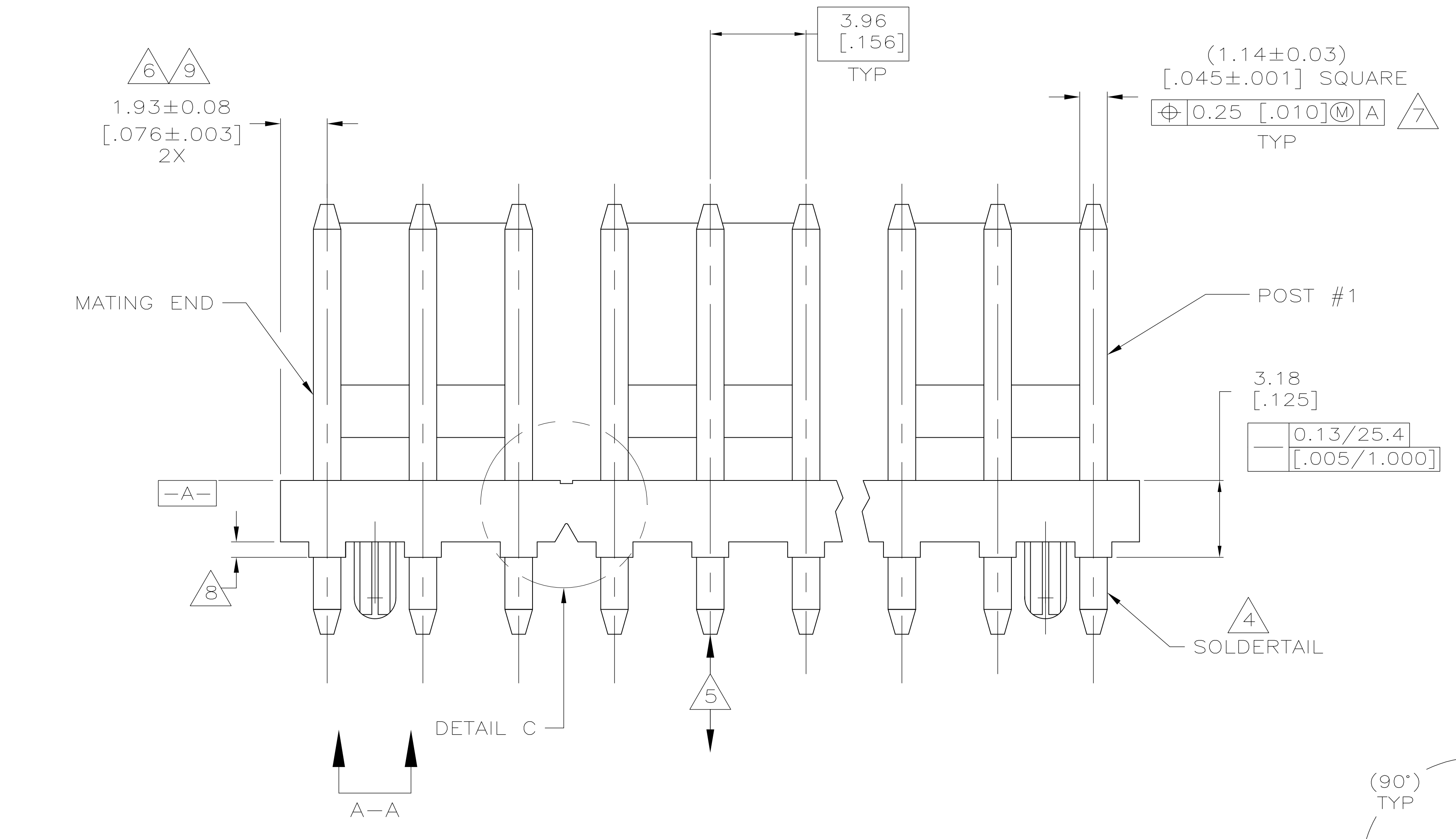
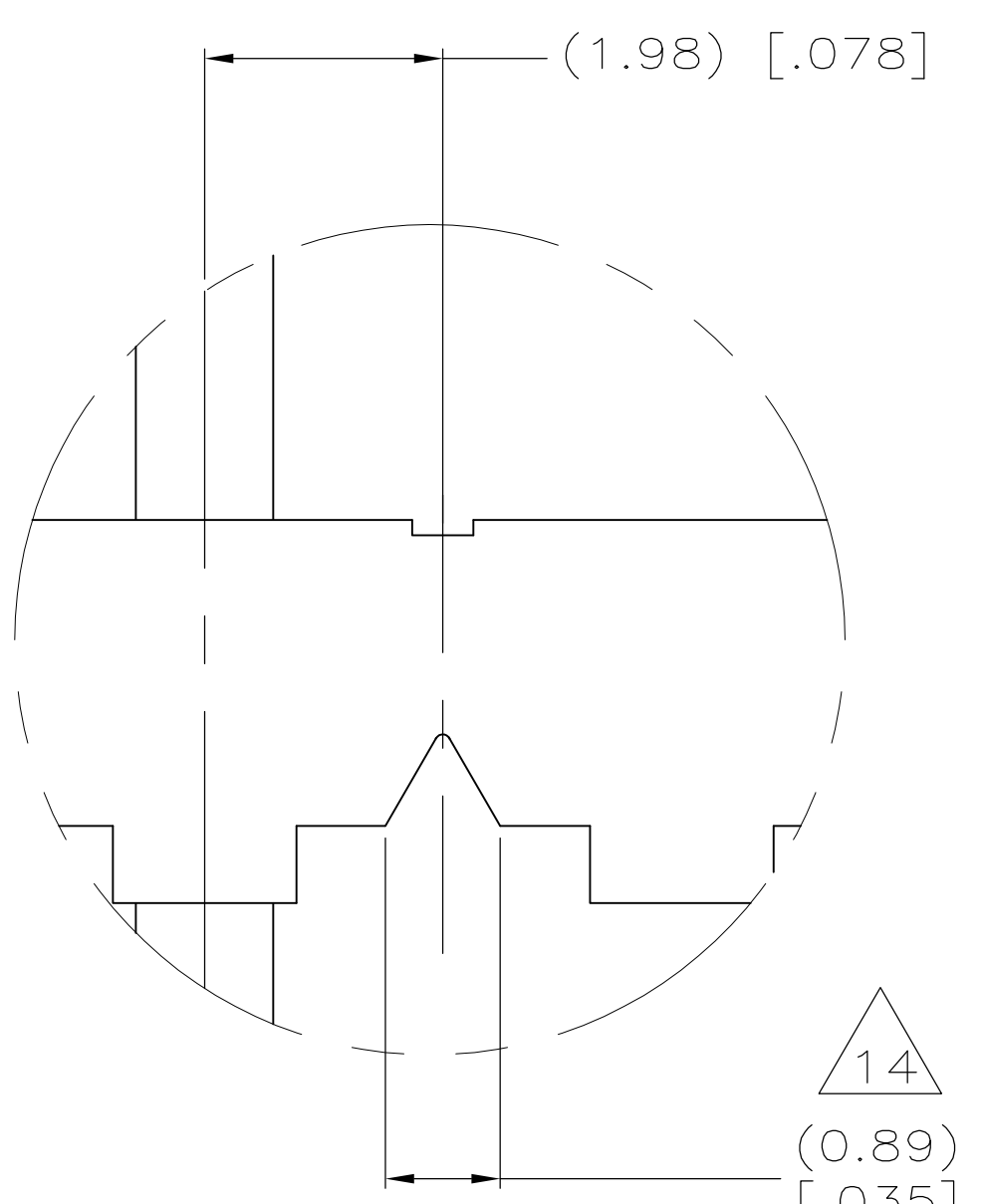

VIEW A-A
SCALE 16:1

- 1 MATERIAL HOUSING: THERMOPLASTIC POLYESTER, GLASS FILLED, UL94V-0 POST: COPPER ALLOY
- 2 FINISH HOUSING: NATURAL POST: SEE NOTES 12, 13 & 17 FOR PLATING.
- 3 UL MARKING MAY NOT APPEAR ON THE 2 OR 3 POSITION SIZES. CSA MARKING MAY NOT APPEAR ON THE 2 POSITION SIZE.
- 4 POST SOLDERTAILS COMPLY WITH TYCO SOLDERABILITY SPECIFICATION 109-11-12.
- 5 POST WITHSTANDS 13.34 NEWTONS (3 LBS) MINIMUM AXIAL FORCE IN EITHER DIRECTION WITHOUT DISLODGING.
- 6 APPLIES AT **-A-**
- 7 APPLIES WHEN THE HEADER IS STRAIGHT.
- 8 PLASTIC PROJECTIONS PERMITTED IN THIS ZONE.
- 9 COORDINATE DIMENSIONS APPLIES FROM CENTER OF THE ACTUAL FEATURE.
- 10 SOLDER SIDE OF BOARD IS SHOWN.
- 11 THE RETENTION TABS PROVIDE A ONE-TIME INTERFERENCE FIT IN THE 1.63 [.064] DIAMETER BOARD HOLES FOR HEADER ASSEMBLY RETENTION DURING SOLDERING. FOUR TABS PER PEG, TWO PEGS PER HEADER ASSEMBLY (ONE PEG ONLY FOR 2 POSITION SIZE).
- 12 PLATING: GOLD PLATE AREA, 0.00076 [.000030] GOLD OR 0.00008 [.000003] MIN GOLD FLASH OVER 0.00068 [.000027] PALLADIUM NICKEL, PER TE CONNECTIVITY'S DISCRETION, ALL SIDES, OVER NICKEL UNDERPLATE, 0.00127 [.000050] MIN, ALL SIDES AND ENTIRE LENGTH OF POST.
- 13 PLATING: BRIGHT TIN-LEAD (93/7) PLATE AREA, 0.00381-0.00889 [.000150-.000350] THICK, ALL FOUR SIDES, OVER, 3.18 [.125] MINIMUM.
- 14 DIMENSIONS IN BRACKETS ARE IN INCHES.
- 15 ALL POSITION SIZES HAVE THE BACK WALL NOTCHED ON BOTH ENDS AS SHOWN. THE 2 THRU 5 POSITION SIZES HAVE SOLID BACK WALLS. POSITION SIZES 6 AND ABOVE HAVE AN INTERRUPTED BACK WALLS AT VARIOUS LOCATIONS (SEE TABLE FOR INTERRUPTION(S) LOCATIONS).
- 16 EDGE OF POLARIZING LOCK WALL TO BE IN LINE WITH CENTERLINE OF ADJACENT POST WITHIN ± 0.13 [.005].
- 17 PLATING: MATTE TIN PLATE AREA, 0.00381-0.00889 [.000150-.000350] THICK, ALL FOUR SIDES, OVER, 3.18 [.125] MINIMUM.

4&5	7&8	11&12	14&15	71.20 [2.803]	18		4-644631-8
4&5	7&8	10&11	13&14	67.23 [2.647]	17		4-644631-7
4&5	8&9	12&13		63.27 [2.491]	16		4-644631-6
4&5	8&9	11&12		59.31 [2.335]	15		4-644631-5
4&5	7&8	10&11		55.35 [2.179]	14		4-644631-4
4&5	7&8	10&11		51.38 [2.023]	13		4-644631-3
4&5	8&9			47.42 [1.867]	12		4-644631-2
4&5	7&8			43.46 [1.711]	11		4-644631-1
3&4	7&8			39.50 [1.555]	10		4-644631-0
3&4	6&7			35.53 [1.399]	9		3-644631-9
4&5				31.57 [1.243]	8		3-644631-8
4&5				27.61 [1.087]	7		3-644631-7
3&4				23.65 [.931]	6		3-644631-6
				NONE	5		3-644631-5
				NONE	4		3-644631-4
				NONE	3		3-644631-3
				NONE	2		3-644631-2

4&5	7&8	11&12	14&15	71.20 [2.803]	18		1-644631-8
4&5	7&8	10&11	13&14	67.23 [2.647]	17		1-644631-7
4&5	8&9	12&13		63.27 [2.491]	16		1-644631-6
4&5	8&9	11&12		59.31 [2.335]	15		1-644631-5
4&5	7&8	10&11		55.35 [2.179]	14		1-644631-4
4&5	7&8	10&11		51.38 [2.023]	13		1-644631-3
4&5	8&9			47.42 [1.867]	12		1-644631-2
4&5	7&8			43.46 [1.711]	11		1-644631-1
3&4	7&8			39.50 [1.555]	10		1-644631-0
4&5				35.53 [1.399]	9		644631-9
4&5				31.57 [1.243]	8		644631-8
4&5				27.61 [1.087]	7		644631-7
3&4				23.65 [.931]	6		644631-6
				NONE	5		644631-5
				NONE	4		644631-4
				NONE	3		644631-3
				NONE	2		644631-2

BACK WALL INTERRUPTIONS BETWEEN POSTS	(L)	NO. OF POSN	ASSEMBLY
---------------------------------------	-----	-------------	----------

OBSOLETE PARTS: OBSOLETE CIS STREAMLINING PER D.RENAUD/D.SINISI
 OBSOLETE PART NUMBERS

THIS DRAWING IS A CONTROLLED DOCUMENT. DATE: 25-FEB-2009
 DESIGNED BY: J. BOSSI DATE: 25-FEB-2009
 DRAWN BY: J. BOSSI DATE: 25-FEB-2009
 CHECKED BY: J. BOSSI DATE: 25-FEB-2009
 APPROVED BY: J. BOSSI DATE: 25-FEB-2009
 PRODUCT SPEC: MTA-156 HEADER ASSEMBLY, STRAIGHT, STRAIGHT .045 SQUARE POST, .000030 GOLD PLATED, WITH RETENTION PEGS
 APPLICATION SPEC: 109-1051
 DRAWING NO: 114-1020
 WEIGHT: 0.00779g
 CUSTOMER DRAWING: G44631
 SCALE: N/A
 SHEET: 1 OF 1
 REV: F2

Mouser Electronics

Authorized Distributor

Click to View Pricing, Inventory, Delivery & Lifecycle Information:

[TE Connectivity:](#)

[4-644631-3](#)