

1

2

3

4

5

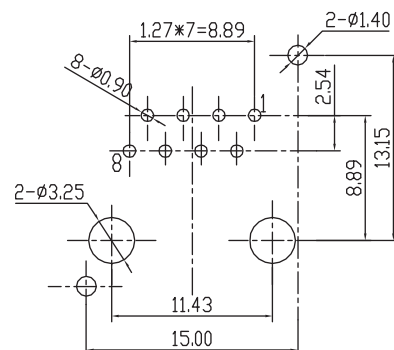

PCB LAYOUT - COMPONENT VIEW

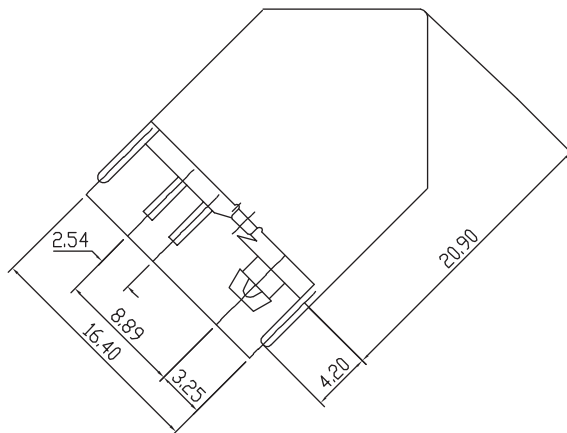
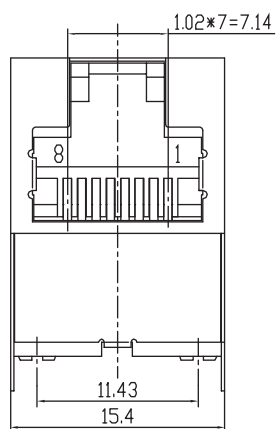

TECHNICAL CHARACTERISTICS

MATERIAL
 INSULATOR MATERIAL: PBT
 FLAMMABILITY RATING: UL94-V0
 COLOR: WHITE
 CONTACT MATERIAL: COPPER ALLOY
 CONTACT TYPE: STAMPED
 CONTACT PLATING: GOLD
 SHIELDING: BRONZE NI PLATED
 QUALITY CLASS: 500 MATING CYCLES

ENVIRONMENTAL
 OPERATING TEMPERATURE: -40 °C UP TO 85 °C
 COMPLIANCE: LEAD FREE AND ROHS

ELECTRICAL
 CURRENT RATING: 1.5 A
 WORKING VOLTAGE: 125 VAC
 INSULATION RESISTANCE: >500 MΩ
 DIELECTRIC WITHSTANDING VOLTAGE: 1 000 VAC/MIN
 CONTACT RESISTANCE: 20 mΩ MAX

STANDARD
 CERTIFIED: E324776

SOLDERING
 JEDEC LEAD FREE WAVE SODLERING PROCESS

PACKAGING
 TRAY

RoHS Compliant

G				PROJECTION: 	GENERAL TOLERANCE .X = +/- 0.2 .XX = +/- 0.15		DESCRIPTION: 45° ENTRY SHIELDED 8P8C MODULAR JACK REVERSE MATAL POST TAIL	SIZE A4
F								
E	03-APR-14	DRAWING UPDATE	QL					
D	03-JAN-14	UL & TEMP UPDATE	QL					
C	07-JUL-10	NEW MEASURES	GG	APPROVAL: RJ	UNIT: MM	WERI PART NO: 615 008 145 121		
B	08-OCT-09	NEW DRAW	JP		SCALE:			
A	23-FEB-09	PDF	JP		SHEET: 1/1			
REV	DATE	FILE	BY		DRAW:			

Mouser Electronics

Authorized Distributor

Click to View Pricing, Inventory, Delivery & Lifecycle Information:

[Wurth Electronics:](#)

[615008145121](#)