

- NOTE:
- MATERIAL: POST: BRASS TIN-PLATED  
HOUSING: NYLON 66 UL 94V-0
  - WHEN EXTRACTING RECEPTACLE HOUSING FROM HEADER, NOT WIRE BUT RECEPTACLE HOUSING SHOULD BE GRIPED IN ORDER TO AVOID THE WIRE BREAKAGE.

**3** OBSOLETE PARTS: OBSOLETE CIS STREAMLINING PER D.RENAUD/D.SINISI

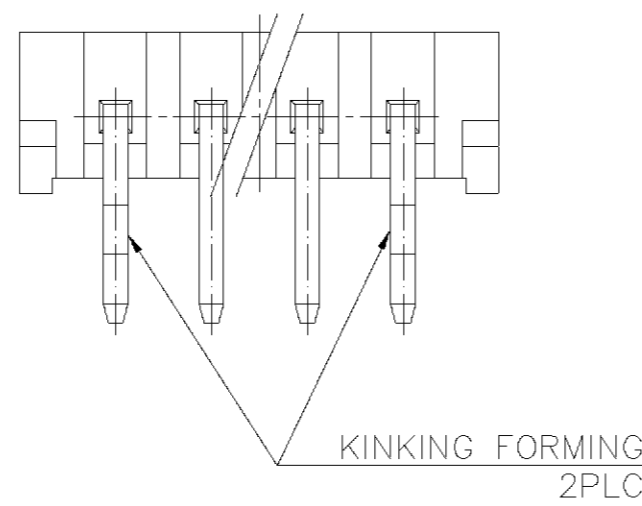
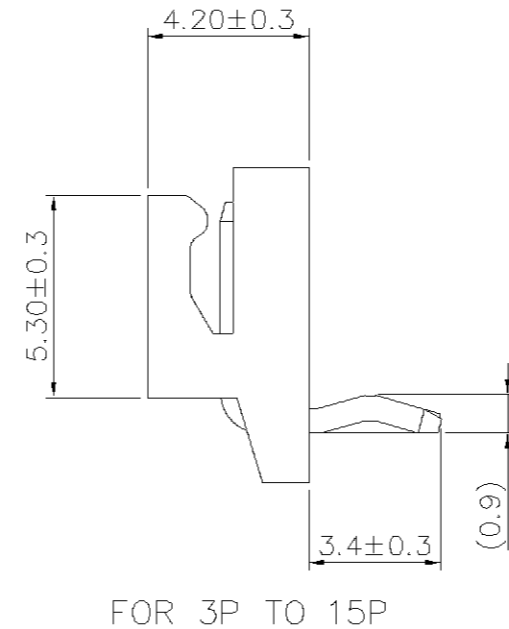
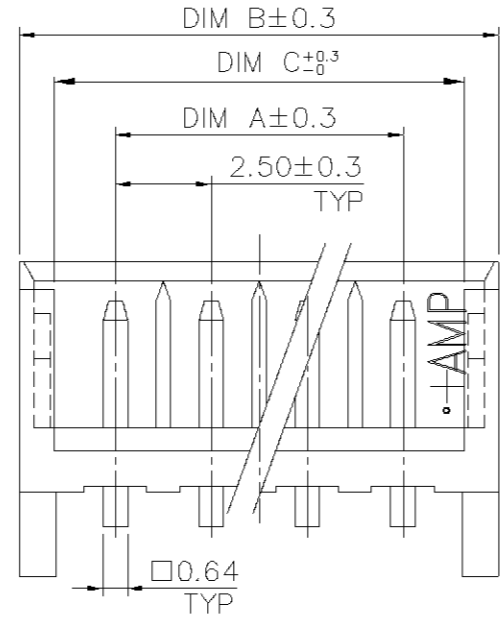
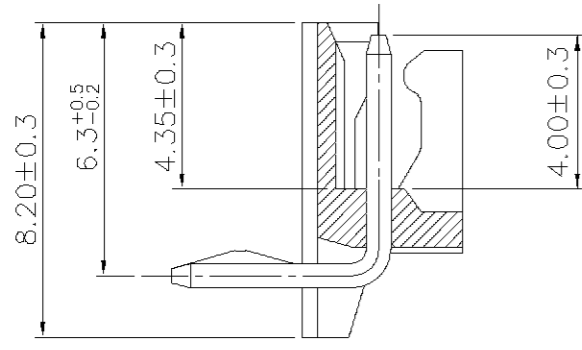

| <b>3</b> OBSOLETE | DIM C | DIM B | DIM A | CIRCUITS | PATR NO.   |
|-------------------|-------|-------|-------|----------|------------|
|                   | 38.2  | 40.0  | 35.00 | 15P      | 1-440053-5 |
|                   | 35.7  | 37.5  | 32.50 | 14P      | 1-440053-4 |
|                   | 33.2  | 35.0  | 30.00 | 13P      | 1-440053-3 |
|                   | 30.7  | 32.5  | 27.50 | 12P      | 1-440053-2 |
|                   | 28.2  | 30.0  | 25.00 | 11P      | 1-440053-1 |
|                   | 25.7  | 27.5  | 22.50 | 10P      | 1-440053-0 |
|                   | 23.2  | 25.0  | 20.00 | 9P       | 440053-9   |
|                   | 20.7  | 22.5  | 17.50 | 8P       | 440053-8   |
|                   | 18.2  | 20.0  | 15.00 | 7P       | 440053-7   |
|                   | 15.7  | 17.5  | 12.50 | 6P       | 440053-6   |
|                   | 13.2  | 15.0  | 10.00 | 5P       | 440053-5   |
|                   | 10.7  | 12.5  | 7.50  | 4P       | 440053-4   |
|                   | 8.2   | 10.0  | 5.00  | 3P       | 440053-3   |
|                   | 5.7   | 7.5   | 2.50  | 2P       | 440053-2   |

|   |  |   |  |  |
|---|--|---|--|--|
| DIMENSION :<br>0 PLC $\pm$<br>1 PLC $\pm$<br>2 PLC $\pm$<br>3 PLC $\pm$<br>ANGLES $\pm$ |  | DR. A. WU<br>31-JAN-2001<br>CHK. J. CHENG<br>31-JAN-2001<br>APP. J. WU<br>31-JAN-2001 | <b>TE</b> TE Connectivity<br>NAME<br>2.5 MM PITCH HPI<br>RIGHT-ANGLE POST HEADERS. |  |
| MATERIAL<br>SEE NOTE  |  | PRODUCT SPEC<br>108-57099   | LOC DW A <sub>3</sub><br>SIZE A <sub>3</sub><br>DRAWING NO C-440053<br>REV A2      |  |
| FINISH<br>SEE NOTE  |  | APPLICATION SPEC<br>WEIGHT  | SCALE --<br>SHEET 1 OF 1   |  |

|     |                 |                              |                     |
|-----|-----------------|------------------------------|---------------------|
| A2  |                 | REVISED PER<br>ECO-11-005301 | RK<br>HMR<br>6APR11 |
| LTR | REVISION RECORD | ECO                          | DR/CHK DATE         |

# Mouser Electronics

Authorized Distributor

Click to View Pricing, Inventory, Delivery & Lifecycle Information:

[TE Connectivity:](#)

[440053-5](#)