

LOC	DIST	REVISIONS					
CM	52	P	LTR	DESCRIPTION	DATE	DWN	APVD
			Z1	REVISED PER ECO-11-004917	11MAR11	RK	HMR

- 1

0.00076 MIN SELECTIVE GOLD PLATING ON INSIDE OF RECEPTACLE OVER NICKEL OVER ALL UNDERPLATE.
2. WIRE RANGE: 0.12 – 0.4 MM<sup>2</sup> (26 – 22 AWG)
3. INSULATION RANGE: 0.89 – 1.65

POINT OF MEASUREMENT  
1 90° FROM SEAM

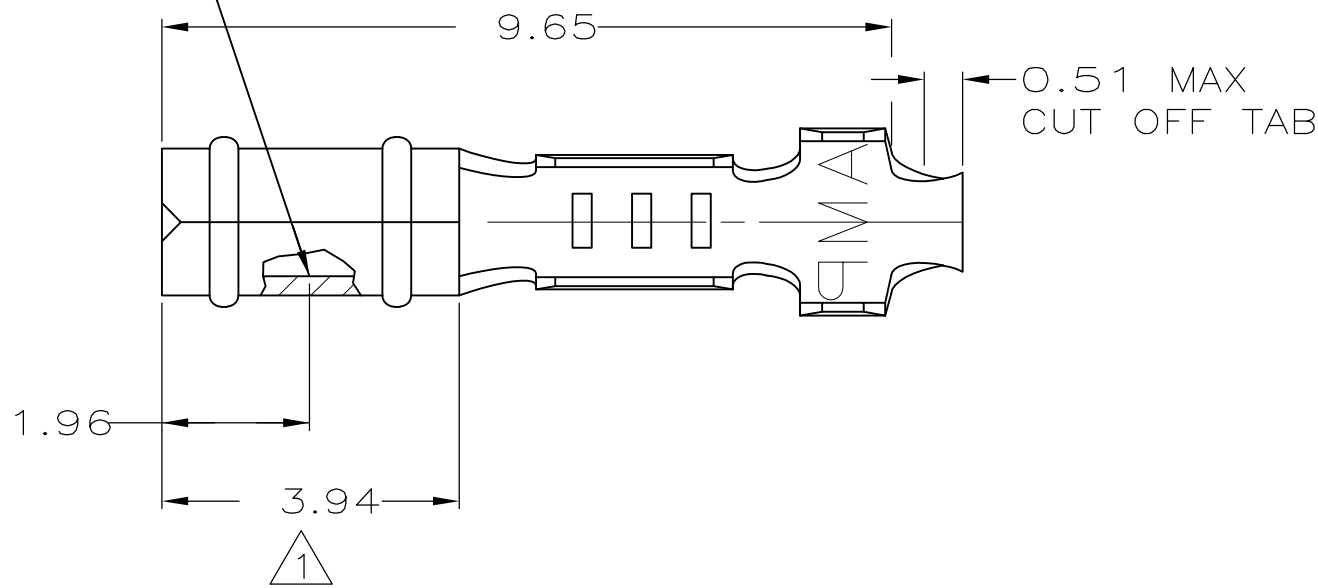

SECTION A-A

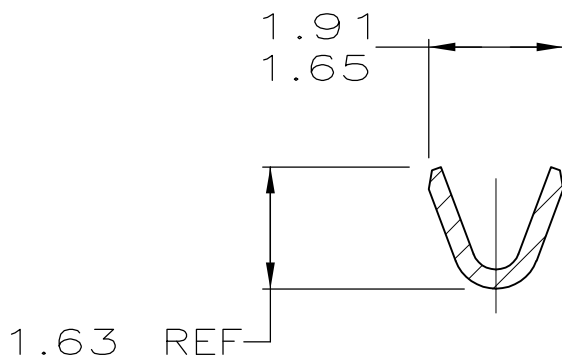
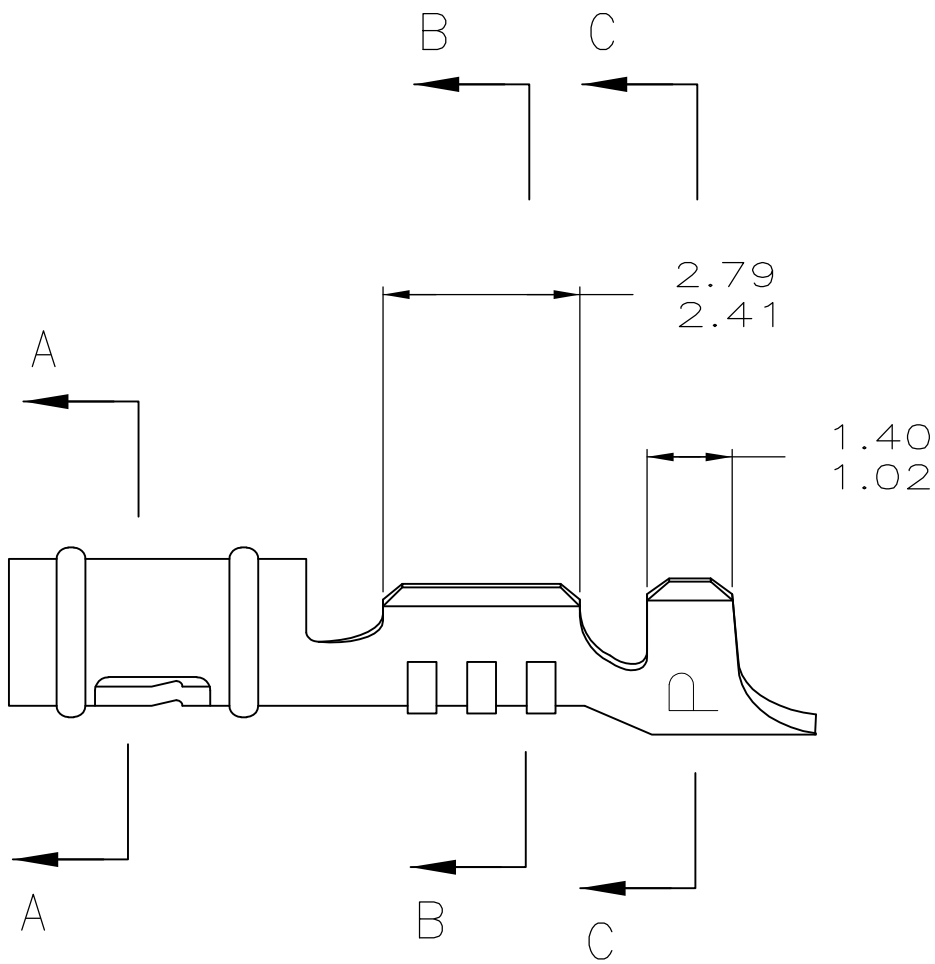

SECTION B-B

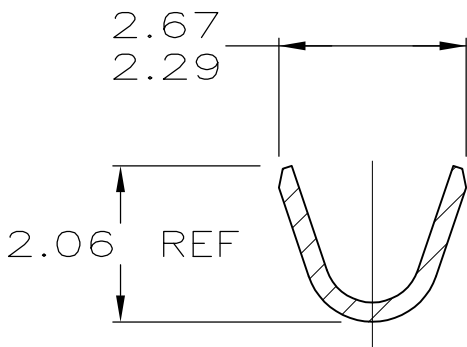

SECTION C-C

MATTE TIN	0.25 BE COPPER	60983-4
1	0.25 BE COPPER	60983-3
PRE-TIN	0.25 PH BRZ	60983-2
2	0.25 PH BRZ	60983-1
FINISH	MATERIAL	PART NUMBER

1.02	.040	1.65	.065	2.67	.105	-	-
0.89	.035	1.63	.064	2.41	.095	-	-
0.51	.020	1.486	.0585	2.29	.090	-	-
0.25	.010	1.47	.058	2.06	.081	9.65	.380
0.13	.005	1.40	.055	1.96	.077	3.94	.155
0.00076	.000030	1.359	.0535	1.91	.075	2.79	.110
MM	IN	MM	IN	MM	IN	MM	IN

CONVERSION TABLE

METRIC

THIS DRAWING IS A CONTROLLED DOCUMENT.		DWN T. BECK 6-11-97	<div><div>TE</div>TE Connectivity</div>		
DIMENSIONS: mm		CHK R. SWING 6-11-97			
		APVD A. BEDDICK 6-17-97	NAME		
		PRODUCT SPEC 108-1025	RECEPTACLE, .058 DIAMETER, 26-22 AWG, .035-.065 INSULATION, LOOSE PIECE, P.C. CONTACT		
MATERIAL SEE TABLE		APPLICATION SPEC 114-1008	SIZE A2	CAGE CODE 00779	DRAWING NO C-60983
TOLERANCES UNLESS OTHERWISE SPECIFIED: 0 PLC ± - 1 PLC ± - 2 PLC ± 0.13 3 PLC ± - 4 PLC ± - ANGLES ± - FINISH		WEIGHT -	RESTRICTED TO -		
CUSTOMER DRAWING		SCALE 10:1	SHEET 1 of 1	REV Z1	

# Mouser Electronics

Authorized Distributor

Click to View Pricing, Inventory, Delivery & Lifecycle Information:

[TE Connectivity:](#)

[60983-1](#)