

THIS DRAWING IS UNPUBLISHED. RELEASED FOR PUBLICATION
 © COPYRIGHT - TE Connectivity Ltd. ALL RIGHTS RESERVED.

REVISIONS					
P	LTR	DESCRIPTION	DATE	DWN	APVD
B2		REVISED PER ECR-17-018813	07FEB2018	BDA	SG

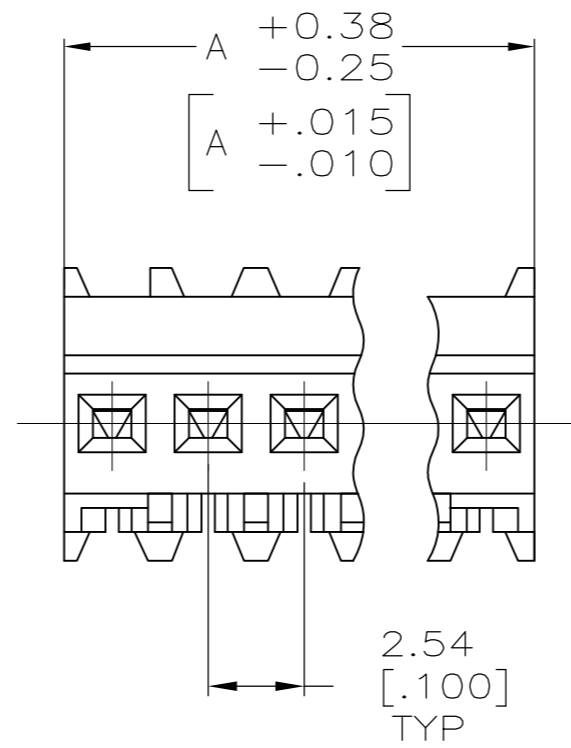
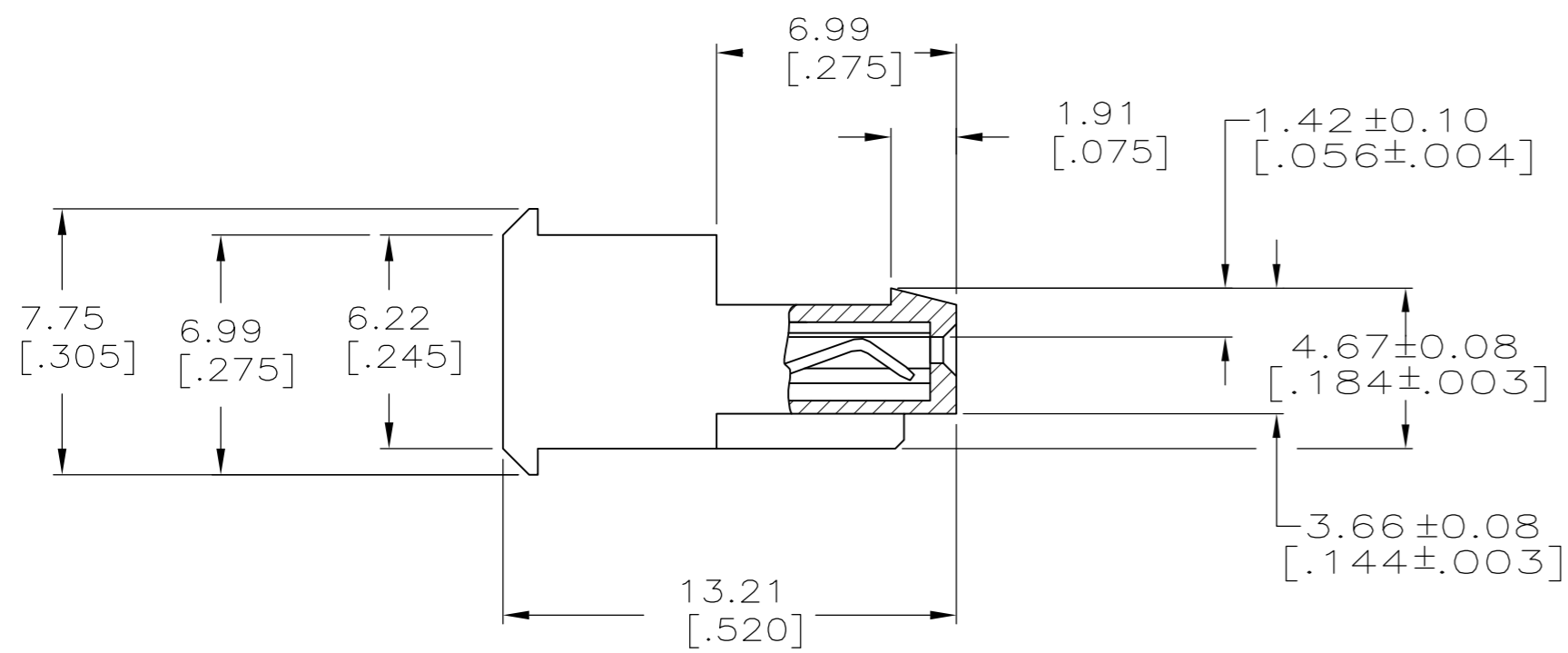
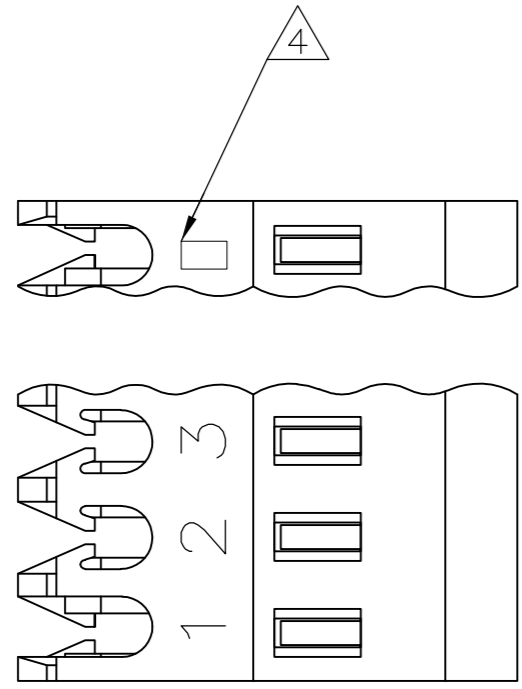

LEAD FREE	38.10 [1.500]	15	4-644575-5
	35.56 [1.400]	14	4-644575-4
	33.02 [1.300]	13	4-644575-3
	30.48 [1.200]	12	4-644575-2
	27.94 [1.100]	11	4-644575-1
	25.40 [1.000]	10	4-644575-0
	22.86 [.900]	9	3-644575-9
	20.32 [.800]	8	3-644575-8
	17.78 [.700]	7	3-644575-7
	15.24 [.600]	6	3-644575-6
	12.70 [.500]	5	3-644575-5
	10.16 [.400]	4	3-644575-4
	7.62 [.300]	3	3-644575-3
	5.08 [.200]	2	3-644575-2

CONTAINS LEAD	38.10 [1.500]	15	1-644575-5
	35.56 [1.400]	14	1-644575-4
	33.02 [1.300]	13	1-644575-3
	30.48 [1.200]	12	1-644575-2
	27.94 [1.100]	11	1-644575-1
	25.40 [1.000]	10	1-644575-0
	22.86 [.900]	9	644575-9
	20.32 [.800]	8	644575-8
	17.78 [.700]	7	644575-7
	15.24 [.600]	6	644575-6
	12.70 [.500]	5	644575-5
	10.16 [.400]	4	644575-4
	7.62 [.300]	3	644575-3
	5.08 [.200]	2	644575-2

7 SUPERSEDED

8 SUPERSEDED

7 SUPERSEDED

1 MATERIAL: CONNECTOR-NYLON UL94V-0 (BLACK)
 CONTACTS-0.30 [.012] THICK COPPER ALLOY
 BRIGHT TIN-LEAD 0.00203 [.000080] MIN THICK FOR CONTACTS
 644575-2 THRU 1-644575-5
 MATTE WHISKER MITIGATED TIN PLATE 0.00203 [.000080] MIN THICK
 OVER 0.00076 [.000030] MIN THICK NICKEL FOR CONTACTS
 3-644575-2 THRU 4-644575-5

2. CONTACTS ACCEPT 22 AWG WIRE WITH 1.52 [.060] MAX INSULATION DIAMETER.

3. CONTACTS MUST ACCEPT 0.64±0.03 [.025±.001] SQUARE POST AND REMAIN LOCKED IN POSITION.

4 IDENTIFICATION NUMBER FOR LAST CIRCUIT MAY NOT APPEAR ON ALL ASSEMBLIES.

5. DIMENSIONS IN BRACKETS ARE IN INCHES.

6. HOUSING FEATURES ARE: FEED THRU WITH LOCKING RAMP.

7 OBSOLETE PARTS: OBSOLETE CIS STREAMLINING PER D.RENAUD/D.SINISI

8 OBSOLETE PARTS

THIS DRAWING IS A CONTROLLED DOCUMENT.		DWN S. HOOVER 03-DEC-2004	TE Connectivity Ltd.	
DIMENSIONS: mm [INCHES]		CHK D. BOSSI 03-DEC-2004		
TOLERANCES UNLESS OTHERWISE SPECIFIED:		APVD D. BOSSI 03-DEC-2004	NAME	
0 PLC ±		PRODUCT SPEC	MTA .100 CONNECTOR ASSEMBLY	
1 PLC ±		APPLICATION SPEC	22 AWG, UL94V-0, SPECIAL	
2 PLC ± 0.13 [.005]		108-1050	SIZE	CAGE CODE
3 PLC ±		114-1019	A2	00779
4 PLC ±			DRAWING NO	RESTRICTED TO
ANGLES ±			C=644575	
FINISH	1	WEIGHT	SCALE	SHEET
		CUSTOMER DRAWING	5:1	1 OF 1
			REV	B2

Mouser Electronics

Authorized Distributor

Click to View Pricing, Inventory, Delivery & Lifecycle Information:

[TE Connectivity:](#)

[4-644575-3](#)