

THIS COPY IS PROVIDED ON A RESTRICTED BASIS AND IS NOT TO BE USED IN ANY WAY DETRIMENTAL TO THE INTERESTS OF PANDUIT CORP.

PANDUIT PART NO.	WEIGHT
OCFC3	.69 LB/100 PCS (317 g/100 PCS)

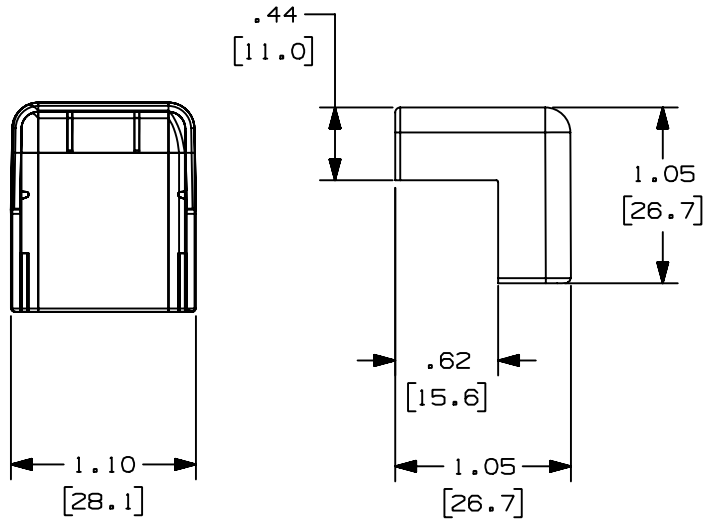

NOTES:

1. SEE CURRENT CATALOG FOR ADDITIONAL PART NUMBER SUFFIXES TO INDICATE COLOR AND OR PACKAGE QUANTITY.
2. THIS PRODUCT IS INTENDED TO BE USED WITH PANDUIT TYPE LD3, LDP3 AND LDS3 RACEWAY.
3. NOMINAL WALL THICKNESSES;
COVER = .055 (1.4)
4. THIS PRODUCT IS FEATURED WITH THE TIA/EIA COMPLIANT BEND RADIUS.
5. DIMENSIONS IN PARENTHESIS ARE IN METRIC.

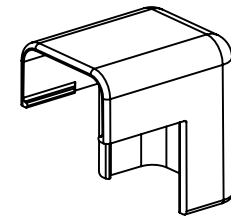

CAD FILENAME/LAYERS D35541CI_LD_OCFC3_02.PRT

PANDUIT CORP. TINLEY PARK, ILLINOIS
OUTSIDE CORNER FITTING COVER (OCFC3)
CUSTOMER DRAWING

UNLESS OTHERWISE SPECIFIED, DIMENSIONAL TOLERANCES ARE:
(.X) ± (.XXX) ±.015 (.4)
(.XX) ±.03 (.8) ANGLES ±

UNLESS OTHERWISE SPECIFIED, ALL DIMENSIONS ARE GIVEN IN INCHES, THIRD ANGLE PROJECTION.

REV	DATE	BY	CHK	DESCRIPTION	ECN	CHK	CUST	SUP	DRAWN BY	DATE	CHECKED BY	MAT'L:	SCALE	DRAWING NO.	DWG SIZE
2	03-10-04	JHEP	RGRO	B. REMOVED CD3 FROM NOTE 2	35541-35	RGRO	RGRO		JBA	09-23-96	CEF	ABS/PC	NONE	35541-35	A
1	05-19-99	DW	HIW	A. REVISED DWG TO SHOW 2D VIEWS	35541-35	HIW	HIW		JBA	09-23-96	CEF	ABS/PC	NONE	35541-35	A
R	09-23-96	JBA	CEF	RELEASED TO PRODUCTION	35541-35	CEF	CEF		JBA	09-23-96	CEF	ABS/PC	NONE	35541-35	A

Mouser Electronics

Authorized Distributor

Click to View Pricing, Inventory, Delivery & Lifecycle Information:

[Panduit:](#)

[OCFC3EI-X](#) [OCFC3WH-X](#) [OCFC3IW-X](#) [OCFC3IG-X](#)