

## SUMMARY



Image is for illustrative purpose only

### # Wires

|         |   |
|---------|---|
| Low     | 0 |
| High    | 0 |
| Coax    | 0 |
| Triax   | 0 |
| Quad    | 0 |
| Fiber   | 0 |
| Fluidic | 0 |

### Download

[Request a quote](#)

[Catalog](#)

|                  |                         |
|------------------|-------------------------|
| Series           | 2S                      |
| Termination type | No contacts / Accessory |
| IP rating        | 61                      |
| Cable Ø          | 0.00 - 0.00 mm          |
| Matching parts   |                         |
| Status           | obsolete                |
| Alternative part |                         |

## TECHNICAL DETAILS

### Mechanics

|                   |   |
|-------------------|---|
| Shell Style/Model | BRR*: Cap spring loaded dust cap for ERA,ERN and EG receptacle or PSA and PK fixed receptacle |
| Keying            | No keying   |
| Housing Material  | PSU (Polysulfone) shell and collet nut, nickel plated brass latch sleeve and mid pieces       |
| Cable Fixing      | ∅ 0 - 0 mm  |
| Variant           | G : Grey  |

### Performance

|               |
|---------------|
| Configuration |
| Insulator     |
| Rated Current |

### Others

LEMO products and services are provided "as is". LEMO makes no warranties or representations with regard to LEMO product & services or use of them, express, implied or statutory, including for accuracy, completeness, or security. The user is fully responsible for his products and applications using LEMO components.

Endurance (Shell): 5000 mating cycles  
 Temp (min / max): -50°C / +150°C  
 Axes material: Nickel-plated brass  
 Maximum operating temperature: 100°C  
 Watertightness: IP61 according to IEC 60529  
 IP Rating: 61

## DRAWINGS

### Draws

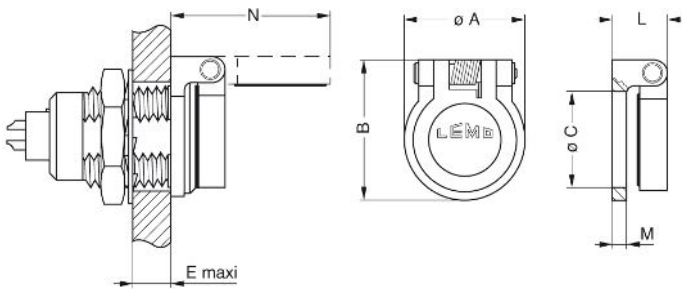

No keying

### Dimensions

|     | A    | B    | C    | E    | L    | M    | N    |
|-----|------|------|------|------|------|------|------|
| mm. | 18.6 | 22.4 | 15.2 | 6.5  | 8.2  | 2    | 26.2 |
| in. | 0,73 | 0,88 | 0,60 | 0,26 | 0,32 | 0,08 | 1,03 |

## RECOMMENDED BY LEMO

### Tools

None

### Cables

|         |  |  |  |
|---------|--|--|--|
| 121 221 |  |  |  |
| 131 221 |  |  |  |
| 151 221 |  |  |  |

LEMO products and services are provided "as is". LEMO makes no warranties or representations with regard to LEMO product & services or use of them, express, implied or statutory, including for accuracy, completeness, or security. The user is fully responsible for his products and applications using LEMO components.

