

PART NUMBER	REV	FIRST USED	POWER UNIT	FEED TYPE	DESCRIPTION
1852522-3	A	354500-1	BENCH MODEL G	PRE FEED	CUTS CARRIER
7-1852522-7	A	-	-	-	SPARE PARTS

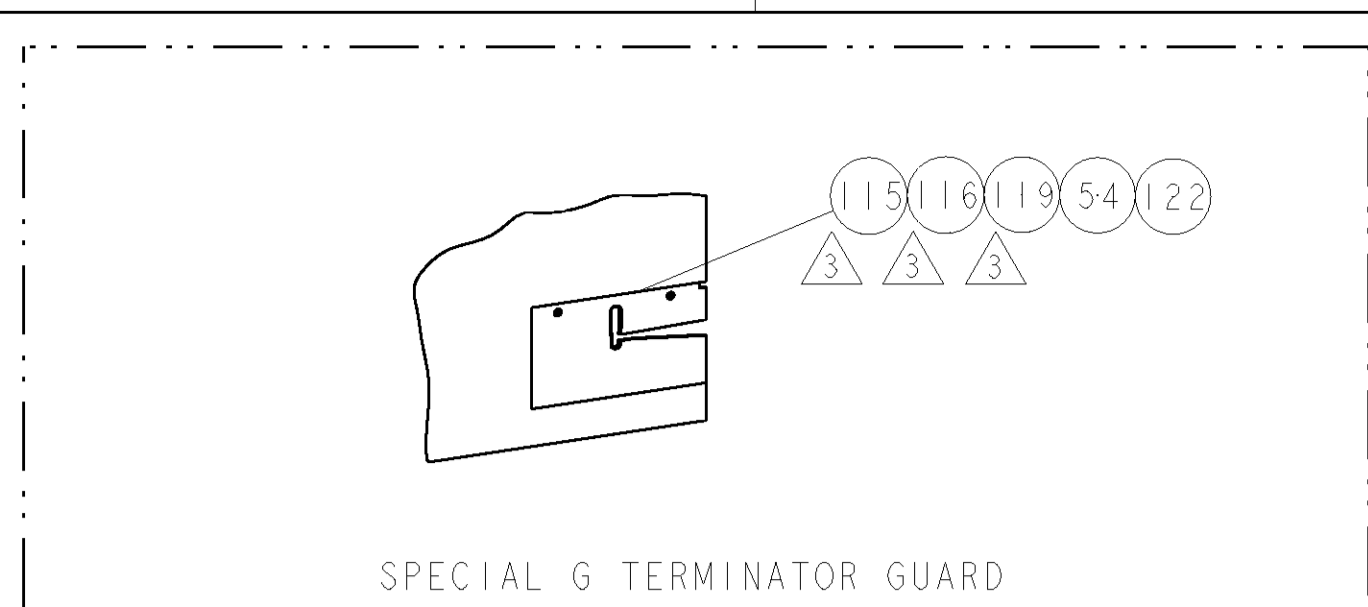

TERMINAL NAME: AMPLIVAR SPLICE SUB-MINIATURE			
TE PN	MANUF PN	TE TERMINAL - TE CRIMP SPECS	
63431-2	-		
-	-	PAD LTR	CRIMP HEIGHT
-	-	A	.81±0.05mm [.032±.002]
-	-	B	-
-	-	C	-
-	-	D	-
-	-	CRIMP	SIZE
-	-	WIRE	TYPE
-	-	INSUL	RANGE
-	-	FEED	1.40mm [.055]
-	-	APPLICATOR INSTRUCTIONS	F
-	-	SET UP GAGE	26 SOLID
WIRE STRIP LENGTH	TERM APPL SPEC	APPLICATOR INSTRUCTIONS	
NONE	NONE	408-8040	
		SET UP GAGE	
		458637-1	

- △ RECOMMENDED SPARE PARTS
- △ GREASE LIGHTLY
- △ GUARD MUST BE IN PLACE WHEN OPERATING APPLICATOR IN A BENCH MACHINE

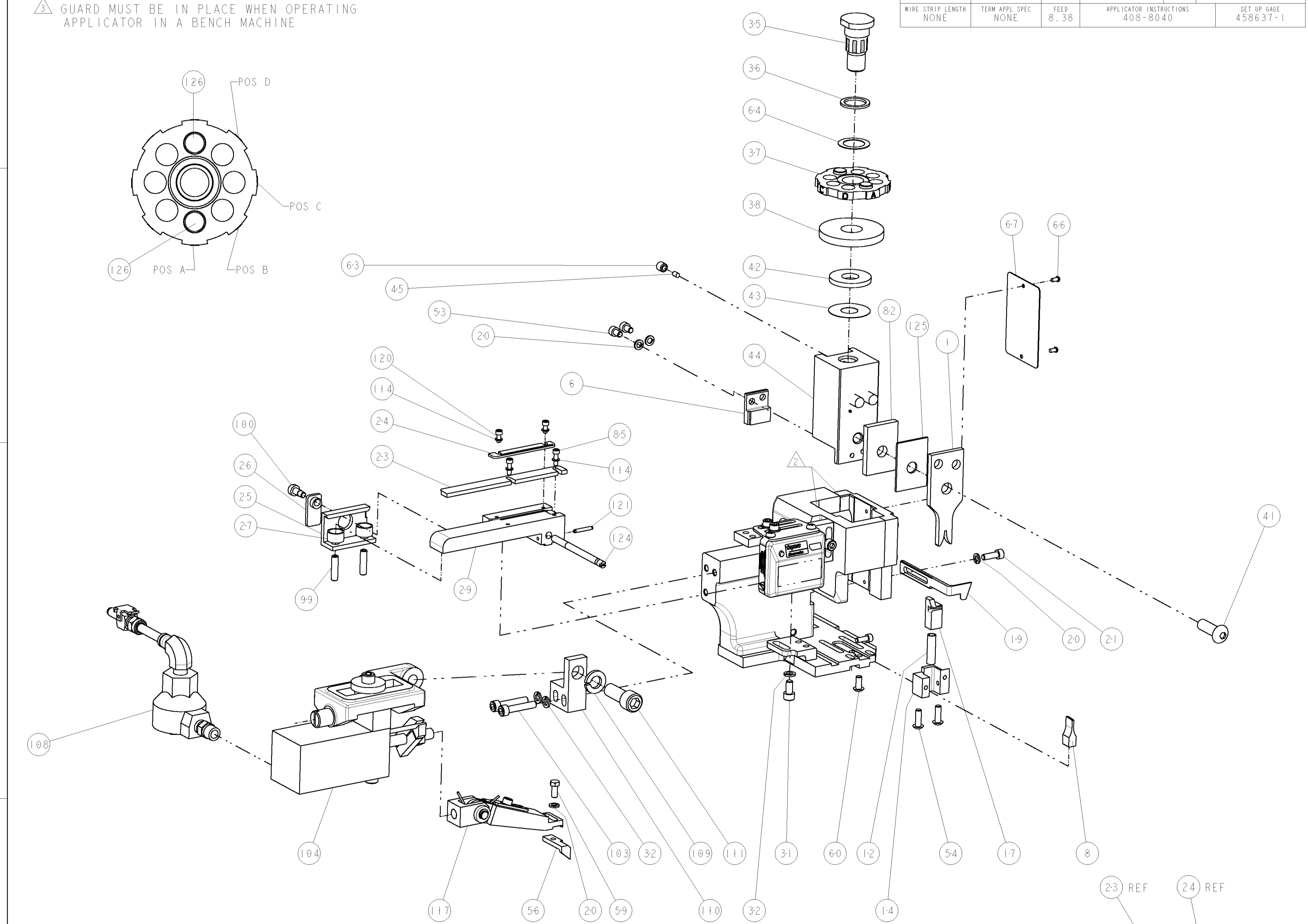
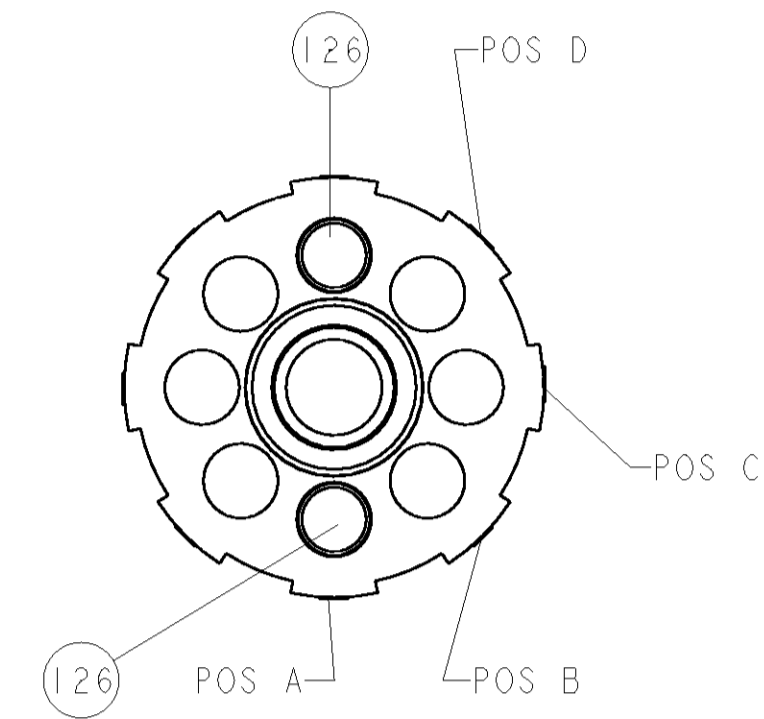

LOC	QTY	REV	DESCRIPTION	DATE	DWN	APVD
A	66		RELEASED	31JAN2008	MEH	TE
-	2	-	3-354779-7	PIN, WIRE DISC, .3175		126
-	1	-	1-455888-2	SPACER, CRIMPER		125
-	1	-	690432-3	ADJUSTMENT SCREW		124
-	2	-	2-21000-6	SCR, SKT HD CAP 3-32 X .375		122
-	1	-	3-21028-8	PIN, SLOTTED SPRING .094 X .625		121
-	2	-	1-21000-3	SCR, SKT HD CAP 4-40 X .250		120
-	1	-	1633650-1	SPACER BLOCK, GUARD		119
-	1	-	461062-1	FEED FINGER ASSEMBLY		117
-	1	..	1633649-1	INSERT, NYLON		116
-	1	..	1633648-1	INSERT, GUARD		115
-	4	-	21024-2	WASHER, SPRG LOCK, REG NO 4		114
-	1	-	3-21001-5	SCR, SKT HD CAP 3/8-16 X 1.000		111
-	1	-	459610-1	MOUNT, FEED BRACKET		110
-	1	-	21024-8	WASHER, SPRG LOCK, REG 3/8		109
-	1	-	692655-7	AIR FEED VALVE ASSEMBLY		108
-	1	-	461065-1	ASSEMBLY, AIR FEED		104
-	2	-	3-21000-9	SCR, SKT HD CAP 10-32 X 1.000		103
-	1	-	22353-8	SCR, SHLD, SLOT HD, 3/16 DIA		100
-	2	-	5-21006-6	SCR, SET, CUP POINT 10-32 X .750		99
-	2	-	1-21000-4	SCR, SKT HD CAP 4-40 X .375		85
-	1	-	2-455888-9	SPACER, CRIMPER		82
-	1	-	4088040	SF APPL INST 408-8040		72
-	1	-	217238-1	GENERAL INSTRUCTION PKG		71
-	1	-	461264-1	PLATE, IDENTIFICATION		67
-	2	-	21017-2	SCREW, DRIVE		66
-	1	-	986950-1	WASHER, FLAT PRECISION		64
-	1	-	21009-2	SCR, SET, SELF LOCKING 1/4-20 X .250		63
-	1	-	22733-8	SCR, BHSC, SELF-LOCKING, 8-32 X .375		60
-	1	-	2-22603-1	SCREW, MACH, HEX HD, 8-32 X .375		59
-	1	-	694433-8	FEED PAWL		56
-	4	-	2-21002-2	SCR, BTN SKT HD CAP 8-32 X .500		54
-	2	-	2-21000-5	SCR, SKT HD CAP 8-32 X .250		53
-	1	-	1633399-6	APPL., BASIC AIR FEED SUB ASSY		46
-	1	-	690191-1	PLUG, NYLON		45
-	1	-	1-455673-2	RAM, SIDE FEED		44
-	1	-	690125-1	SHIM SUB-ASSY		43
-	1	-	690124-4	WASHER, RAM (.135)		42
-	1	-	7-21002-9	SCR, BTN SKT HD CAP 5/16-24 X 1.00		41
-	1	-	690223-2	SPACER, INS.		38
-	1	-	354777-1	WIRE DISC, ASSEMBLY		37
-	1	-	22480-5	SPRING, COMPRESSION		36
-	1	-	690212-1	POST, RAM		35
-	3	-	21024-5	WASHER, SPRG LOCK, REG NO 10		32
-	1	-	3-21000-4	SCR, SKT HD CAP 10-32 X .375		31
-	1	-	844048-5	PLATE, REAR STRIP GUIDE		29
-	2	-	1-22284-0	SPRING, COMPRESSION		27
-	1	-	356835-1	LEVER, DRAG RELEASE		26
-	1	-	240792-1	DRAG, TERMINAL		25
-	1	-	690438-1	FRONT STRIP GUIDE		24
-	1	-	189124-2	GUIDE, FRONT STRIP		23
-	1	-	2-21000-7	SCR, SKT HD CAP 8-32 X .500		21
-	4	-	21024-4	WASHER, SPRG LOCK, REG NO 8		20
-	1	..	3-1338987-1	STRIPPER		19
-	1	-	1-690463-6	FLOATING SHEAR, REAR		17
-	1	-	690462-1	SHEAR HOLDER, REAR		14
-	-	-		13
-	1	-	3-22280-3	SPRING, COMPRESSION		12
-	1	-	1-21000-9	SCR, SKT HD CAP 6-32 X .375		11
-	-	-		10
-	-	-		9
-	1	-	1633359-6	ANVIL, AMPLIVAR		8
-	-	-		7
-	1	-	468888-2	DEPRESSOR, REAR SHEAR - SPECIAL		6
-	-	-		5
-	-	-		4
-	-	-		3
-	-	-		2
-	1	-	1-1633588-2	CRIMPER, WIRE		1

DIMENSIONS: INCHES		TOLERANCES UNLESS OTHERWISE SPECIFIED:		DWN: HERR 21SEP2007		Tyco Electronics Tyco Electronics Harrisburg, PA 17105-3608	
9 PLC	±	1 PLC	±0.1	CHK: G. BAILEY 21SEP2007	NAME: SIDE FEED HDM APPLICATOR		
1 PLC	±0.01	3 PLC	±0.001	APVD: T. BENCHOFF 21SEP2007	PRODUCT SPEC: -		
4 PLC	±0.0001	ANGLES	±	APPLICATION SPEC: -			
MATERIAL: -		FINISH: -		WEIGHT: -		SIZE: CAGE CODE: DRAWING NO: RESTRICTED TO: A1 00779 C=1852522	
CUSTOMER DRAWING				SCALE: 3:5		SHEET 1 OF 1 REV A	

FEED TRACK POSITION GUIDE BY WIRE BARREL

CUSTOMER VIEWABLE ASSEMBLY

Mouser Electronics

Authorized Distributor

Click to View Pricing, Inventory, Delivery & Lifecycle Information:

[TE Connectivity:](#)

[1852522-3](#)