

LOC		DIST		REVISIONS			
ES		00		REV	DESCRIPTION	DATE	BY
				0	RELEASED PER OS12-0317-04	16DEC04	BM
				01	REVISED PER ECO-09-024606	17DEC09	KK

- △1 HOUSING MATERIAL: LIQUID CRYSTAL POLYMER. COLOR: NATURAL
- △2 CONTACT MATERIAL: PHOSPHOR-BRONZE
- △3 CONTACT FINISH:(B)  
UNDERPLATE (ENTIRE CONTACT):  
0.00127 MIN NICKEL PER SAE-AMS-QQ-N-290  
ON MATING SURFACES:  
CONFORMS TO ALL TESTING SPECIFIED FOR TELCORDIA UNCONTROLLED ENVIRONMENT.  
ON LEADS:  
0.0006 MIN MATTE TIN PER ASTM B 545 OVER UNDERPLATE.  
LUBRICATION (MIN MATING SURFACES):  
SURFACE CONDITIONER AFTER PLATING.
- △4 PART MARKING, LOCATED APPROXIMATELY AS SHOWN.
- △5 OBSOLETE PARTS: OBSOLETE CIS STREAMLINING PER D.RENAUD/D.SINISI

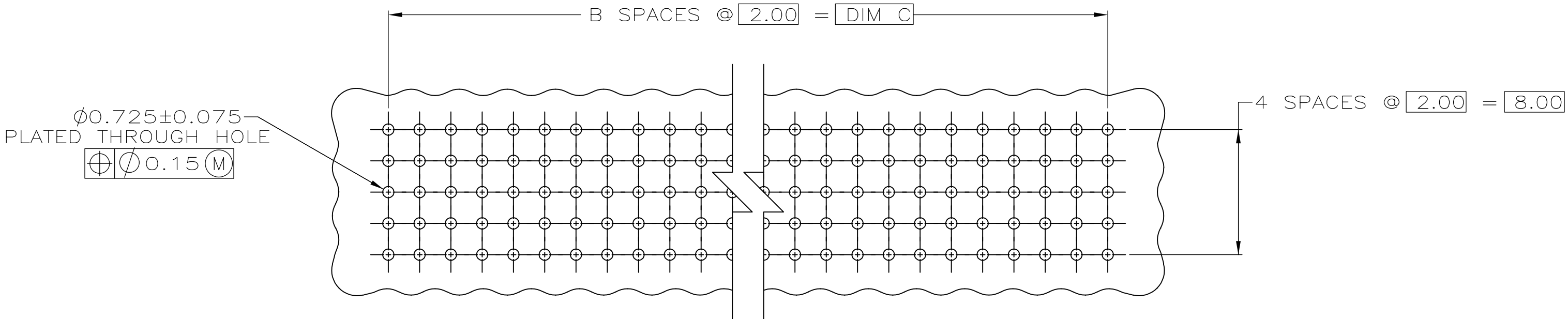

RECOMMENDED CIRCUIT PATTERN  
(COMPONENT SIDE)

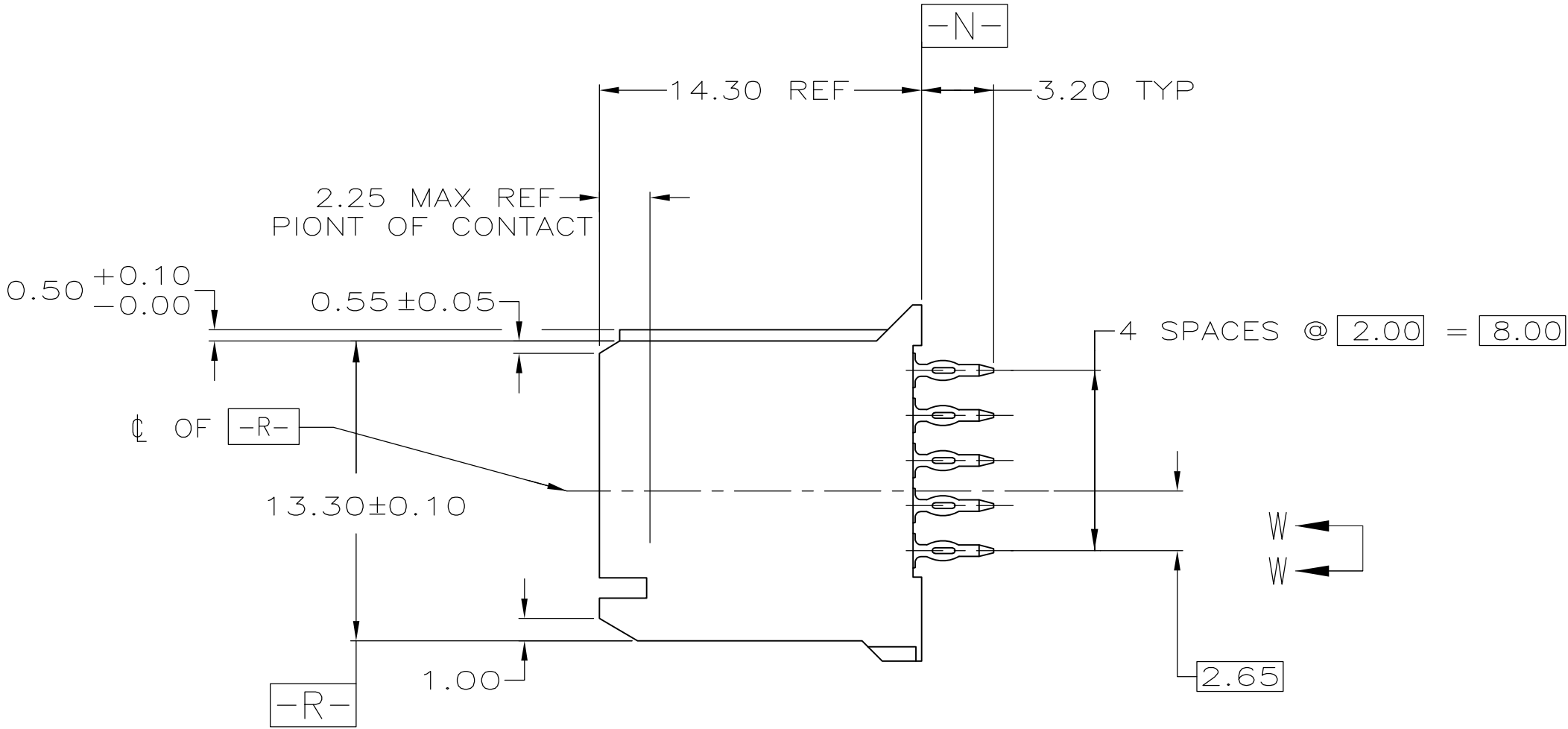
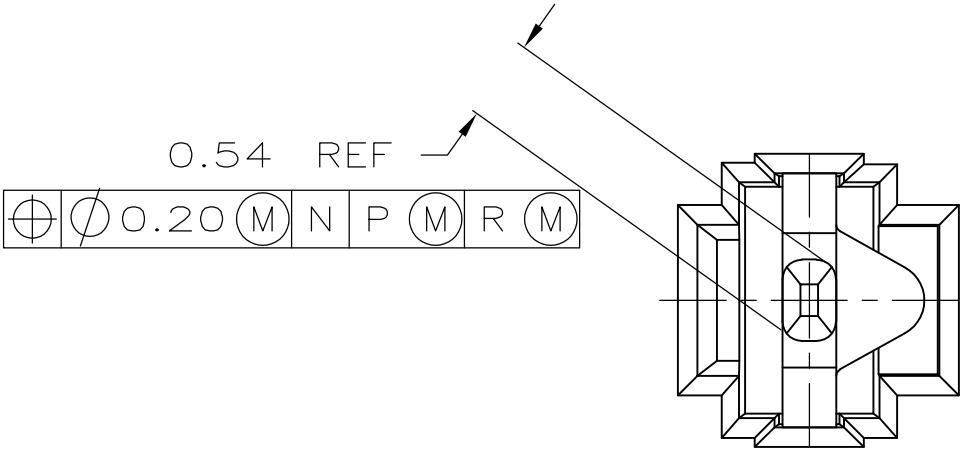

VIEW W-W  
SCALE 20:1

△5 OBSOLETE	94.00	47	95.88	240	5223668-8
	82.00	41	83.88	210	5223668-7
	70.00	35	71.88	180	5223668-6
	58.00	29	59.88	150	5223668-5
	46.00	23	47.88	120	5223668-4
	34.00	17	35.88	90	5223668-3
	22.00	11	23.88	60	5223668-2
DIM C	10.00	5	11.88	30	5223668-1
	B	DIM A	NUMBER OF SIGNAL POSITIONS		PART NUMBER

THIS DRAWING IS A CONTROLLED DOCUMENT.		DWN B.MCMMASTER	16DEC04	Tyco Electronics Corporation	
		CHK R.WERTZ	16DEC04	Shanghai, P.R.China, 200233	
		APP'D R.WERTZ	16DEC04	NAME	
DIMENSIONS: mm		TOLERANCES UNLESS OTHERWISE SPECIFIED:		ASSEMBLY, RECEPTACLE, SIGNAL, VERTICAL, 5 ROW, Z-PACK 2mm FB, WITH PRESS-FIT LEADS	
		0 PLC ± -		APPLICATION SPEC	
		1 PLC ± -		—	
		2 PLC ± 0.13		—	
		3 PLC ± -		—	
		4 PLC ± -		—	
		ANGLES ± -		—	
MATERIAL		FINISH		—	
△1 △2		△3		—	
CUSTOMER DRAWING		SCALE 4:1		SHEET 1 OF 1	
				REV 01	

# Mouser Electronics

Authorized Distributor

Click to View Pricing, Inventory, Delivery & Lifecycle Information:

[TE Connectivity:](#)

[5223668-1](#)