

REV.	DATE	ECR NO.	DESCRIPTION
NC	08/25/09	XXXXXX	INITIAL RELEASE

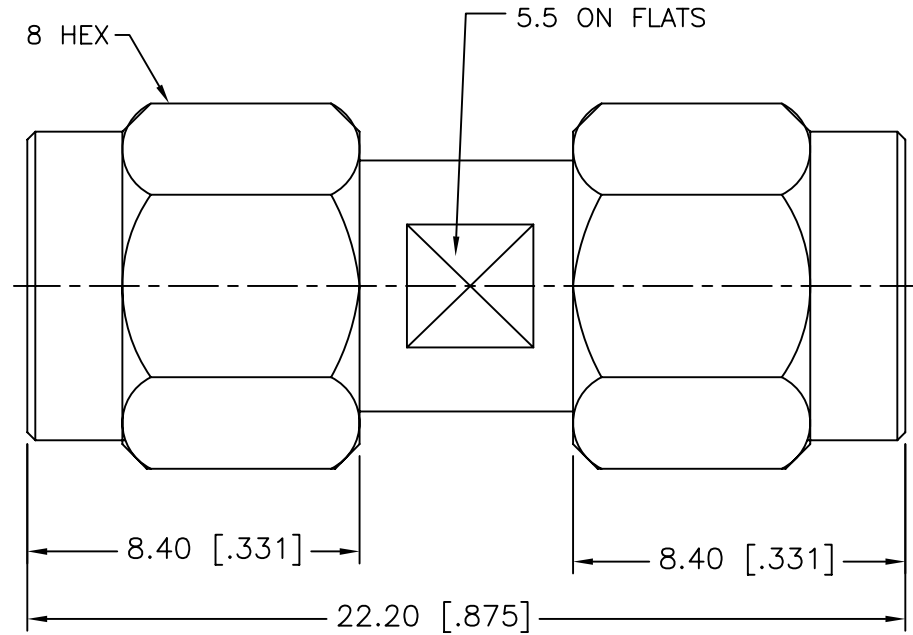

				UNLESS OTHERWISE SPECIFIED DIMENSIONS ARE IN MILLIMETERS. DIMENSIONS IN [ ] ARE IN INCHES AND FOR CUSTOMER REFERENCE ONLY.	APPROVALS	DATE	<b>Amphenol Connex</b>						
6	RETAINER RING	BERYLLIUM COPPER	NATURAL	2	DRAWN	CW				08/25/09	PART DESCRIPTION <b>SMA PLUG TO PLUG ADAPTOR</b>		
5	GASKET	SILICONE	RED	2	CHECKED			PART NO. <b>132168SS</b>					
4	CONTACT PIN	BRASS	GOLD	1	ISSUED						DWG. NO. 132168SS.DWG		
3	INSULATOR	PTFE	NATURAL	2	SHEET	1 OF 1		REV.	NC	SIZE			
2	SHELL	STAINLESS STEEL	PASSIVATED	2	CAD FILE		C:/CONNEX/132168SS.DWG						
1	BODY	STAINLESS STEEL	PASSIVATED	1	DO NOT SCALE DRAWING								
				UNLESS OTHERWISE SPECIFIED TOLERANCES FOR MILLIMETERS ARE: 0.5 - 8mm ± 0.20mm 8 - 30mm ± 0.40mm 30 - 120mm ± 0.50mm UNLESS OTHERWISE SPECIFIED TOLERANCES FOR INCHES ARE: .020 - .315 = ± 0.007" .315 - 1.180 = ± 0.015" 1.180 - 4.724 = ± 0.020"									

# Mouser Electronics

Authorized Distributor

Click to View Pricing, Inventory, Delivery & Lifecycle Information:

[Amphenol:](#)

[132168SS](#)