

LOC	DIST	REVISIONS					
		P	LTR	DESCRIPTION	DATE	DWN	APVD
AD	00		A5	REVISED PER ECO-14-005988	23APR2014	NK	RH

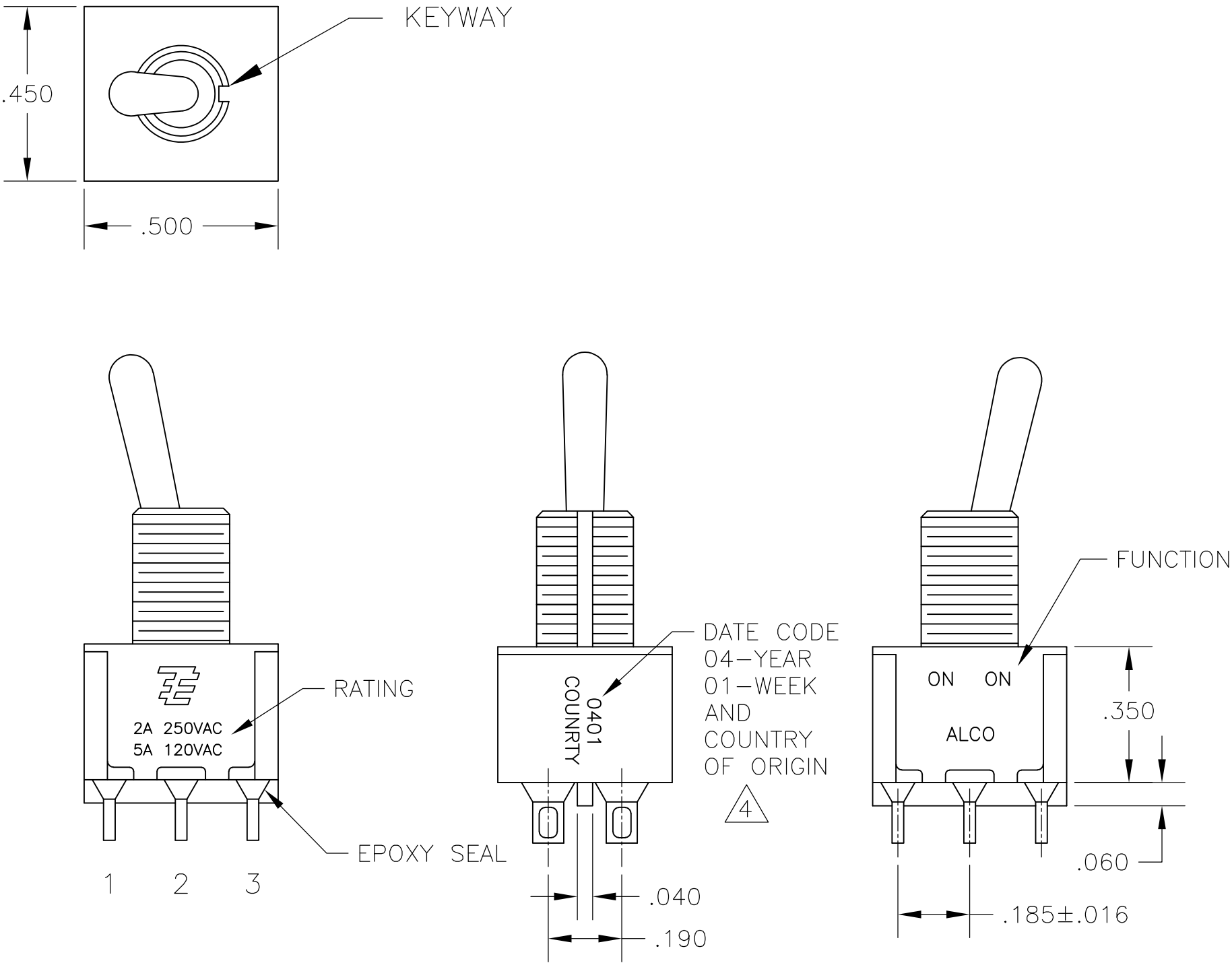

- 1
- ALL MATERIALS AND FINISHES SHALL COMPLY WITH EU DIRECTIVE 2002/95/EC OF 27JAN2003 (ROHS).
- 2
- EACH SWITCH WITH THREADED BUSHINGS SUPPLIED WITH THE FOLLWING MOUNTING HARDWARE:
(2) HEX NUTS
(1) INTERNAL TOOTH LOCKWASHER
(1) LOCATING RING.
- 3
- G CONTACT OPTION CAN BE USED FOR SIGNAL OR POWER LEVEL SWITCHING. IF SWITCH IS USED AT LEVELS EXCEEDING .4VA @ 20V AC/DC, SWITCH IS RENDERED FOR POWER SWITCHING ONLY DUE TO ARC REMOVAL OF GOLD PLATING. RATING MARKED ON FRAME IS 2A 250VAC, 5A 120 VAC.
- 4
- DATE CODE AND COUNTRY OF ORIGIN MAY APPEAR ON EITHER SIDE OF SWITCH.
- 5
- LENGTH OF TOGGLE REDUCED BY .020 WITH A, AV2, V30 OR V40 VERTICAL SUPPORT BRACKET OPTIONS.
- 6
- ALL LOGO, RATING, DATE CODE, AND FUNCTION MARKINGS TO BE LASER MARKED.

FUNCTION CHART			
FUNCTION			
01	ON	NONE	ON
08	ON	NONE	(ON)
TERMINALS CONNECTED	2-3, 5-6	---	1-2, 4-5
None: No mechanical position Off: Mechanical position with no electrical connection (On): Momentary action			

SPECIFICATIONS CHART	
RATING, B CONTACTS	.4VA MAX @20V MAX. AC OR DC
RATING, G CONTACTS-SEE NOTE 3	.4VA MAX @20V MAX. AC OR DC OR 5A @120 VAC OR 28 VDC (RESISTIVE)
	2A @250 VAC (RESISTIVE)
RATING, Q CONTACTS	5A @120 VAC OR 28 VDC (RESISTIVE)
	2A @250 VAC (RESISTIVE)
ELECTRICAL LIFE	6,000 CYCLES AT RATED LOAD
CONTACT RESISTANCE	10 MILLIOHMS MAX INITIAL @ 2-4VDC, 100ma
INSULATION RESISTANCE	1,000 MEGOHMS MIN
DIELECTRIC WITHSTANDING VOLTAGE	1,000 V RMS AT SEA LEVEL
OPERATING TEMPRATURE	-30C TO 85C

PART NUMBER SEQUENCE CHART						
MODEL	FUNCTION	TOGGLE	BUSHING	TERMINAL	CONTACT	RoHS
EXAMPLE: A201SYCQ04	01	K	CW	A	B	04
	08	K1	D	AV2	G	
		L	D9	C	Q	
		L1	H	V30		
		L2	Y	V40		
		M	Y9	V70		
		P3		W		
		S		W4		
		T		Z		
		T1		Z3		

EXAMPLE: A201SYCQ04

THIS DRAWING IS A CONTROLLED DOCUMENT.		DWN M. ZITTO	18MAY05	TE Connectivity		
DIMENSIONS: INCHES		CHK M. ZITTO	-			
		APVD M. ZITTO	-	NAME GEMINI A SERIES TOGGLE SWITCH, DOUBLE POLE, 2 POSITION FUNCTIONS (01 & 08)		
		PRODUCT SPEC	-			
MATERIAL		APPLICATION SPEC	-	SIZE	CAGE CODE	DRAWING NO
FINISH		WEIGHT	-	A2	00779	C=1825138
		CUSTOMER DRAWING		SCALE	3:1	SHEET 1 of 4
						REV A5

DIM L	BUSHING TYPE	DIM L	BUSHING TYPE	DIM L	BUSHING TYPE
.840	Y, H	.640	Y, H	.550	Y, H
.910	D, D9	.710	D, D9	.620	D, D9

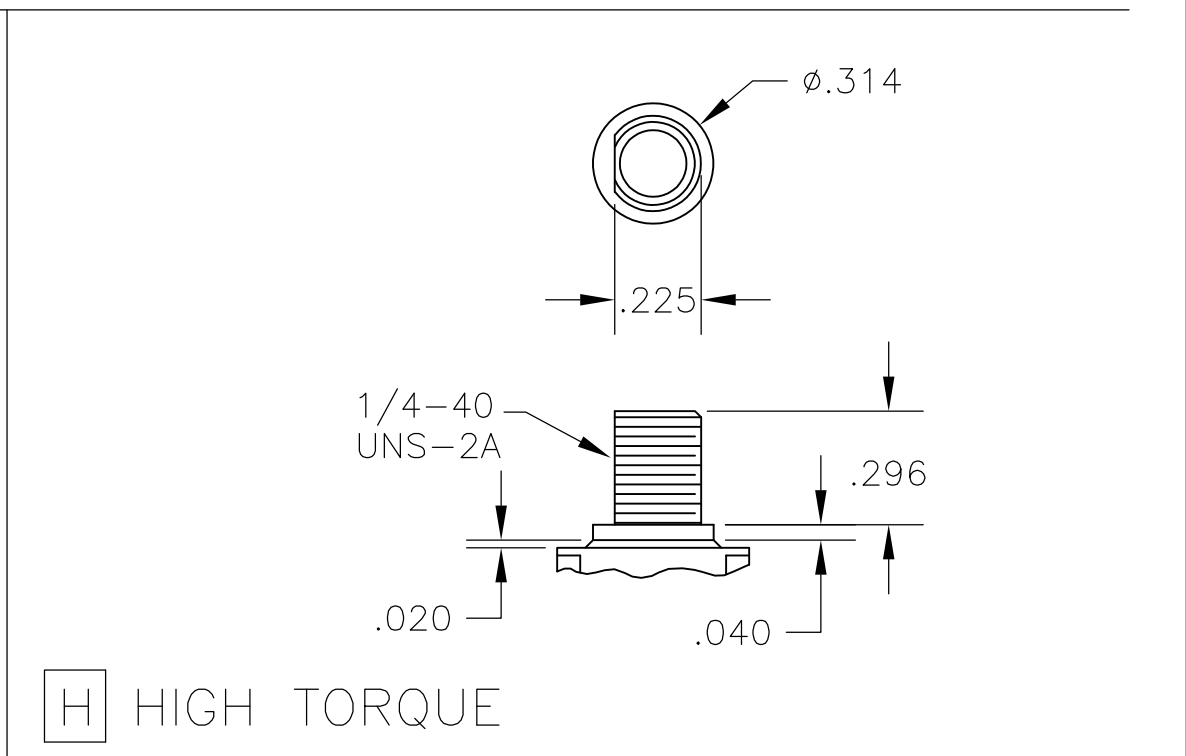
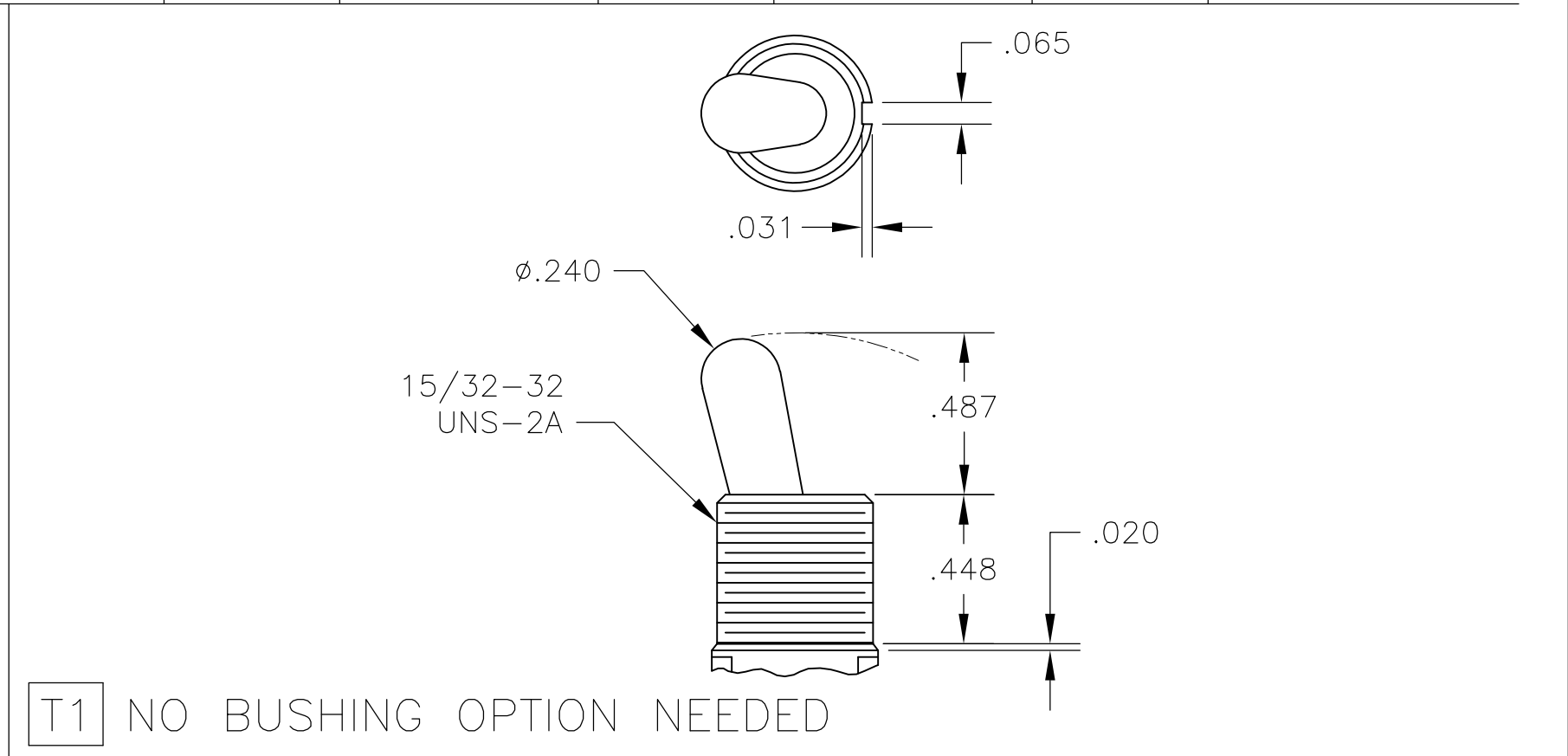

LOC	DIST	REVISIONS					
		P	LTR	DESCRIPTION	DATE	DWN	APVD
AD	00	-	-	SEE SHEET 1	-	-	-

D

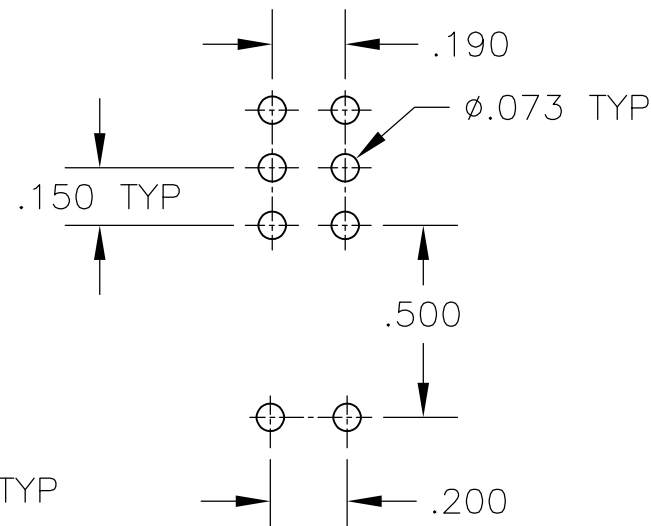
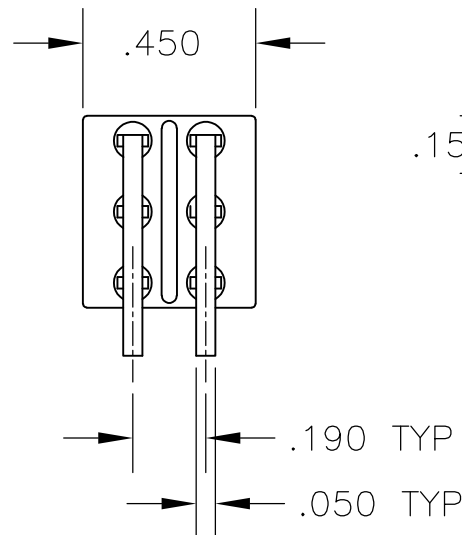
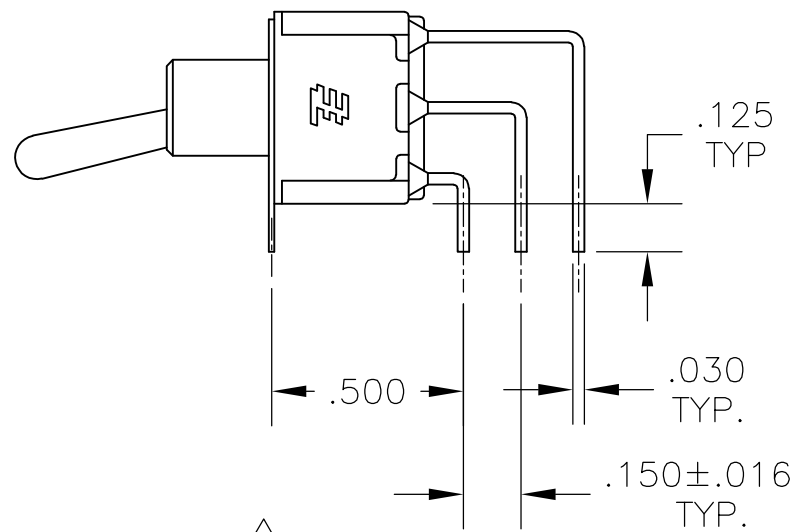
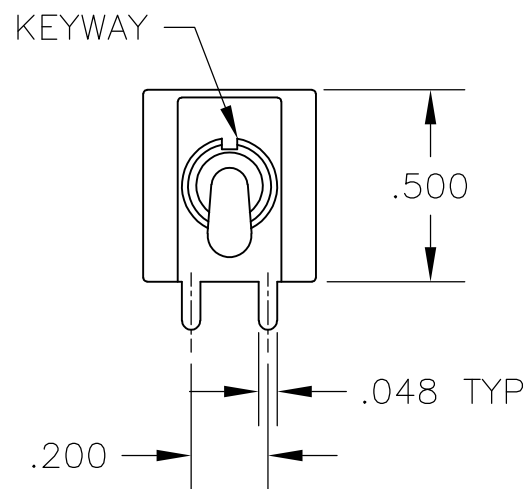

RECOMMENDED
PCB LAYOUT

AV2 VERTICAL RIGHT ANGLE 5

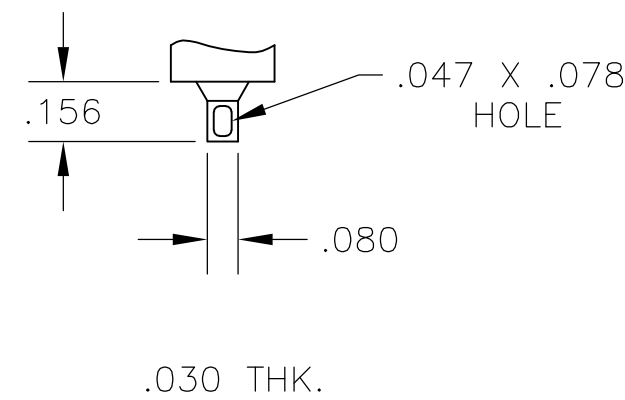

.030 THK.

Z WIRE LUG

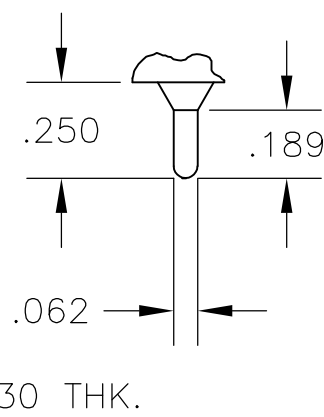

.030 THK.

Z3 QUICK CONNECT

C

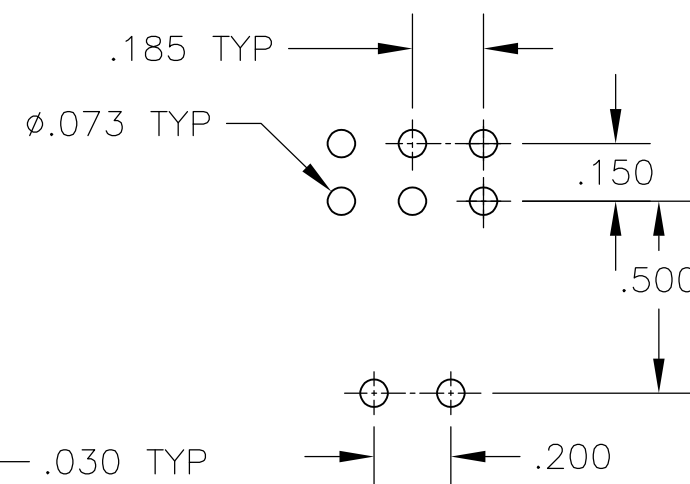
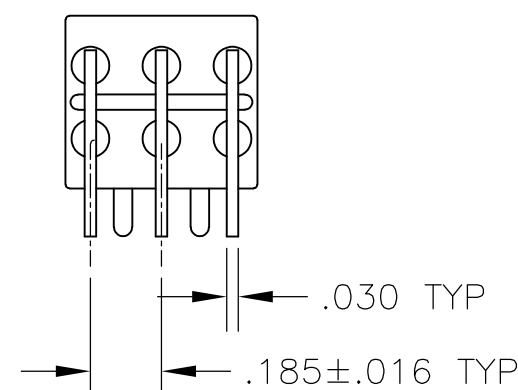
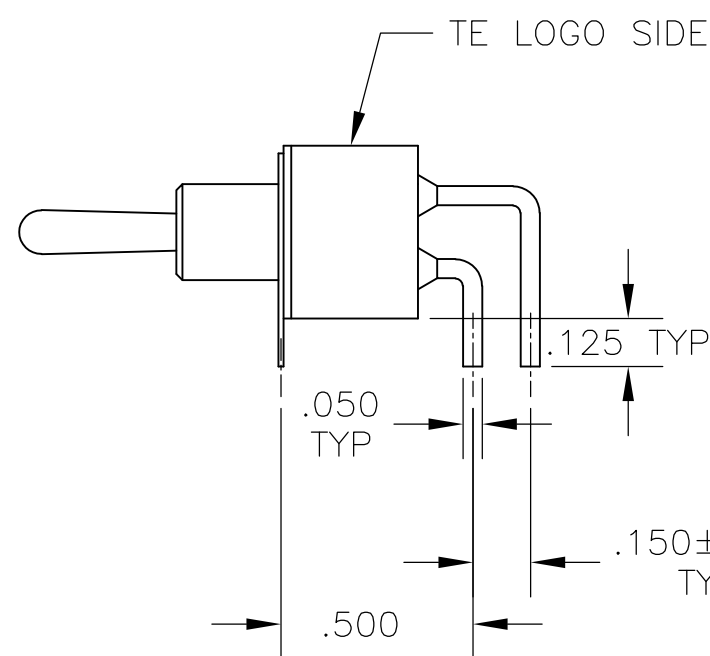
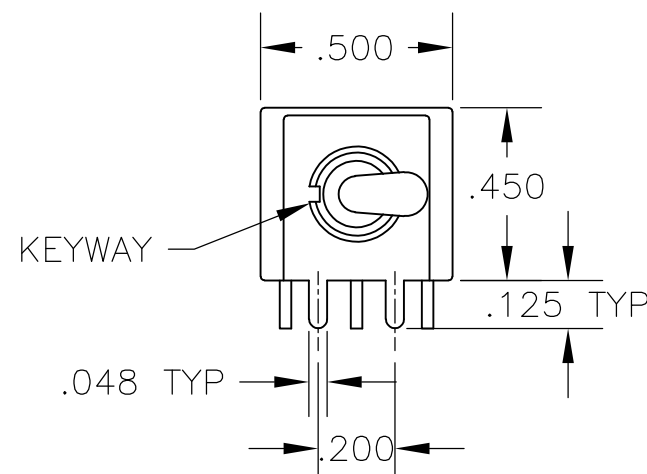

RECOMMENDED
PCB LAYOUT

A RIGHT ANGLE 5

OPTION	DIM A
W	.736
W4	1.062

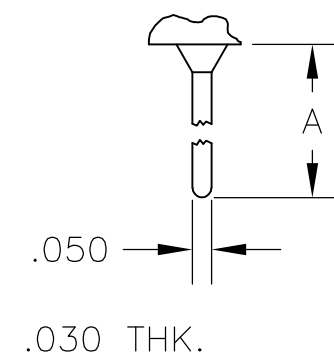

.030 THK.

W W4 WIRE WRAP

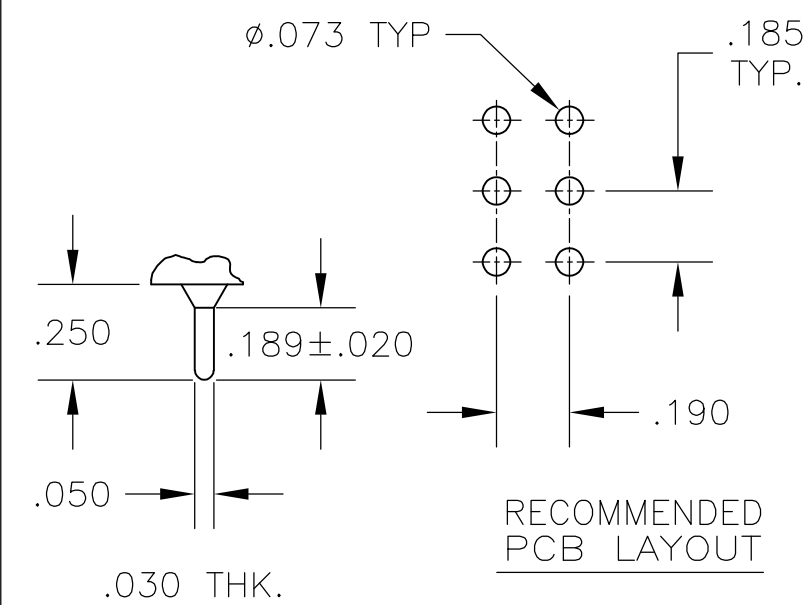

.030 THK.

RECOMMENDED
PCB LAYOUT

C PRINTED CIRCUIT

B

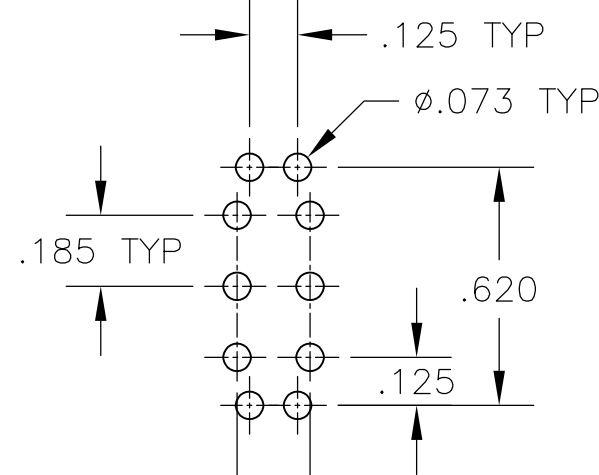
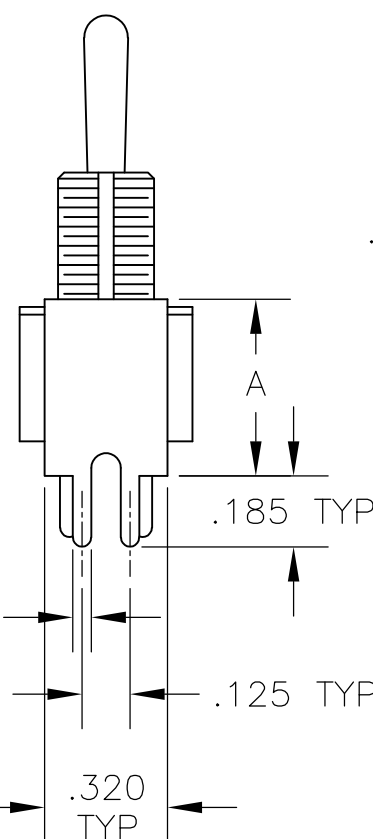
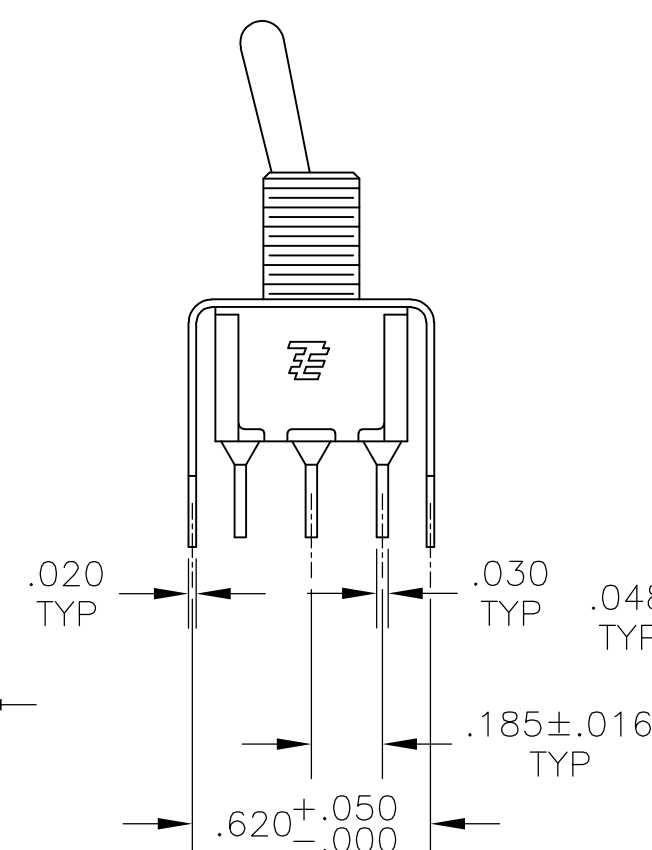
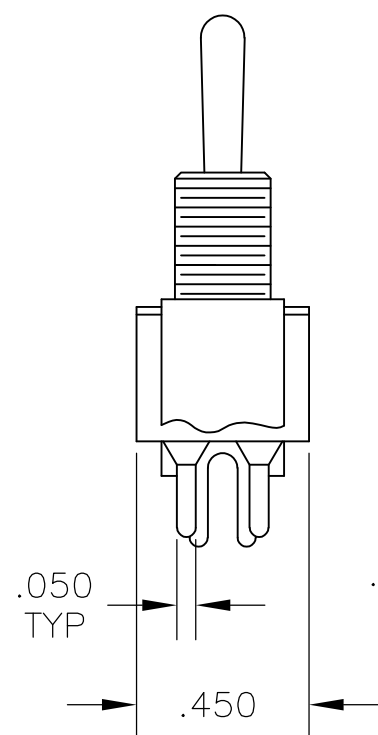

RECOMMENDED
PCB LAYOUT

V30 V40 5

VERTICAL SUPPORT BRACKET

OPTION	DIM A
V30	.460
V40	.630

V70

VERTICAL SUPPORT BRACKET

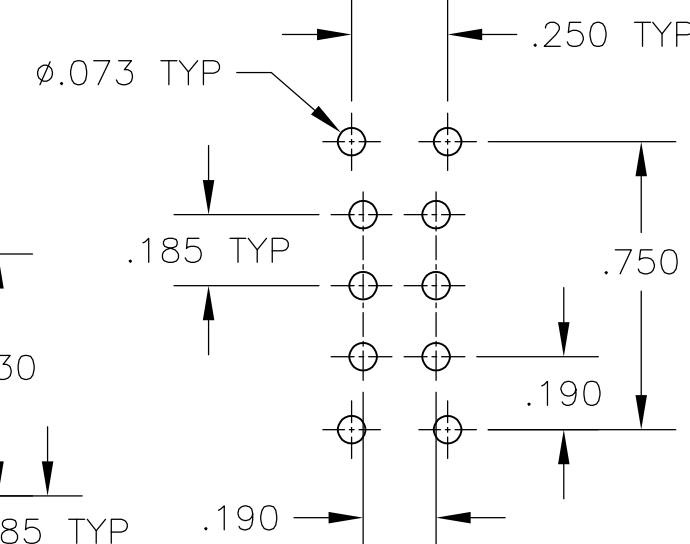
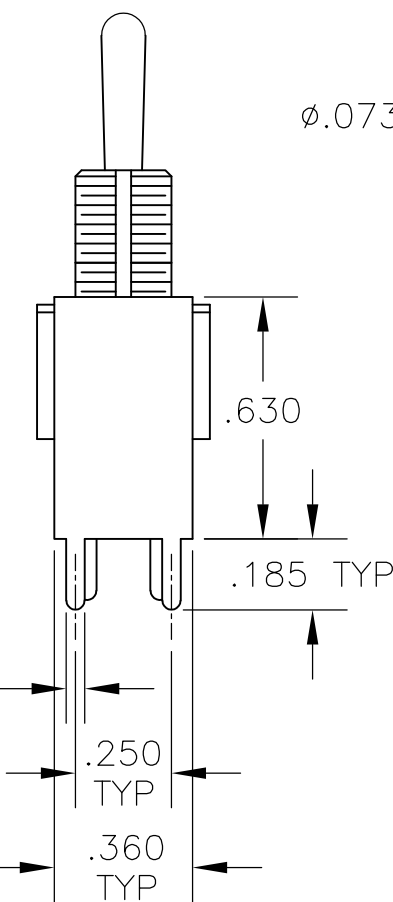
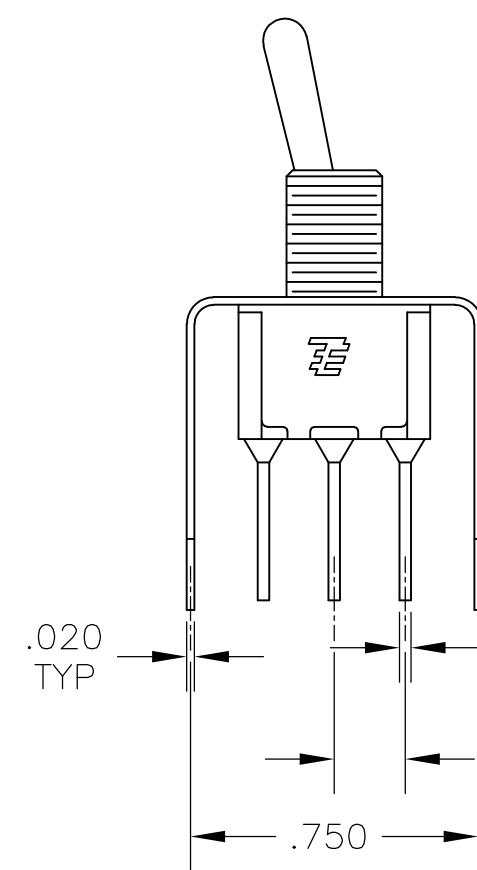
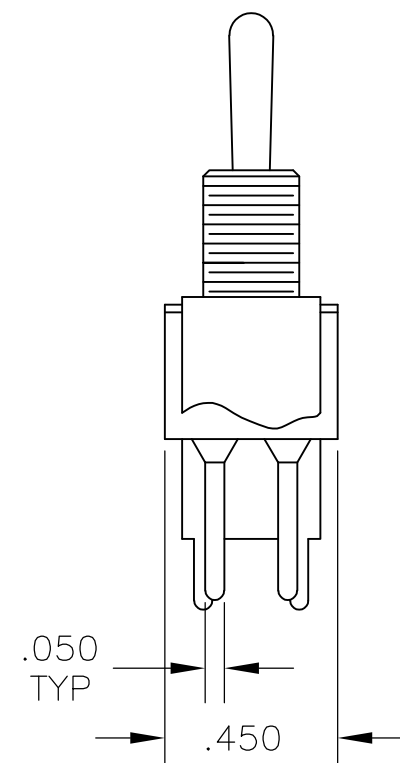

RECOMMENDED
PCB LAYOUT

A

THIS DRAWING IS A CONTROLLED DOCUMENT.				14APR05			
DWN M. ZITTO				-			
CHK M.ZITTO				-			
APVD P.BROUILLETTE				-			
PRODUCT SPEC				-			
APPLICATION SPEC				-			
WEIGHT				-			
CUSTOMER DRAWING				-			
SCALE 2:1				SHEET 3 of 4			
REV A5				-			



TE Connectivity

GEMINI A SERIES TOGGLE SWITCH, DOUBLE POLE,
2 POSITION FUNCTIONS (01 & 08)

SIZE A2 CAGE CODE 00779 DRAWING NO C=1825138 RESTRICTED TO

LOC	DIST	REVISIONS					
AD	00	P	LTR	DESCRIPTION	DATE	DWN	APVD
			—	SEE SHEET 1	—	—	—

Alco P/N	P/N
A201KAB04	1825138-1
A201KD9AQ04	1825138-2
A201KZQ04	1825138-3
not assigned	1825138-4
A201L1D9V30Q04	1825138-5
A201MD9AB04	1825138-6
A201MD9AQ04	1825138-7
A201MD9AV2B04	1825138-8
A201MD9AV2Q04	1825138-9
A201MDAQ04	1-1825138-0
not assigned	1-1825138-1
A201MYAQ04	1-1825138-2
A201MYCB04	1-1825138-3
A201MYZQ04	1-1825138-4
A201P3ZQ04	1-1825138-5
A201SCWZB04	1-1825138-6
A201SD9AQ04	1-1825138-7
A201SD9AV2Q04	1-1825138-8
A201SDCB04	1-1825138-9
A201SDZQ04	2-1825138-0
A201SY9AB04	2-1825138-1
A201SYAB04	2-1825138-2
A201SYAQ04	2-1825138-3
A201SYCB04	2-1825138-4
A201SYCQ04	2-1825138-5
A201SYWQ04	2-1825138-6
A201SYZB04	2-1825138-7
A201SYZQ04	2-1825138-8
A201T1ZQ04	2-1825138-9
not assigned	3-1825138-0
A201TZQ04	3-1825138-1
A208KZG04	3-1825138-2
A208P3ZQ04	3-1825138-3
A208SD9AQ04	3-1825138-4
A208SD9AV2Q04	3-1825138-5
A208SYCB04	3-1825138-6
A208SYCQ04	3-1825138-7
A208SYZQ04	3-1825138-8
A208T1ZQ04	3-1825138-9
A208TZQ04	4-1825138-0
A208SDCQ04	4-1825138-1
A201P3V30G04	4-1825138-2
A203MD9AQ-UL	4-1825138-3
A201MCWCB04	4-1825138-4
A201SCWCB04	4-1825138-5

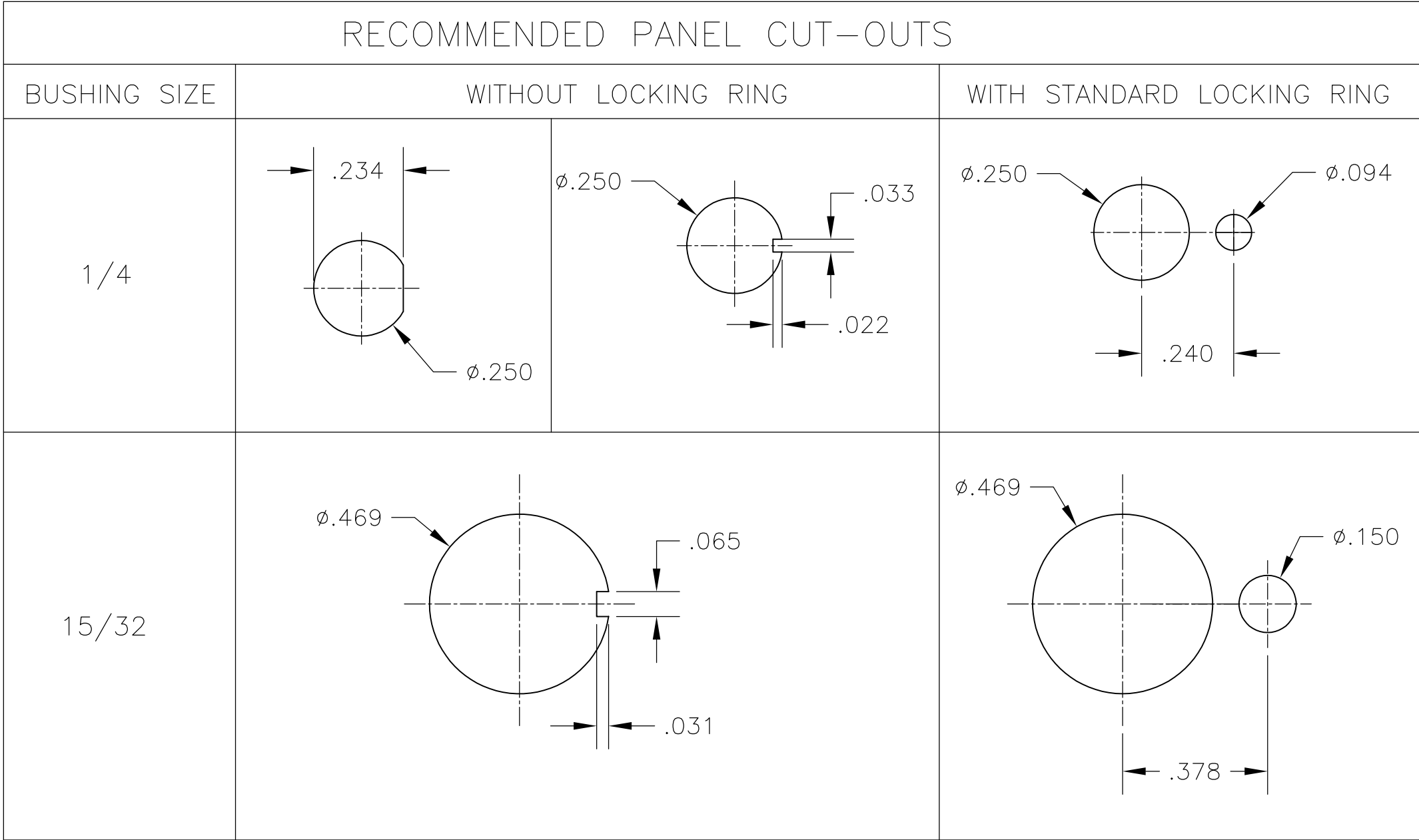

MATERIALS CHART		
COMPONENT NAME	BASE MATERIAL	
CASE	DAP, RED, UL94 V-0	
FRAME	STAINLESS STEEL	FINISH
B TERMINALS & CONTACTS	COPPER	GOLD OVER NICKEL
G TERMINALS & CONTACTS	COPPER	GOLD OVER SILVER
Q TERMINALS & CONTACTS	COPPER	.000400 SILVER
ACTUATOR	PHENOLIC, BLACK, UL94 V-1	
LEVER	BRASS	CHROME
BUSHING	BRASS	NICKEL
SPRING	MUSIC WIRE	
SUPPORT BRACKET	BRASS	TIN
PIVOT PIN	STEEL	NICKEL
LOCK WASHER	STAINLESS STEEL	
LOCKING RING	STAINLESS STEEL	
NUTS	C3604BD BRASS	NICKEL
TERMINAL SEAL	EPOXY	

THIS DRAWING IS A CONTROLLED DOCUMENT.

DIMENSIONS:
INCHES

TOLERANCES UNLESS OTHERWISE SPECIFIED:

0 PLC ± -
1 PLC ± -
2 PLC ± -
3 PLC ± .010
4 PLC ± -
ANGLES ± -
FINISH -

MATERIAL

-

DWN
M. ZITTO

CHK
M.ZITTO

APVD
P.BROUILLETTE

PRODUCT SPEC
-

APPLICATION SPEC
-

WEIGHT
-

CUSTOMER DRAWING

14APR05

TE Connectivity

NAME
GEMINI A SERIES TOGGLE SWITCH, DOUBLE POLE,
2 POSITION FUNCTIONS (01 & 08)

SIZE
A2

CAGE CODE
00779

DRAWING NO
C=1825138

RESTRICTED TO
-

SCALE
3:1

SHEET
4 of 4

REV
A5

Mouser Electronics

Authorized Distributor

Click to View Pricing, Inventory, Delivery & Lifecycle Information:

[TE Connectivity:](#)

[A201MD9AQ04](#)