

RECOMMENDED PC BOARD LAYOUT

NOTES:

1. RECOMMENDED P.C.B THICKNESS 1.60 MM
2. HOUSING MAT'L: NYLON 66, 25% G.F UL 94V-0, BLACK.
3. CONTACTS: PHOS BRONZE ALLOY UNS-C51000, 0.460 ROUND WIRE, PLATING SEE TABLE.
4. METAL SHELL MATERIAL:  
COPPER ALLOY. 0.20mm THICK  
FINISH:  
FOR 94152-XXX TIN-LEAD 100u" THICK MIN.  
FOR 94152-XXXLF PURE TIN 80u" THICK MIN.
5. PACKAGING: GES-14-351, USE TRAY
6. ALL DIMENSIONS IN MILLIMETER.
7. IF LF P/N THE PRODUCT MEETS EUROPEAN UNION DIRECTIVES AND OTHER COUNTRY REGULATIONS AS DESCRIBED IN GS-22-008.
8. THE HOUSING WILL WITHSTAND EXPOSURE TO 260°C PEAK TEMPERATURE FOR 10 SECONDS IN A WAVE SOLDER APPLICATION WITH A 1.60mm MINIMUM THICK CIRCUIT BOARD.
9. IF LF P/N PACKAGING MEETS GS-14-920 SPECIFICATION.

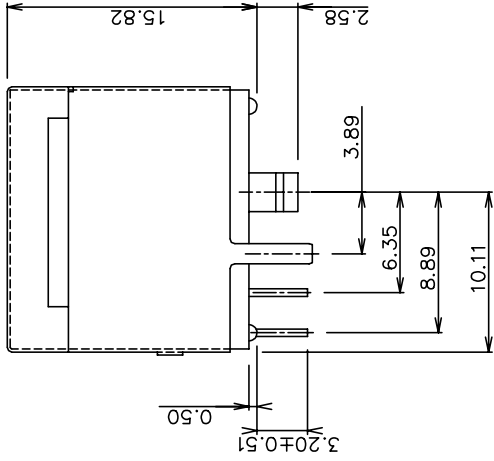
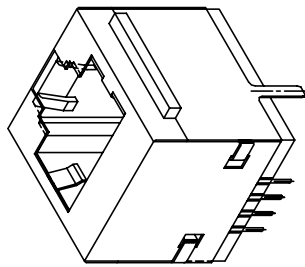

METAL SHIELD  
M/J ASSY FOR VERT.

mat'l. code		surface	tolerance	projection	product family
ISQI302		ISQI302	ISQI302	ISQI302	MOD JACK
trlec n dnr	date	tolerances unless otherwise specified			
B T50378	CL 12/18/95	angle	0.XX±0.3	8 POS VERT P.C.B. M/J ASSY	
C T03-043	WL 10/06/03	scale	0.XX±0.15	SHIELDED	
D N05-0030	YS 02/05/05	0°±2'	0.XXX±0.05	awg no sheet 1 of 1 size	
E N06-0319	WG 12/28/08	chr		94152	
F ELX-N-01090	SH MW 3/14/12	eng	KCHOU	Product Customer Drawing	
G ELX-N-1584	Henry	09/13/13	chr	type	
			appd	JENN TSAO	
sheet	revising				
index	Sheet	1			

# Mouser Electronics

Authorized Distributor

Click to View Pricing, Inventory, Delivery & Lifecycle Information:

[FCI / Amphenol:](#)

[94152-088LF](#) [94152-188LF](#) [94152-488LF](#) [94152-388LF](#)