

This document is the property of Amphenol Corporation and is delivered on the express condition that is not to be disclosed, reproduced or used, in whole or in part, for manufacture or sale by anyone other than Amphenol Corporation without its prior consent, and that no right is granted to disclose or to use any information in this document.

The marking on this product doesn't contain environmental hazardous materials per Material Specification SS-00259 for Sony GP compliant or per directive 2011/65/EU for RoHS compliant.



ORIGINAL



REVISIONS				
SYM	ECN No.	DESCRIPTION	DATE	APPROVED
F	NE-11115	MODIFIED DRAWING	08/22/2011	Sondra Sang
A1	NE-13107	MODIFIED PINS & ADDED DIMENSION	07/09/2013	Sondra Sang
B1	NE-13138	ADDED COLOR OPTIONS AND DIMENSIONS	08/22/2013	Sondra Sang
C1	NE-13175	CANCELED PIN LENGTH OPTIONS	10/29/2013	Sondra Sang
D1	NE-14166	ADDED SOLDER TAIL LENGTH OPTION	10/29/2013	Sondra Sang
E1	NE-16213	ADD D/C T&R /REMOVE NYLON /COMBINE SD	09/14/2016	Arron Lin
F1	NE-17304	ADD PANEL CUT OUT	11/30/2017	Sondra Sang

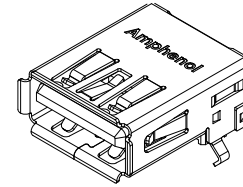
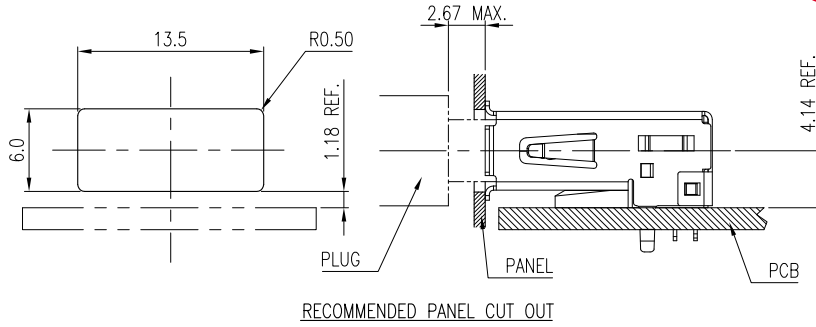
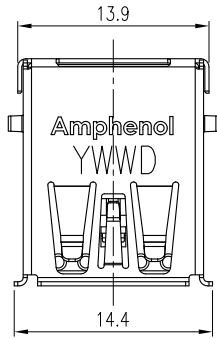

PIN #	SIGNAL NAME
1	VBUS
2	D-
3	D+
4	GND
5	SSRX-
6	SSRX+
7	GND_DRAIN
8	SSTX-
9	SSTX+
SHELL	SHIELD

PIN ASSIGNMENT

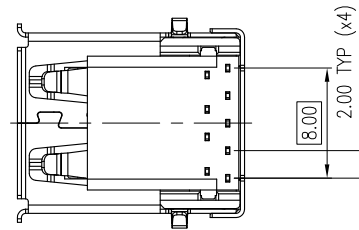
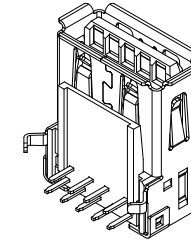
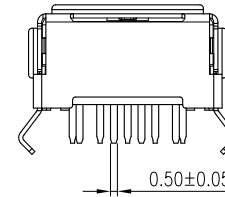
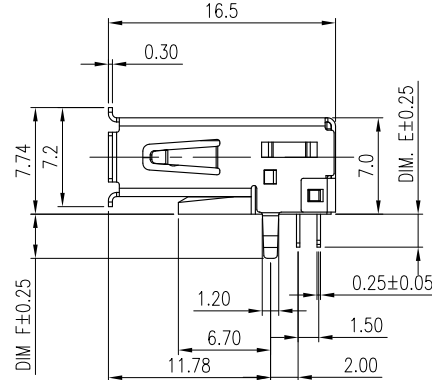
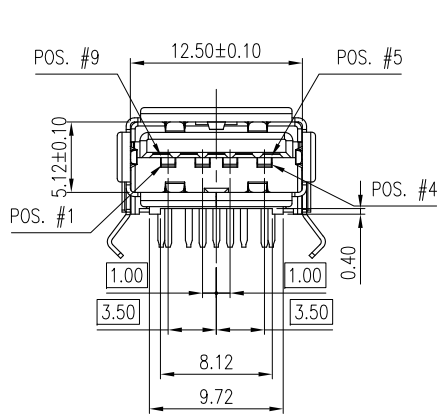

PART NUMBER: GSB3 111 X X X HR

CONTACT FINISH

- 1: GOLD FLASH
- 2: 15µ" GOLD
- 3: 30µ" GOLD

SOLDER TAIL LENGTH / PACKAGE OPTION

PART NO	DIM. E	DIM. F	PACKAGE
GSB3111XXHR	2.40	3.20	TRAY
GSB3111XX1HR	3.00	3.60	TRAY
GSB3111XX3HR	2.17	3.20	TRAY
GSB3111XX5HR	2.40	3.20	T&R
GSB3111XX6HR	3.00	3.60	T&R
GSB3111XX7HR	2.17	3.20	T&R

INSULATOR AND COLOR

- 1: LCP, Blue
- 3: LCP, Black

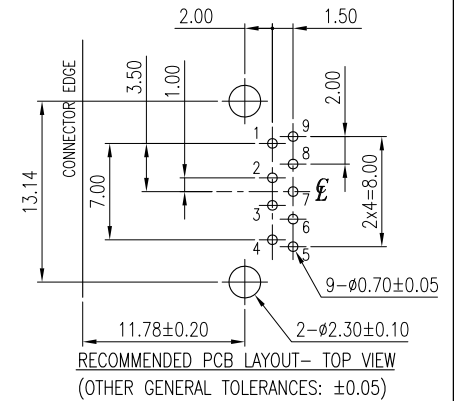

- NOTES:
1. HOUSING: HIGH TEMPERATURE THERMOPLASTIC OPTIONS UL 94V-0 COLOR-OPTIONS
 2. BOTTOM COVER: HIGH TEMPERATURE THERMOPLASTIC, UL 94V-0, COLOR:OPTIONS
 3. CONTACT: COPPER ALLOY, 0.25mm THICKNESS, SELECTIVE GOLD PLATING ON CONTACT AREA, 120µ" MIN. MATTE TIN PLATED ON SOLDERING TAIL, 80µ" MIN. NICKEL UNDER-PLATED OVERALL
 4. METAL SHELL: COPPER ALLOY, 0.3mm THICKNESS, 50µ" MIN. NICKEL UNDER-PLATED OVERALL
 5. THIS PRODUCT DOESN'T CONTAIN ENVIRONMENTAL HAZARDOUS PER DIRECTIVE 2011/65/EU FOR ROHS COMPLIANT.
 6. P/N: GSB31113XXXHR PRODUCT SPECIFICATION REFER TO: PS-7411
P/N: GSB31111XXXHR/GSB31112XXXHR PRODUCT SPECIFICATION REFER TO: PS-7440

TOLERANCE	APPROVALS	DATE	TITLE	UNIT	SIZE	PART No.
X.	DRAWN		USB 3.0 CONNECTOR STANDARD A R/A DIP TYPE	mm	A3	GSB3111XXXHR
X.X ±0.30	Sondra Sang	11/30/2017				
X.XX ±0.20	Chenny Yeh	11/30/2017				
X.XXX ±0.10	APPROVED					
ANGULAR ±1°	Hank Hsu	11/30/2017				
UNLESS OTHERWISE SPECIFIED	DWG TYPE	PROJECT CODE		SCALE	SHEET	DWG No.
	CUST DWG	OTHER		NA	1 OF 3	GSB3111XXXHR
						REV. F1

Amphenol®

Amphenol Corporation
Amphenol Taiwan Corporation

This document is the property of Amphenol Corporation and is delivered on the express condition that is not to be disclosed, reproduced or used, in whole or in part, for manufacture or sale by anyone other than Amphenol Corporation without its prior consent, and that no right is granted to disclose or to use any information in this document.

The marking on this product doesn't contain environmental hazardous materials per Material Specification SS-00259 for Sony GP compliant or per directive 2011/65/EU for RoHS compliant.



ORIGINAL



REVISIONS				
SYM	ECN No.	DESCRIPTION	DATE	APPROVED
F	NE-11115	MODIFIED DRAWING	08/22/2011	Sondra Sang
A1	NE-13107	MODIFIED PINS & ADDED DIMENSION	07/09/2013	Sondra Sang
B1	NE-13138	ADDED COLOR OPTIONS AND DIMENSIONS	08/22/2013	Sondra Sang
C1	NE-13175	CANCELED PIN LENGTH OPTIONS	10/29/2013	Sondra Sang
D1	NE-14166	ADDED SOLDER TAIL LENGTH OPTION	10/29/2013	Sondra Sang
E1	NE-16213	ADD D/C T&R /REMOVE NYLON /COMBINE SD	09/14/2016	Arron Lin
F1	NE-17304	ADD PANEL CUT OUT	11/30/2017	Sondra Sang

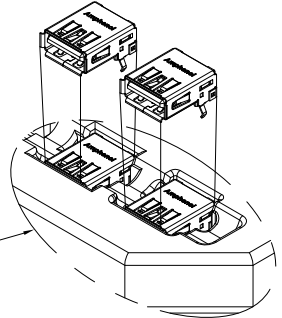
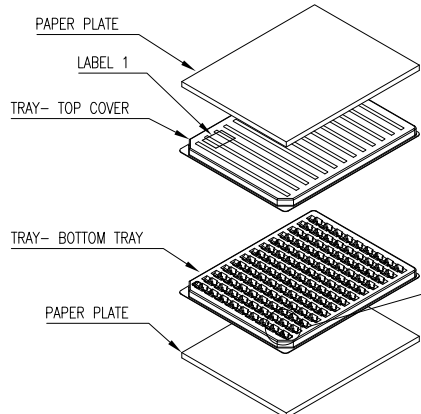

PN : GSBX1113XXHR	■■■■■■■■■■
QTY : 117	■■■
P/O : 411-012345-001	■■■■■■■■■■
DATE : 07/31/2009	MM/DD/YYYY
G.W. : 15.00 KG	HF
Amphenol Taiwan Corporation	

LABEL 1 = QTY : 117
LABEL 2 = QTY : 2340

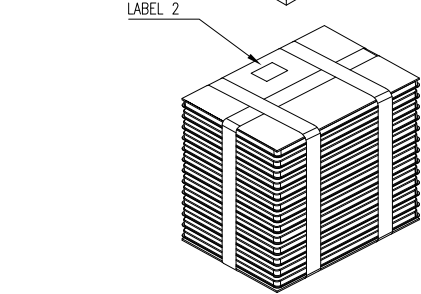

TOTAL 20 LAYERS TRAYS

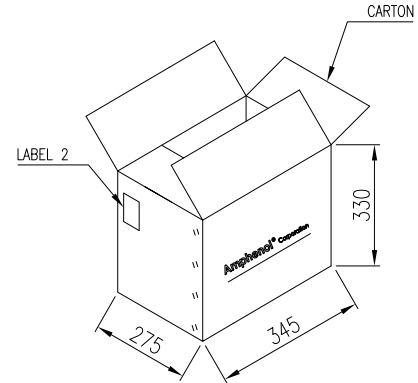
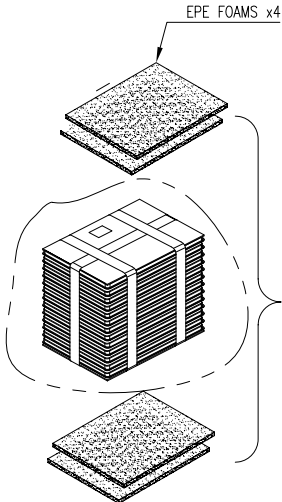

- NOTES:
1. MATERIAL: TRAY- PET
 2. THICKNESS: 0.80 mm MINIMUM
 3. THE BARCODE MUST BE 3 OF 9 BARCODE
 4. COMPONENTS LOAD PER THE TRAY: 117 PCS.
 5. THIS PRODUCT DOESN'T CONTAIN ENVIRONMENTAL HAZARDOUS MATERIALS PER DIRECTIVE 2011/65/EU FOR RoHS COMPLIANT
 6. TRAY SIZE : 333 X 265 X 15.6 mm

PART NO.	PCS. / TRAY	TRAY / CARTCON	N.W.	G.W.
GSBX1113XXHR	117 PCS.	117X20=2340 PCS.	6.0	9.4

(***) FOR REFERENCE

TOLERANCE	APPROVALS	DATE	TITLE	UNIT		SIZE	PART No.
X. ±0.30	DRAWN Sondra Sang	11/30/2017	USB 3.0 CONNECTOR STANDARD A R/A DIP TYPE	mm	A3	GSB31113XXHR	
X.X ±0.20	CHECKED Chenny Yeh	11/30/2017					
X.XX ±0.10	APPROVED Hank Hsu	11/30/2017		NA	2 OF 3	REV. F1	
ANGULAR ±1°	DWG TYPE CUST DWG	PROJECT CODE OTHER					
UNLESS OTHERWISE SPECIFIED						DWG No. GSB31113XXHR	

Amphenol[®]
Amphenol Corporation
Amphenol Taiwan Corporation

This document is the property of Amphenol Corporation and is delivered on the express condition that it is not to be disclosed, reproduced or used, in whole or in part, for manufacture or sale by anyone other than Amphenol Corporation without its prior consent, and that no right is granted to disclose or to use any information in this document.

The marking on this product doesn't contain environmental hazardous materials per Material Specification SS-00259 for Sony GP compliant or per directive 2011/65/EU for RoHS compliant.



ORIGINAL



REVISIONS				
SYM	ECN No.	DESCRIPTION	DATE	APPROVED
F	NE-11115	MODIFIED DRAWING	08/22/2011	Sondra Sang
A1	NE-13107	MODIFIED PINS & ADDED DIMENSION	07/09/2013	Sondra Sang
B1	NE-13138	ADDED COLOR OPTIONS AND DIMENSIONS	08/22/2013	Sondra Sang
C1	NE-13175	CANCELED PIN LENGTH OPTIONS	10/29/2013	Sondra Sang
D1	NE-14166	ADDED SOLDER TAIL LENGTH OPTION	10/29/2013	Sondra Sang
E1	NE-16213	ADD D/C T&R /REMOVE NYLON /COMBINE SD	09/14/2016	Arron Lin
F1	NE-17304	ADD PANEL CUT OUT	11/30/2017	Sondra Sang

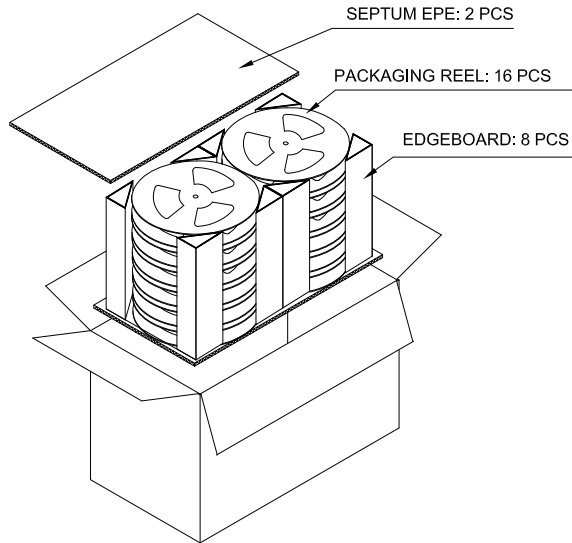
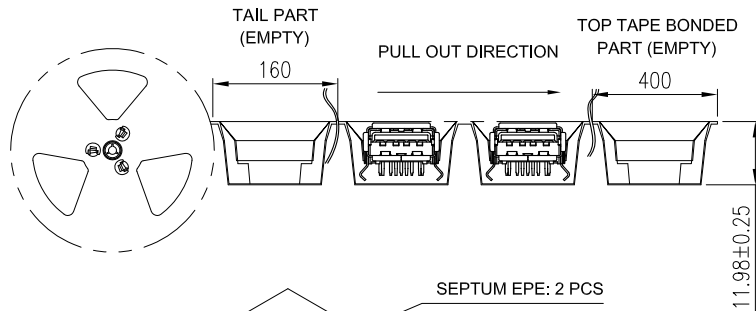
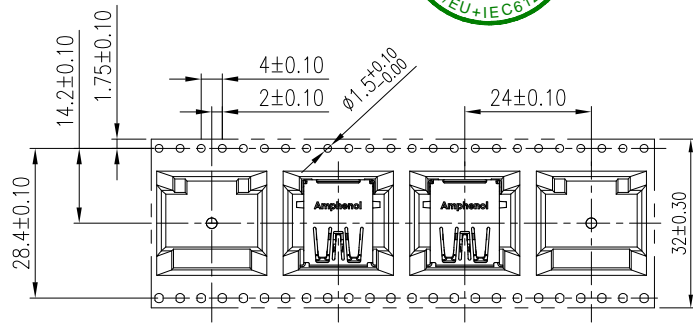

REEL SIZE	PARTS PER CARTON<S.P.Q>	PARTS PER REEL	TOTEL REEL PER CARTON
Ø330	3520	220	16

NOTES:

1. STAPLES SHOULD ONLY BE USED TO SET UP CARTON. ALL CARTON CLOSURES MUST BE DONE WITH TAPE.
2. FILL PACKAGING TRAYS WITH THE QUANTITIES AS INDICATED IN THE CHART.
3. SHIPPING CARTON DIMENSION: 690 X 360 X 325mm.
4. NET WEIGHT: 8.4 KG.
GROSS WEIGHT: XX KG.

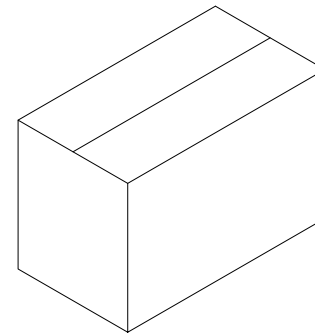

TOLERANCE	APPROVALS	DATE	TITLE			Amphenol®		
X. X.X ±0.30 X.XX ±0.20 X.XXX ±0.10	DRAWN Sondra Sang	11/30/2017	USB 3.0 CONNECTOR STANDARD A R/A DIP TYPE			Amphenol Corporation Amphenol Taiwan Corporation		
	CHECKED Chenny Yeh	11/30/2017						
ANGULAR ±1°	APPROVED Hank Hsu	11/30/2017		UNIT	SIZE	PART No.	GSB3111XXXHR	
UNLESS OTHERWISE SPECIFIED	DWG TYPE CUST DWG	PROJECT CODE OTHER		mm	A3	DWG No.		
			SCALE	SHEET	REV			
			NA	3 OF 3	F1X			