

THIS DRAWING IS UNPUBLISHED. RELEASED FOR PUBLICATION  
 © COPYRIGHT - By - ALL RIGHTS RESERVED.

LOC		DIST		REVISIONS			
P	LTR	DESCRIPTION		DATE	DWN	APVD	
AF	50	J5		REVISED PER ECR-12-013486	06JAN13	KH	KR

SUGGESTED MATING TAB

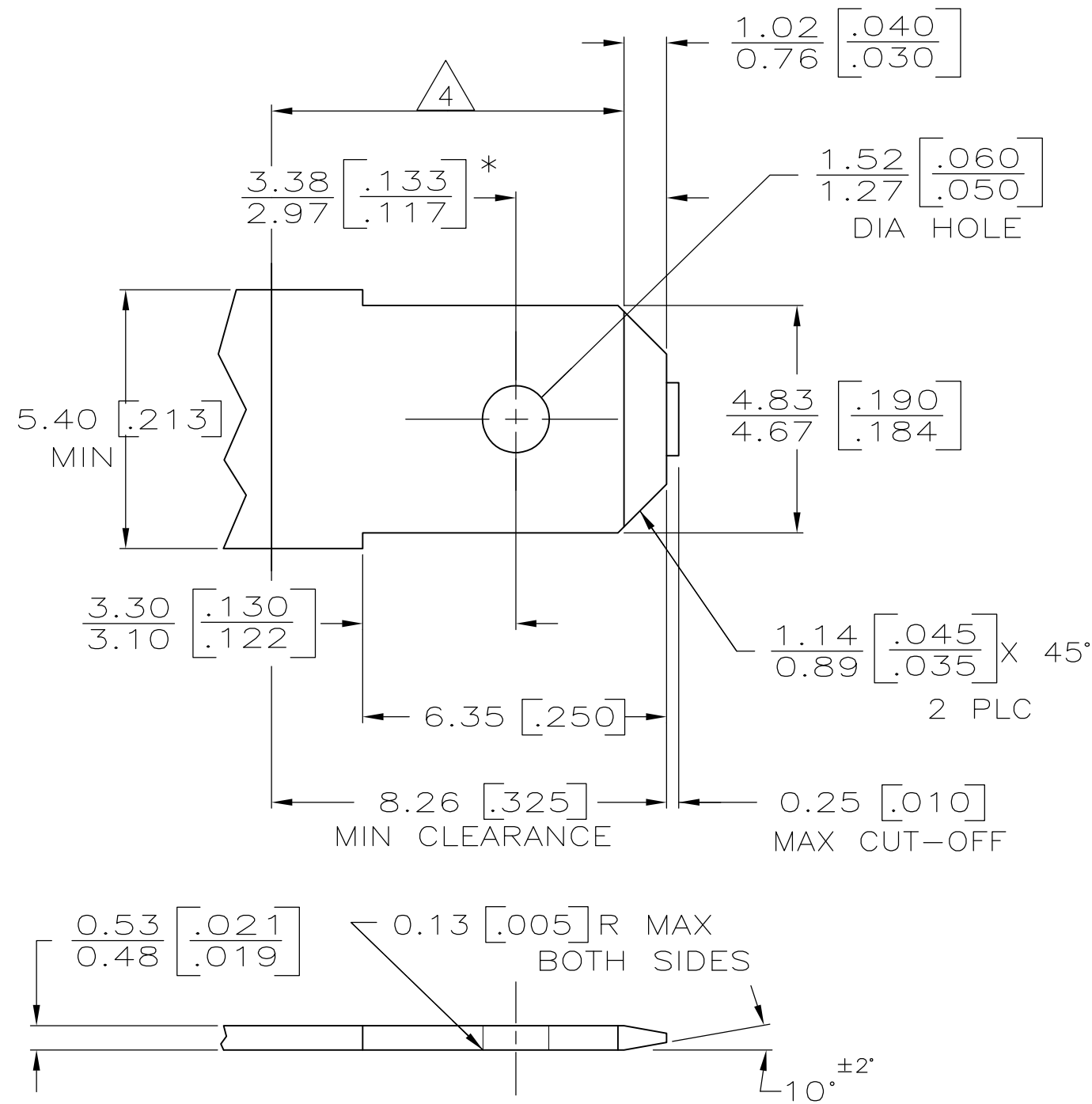

- 1 MATL: #2 HARD BRASS OR NICKEL PLATE STEEL.
- 2 NO BURRS PERMISSIBLE AT HOLE.
- 3 TIN PLATING IS REQUIRED ON BRASS WHEN TERMINAL TEMPURTURE IS OVER 225° F.
- 4 MUST BE FLAT WITHIN 0.076 [0.003] OVER THIS LENGTH.
- 5 HOLE MUST BE SYMMETRICAL ABOUT TAB  $\phi$  WITHIN 0.076 [0.003]
- \* TO BE USED ONLY WHEN SHOULDER IS ELIMINATED.

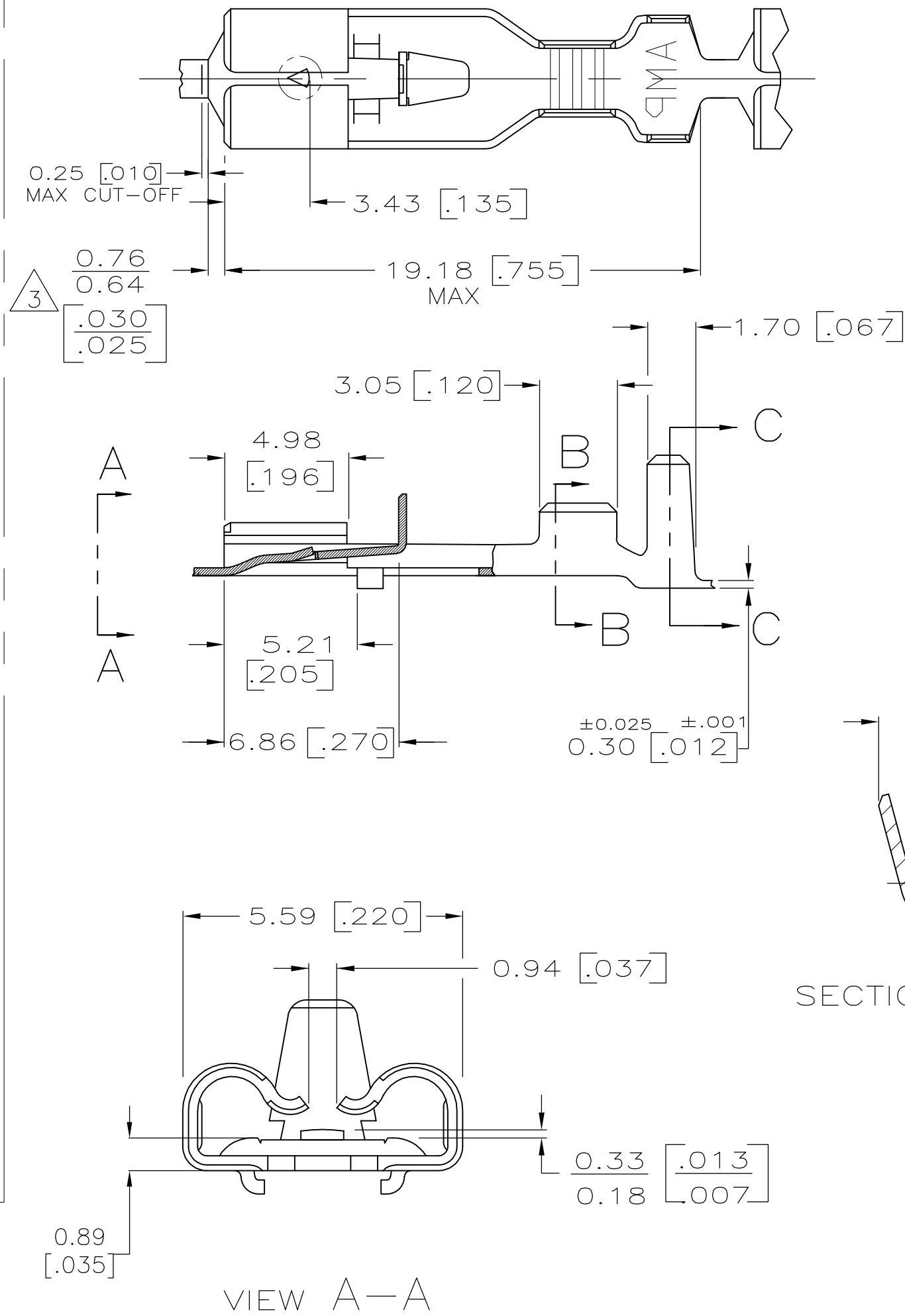

- 1 DIMENSIONS IN BRACKETS ARE IN INCHES.
- 2 CONTINUOUS STRIP ON REELS.
- 3 THE 0.76 [0.030] / 0.64 [0.025] DIMENSION MUST BE MAINTAINED BY THE APPLICATOR CUT-OFF TO ENSURE THE PROPER LOCKING FUNCTION OF THE RECEPTACLE.
- 4 WIRE SIZE IS FOR A [#24-#20] AWG.
- 5 INSULATION RANGE IS 1.52-2.79 [0.060-.110] DIA.
- 6 GOLD PLATE 0.00127 [0.000050] MIN THK OVER 0.00127 [0.000050] MIN NICKEL PL.
- 7 GOLD FLASH PL. 0.00012 [0.000005] MIN THK OVER 0.00127 [0.000050] MIN NICKEL PL
- 8 PRELIMINARY - NOT FOR PRODUCTION

SECTION B-B

SECTION C-C

GOLD / NICKEL 7	BRASS	8	63196-5
---	BRASS		63196-4
GOLD / NICKEL 6	BRASS	8	63196-3
PRE-TIN	BRASS		63196-2
TIN	BRASS		63196-1
FINISH	MATERIAL		PART NO.

DIMENSIONS:		TOLERANCES UNLESS OTHERWISE SPECIFIED:		DWN		APVD		NAME	
mm	[INCHES]	0 PLC	± -	JR RUTH	2/28/87	R KUZO	3/9/87	RECEPTACLE, POSITIVE LOCK, .187 SERIES	
1 PLC	± -	1 PLC	± -	CHK	G YETTER	PRODUCT SPEC		SIZE	A2
2 PLC	± -	2 PLC	± -	APPLICATION SPEC		WEIGHT	-	CAGE CODE	00779
3 PLC	± 0.25 .010	3 PLC	± 0.25 .010	MATERIAL		SEE TABLE	SEE TABLE	DRAWING NO	C=63196
4 PLC	± -	4 PLC	± -	FINISH		SEE TABLE	SEE TABLE	RESTRICTED TO	-
ANGLES	± -	FINISH		CUSTOMER DRAWING		SCALE	5:1	SHEET	1 OF 1
MATERIAL		FINISH		WEIGHT		SCALE		REV	J5

# Mouser Electronics

Authorized Distributor

Click to View Pricing, Inventory, Delivery & Lifecycle Information:

[TE Connectivity:](#)

[63196-2](#)