























Tous droits strictement réservés. Reproduction ou communication à des tiers interdite sous quelque forme que ce soit sans autorisation écrite du propriétaire. Propriété de c FCI. Droits de reproduction FCI.



All rights strictly reserved. Reproduction or issue to third parties in any form whatever is not permitted without written authority from the proprietor. Property of FCI. Copyright FCI.

PRODUCT NO.	ROW S		POWER		SIGNAL						POWER		
		E1	P1	P2	1	2	3	4	5	6	P3	P4	E2
51730-119-- NOTE ③	D C B A												
													

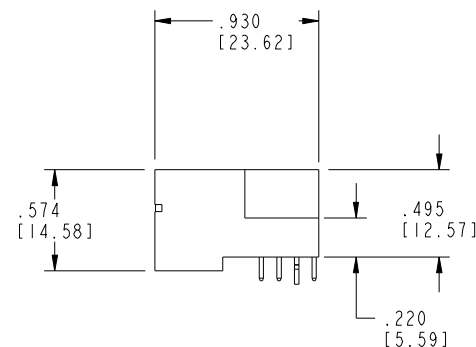
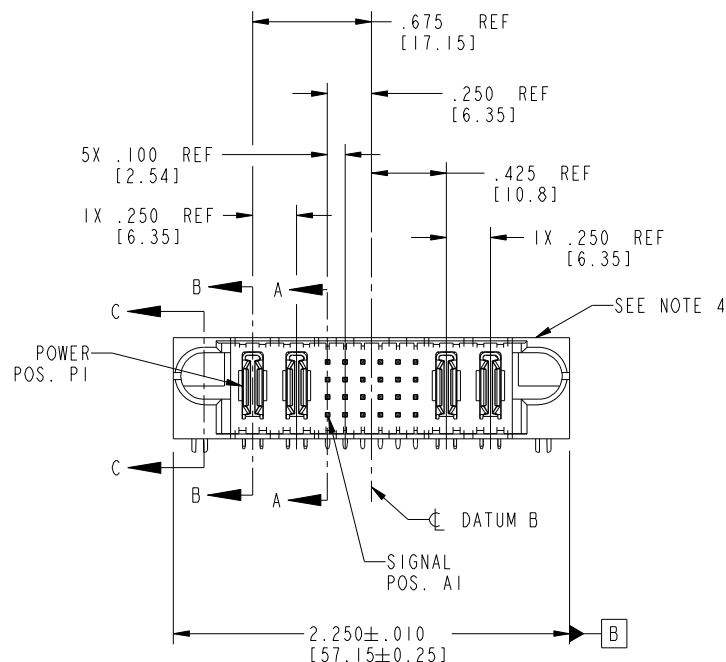

CODE	DIM "M" MATING LENGTH	CONTACT TYPE
U	.270 [6.86]	SIGNAL
T	.270 [6.86]	SIGNAL
S	.270 [6.86]	SIGNAL
R	.270 [6.86]	SIGNAL
PA	N/A [N/A]	POWER
HA	N/A [N/A]	HOLD-DOWN
F	.220 [5.59]	SIGNAL

mat'l code				SEE NOTE 2		tolerances unless otherwise specified		CUSTOMER		FCI		www.fciconnect.com	
ltr	ecn no.	dr	date			linear	.XX±.01/0.X±0.3	COPY		projection		title	2P + 24S + 2P
A	DG05-0543	Ryan	12/13/05				.XXX±.005/0.XX±0.13					RIGHT ANGLE SOLDER HEADER	
B	DG08-0253	SH	09/13/08			angles	.XXX±.0020/0.XXX±0.051					product family	PwrBlade
						dr	Ryan.Yuan 12/13/05					size	213
						enrg	Sally.Luo 12/19/05					dwg no	51730-119
						chr	David Su 12/13/05					scale	1:1
						appd	JOSEPH HSIA 12/13/05					sheet	1 of 4
sheet index	revision	B	B	B	B							cage code	22526
	sheet	1	2	3	4								

Pro/E



All rights strictly reserved. Reproduction or issue to third parties in any form whatever is not permitted without written authority from the proprietor. Property of FCI. Copyright FCI.

Tous droits strictement réservés. Reproduction ou communication à des tiers interdite sous quelque forme que ce soit sans autorisation écrite du propriétaire. Propriété de c FCI. Droits de reproduction FCI.

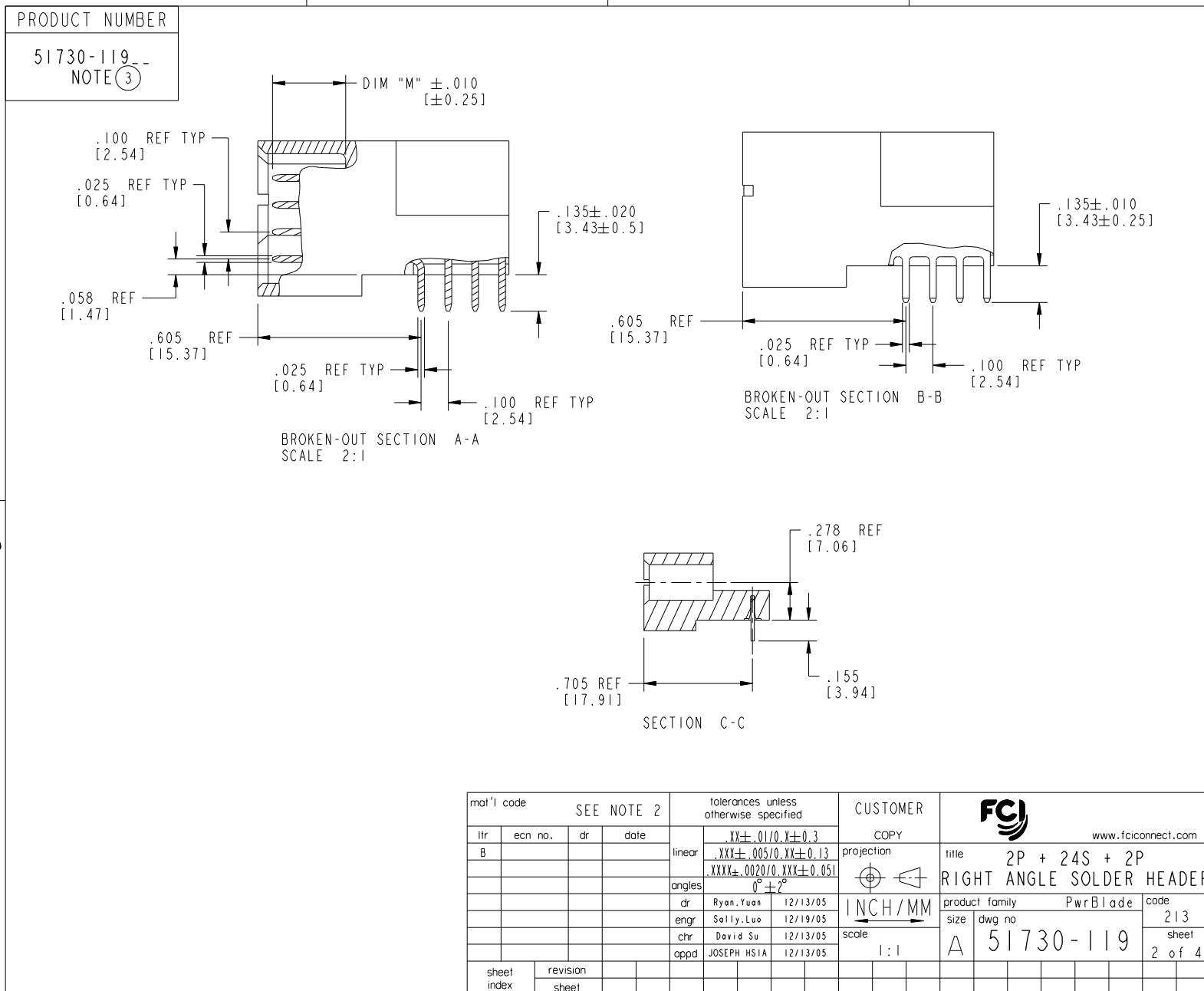



All rights strictly reserved. Reproduction or issue to third parties in any form whatever is not permitted without written authority from the proprietor.
Property of FCI. Copyright FCI.

Tous droits strictement réservés. Reproduction ou communication à des tiers interdite sous quelque forme que ce soit sans autorisation écrite du propriétaire.
Propriété de c FCI. Droits de reproduction FCI.

PRODUCT NUMBER
51730-119--
NOTE ③

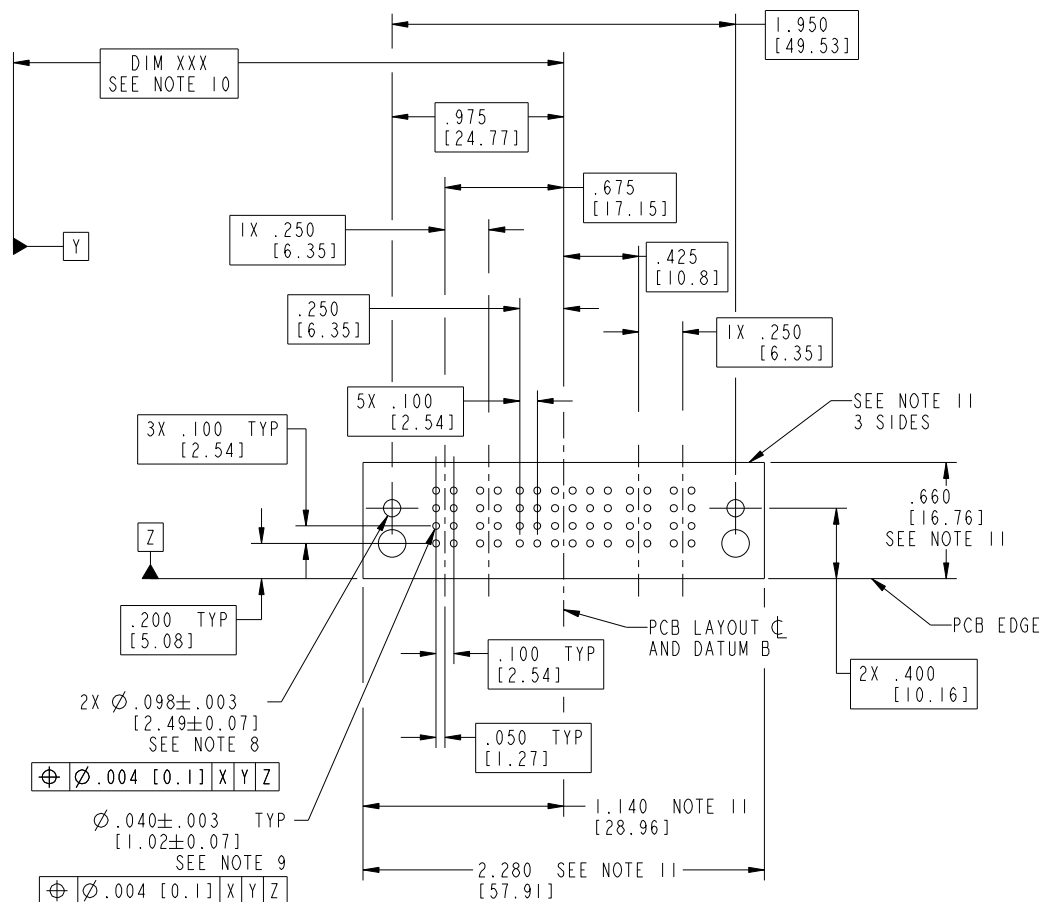

RECOMMENDED PCB LAYOUT

mat'l code				SEE NOTE 2		tolerances unless otherwise specified		CUSTOMER		FCI	
litr	ecn no.	dr	date					COPY		www.fciconnect.com	
B						linear	.XX±.01/0.X±0.3	projection		title	2P + 24S + 2P
						angles	.XXX±.005/0.XX±0.13			RIGHT ANGLE SOLDER HEADER	
							.XXX±.0020/0.XXX±0.051			product family	PwrBlade
						dr	Ryan.Yuan 12/13/05			code	213
						enrg	Sally.Luo 12/19/05			size	dwg no
						chr	David Su 12/13/05			scale	51730-119
						appd	JOSEPH HSIA 12/13/05			sheet	3 of 4
sheet index	revision sheet									cage code	22526

Pro/E

PDM: Rev:B

STATUS:Released

Printed: Dec 20, 2010

Tous droits strictement reserves. Reproduction ou communication a des tiers interdite sous quelque forme que ce soit sans autorisation écrite du propriétaire. Propriete de c FCI. Droits de reproduction FCI.



All rights strictly reserved. Reproduction or issue to third parties in any form whatever is not permitted without written authority from the proprietor. Property of FCI. Copyright FCI.

PRODUCT NUMBER
51730-119_- NOTE ③

NOTES:

1. DIMENSIONS AND TOLERANCES ARE IN ACCORDANCE WITH ASME Y14.5M, 1994 UNLESS OTHERWISE SPECIFIED.

CONNECTOR NOTES:

- ② HOUSING MATERIAL: UL 94 V-0 GLASS FILLED HIGH-TEMP THERMOPLASTIC
POWER CONTACT MATERIAL: COPPER ALLOY
SIGNAL PIN MATERIAL: COPPER ALLOY

3. PLATING:
③ SEE ITEM 1 & 2 IN PRINT 10064183 FOR PLATING SPEC OF 51730-119 AND 51730-119LF RESPECTIVELY

- ④ MANUFACTURER'S NAME, P/N, AND DATE CODE TO APPEAR ON THIS SURFACE.

5. PRODUCT SPECIFICATION GS-12-149.
APPLICATION SPECIFICATION BUS-20-067.

6. PACKAGED IN TRAYS.

PCB NOTES:

7. ALL HOLE DIAMETERS ARE FINISHED HOLE SIZE.

- ⑧ MOUNTING HOLES, WHERE APPLICABLE, ARE UNPLATED.

- ⑨ $\varnothing .0453 \pm .0010$ [1.151 \pm 0.025] DRILLED HOLES PLATED WITH
.0003 [0.008] MIN SnPb OVER .001 [0.03]
TO .003 [0.08] Cu PLATING TO ACHIEVE
 $\varnothing .040 \pm .003$ [1.02 \pm .07] HOLE.

- ⑩ "DIM XXX" TO BE DETERMINED BY THE CUSTOMER.

- ⑪ CONNECTOR KEEP-OUT ZONE.

12: A ③ SYMBOL WILL BE NEXT TO ANY DIMENSION, VIEW,
OR NOTE WHICH HAS BEEN MODIFIED WITH CURRENT
DRAWING VERSION.

mat'l code				SEE NOTE 2		tolerances unless otherwise specified		CUSTOMER		www.fciconnect.com	
ltr	ecr no.	dr	date	linear	$.XX \pm .01 / 0.X \pm 0.3$		COPY			title	
B					$.XXX \pm .005 / 0.XX \pm 0.13$		projection			2P + 24S + 2P	
					$.XXX \pm .0020 / 0.XXX \pm 0.051$		INCH/MM			RIGHT ANGLE SOLDER HEADER	
				angles	$0^\circ \pm 2^\circ$		scale			product family	
				dr	Ryan.Yuan	12/13/05	1:1			PwrBlade	
				enrg	Sally.Luo	12/19/05				code	
				chr	David.Su	12/13/05			size		213
				appd	JOSEPH HSIA	12/13/05			dwg no		sheet
sheet index		revision sheet								4 of 4	

cage code 22526

Mouser Electronics

Authorized Distributor

Click to View Pricing, Inventory, Delivery & Lifecycle Information:

[FCI / Amphenol:](#)

[51730-119LF](#)