

| LOC | DIST | REVISIONS | | | | |
|-----|------|-----------|-----|-------------|-----------|-------------|
| | | P | LTR | DESCRIPTION | DATE | DWN APVD |
| FT | 0 | | 1 | - | 10DEC2008 | SS CR |
| | | | | | | |
| | | | | | | |
| | | | | | | |

D

D

C

C

B

B

A

A

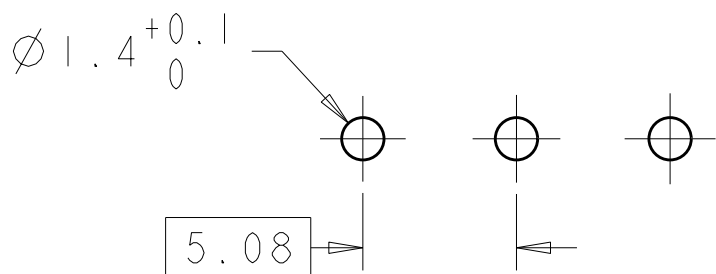
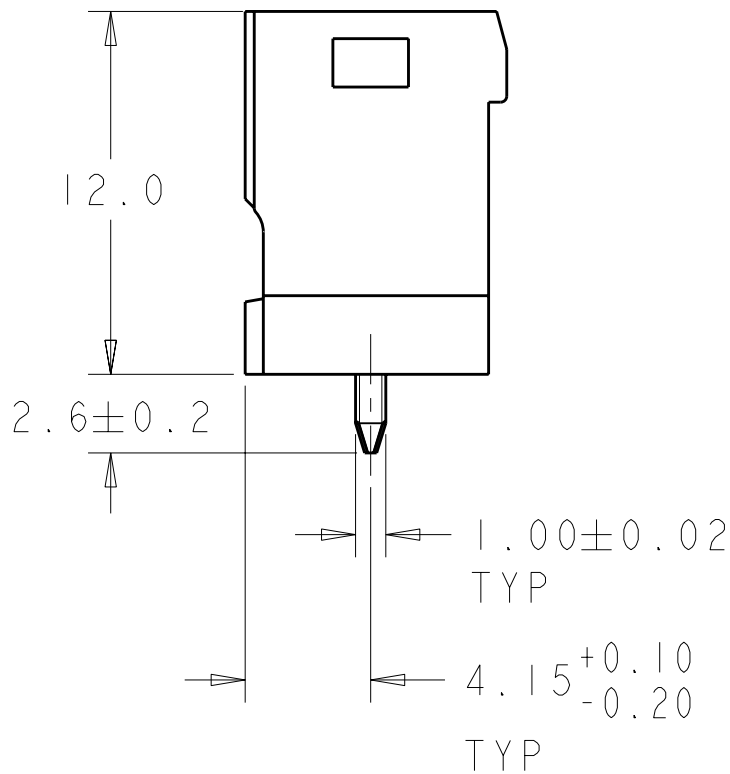
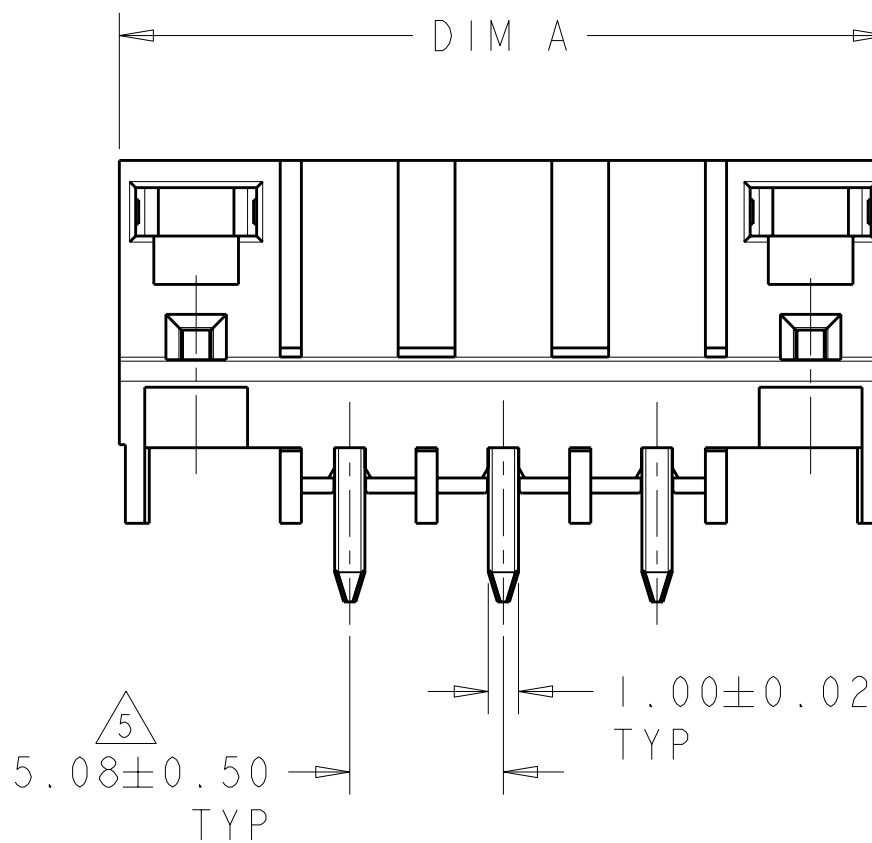
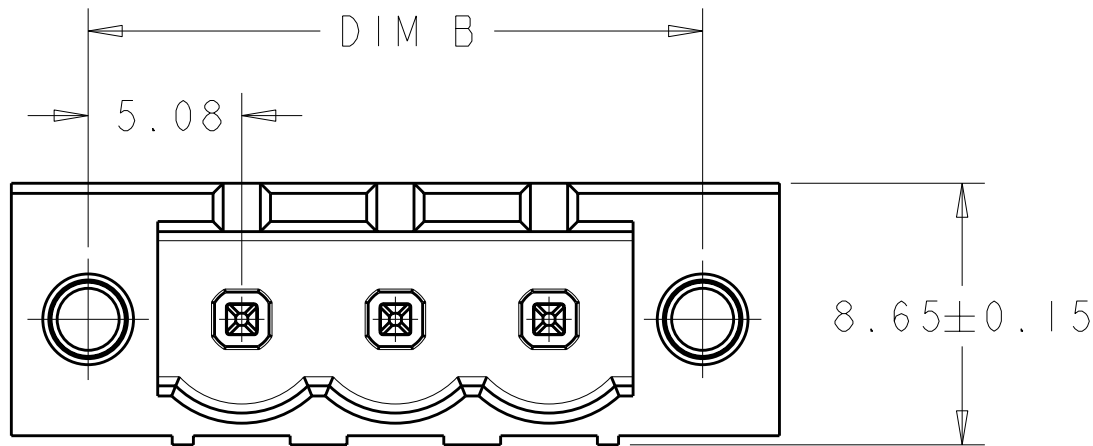

RECOMMENDED PC BOARD LAYOUT

1. MATERIALS:
HOUSING: PA 6-6, UL 94V-0, COLOR: DK GRAY
TERMINAL: PHOSPHOR BRZ, TIN PLATED
2. SUITABLE FOR 1.6-2.4mm PC BOARD THICKNESS.
3. RECOGNIZED UNDER THE COMPONENT PROGRAM OF UNDERWRITERS LABORATORIES INC. FILE NO. E60677.
4. IMQ CERTIFICATE WITH SURVEILLANCE ON CONFORMITY WITH IEC 998-1/998-2-1.
5. NOT CUMULATIVE TOLERANCE.
6. TE LOGO TO APPEAR ON HOUSING, LOCATION OPTIONAL WHERE SPACE PERMITS.
7. STANDARD PACKAGE.
8. TAPE AND REEL PACKAGE.

THIS PRINT IS
PRELIMINARY
THE INFORMATION CONTAINED IN THIS DOCUMENT
IS CONFIDENTIAL AND PROPRIETARY TO TYCO ELECTRONICS
DO NOT REPRODUCE OR DISTRIBUTE
DESIGN IS SUBJECT TO CHANGE WITHOUT NOTICE

| | | | | |
|-------|-------|-------|-----------|-------------|
| 8 | 20.32 | 25.40 | 3 | 2-1986486-3 |
| 7 | 20.32 | 25.40 | 3 | 1986486-3 |
| NOTES | DIM B | DIM A | NO OF POS | PART NUMBER |

| | | | | | |
|---|--|--------------------|-----------------------|---|------------------------|
| THIS DRAWING IS A CONTROLLED DOCUMENT FOR TYCO ELECTRONICS CORPORATION. IT IS SUBJECT TO CHANGE AND THE CONTROLLING ENGINEERING ORGANIZATION SHOULD BE CONTACTED FOR THE LATEST REVISION. | | DWN S. SCHLEGE | 10DEC2008 | Tyco Electronics Harrisburg, PA 17105-3608 | |
| DIMENSIONS: mm | | CHK C. RICHARD | 10DEC2008 | | |
| TOLERANCES UNLESS OTHERWISE SPECIFIED: 0 PLC ± 1 PLC ±0.3 2 PLC ±0.25 3 PLC ±0.000 4 PLC ±0.000 ANGLES ±2° FINISH | | APVD C. RICHARD | 10DEC2008 | NAME TERMINAL BLOCK HEADER ASSY, VERTICAL W/ LOCKING SCREW, FLG 5.08mm HIGH TEMP | |
| MATERIAL | | PRODUCT SPEC - | APPLICATION SPEC - | SIZE A200779 | CAGE CODE C-1986486 |
| 1 | | WEIGHT - | CUSTOMER DRAWING | SCALE 4: | SHEET OF REV |

Mouser Electronics

Authorized Distributor

Click to View Pricing, Inventory, Delivery & Lifecycle Information:

[TE Connectivity:](#)

[2-1986486-3](#)